

PRODUCT INFORMATION PACKET



Model No: TO178

Catalog No: TO178

100 HP General Purpose Motor, 3 phase, 1800 RPM, 230/460 V, 404TS Frame, ODP
General Purpose Motors



Regal and Century are trademarks of Regal Rexnord Corporation or one of its affiliated companies.
©2021 Regal Rexnord Corporation, All Rights Reserved. MC017097E





Nameplate Specifications

Output HP	100 Hp	Output KW	74.6 kW
Frequency	60 Hz	Voltage	230/460 V
Current	113 A	Speed	1788 rpm
Service Factor	1.15	Phase	3
Duty	Continuous	Insulation Class	F
Frame	404TS	Enclosure	Open Drip Proof
Thermal Protection	None	Ambient Temperature	40 °C
UL	Recognized	CSA	Y
CE	Y	Number of Speeds	1

Technical Specifications

Electrical Type	POLYPHASE	Starting Method	Across The Line
Poles	4	Rotation	Reversible
Mounting	Rigid Base	Drive End Bearing	Ball
Opp Drive End Bearing	Ball	Frame Material	Cast Iron
Shaft Type	Keyed	Overall Length	33.86 in
Frame Length	19.68 in	Shaft Diameter	2.125 in
Shaft Extension	4.25 in		
Outline Drawing	SS620254	Connection Drawing	A-EE7308AA

This is an uncontrolled document once printed or downloaded and is subject to change without notice. Date Created:10/12/2021

SS620254

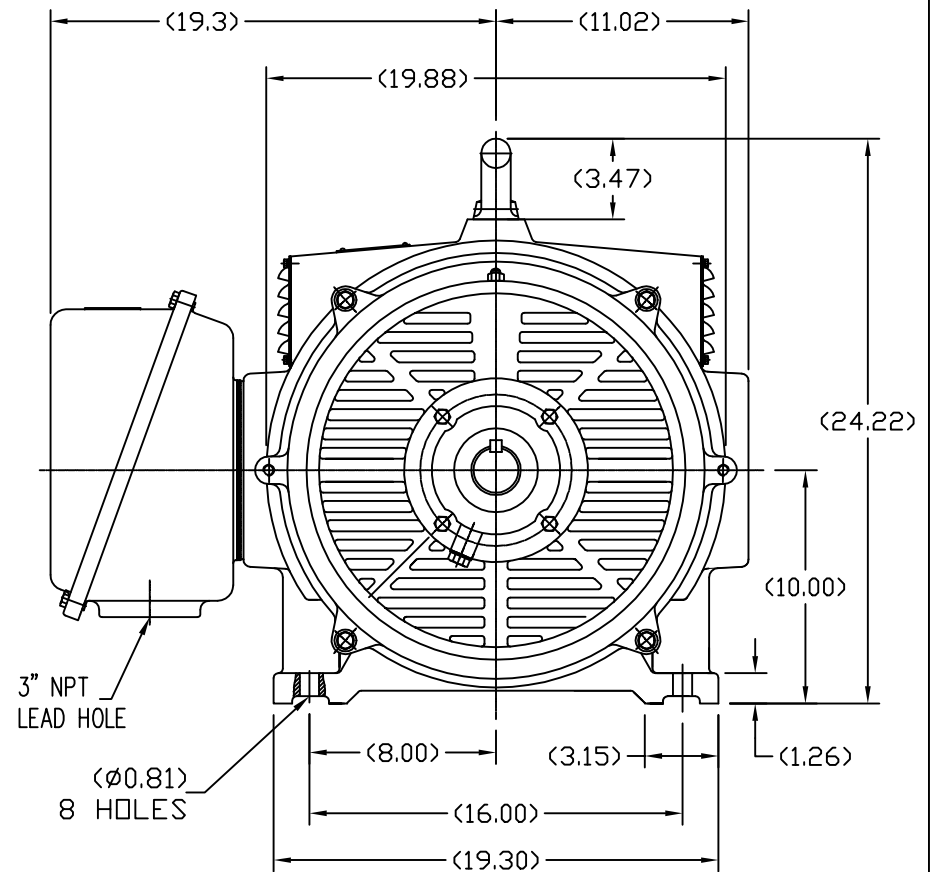
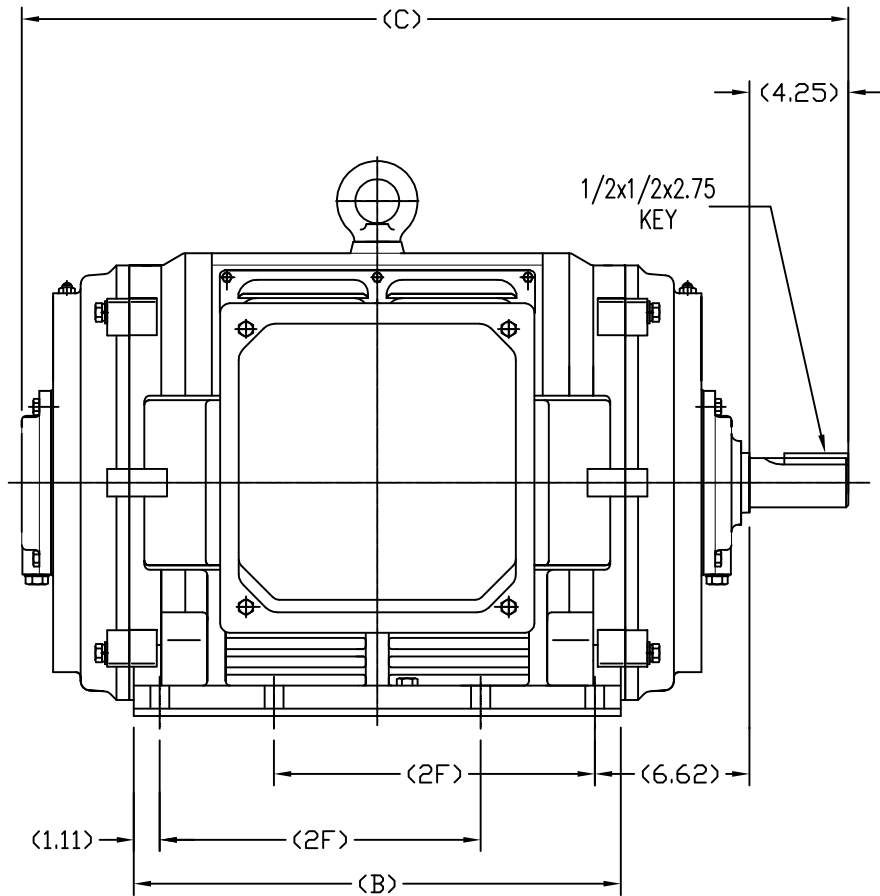

				TOLERANCES UNLESS SPECIFIED		REGAL-BELOIT CORPORATION		DRAWN CL 03-04-2010	
				DEC.	INCHES			CHK	ZYH 03-04-2010
				X	±.1			APPD	HZJ 03-04-2010
				XX	±.03	TITLE		SCALE	1=75
				XXX	±.005	404/405TS FR-DDP-CAST IRON		REF	
				XXXX	±.0005	MAT'L		FMF	HWADA
				ANG	±1/2"	FINISH		PREV	
NO. REVISION				BY & DATE		RFP		DRAWING NO.	
THIS DRAWING IN DESIGN AND DETAIL IS OUR PROPERTY AND MUST NOT BE USED EXCEPT IN CONNECTION WITH OUR WORK ALL RIGHTS OF DESIGN AND INVENTION ARE RESERVED THIS IS AN ELECTRONICALLY GENERATED DOCUMENT - DO NOT SCALE THIS PRINT				CHK		CAD FILE		SS620254	
				DIST		SIZE		B	
								SS620254	
								REV.	



LOW VOLTAGE



HIGH VOLTAGE

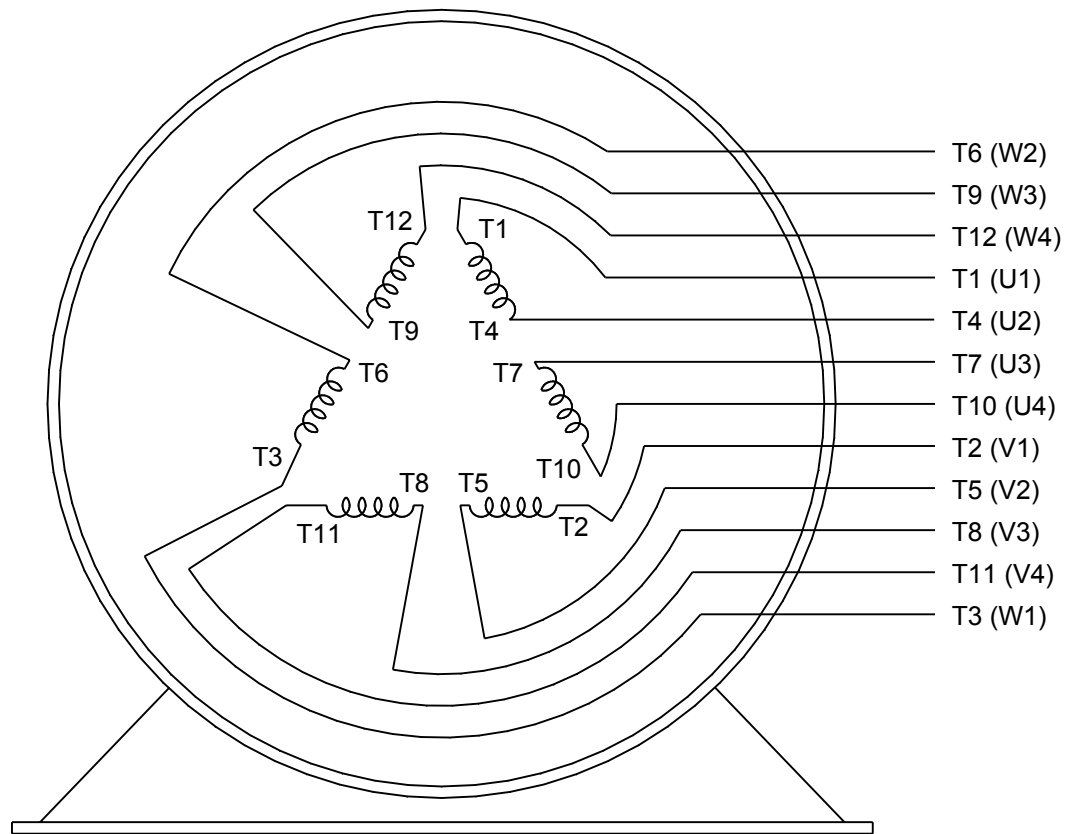

VIEW OF TERMINAL END

DRAWING REVISION K	REVISION BY AJW	DATE 07-17-2015
ECO ECO-0081632	APPROVED BY T. VUE	DATE 07-17-2015
ECO DESCRIPTION REV'D IEC MARKINGS PER IEC 60034-8		
<small>COPYRIGHT REGAL BELOIT AMERICA, INC. ALL RIGHTS RESERVED. PROPRIETARY AND CONFIDENTIAL INFORMATION - THIS DOCUMENT IS THE PROPERTY OF REGAL BELOIT AMERICA, INC. ("OWNER") AND CONTAINS OWNER'S PROPRIETARY INFORMATION. ANY PERSON, CORPORATION OR OTHER FIRM RECEIVING IT IS DEEMED, BY RECEIVING IT, TO AGREE THAT IT, AND/OR ANY PART OF IT, SHALL NOT BE DISCLOSED TO ANY PERSON, CORPORATION OR OTHER ENTITY, DUPLICATED, AND/OR USED, EXCEPT AS EXPRESSLY APPROVED IN WRITING IN ADVANCE BY OWNER. THIS DOCUMENT SHALL BE RETURNED TO OWNER UPON REQUEST. IT MAY BE SUBJECT TO CERTAIN RESTRICTIONS UNDER APPLICABLE EXPORT CONTROL LAWS AND REGULATIONS.</small>		

DRAWN BY LZ	DATE 01-12-1994
APPROVED BY GK	DATE 01-14-1994
REFERENCE	THIRD ANGLE PROJECTION
SIZE A	DRAWING NUMBER EE7308AA



Regal Beloit America, Inc.

DESCRIPTION
CONN DIAGRAM-EXTERNAL
 3Ø-2/1 DELTA-12 LEADS

MATERIAL PROCESS/FINISH

SHEET
1 OF 1