

# PRODUCT INFORMATION PACKET

**marathon®**  
Motors

Model No: TCA3152A3133GACD01  
Catalog No: TCA3152A3133GACD01  
TerraMAX® Cast Iron Motor, 425 HP, 3 Ph, 50 Hz, 415 V, 355L Frame



Regal and Marathon are trademarks of Regal Rexnord Corporation or one of its affiliated companies.  
©2025 Regal Rexnord Corporation, All Rights Reserved. MC017097E

**RegalRexnord**

### Nameplate Specifications

|                        |               |                            |                             |
|------------------------|---------------|----------------------------|-----------------------------|
| Phase                  | 3             | Output HP                  | 425 Hp                      |
| Output KW              | 315.0 kW      | Voltage                    | 415 V                       |
| Speed                  | 1490 r/min    | Service Factor             | 1                           |
| Frame                  | 355L          | Enclosure                  | Totally Enclosed Fan Cooled |
| Thermal Protection     | No Protection | Efficiency                 | 96 %                        |
| Ambient Temperature    | 50 °C         | Frequency                  | 50 Hz                       |
| Current                | 507.2 A       | Power Factor               | 0.9                         |
| Duty                   | S1            | Insulation Class           | F                           |
| Drive End Bearing Size | 6322          | Opp Drive End Bearing Size | 6322                        |
| UL                     | No            | CSA                        | No                          |
| CE                     | Yes           | IP Code                    | 55                          |
| Number of Speeds       | 1             | Efficiency Class           | IE3                         |

### Technical Specifications

|                       |               |                       |                |
|-----------------------|---------------|-----------------------|----------------|
| Electrical Type       | Squirrel Cage | Starting Method       | Direct On Line |
| Poles                 | 4             | Rotation              | Bi-Directional |
| Mounting              | B35           | Motor Orientation     | Horizontal     |
| Drive End Bearing     | C3            | Opp Drive End Bearing | C3             |
| Frame Material        | Cast Iron     | Shaft Type            | Keyed          |
| Overall Length        | 1542 mm       | Frame Length          | 1010 mm        |
| Shaft Diameter        | 95 mm         | Shaft Extension       | 170 mm         |
| Assembly/Box Mounting | R Side        |                       |                |
| Connection Drawing    | 8442000085    | Outline Drawing       | 0235502333     |

This is an uncontrolled document once printed or downloaded and is subject to change without notice. Date Created:04/22/2025

4

3

Uncontrolled Copy

2

1

B

A

B

A

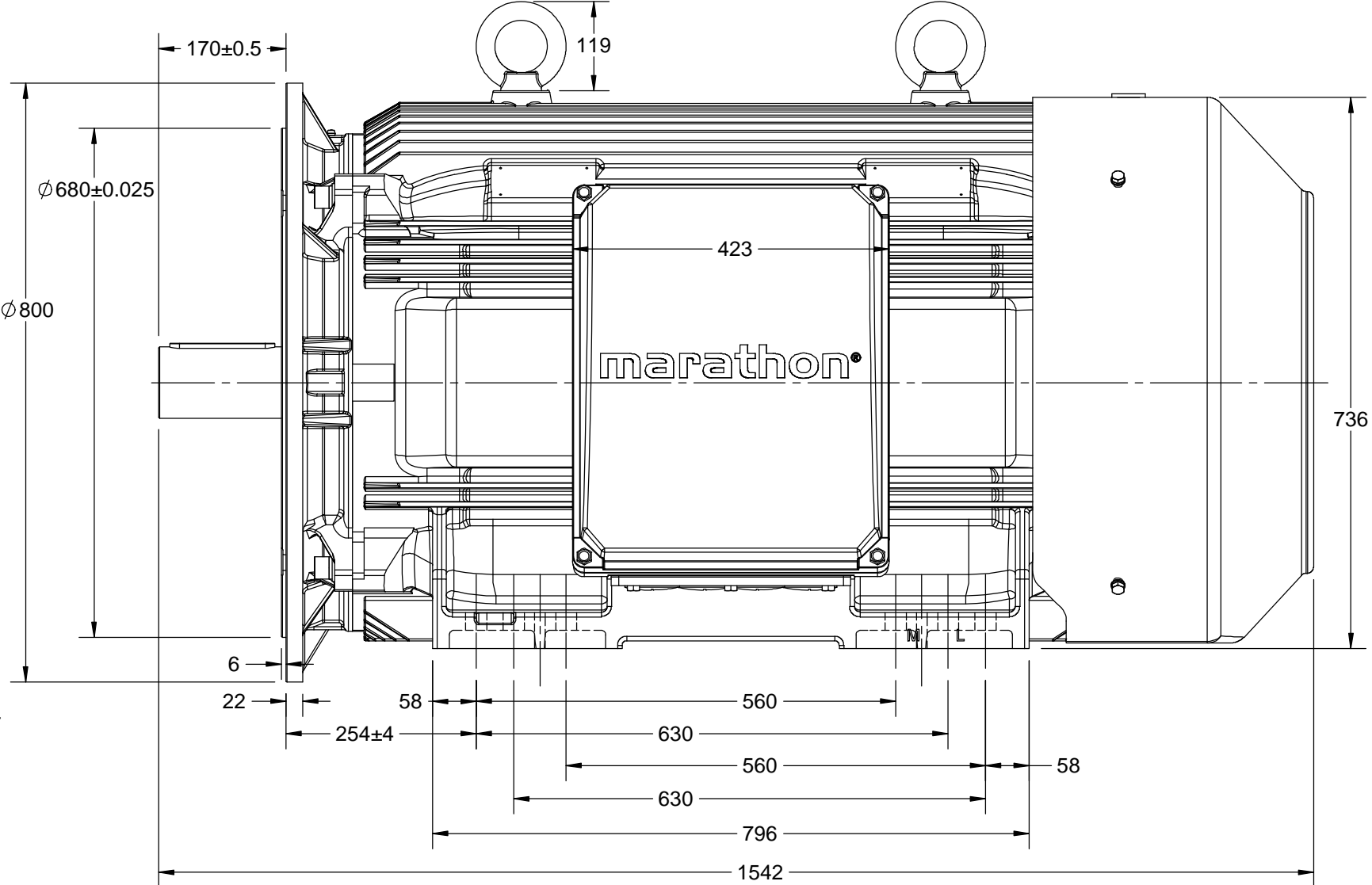
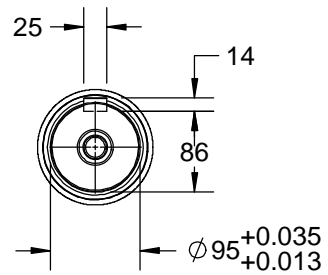
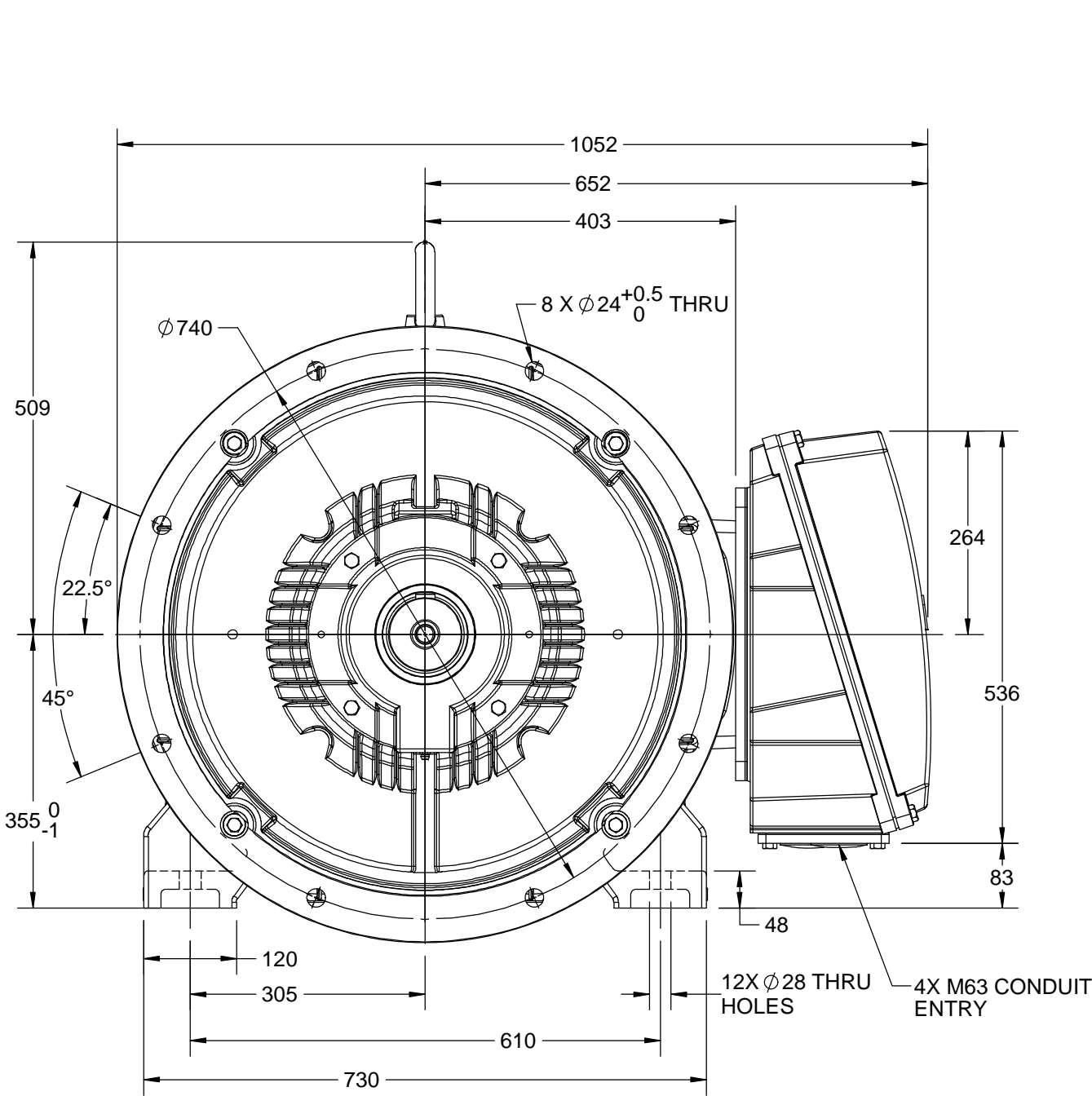

|  |                    |                    |
|--|--------------------|--------------------|
| DRAWING REVISION<br>B  | REVISION BY<br>VS  | DATE<br>05/07/2018 |
| ECO<br>ECO-0148344   | APPROVED BY<br>SBD | DATE<br>05/07/2018 |
| ECO DESCRIPTION<br>MODEL UPDATED   |                    |                    |
| COPYRIGHT REGAL BELOIT AMERICA, INC. ALL RIGHTS RESERVED.<br>PROPRIETARY AND CONFIDENTIAL INFORMATION - THIS DOCUMENT IS THE PROPERTY OF<br>REGAL BELOIT AMERICA, INC. ("OWNER") AND CONTAINS OWNER'S PROPRIETARY<br>INFORMATION. ANY PERSON, CORPORATION OR OTHER FIRM RECEIVING IT IS DEEMED,<br>BY RECEIVING IT, TO AGREE THAT IT, AND/OR ANY PART OF IT, SHALL NOT BE DISCLOSED<br>TO ANY PERSON, CORPORATION OR OTHER ENTITY, DUPLICATED, AND/OR USED, EXCEPT<br>AS EXPRESSLY APPROVED IN WRITING IN ADVANCE BY OWNER. THIS DOCUMENT SHALL<br>BE RETURNED TO OWNER UPON REQUEST. IT MAY BE SUBJECT TO CERTAIN<br>RESTRICTIONS UNDER APPLICABLE EXPORT CONTROL LAWS AND REGULATIONS. |                    |                    |

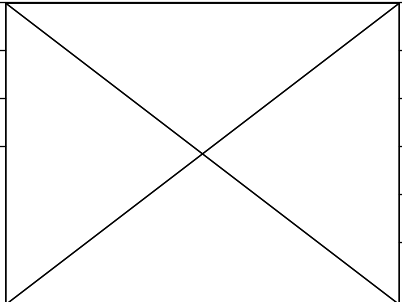

|                           |                                      |                              |                 |
|---------------------------|--------------------------------------|------------------------------|-----------------|
| DRAWN BY<br>GSR           | <b>marathon™</b><br>Motors           |                              |                 |
| DATE<br>15/011/2017       |                                      |                              |                 |
| APPROVED BY<br>JAY        | DESCRIPTION<br>OUTLINE               |                              |                 |
| DATE<br>15/011/2017       | 355L FR-4~8P-B35 MTG. TCA/QCA-RHS TB |                              |                 |
| REFERENCE                 | MATERIAL                             | PROCESS/FINISH               |                 |
| THIRD ANGLE<br>PROJECTION | SIZE<br>B                            | DRAWING NUMBER<br>0235502333 | SHEET<br>1 OF 1 |

4

3

2

1

COPYRIGHT REGAL BELOIT AMERICA, INC. ALL RIGHTS RESERVED. UNCONTROLLED COPY  
 PROPRIETARY AND CONFIDENTIAL INFORMATION - THIS DOCUMENT IS THE PROPERTY OF  
 REGAL BELOIT AMERICA, INC. ("OWNER") AND CONTAINS OWNER'S PROPRIETARY  
 INFORMATION. ANY PERSON, CORPORATION OR OTHER FIRM RECEIVING IT IS DEEMED,  
 BY RECEIVING IT, TO AGREE THAT IT, AND/OR ANY PART OF IT, SHALL NOT BE DISCLOSED  
 TO ANY PERSON, CORPORATION OR OTHER ENTITY, DUPLICATED, AND/OR USED, EXCEPT  
 AS EXPRESSLY APPROVED IN WRITING IN ADVANCE BY OWNER. THIS DOCUMENT SHALL  
 BE RETURNED TO OWNER UPON REQUEST. IT MAY BE SUBJECT TO CERTAIN  
 RESTRICTIONS UNDER APPLICABLE EXPORT CONTROL LAWS AND REGULATIONS.

|   |                           |                           |
|---|---------------------------|---------------------------|
| DRAWING REVISION<br><b>A</b>                  | REVISION BY<br><b>SN</b>  | DATE<br><b>13/01/2017</b> |
| ECO<br><b>ECO-0116390</b>                     | APPROVED BY<br><b>SBD</b> | DATE<br><b>13/01/2017</b> |
| ECO DESCRIPTION<br><b>NEW DRAWING RELEASE</b> |                           |                           |

| GEOMETRIC TOLERANCE |         |      |
|---------------------|---------|------|
| LINEAR DIM          | >0~6    | ±0.1 |
|                     | >6~30   | ±0.2 |
|                     | >30~120 | ±0.3 |



**NOTES:**

1. PRESSURE-SENSITIVE ADHESIVE COATED PAPER ON THE BACK OF SELF-ADHESIVE.
2. AT THE END OF YELLOW, WORDS, SYMBOLS, LETTERS ARE BLACK, BORDER IS BLACK.
3. THE TOLERANCE OF THE LINEAR SIZE OF THE TOLERANCE WITHOUT THE TOLERANCE BY THE TABLE.

8WD.442.2017



|                       |  |                                     |                        |
|-----------------------|--|-------------------------------------|------------------------|
| DRAWN BY<br><b>SN</b> |  <b>Regal Beloit America, Inc.</b> |                                     |                        |
|                       |  |                                     |                        |
|                       | DESCRIPTION<br><b>CONN DIAGRAM-NAMEPLATE</b>   |                                     |                        |
|                       | MATERIAL   |                                     | PROCESS/FINISH         |
|                       | SIZE<br><b>A</b>   | DRAWING NUMBER<br><b>8442000085</b> | SHEET<br><b>1 OF 1</b> |

Model No. TCA3152A3133GACD01

| U<br>(V) | Δ / Y<br>Conn | f<br>(Hz) | P<br>[kW] | P<br>[hp] | I<br>[A] | n<br>[RPM] | T<br>[Nm] | IE<br>Class | % EFF at __ load |      |       |       | PF at __ load |       |       | I <sub>A</sub> /I <sub>N</sub><br>[pu] | T <sub>A</sub> /T <sub>N</sub><br>[pu] | T <sub>K</sub> /T <sub>N</sub><br>[pu] |
|----------|---------------|-----------|-----------|-----------|----------|------------|-----------|-------------|------------------|------|-------|-------|---------------|-------|-------|--|--|--|
| 415      | Δ             | 50        | 315       | 425       | 507.2    | 1490       | 2031.21   | IE3         | 5/4FL            | FL   | 3/4FL | 1/2FL | FL            | 3/4FL | 1/2FL | 7                                      | 2.0                                    | 2.5                                    |
|          |               |           |           |           |          |            |           |             | -                | 96.0 | 96.0  | 96.1  | 0.90          | 0.88  | 0.84  |  |  |  |
|          |               |           |           |           |          |            |           |             |                  |      |       |       |               |       |       |  |  |  |

|                                  |                                   |
|----------------------------------|-----------------------------------|
| Motor type                       | TCA                               |
| Enclosure                        | TEFC                              |
| Frame Material                   | Cast Iron                         |
| Frame size                       | 355L                              |
| Duty                             | S1                                |
| Voltage variation *              | ± 10%                             |
| Frequency variation *            | ± 5%                              |
| Combined variation *             | 10%                               |
| Design                           | N                                 |
| Service factor                   | 1.0                               |
| Insulation class                 | F                                 |
| Ambient temperature              | -20 to +50 °C                     |
| Temperature rise (by resistance) | 70 [ Class B ] K                  |
| Altitude above sea level         | 1000 meter                        |
| Hazardous area classification    | NA                                |
| Zone classification              | NA                                |
| Gas group                        | NA                                |
| Temperature class                | NA                                |
| Rotor type                       | Aluminum Die cast                 |
| Bearing type                     | Anti-friction ball bearing        |
| DE / NDE bearing                 | 6322 C3 / 6322 C3                 |
| Lubrication method               | Regreasable                       |
| Type of grease                   | Shell Gadus S5 V100 or Equivalent |

|   |   |
|---|---|
| Degree of protection                      | IP 55                                       |
| Mounting type                             | IM B35                                      |
| Cooling method                            | IC 411                                      |
| Motor weight - approx.                    | 1947 kg                                     |
| Gross weight - approx.                    | 1992 kg                                     |
| Motor inertia                             | 10.1755 kgm <sup>2</sup>                    |
| Load inertia                              | Customer to Provide                         |
| Vibration level                           | 2.8 mm/s                                    |
| Noise level ( 1meter distance from motor) | 82 dB(A)                                    |
| No. of starts hot/cold/Equally spread     | 2/3/4                                       |
| Starting method                           | DOL   |
| Type of coupling                          | Direct                                      |
| LR withstand time (hot/cold)              | 15/30 s                                     |
| Direction of rotation                     | Bi-directional                              |
| Standard rotation                         | Clockwise form DE                           |
| Paint shade                               | RAL 5014                                    |
| Accessories                               |   |
| Accessory - 1                             | -   |
| Accessory - 2                             | -   |
| Accessory - 3                             | -   |
| Terminal box position                     | RHS   |
| Maximum cable size/conduit size           | 1R x 3C x 300mm <sup>2</sup> /4 x M63 x 1.5 |
| Auxiliary terminal box                    | NA  |

I<sub>A</sub>/I<sub>N</sub> - Locked Rotor Current / Rated Current

T<sub>K</sub>/T<sub>N</sub> - Breakdown Torque / Rated Torque

T<sub>A</sub>/T<sub>N</sub> - Locked Rotor Torque / Rated Torque

#### NOTE

All performance values at rated voltage and frequency.

All performance parameters are subjected to standard tolerance as per IEC 60034-1

\* Voltage, Frequency and combined variation are as per IEC60034-1

Technical data are subject to change. There may be discrepancies between calculated and name plate values.

| Efficiency | Europe | China | India           | Aus/Nz | Brazil | Global IEC |
|------------|--------|-------|-----------------|--------|--------|------------|
| Standards  | -      | -     | IS 12615 : 2018 | -      | -      | -          |

**Model No.** TCA3152A3133GACD01

| Enclosure | U<br>(V) | Δ / Y<br>Conn | f<br>(Hz) | P<br>[kW] | P<br>[hp] | I<br>[A] | n<br>[RPM] | T<br>[kgm] | T<br>[Nm] | IE<br>Class | Amb<br>[°C] | Duty | Elevation<br>[m] | Inertia<br>[kg-m <sup>2</sup> ] | Weight<br>[kg] |
|-----------|----------|---------------|-----------|-----------|-----------|----------|------------|------------|-----------|-------------|-------------|------|------------------|---------------------------------|----------------|
| TEFC      | 415      | Δ             | 50        | 315       | 425       | 507.2    | 1490       | 207.13     | 2031.21   | IE3         | 50          | S1   | 1000             | 10.1755                         | 1947           |

**Motor Load Data**

| Load Point   |       | NL    | 1/4FL | 1/2FL  | 3/4FL  | FL     | 5/4FL |
|--------------|-------|-------|-------|--------|--------|--------|-------|
| Current      | A     | 121.1 | 171.9 | 270.0  | 383.8  | 507.2  |       |
| Torque       | Nm    | 0.0   | 505.2 | 1012.0 | 1520.6 | 2031.2 |       |
| Speed        | r/min | 1500  | 1498  | 1495   | 1493   | 1490   |       |
| Efficiency   | %     | 0.0   | 94.2  | 96.1   | 96.0   | 96.0   |       |
| Power Factor | %     | 5.0   | 68.1  | 84.0   | 88.0   | 90.0   |       |

**Performance vs Load Chart**

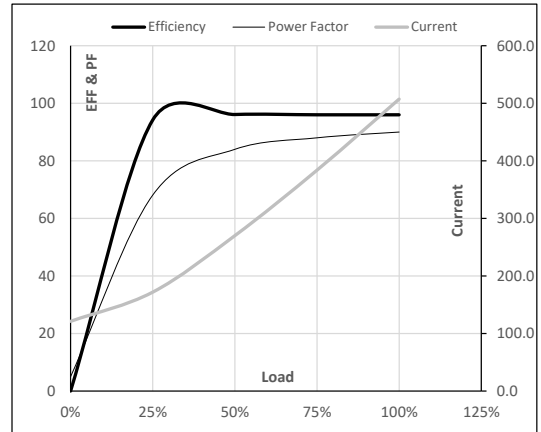

**Motor Speed Torque Data**

| Load Point |       | LR     | P-Up   | BD     | Rated | NL    |
|------------|-------|--------|--------|--------|-------|-------|
| Speed      | r/min | 0      | 214    | 1371   | 1490  | 1500  |
| Current    | A     | 3550.6 | 3195.5 | 1734.5 | 507.2 | 121.1 |
| Torque     | pu    | 2.0    | 1.7    | 2.5    | 1     | 0     |

**Starting Characteristics Chart**

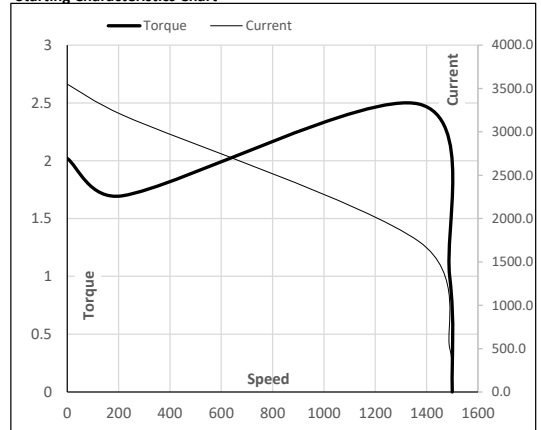

**NOTE** Refer data sheet for applicable standard and tolerances on performance parameters

Issued By  
Issued Date

Model No. TCA3152A3133GACD01

| Enclosure | U<br>(V) | Δ / Y<br>Conn | f<br>[Hz] | P<br>[kW] | P<br>[hp] | I<br>[A] | n<br>[rpm] | T<br>[kgm] | T<br>[Nm] | IE<br>Class | Amb<br>[°C] | Duty | Elevation<br>[m] | Inertia<br>[kg-m <sup>2</sup> ] | Weight<br>[kg] |
|-----------|----------|---------------|-----------|-----------|-----------|----------|------------|------------|-----------|-------------|-------------|------|------------------|---------------------------------|----------------|
| TEFC      | 415      | Δ             | 50        | 315       | 425       | 507.2    | 1490       | 207.13     | 2031.21   | IE3         | 50          | S1   | 1000             | 10.1755                         | 1947           |

Motor Speed Torque Data

| Load     |    | FL    | I <sub>1</sub> | I <sub>2</sub> | I <sub>3</sub> | I <sub>4</sub> | I <sub>5</sub> | LR |
|----------|----|-------|----------------|----------------|----------------|----------------|----------------|----|
| TWT Hot  | s  | 10000 | 50             | 35             | 29             | 23             | 18             | 15 |
| TWT Cold | s  | 10000 | 100            | 70             | 55             | 45             | 35             | 30 |
| Current  | pu | 1     | 2              | 3              | 4              | 5              | 6              | 7  |

Thermal Characteristics Chart

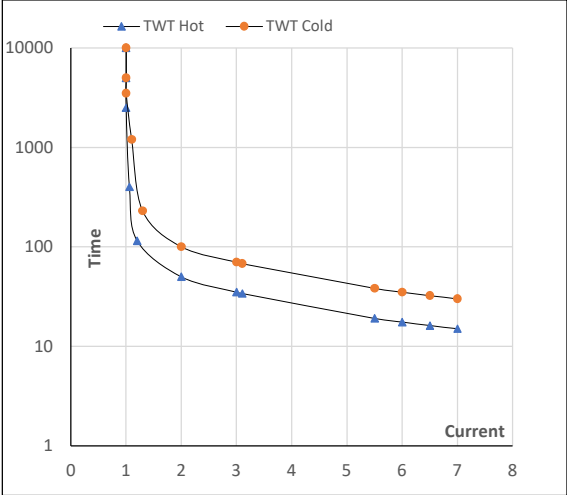

NOTE Refer data sheet for applicable standard and tolerances on performance parameters

Issued By

Issued Date

