

# PRODUCT INFORMATION PACKET



Model No: LM60039  
Catalog No: LM60039

BSOLETE-REPLACED BY 199017.00 -..15HP..1200RPM.284T.TEFC.230/460V.3PH.60HZ.CONT.40C.1.15SF.RIGID..

.....

Regal and Leeson are trademarks of Regal Rexnord Corporation or one of its affiliated companies.  
©2023 Regal Rexnord Corporation, All Rights Reserved. MC017097E





### Nameplate Specifications

Phase	3	Output HP	15 & 10 Hp
Output KW	11.2 & 7.5 kW	Voltage	208-230/460 & 190/380 V
Speed	1186 & 985 rpm	Service Factor	1.25 & 1.15
Frame	284T	Enclosure	Totally Enclosed Fan Cooled
Thermal Protection	No Protection	Efficiency	92.4 & 91.7 %
Ambient Temperature	40 °C	Frequency	60 & 50 Hz
Current	43-40.5/20.3 & 33/16.6 A	Power Factor	74.6
Duty	Continuous	Insulation Class	F
Design Code	B	KVA Code	H
Drive End Bearing Size	6311	Opp Drive End Bearing Size	6309
UL	Recognized	CSA	Y
CE	Y	IP Code	43
Number of Speeds	1		

### Technical Specifications

Electrical Type	Squirrel Cage Induction Run	Starting Method	Wye Start Delta Run
Poles	6	Rotation	Reversible
Mounting	Rigid Base	Motor Orientation	Horizontal
Drive End Bearing	Ball	Opp Drive End Bearing	Ball
Frame Material	Cast Iron	Shaft Type	T
Assembly/Box Mounting	F1/F2 CAPABLE		
Outline Drawing	16953960LN	Connection Drawing	004172.03LN

This is an uncontrolled document once printed or downloaded and is subject to change without notice. Date Created:06/23/2023

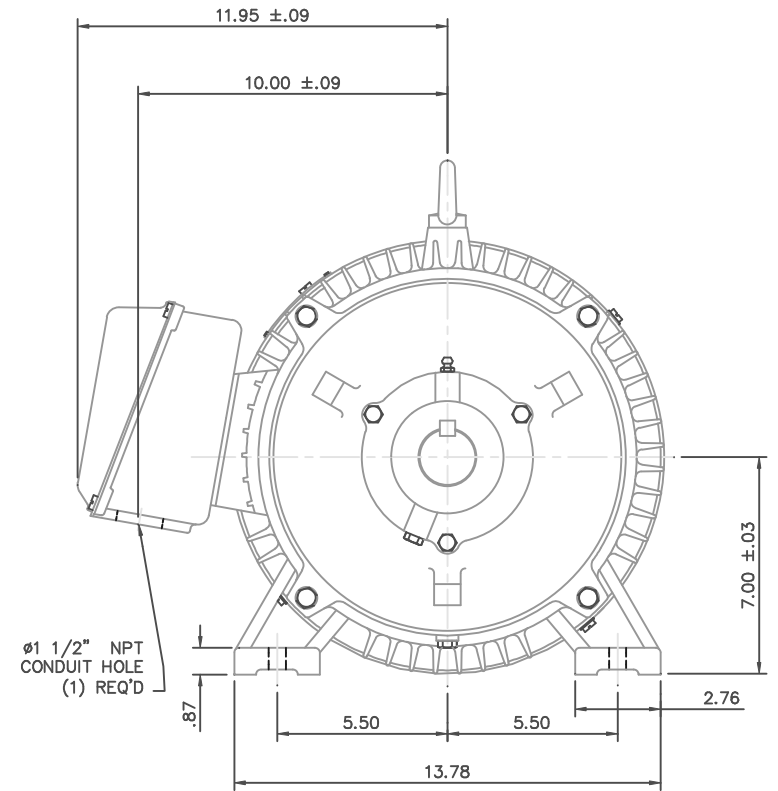
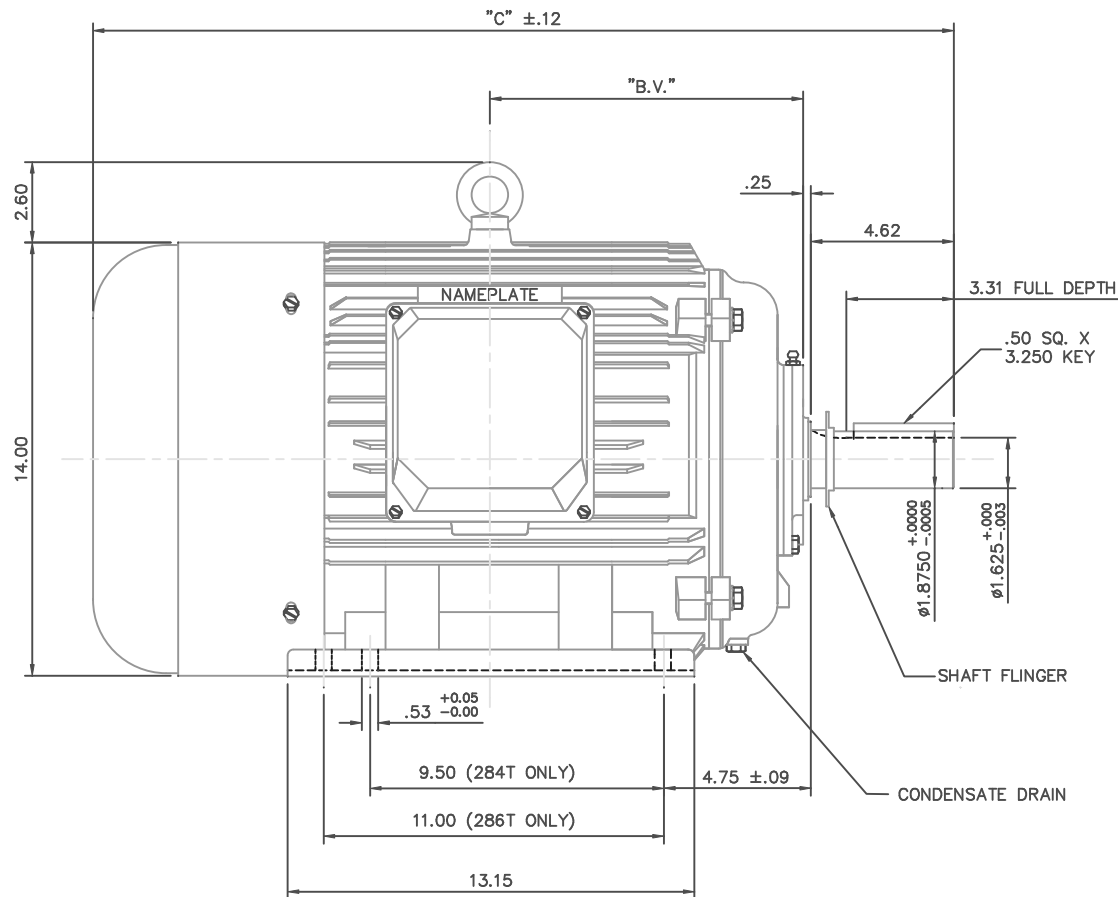

NOTE: 286T HAS 6 MTG. HOLES,  
USING 284T AND 286T LOCATIONS

FRAME DESIGN	"C"	"BV"
284T	26.26	9.65
286T	27.83	10.43

			TOLERANCES UNLESS SPECIFIED		Lincoln MOTOR	DRAWN CJK 07/016/01	
			DEC.	INCHES		CHK	
			.X	±.1		APPD	
			.XX	±.03	TITLE	OUTLINE-280T FRAME, TEFC-RIGID NEW CONDUIT BOX	SCALE 1=4
02	REDRAWN TO CURRENT CAD STANDARDS	CJK 11/1/01	.XXX	±.005	MAT'L	CAST IRON	REF
01	ADDED HOLE FOR 286T BASE	JJK 07/13/99	.XXXX	±.0005	FINISH		PREV
NO.	REVISION	BY & DATE	CHK	ANG	±1/2"	FINISH	
THIS DRAWING IN DESIGN AND DETAIL IS OUR PROPERTY AND MUST NOT BE USED EXCEPT IN CONNECTION WITH OUR WORK ALL RIGHTS OF DESIGN AND INVENTION ARE RESERVED THIS IS AN ELECTRONICALLY GENERATED DOCUMENT - DO NOT SCALE THIS PRINT			RFP		CAD FILE	16953960LN	SIZE B
			DIST				DRAWING NO. 169539-60LN
							REV. 02

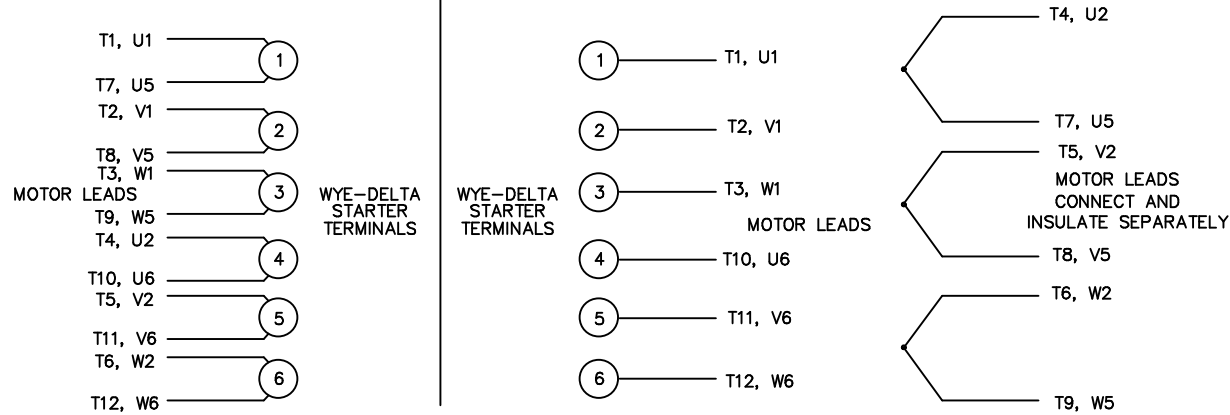
WYE – DELTA STARTING USEABLE ON 2,4 AND 6 POLE MOTORS.LOW VOLTAGE CONNECTIONHIGH VOLTAGE CONNECTION

REFER TO THE WYE-DELTA STARTER CONNECTION INSTRUCTIONS FOR PROPER CONNECTION OF POWER LINES TO STARTER.

PART WINDING START USABLE ON 4 & 6 POLE MOTORS  
LOW VOLTAGE CONNECTION ONLY

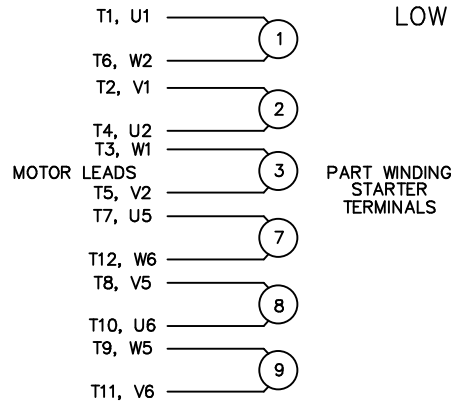

REFER TO THE PART WINDING STARTER INSTRUCTIONS FOR PROPER CONNECTION OF POWER LINES TO STARTER.

REFER TO THE CUTLER – HAMMER OR EQUIV. FOR PROPER SELECTION OF OVERLOAD HEATER COILS.

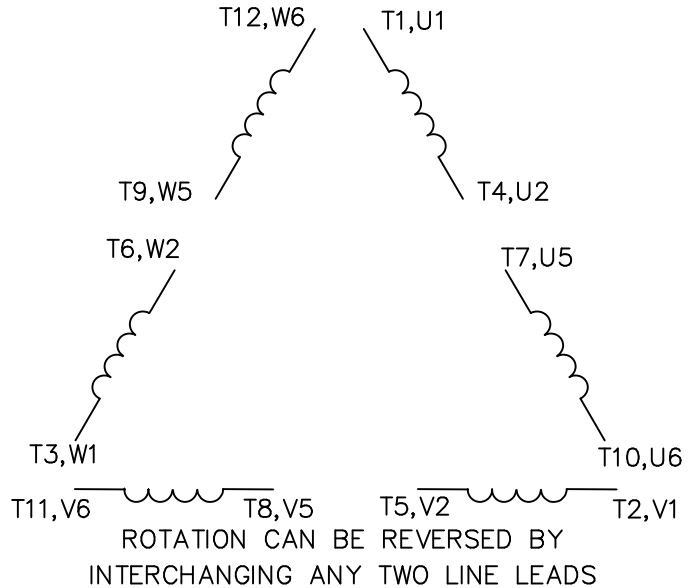
LINE LEADS

12 LEAD DELTA CONNECTION ACROSS THE LINE START  
 (FOR Y START DELTA RUN, REMOVE THE JUMPERS)

LOW VOLTAGE  
 (MUST BE REWIRED  
 AS SHOWN)

HIGH VOLTAGE  
 (FACTORY WIRED FOR HIGH  
 VOLTAGE AS SHOWN)

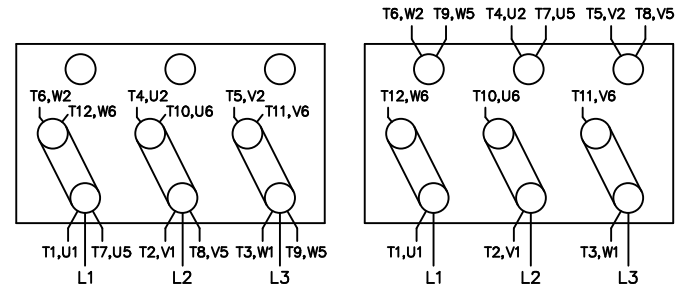

TOLERANCES  
 UNLESS SPECIFIED

DEC. INCHES

.X ±.1

.XX ±.02

.XXX ±.005

.XXXX ±.0005

ANG ±7'30"

**Lincoln**  
**MOTORS**

TITLE DELTA – WYE CONNECTION DIAGRAM  
 IEC CAST IRON MOTORS

MAT'L.

FINISH

DRAWN RJW 09-12-2005

CHK ML 09-12-2005

APPD GK 09-12-2005

SCALE

REF

FMF

PREV

NO. REVISION BY & DATE

RFP 09-12-2005

DIST WA-PR

CAD FILE 00417203LN

SIZE

A

DRAWING NO. PAGE OF

004172-03-LN

REV.