

PRODUCT INFORMATION PACKET



Model No: LM34553

Catalog No: LM34553

LM34553..125HP..3570/2965RPM.404TSC.DP.230/460//380-415V.3PH.60/50HZ.CONT.40C.1.25/1.15SF.RIGID....

.....

Regal and Leeson are trademarks of Regal Rexnord Corporation or one of its affiliated companies.

©2023 Regal Rexnord Corporation, All Rights Reserved. MC017097E





Nameplate Specifications

Phase	3	Output HP	125 & 125 Hp
Output KW	93.0 & 93.0 kW	Voltage	230/460 & 380-415 V
Speed	3570 & 2965 rpm	Service Factor	1.25 & 1.15
Frame	404TSC	Enclosure	Drip Proof
Thermal Protection	No Protection	Efficiency	95 & 94.1 %
Ambient Temperature	40 °C	Frequency	60 & 50 Hz
Current	276/138 & 166-158 A	Power Factor	90
Duty	Continuous	Insulation Class	F
Design Code	B	KVA Code	G
Drive End Bearing Size	6315	Opp Drive End Bearing Size	6313
UL	Recognized	CSA	Y
CE	Y	IP Code	22
Number of Speeds	1		

Technical Specifications

Electrical Type	Squirrel Cage Induction Run	Starting Method	Wye Start Delta Run
Poles	2	Rotation	Reversible
Resistance Main	.031 Ohms	Mounting	Rigid Base
Motor Orientation	Horizontal	Drive End Bearing	Ball
Opp Drive End Bearing	Ball	Frame Material	Rolled Steel
Shaft Type	TS	Assembly/Box Mounting	F2 ONLY
Outline Drawing	XJ2D1SC2-1735	Connection Drawing	A-EE7308AA-LN

This is an uncontrolled document once printed or downloaded and is subject to change without notice. Date Created:06/23/2023

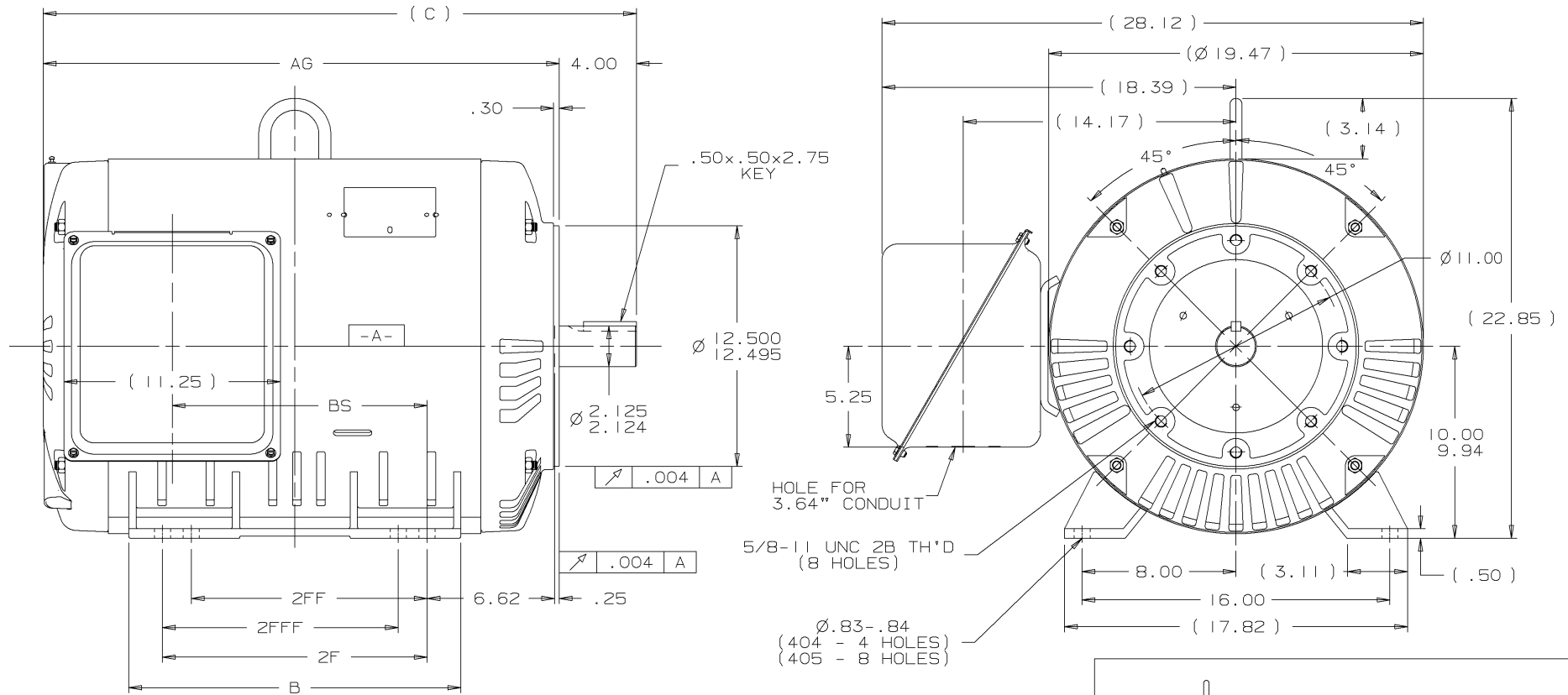

- NOTES:
1. CONDUIT BOX CAN BE ROTATED IN 90° STEPS.
 2. NAMEPLATES TO BE READ FROM CONDUIT BOX SIDE OF MOTOR.

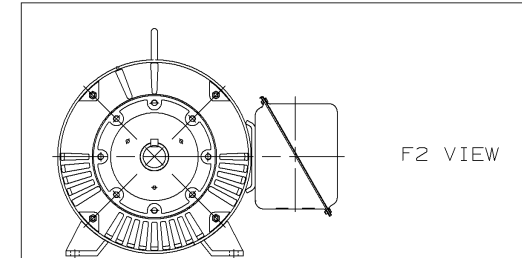

DASH	FRAME	C	AG	BS	B	2F	2FF	2FFF	REV	DATE	CHANGE	NAME	HLB	PART NAME	OUTLINE NEMA MOTORS	400TS ODP UE DE C-FACE	DRWG NO	XJ2DISC2
1735	404TS	29.16	25.16	11.75	15.75	12.25			I	09-13-2001	NEW DRAWING		HLB					
1885	405TS	30.66	26.66	13.25	17.25	13.75	12.25	12.25										

Lincoln
MOTORS

UNLESS OTHERWISE SPECIFIED DIMENSIONS ARE IN INCHES TOL. ON XX±.02 XXX±.005 XXXX±.0005 ANGLES± 7'30"			
✓	MAX. SURFACE ROUGHNESS UNLESS OTHERWISE NOTED	DRAWN BY	HLB
	FINISH	CHKD BY	ML
	MATERIAL	APPD BY	HNH

DISTRIBUTION WA - LB - WP - BY CADD FILE NO. XJ2DISC2

T12 _____
 T1 _____
 T6 _____ L1
 T7 _____

T2 _____
 T4 _____
 T8 _____ L2
 T10 _____

T3 _____
 T5 _____
 T9 _____ L3
 T11 _____

LOW VOLTAGE

T12 _____ L1
 T1 _____

T4 _____
 T7 _____

T2 _____ L2
 T10 _____

T5 _____
 T8 _____

T3 _____ L3
 T11 _____

T6 _____
 T9 _____

HIGH VOLTAGE

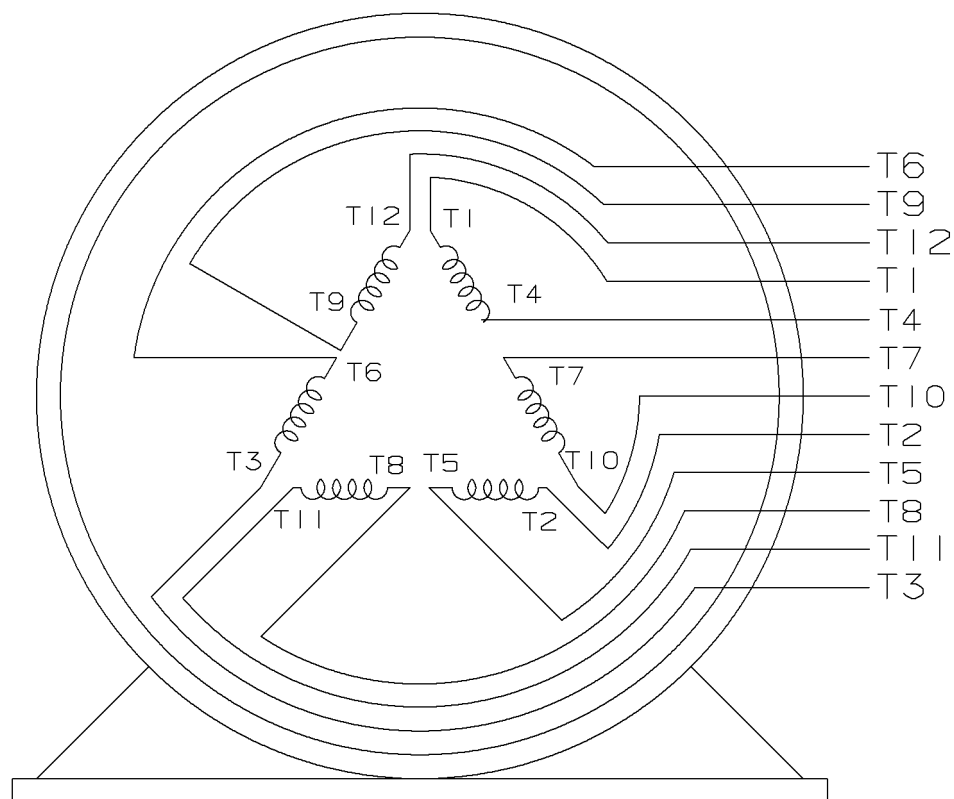

VIEW OF TERMINAL END

					✓ UNLESS OTHERWISE SPECIFIED DIMENSIONS ARE IN INCHES TOL. ON XX±.02 XXX±.005 XXXX±.0005 ANGLES± 7°30"		
2	08-09-1999	RE-ISSUE, ADDED '-' TO PART NUMBER	BLR		MAX. SURFACE ROUGHNESS UNLESS OTHERWISE NOTED		DRAWN BY TRB 07-16-1999
					FINISH		CHKD BY ML 06-18-1999
1	06-18-1999	NEW DRAWING	TRB		MATERIAL		APPD BY GK 06-18-1999
REV	DATE	CHANGE	NAME	PART NAME 3 PHASE CONNECTION DIAGRAM 2/1 DELTA - 12 LEADS			DRWG NO A- EE7308AA-LN
				PURCHASED	CADD FILE NO.	EE7308AALN	

ERROR: undefined
OFFENDING COMMAND: Pscrip

STACK: