

PRODUCT INFORMATION PACKET



Model No: LM34258
Catalog No: LM34258

LM34258..25HP..1775/1470RPM.284T.DP.230/460//200/400VAC.3PH.60/50HZ.CONT.40C.1.25/1.15SF.RIGID.....

.....

Regal and Leeson are trademarks of Regal Rexnord Corporation or one of its affiliated companies.
©2023 Regal Rexnord Corporation, All Rights Reserved. MC017097E





Nameplate Specifications

Phase	3	Output HP	25 & 25 Hp
Output KW	18.7 & 18.7 kW	Voltage	230/460 & 200/400 V
Speed	1775 & 1470 rpm	Service Factor	1.25 & 1.15
Frame	284T	Enclosure	Drip Proof
Thermal Protection	No Protection	Efficiency	93.6 & 92.4 %
Ambient Temperature	40 °C	Frequency	60 & 50 Hz
Current	64/32 & 74/37 A	Power Factor	78
Duty	Continuous	Insulation Class	H
Design Code	B	KVA Code	G
Drive End Bearing Size	6311	Opp Drive End Bearing Size	6210
UL	Recognized	CSA	Y
CE	Y	IP Code	23
Number of Speeds	1		

Technical Specifications

Electrical Type	Squirrel Cage Induction Run	Starting Method	Wye Start Delta Run
Poles	4	Rotation	Reversible
Resistance Main	65 Ohms	Mounting	Rigid Base
Motor Orientation	Horizontal	Drive End Bearing	Ball
Opp Drive End Bearing	Ball	Frame Material	Cast Iron
Shaft Type	T	Assembly/Box Mounting	F1/F2 CAPABLE
Outline Drawing	B-SS207936LN-1325	Connection Drawing	A-EE7358-LN

This is an uncontrolled document once printed or downloaded and is subject to change without notice. Date Created:06/22/2023

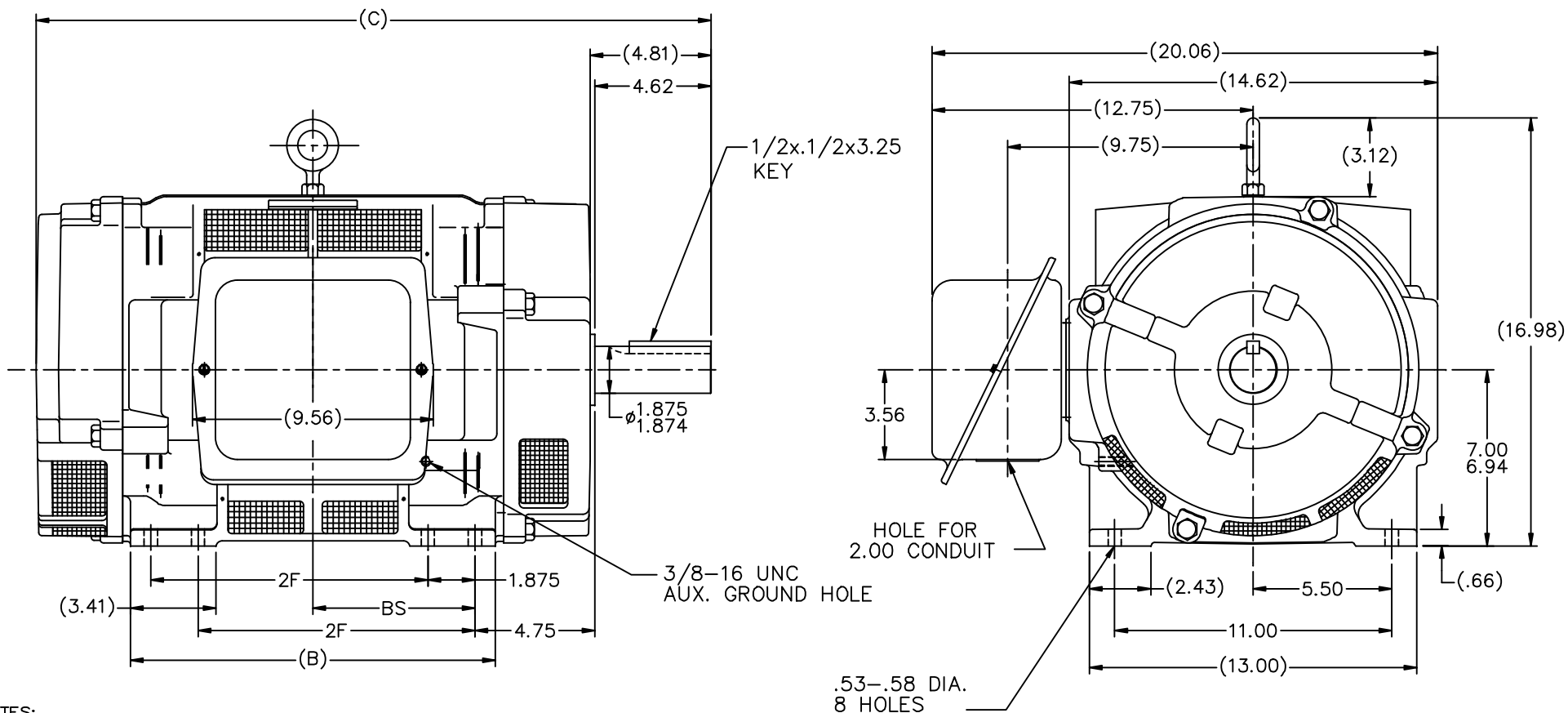

- NOTES:
1. CONDUIT BOX CAN BE ROTATED IN 90° STEPS.
 2. CONDUIT BOX CAN BE MOUNTED ON OPPOSITE SIDE BY REMOVING BRACKETS AND TURNING FRAME 180°.
 3. NAMEPLATE TO BE READ FROM CONDUIT BOX SIDE OF MOTOR.

DASH	FRAME	B	C	2F	BS
1325	284T	12.63	24.94	9.50	5.50
1512	286T	14.50	26.81	11.00	6.44

		TOLERANCES UNLESS SPECIFIED		Lincoln MOTORS		DRAWN KS 12-27-2011	
		DEC.	INCHES			CHK SJW 12-28-2011	
		.X	±.1			APPD MJS 12-28-2011	
		.XX	±.02	TITLE OUTLINE		SCALE 1=4	
		.XXX	±.005	280 FR. - TS - DR.PR. - CAST IRON		REF SS207936	
		.XXXX	±.0005	MAT'L		FMF MUB2155	
NO.	REVISION	BY & DATE	CHK	ANG	FINISH	PREV	
THIS DRAWING IN DESIGN AND DETAIL IS OUR PROPERTY AND MUST NOT BE USED EXCEPT IN CONNECTION WITH OUR WORK ALL RIGHTS OF DESIGN AND INVENTION ARE RESERVED THIS IS AN ELECTRONICALLY GENERATED DOCUMENT - DO NOT SCALE THIS PRINT				RFP	12-28-2011	CAD FILE SS207936	SIZE B
				DIST	LB	DRAWING NO. SS207936LN	PAGE OF REV.

WYE START

HIGH VOLTAGE

DELTA RUN

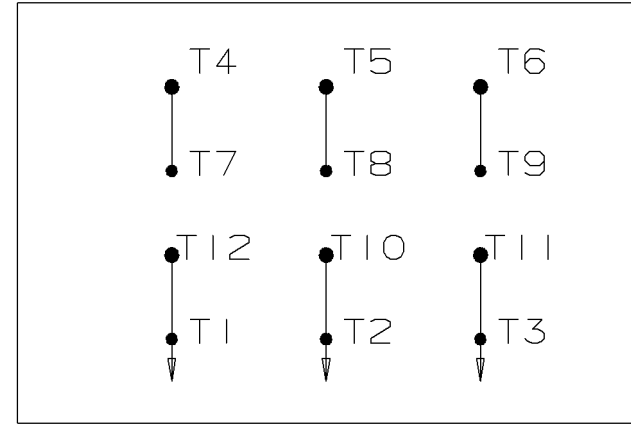
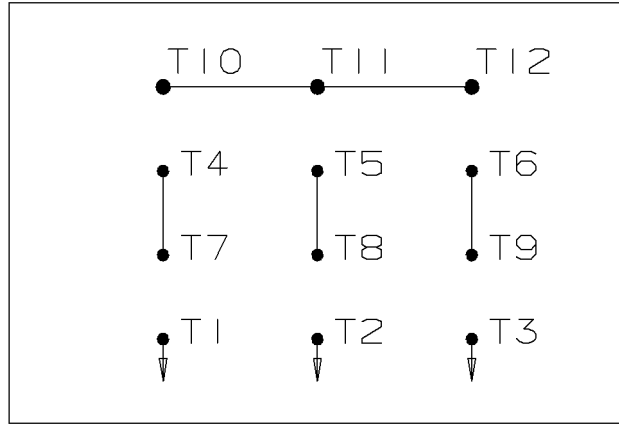

WYE START

LOW VOLTAGE

DELTA RUN

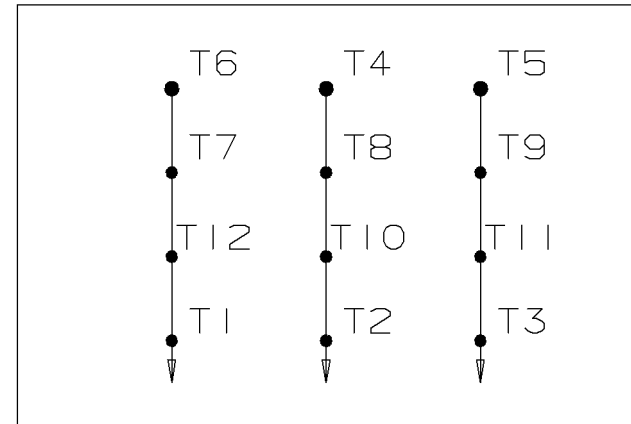
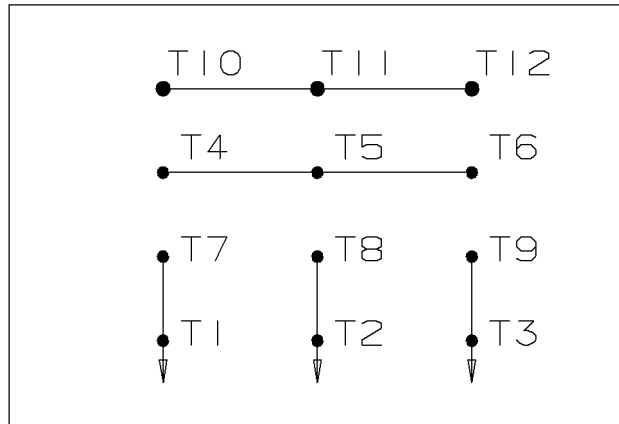

4/2 CKTY Δ

					<input checked="" type="checkbox"/> UNLESS OTHERWISE SPECIFIED DIMENSIONS ARE IN INCHES TOL. ON XX± .02 XXX± .005 XXXX± .0005 ANGLES± 7°30"			
						MAX. SURFACE ROUGHNESS UNLESS OTHERWISE NOTED	DRAWN BY DRS	12-07-1999
				FINISH		CHKD BY ML	12-07-1999	
				MATERIAL		APPD BY TB	12-07-1999	
REV	DATE	CHANGE	NAME	PART NAME CONNECTION DIAGRAM			DRWG NO A- EE7358-LN	
					PURCHASED	CADD FILE NO.	EE7358-LN	