

PRODUCT INFORMATION PACKET

Model No: LM21391

Catalog No: LM21391

Automotive Duty Motor, 60 HP, 3 Ph, 60 Hz, 460 V, 1800 RPM, 405U Frame, TEFC



Regal and are trademarks of Regal Rexnord Corporation or one of its affiliated companies.
©2022 Regal Rexnord Corporation, All Rights Reserved. MC017097E

Nameplate Specifications

Output HP	60 Hp	Output KW	45.0 kW
Frequency	60 Hz	Voltage	460 V
Current	67.5 A	Speed	1780 rpm
Service Factor	1	Phase	3
Efficiency	95 %	Power Factor	87.5
Duty	Continuous	Insulation Class	F
Design Code	B	KVA Code	G
Frame	405U	Enclosure	Totally Enclosed Fan Cooled
Thermal Protection	No Protection	Ambient Temperature	65 °C
Drive End Bearing Size	316	Opp Drive End Bearing Size	313
UL	Recognized	CSA	Y
CE	Y	IP Code	43
Number of Speeds	1		

Technical Specifications

Electrical Type	Squirrel Cage Induction Run	Starting Method	Across The Line
Poles	4	Rotation	Reversible
Resistance Main	.095 Ohms	Mounting	Rigid Base
Motor Orientation	Horizontal	Drive End Bearing	Ball
Opp Drive End Bearing	Ball	Frame Material	Cast Iron
Shaft Type	U	Overall Length	37.00 in
Frame Length	16.75 in	Shaft Diameter	2.375 in
Shaft Extension	7.12 in	Assembly/Box Mounting	F1/F2 CAPABLE
Connection Drawing	A-EE7300U-LN	Outline Drawing	B-SS514649LN-1675

This is an uncontrolled document once printed or downloaded and is subject to change without notice. Date Created:09/07/2022

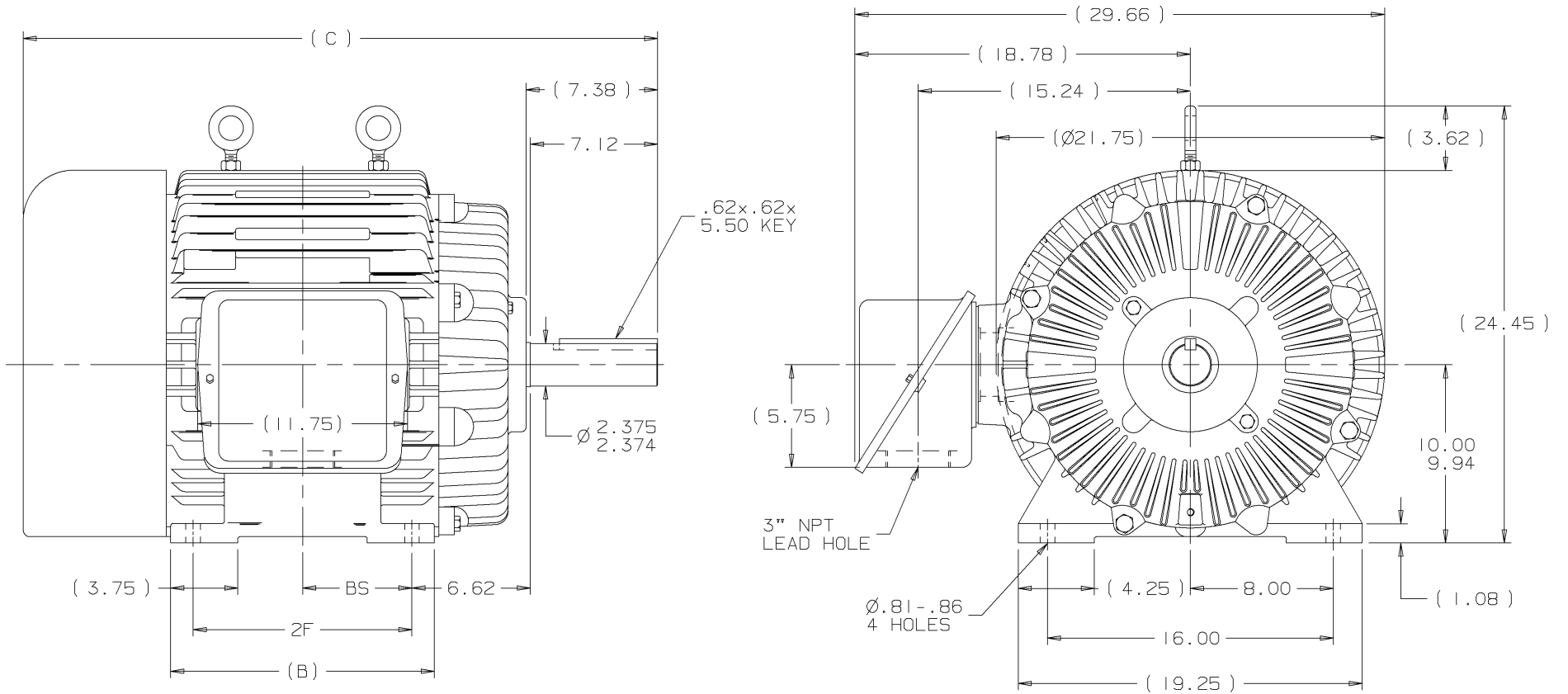

NOTES:

1. CONDUIT BOX CAN BE ROTATED IN 90° STEPS.
2. CONDUIT BOX CAN BE MOUNTED ON OPPOSITE SIDE BY REMOVING BRACKETS AND TURNING FRAME 180°.
3. NAMEPLATE TO BE READ FROM CONDUIT BOX SIDE OF MOTOR.

DASH	FRAME	B	C	2F	BS	REV	DATE	CHANGE	NAME	PART NAME	DRWG NO
1525	404U	14.75	35.50	12.25	6.12	I	03-02-2001	NEW DRAWING	KL	400U FR. - TEFC - TAPPED LEAD HOLE	B-SS514649LN
1675	405U	16.25	37.00	13.75	6.88						



UNLESS OTHERWISE SPECIFIED DIMENSIONS ARE IN INCHES
 TOL. ON XX±.03 XXX±.005 XXXX±.0005 ANGLES± 7'30"
 MAX. SURFACE ROUGHNESS UNLESS OTHERWISE NOTED
 FINISH
 MATERIAL
 DRAWN BY KL 03-02-2001
 CHKD BY DJK 03-02-2001
 APPD BY JES 03-02-2001

PURCHASED | L | DISTRIBUTION WA - LB - WP - LN - BY | CADD FILE NO. | SS514649LN

ERROR: undefined
OFFENDING COMMAND: Pscript

STACK:

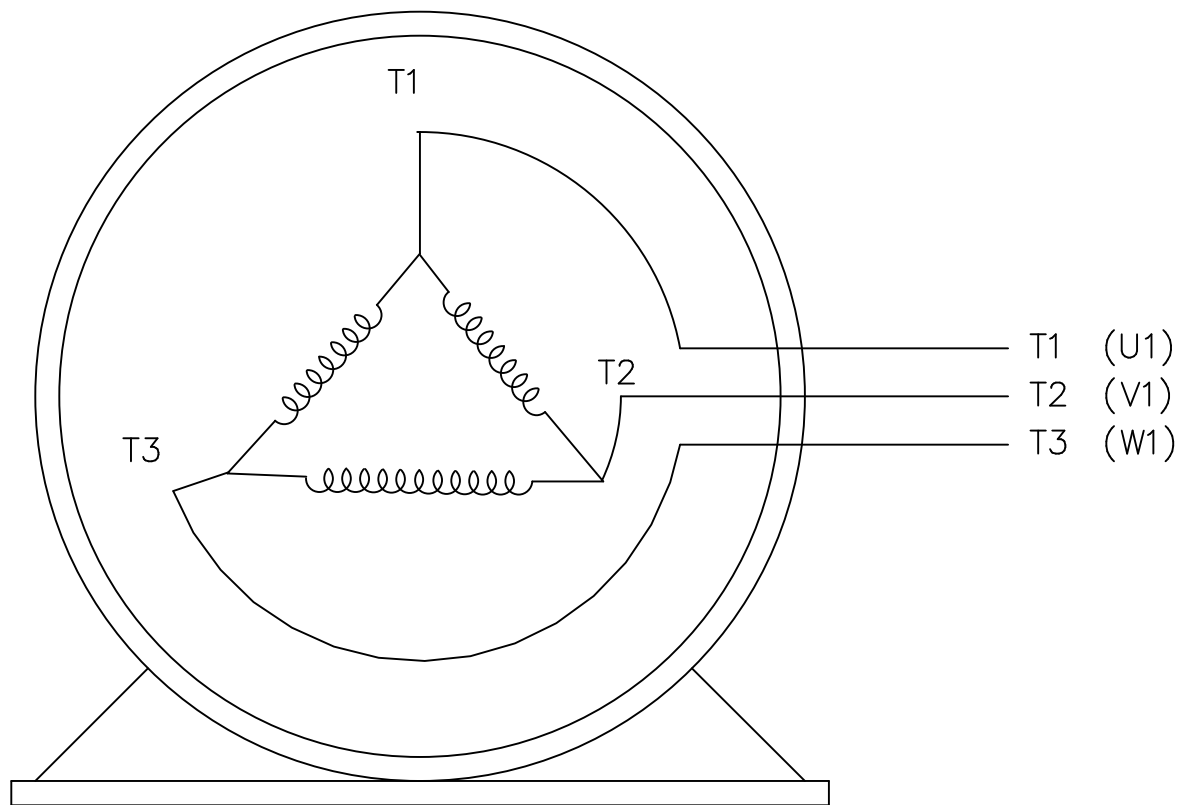
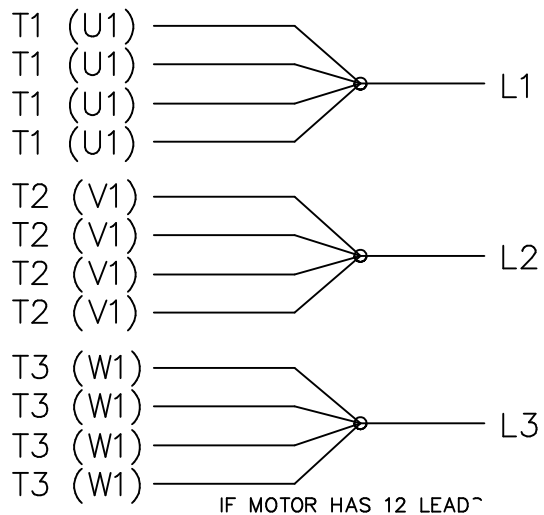
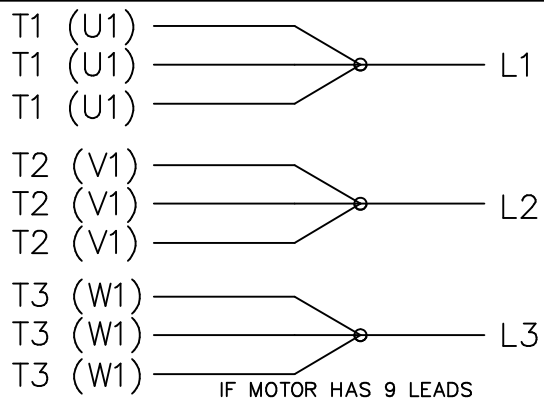
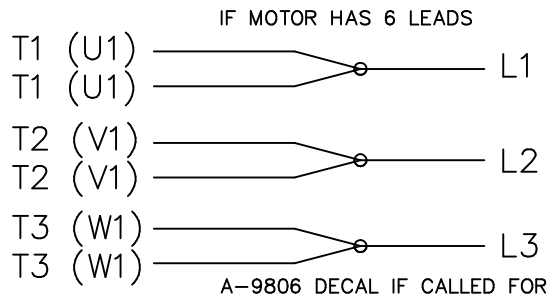

VIEW OF TERMINAL END

				TOLERANCES UNLESS SPECIFIED			DRAWN KL 12-06-2000
				DEC.	INCHES		CHK DJK 12-06-2000
				.X	±.1		APPD DJK 12-06-2000
				.XX	±.02		SCALE
2	ADDED TABLES	CN39272	RJW 06-03-2005	ML	.XXX ±.005	TITLE EXTERNAL CONNECTION DIAGRAM 3Ø SINGLE VOLTAGE DELTA	REF
1	NEW DRAWING	MU34873	KL 12-06-2000		.XXXX ±.0005	MAT'L.	FMF
NO.	REVISION	BY & DATE	CHK	ANG	±7'30"	FINISH	PREV
THIS DRAWING IN DESIGN AND DETAIL IS OUR PROPERTY AND MUST NOT BE USED EXCEPT IN CONNECTION WITH OUR WORK ALL RIGHTS OF DESIGN AND INVENTION ARE RESERVED THIS IS AN ELECTRONICALLY GENERATED DOCUMENT - DO NOT SCALE THIS PRINT				RFP	CAD FILE EE7300U_LN		SIZE A
				DIST LE			DRAWING NO. EE7300U-LN
						PAGE OF	REV. 2



CERTIFICATION DATA SHEET

**2100 WASHINGTON ST.
GRAFTON, WI
PH. 262-277-8810**

CONN. DIAGRAM: A-EE7300U-LN

OUTLINE: B-SS514649LN-1675

CATALOG : LM21391

WINDING #: T4054125 5

MOUNTING: F1/F2 CAPABLE

TYPICAL MOTOR PERFORMANCE DATA

HP	kW	SYNC. RPM	F.L. RPM	FRAME	ENCLOSURE	KVA CODE	DESIGN
60	45.0	1800	1780	405U	TEFC	G	B

PH	Hz	VOLTS	AMPS	START TYPE	DUTY	INSL	S.F.	AMB°C
3	60	460	67.5	ACROSS THE LINE	CONTINUOUS	F1	1.0	65

FULL LOAD EFF:	95	3/4 LOAD EFF:	95	1/2 LOAD EFF:	94.5	GTD. EFF	94.5	ELEC. TYPE	SQ CAGE IND RUN
FULL LOAD PF:	87.5	3/4 LOAD PF:	85	1/2 LOAD PF:	79				

F.L. TORQUE	LOCKED ROTOR AMPS	L.R. TORQUE	B.D. TORQUE	F.L. RISE°C
177 LB-FT	435	255 LB-FT 144 %	440 LB-FT 249 %	48

SOUND PRESSURE @ 3 FT.	SOUND POWER	ROTOR WK^2	MAX. WK^2	SAFE STALL TIME	STARTS / HOUR	APPROX. MOTOR WGT
66 dBA	76 dBA	23 LB-FT^2	- LB-FT^2	30 SEC.	-	1100 LBS.

***** SUPPLEMENTAL INFORMATION *****

DE BRACKET TYPE	ODE BRACKET TYPE	MOUNT TYPE	ORIENTATION	SEVERE DUTY	HAZARDOUS LOCATION	DRIP COVER	SCREENS	PAINT
STANDARD	STANDARD	RIGID	HORIZONTAL	FALSE	NONE	FALSE	NONE	GRAY - LINCOLN

BEARINGS		GREASE	SHAFT TYPE	SPECIAL DE	SPECIAL ODE	SHAFT MATERIAL	FRAME MATERIAL
DE	ODE	POLYREX EM	U	NONE	NONE	1045 HOT ROLLED (C-204)	CAST IRON
BALL	BALL						
316	313						

THERMO-PROTECTORS				THERMISTORS	CONTROL	SPACE HEATERS
THERMOSTATS	PROTECTORS	WDG RTDs	BRG RTDs	NONE	FALSE	NONE VOLTS
NONE	NOT	NONE	NONE			

*
N
O
T
E
S
*

INVERTER TORQUE: NONE
INV. HP SPEED RANGE: NONE
ENCODER: NONE NONE NONE NONE NONE PPR
BRAKE: NONE NONE NONE P/N NONE NONE NONE NONE FT-LB NONE V NONE Hz

Data Sheet

Date: 1/31/2018

LM21391



Data @ **460 V**

Motor Load Data

Load	0%	25%	50%	75%	100%	115%	125%	LR
Current (Amps)	19.5	25.5	37.5	52.0	67.5	77.5	84.5	435
Torque (ft-lb)	0.00	44.0	88.0	132	177	204	222	255
RPM	1800	1795	1790	1785	1780	1.778	1775	0
Efficiency (%)		91.7	94.5	95.0	95.0	94.5	94.1	
P.F. (%)	4.5	59.0	79.0	85.0	87.5	88.0	88.0	25.0

Motor Speed Data

	LR	Pull-Up	BD	Rated	Idle
Speed (RPM)	0	900	1700	1780	1800
Current (Amps)	435	400	250	67.5	19.5
Torque (ft-lb)	255	225	440	177	0.00

Information Block				
HP	60.0			
Sync. RPM	1800			
Frame	404			
Enclosure	TEFC			
Construction	TFS			
Voltage	460 V			
Frequency	60 Hz			
Design	A			
LR Code letter	G			
Service Factor	1.15			
Temp Rise @ FL	48 °C			
Duty	CONT			
Ambient	40 °C			
Elevation	1,000 feet			
Rotor/Shaft wk ²	23.0 Lb-Ft ²			
Ref Wdg	T4054125 NONE			
Sound Pressure @ 1M	75 dBA			
VFD Rating	NONE			
Outline Dwg	B-SS514649LN-1675			
Conn. Diag	A-EE7300U-LN			
Additional Specifications:				
0				
0				
EQUIV CKT (OHMS / PHASE)				
R1	R2	X1	X2	Xm
0.0600	0.0410	0.4720	0.3860	13.2440

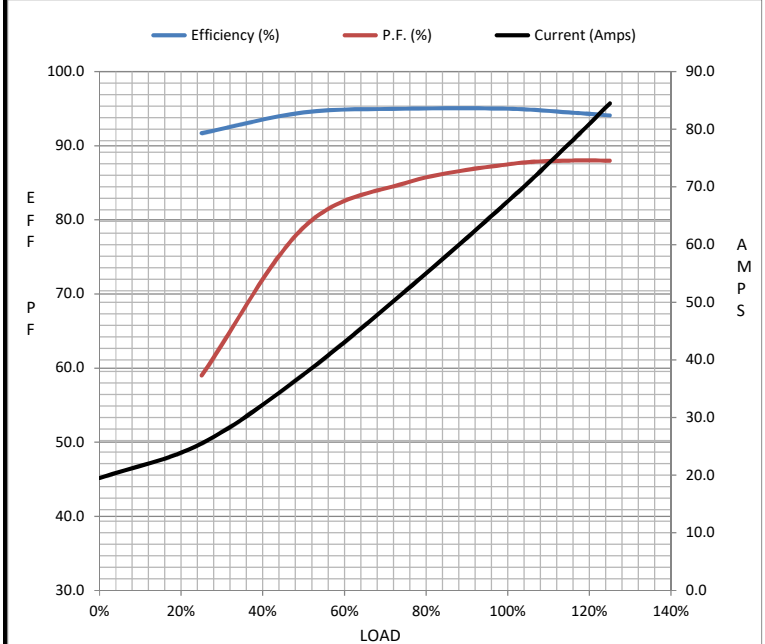

Speed - Torque Curve

