

PRODUCT INFORMATION PACKET



Model No: LM17388

Catalog No: LM17388

General Purpose Motor, 125 & 125 HP, 3 Ph, 60 & 50 Hz, 230/460 & 380-415 V, 3600 & 3000 RPM,
404TSC Frame, DP



Regal and Leeson are trademarks of Regal Rexnord Corporation or one of its affiliated companies.

©2023 Regal Rexnord Corporation, All Rights Reserved. MC017097E





Nameplate Specifications

Phase	3	Output HP	125 & 125 Hp
Output KW	93.3 & 93.3 kW	Voltage	230/460 & 380-415 V
Speed	3570 & 2965 rpm	Service Factor	1.25 & 1.15
Frame	404TSC	Enclosure	Drip Proof
Thermal Protection	No Protection	Efficiency	95 & 94.1 %
Ambient Temperature	40 °C	Frequency	60 & 50 Hz
Current	276/138 & 166-158 A	Power Factor	90
Duty	Continuous	Insulation Class	F
Design Code	B	KVA Code	G
Drive End Bearing Size	315	Opp Drive End Bearing Size	313
UL	Recognized	CSA	Y
CE	Y	IP Code	22
Number of Speeds	1		

Technical Specifications

Electrical Type	Squirrel Cage Induction Run	Starting Method	Wye Start Delta Run
Poles	2	Rotation	Reversible
Resistance Main	.031 Ohms	Mounting	Rigid Base
Motor Orientation	Horizontal	Drive End Bearing	Ball
Opp Drive End Bearing	Ball	Frame Material	Rolled Steel
Shaft Type	TS	Overall Length	29.16 in
Frame Length	17.35 in	Shaft Diameter	2.125 in
Shaft Extension	4.25 in	Assembly/Box Mounting	F1 ONLY
Outline Drawing	XJ2D1SC2-1735	Connection Drawing	A-EE7308AA-LN

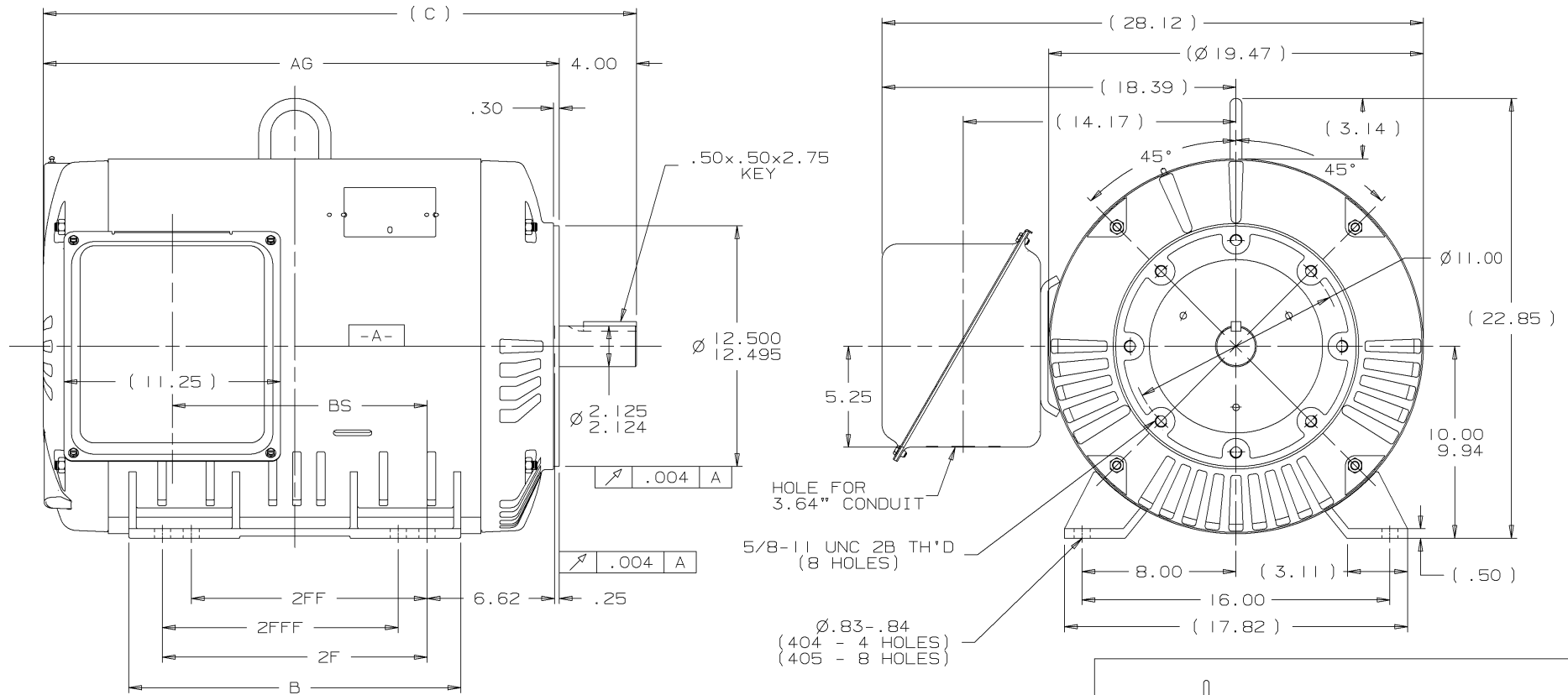

- NOTES:
1. CONDUIT BOX CAN BE ROTATED IN 90° STEPS.
 2. NAMEPLATES TO BE READ FROM CONDUIT BOX SIDE OF MOTOR.

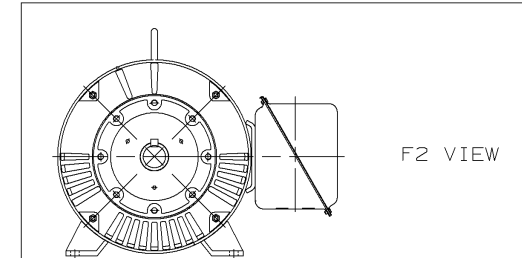

DASH	FRAME	C	AG	BS	B	2F	2FF	2FFF	REV	DATE	CHANGE	NAME	HLB	PART NAME	OUTLINE NEMA MOTORS	DRWG NO
1735	404TS	29.16	25.16	11.75	15.75	12.25			I	09-13-2001	NEW DRAWING		HLB	400TS ODP UE DE C-FACE		XJ2DISC2
1885	405TS	30.66	26.66	13.25	17.25	13.75	12.25	12.25	REV	DATE	CHANGE	NAME		DISTRIBUTION	W A - L B - W P - BY	CADD FILE NO. XJ2DISC2

Lincoln
MOTORS

UNLESS OTHERWISE SPECIFIED DIMENSIONS ARE IN INCHES TOL. ON XX±.02 XXX±.005 XXXX±.0005 ANGLES± 7'30"			
MAX. SURFACE ROUGHNESS UNLESS OTHERWISE NOTED		DRAWN BY	HLB
FINISH		CHKD BY	ML
MATERIAL		APPD BY	HNH

T12 _____
 T1 _____
 T6 _____ L1
 T7 _____

T2 _____
 T4 _____
 T8 _____ L2
 T10 _____

T3 _____
 T5 _____
 T9 _____ L3
 T11 _____

LOW VOLTAGE

T12 _____ L1
 T1 _____

T4 _____
 T7 _____

T2 _____ L2
 T10 _____

T5 _____
 T8 _____

T3 _____ L3
 T11 _____

T6 _____
 T9 _____

HIGH VOLTAGE

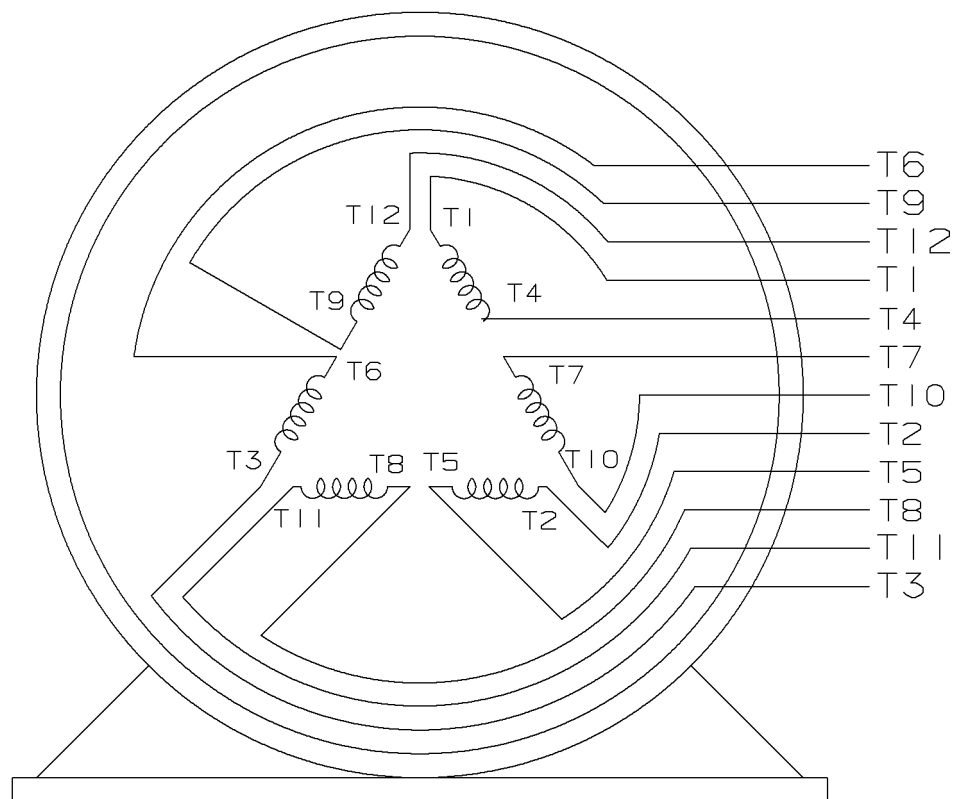

VIEW OF TERMINAL END

					✓ UNLESS OTHERWISE SPECIFIED DIMENSIONS ARE IN INCHES TOL. ON XX±.02 XXX±.005 XXXX±.0005 ANGLES± 7°30"		
2	08-09-1999	RE-ISSUE, ADDED '-' TO PART NUMBER	BLR		MAX. SURFACE ROUGHNESS UNLESS OTHERWISE NOTED		DRAWN BY TRB 07-16-1999
					FINISH		CHKD BY ML 06-18-1999
1	06-18-1999	NEW DRAWING	TRB		MATERIAL		APPD BY GK 06-18-1999
REV	DATE	CHANGE	NAME	PART NAME 3 PHASE CONNECTION DIAGRAM 2/1 DELTA - 12 LEADS			DRWG NO A- EE7308AA-LN
				PURCHASED	CADD FILE NO.	EE7308AALN	

ERROR: undefined
OFFENDING COMMAND: Pscrip

STACK:



**2100 WASHINGTON ST.
GRAFTON, WI
PH. 262-277-8810**

CERTIFICATION DATA SHEET

CONN. DIAGRAM: A-EE7308AA-LN

CATALOG #: LM17388

OUTLINE: XJ2D1SC2-1735

WINDING #: L4042005 1

MOUNTING: F1 ONLY

TYPICAL MOTOR PERFORMANCE DATA

HP	kW	SYNC. RPM	F.L. RPM	FRAME	ENCLOSURE	KVA CODE	DESIGN
125&125	93.3&93.3	3600	3570&2965	404TSC	DP	G	B

PH	Hz	VOLTS	AMPS	START TYPE	DUTY	INSL	S.F.	AMB°C
3	60/50	230/460&380-415	276/138&166-158	WYE START DELTA RUN	CONTINUOUS	F4	1.25/1.15	40

FULL LOAD EFF:	95&94.1	3/4 LOAD EFF:	94.5	1/2 LOAD EFF:	93	GTD. EFF		ELEC. TYPE
FULL LOAD PF:	90&90	3/4 LOAD PF:	89.5	1/2 LOAD PF:	85	94.1		SQ CAGE IND RUN

F.L. TORQUE	LOCKED ROTOR AMPS	L.R. TORQUE	B.D. TORQUE	F.L. RISE°C
184 LB-FT	1814 / 907	280 LB-FT 152 %	525 LB-FT 285 %	45

SOUND PRESSURE @ 3 FT.	SOUND POWER	ROTOR WK^2	MAX. WK^2	SAFE STALL TIME	STARTS / HOUR	APPROX. MOTOR WGT
- dBA	- dBA	13.5 LB-FT^2	- LB-FT^2	- SEC.	-	- LBS.

***** SUPPLEMENTAL INFORMATION *****

DE BRACKET TYPE	ODE BRACKET TYPE	MOUNT TYPE	ORIENTATION	SEVERE DUTY	HAZARDOUS LOCATION	DRIP COVER	SCREENS	PAINT
C-FACE	STANDARD	RIGID	HORIZONTAL	FALSE	NONE	FALSE	NONE	GRAY - LINCOLN

BEARINGS		GREASE	SHAFT TYPE	SPECIAL DE	SPECIAL ODE	SHAFT MATERIAL	FRAME MATERIAL
DE	ODE						
BALL	BALL	POLYREX EM	TS	NONE	NONE	1045 HOT ROLLED (C-204)	ROLLED STEEL
315	313						

THERMO-PROTECTORS				THERMISTORS	CONTROL	SPACE HEATERS
THERMOSTATS	PROTECTORS	WDG RTDs	BRG RTDs			
NONE	NOT	NONE	NONE	NONE	FALSE	NONE VOLTS

*

N

O

T

E

S

*

INVERTER TORQUE:	NONE
INV. HP SPEED RANGE:	NONE
ENCODER:	NONE
	NONE NONE
	NONE NONE PPR
BRAKE:	NONE NONE
	NONE P/N NONE
	NONE NONE
	NONE FT-LB NONE V NONE Hz

Data Sheet

Date: 1/24/2018

LM17388



Data @ 460 V

Motor Load Data

Load	0%	25%	50%	75%	100%	115%	125%	LR	
Current (Amps)	36.0	49.5	75.0	105	138	158	170	907	
Torque (ft-lb)	0.00	45.5	91.5	138	184	212	230	280	
RPM	3600	3595	3585	3580	3570	3,565	3562	0	
Efficiency (%)		89.5	93.0	94.5	95.0	95.0	94.5		
P.F. (%)	9.5	69.5	85.0	89.5	90.0	91.0	91.5	27.0	

Motor Speed Data

	LR	Pull-Up	BD	Rated	Idle
Speed (RPM)	0	1800	3425	3570	3600
Current (Amps)	907	875	575	138	36.0
Torque (ft-lb)	280	250	525	184	0.00

Information Block

HP	125.0			
Sync. RPM	3600			
Frame	404			
Enclosure	DP			
Construction	TDR			
Voltage	230/460#380-415	V		
Frequency	60	Hz		
Design	A			
LR Code letter	G			
Service Factor	1.15			
Temp Rise @ FL	45	° C		
Duty	CONT			
Ambient	40	° C		
Elevation	1,000	feet		
Rotor/Shaft wk²	13.5	Lb-Ft²		
Ref Wdg	L4042005	NONE		
Sound Pressure @ 1M	999	dBA		
VFD Rating	NONE			
Outline Dwg	XJ2D1SC2-1735			
Conn. Diag	A-EE7308AA-LN			
Additional Specifications:				
0				
0				
EQUIV CKT (OHMS / PHASE)				
R1	R2	X1	X2	Xm
0.0250	0.0150	0.2170	0.1330	7.6430

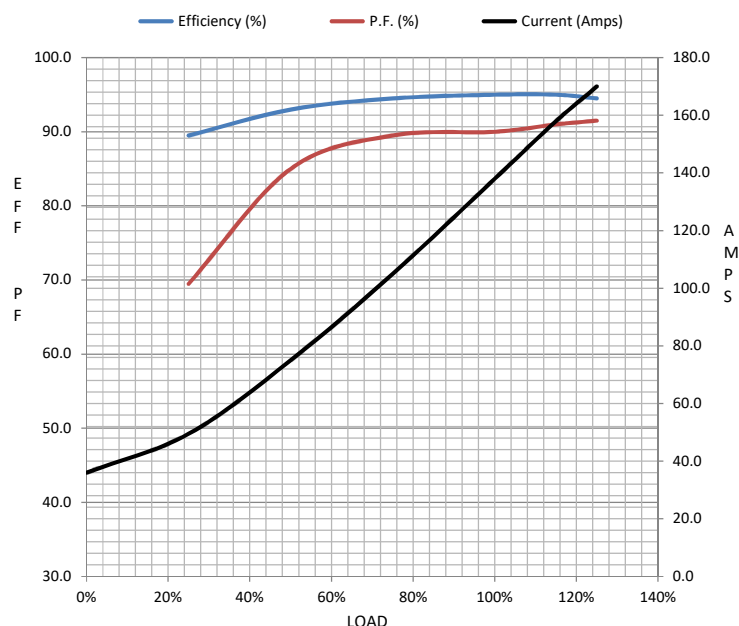

Speed - Torque Curve

