

# PRODUCT INFORMATION PACKET



Model No: LM13840  
Catalog No: LM13840  
60 HP General Purpose Motor, 3 phase, 3600 RPM, 230/460 V, 326TSC Frame, ODP  
General Purpose Motors



Regal and Leeson are trademarks of Regal Rexnord Corporation or one of its affiliated companies.  
©2021 Regal Rexnord Corporation, All Rights Reserved. MC017097E





### Nameplate Specifications

Output HP	60 Hp	Output KW	45.0 kW
Frequency	60 Hz	Voltage	230/460 V
Current	136.0/68.0 A	Speed	3550 rpm
Service Factor	1.25	Phase	3
Efficiency	93.6 %	Power Factor	88.5
Duty	Continuous	Insulation Class	F
Design Code	B	KVA Code	F
Frame	326TSC	Enclosure	Drip Proof
Thermal Protection	No	Ambient Temperature	40 °C
Drive End Bearing Size	6311	Opp Drive End Bearing Size	6309
UL	Recognized	CSA	Y
CE	Y	IP Code	22
Number of Speeds	1		

### Technical Specifications

Electrical Type	Squirrel Cage Induction Run	Starting Method	Wye Start Delta Run
Poles	2	Rotation	Reversible
Resistance Main	.13 Ohms	Mounting	Rigid Base
Motor Orientation	Horizontal	Drive End Bearing	Ball
Opp Drive End Bearing	Ball	Frame Material	Rolled Steel
Shaft Type	TS	Overall Length	25.91 in
Frame Length	16.57 in	Shaft Diameter	1.875 in
Shaft Extension	3.75 in	Assembly/Box Mounting	F1 ONLY
Connection Drawing	A-EE7308AA-LN	Outline Drawing	XG2D1SC2-1657

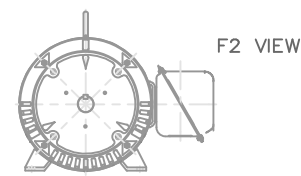
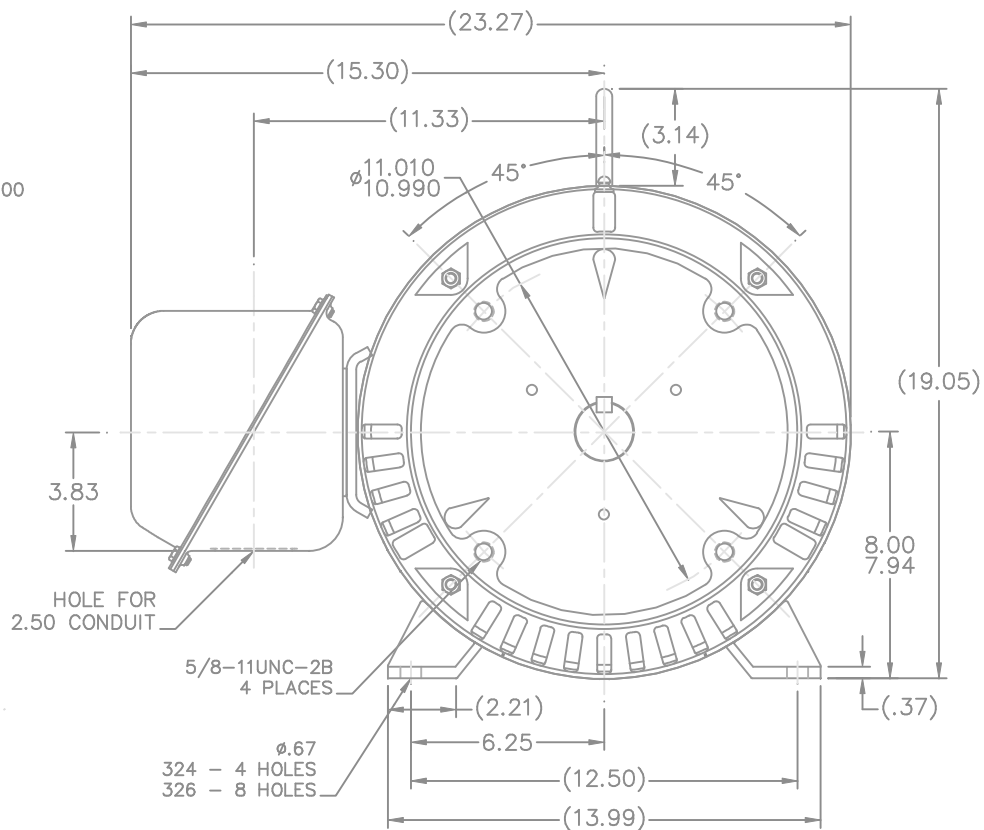
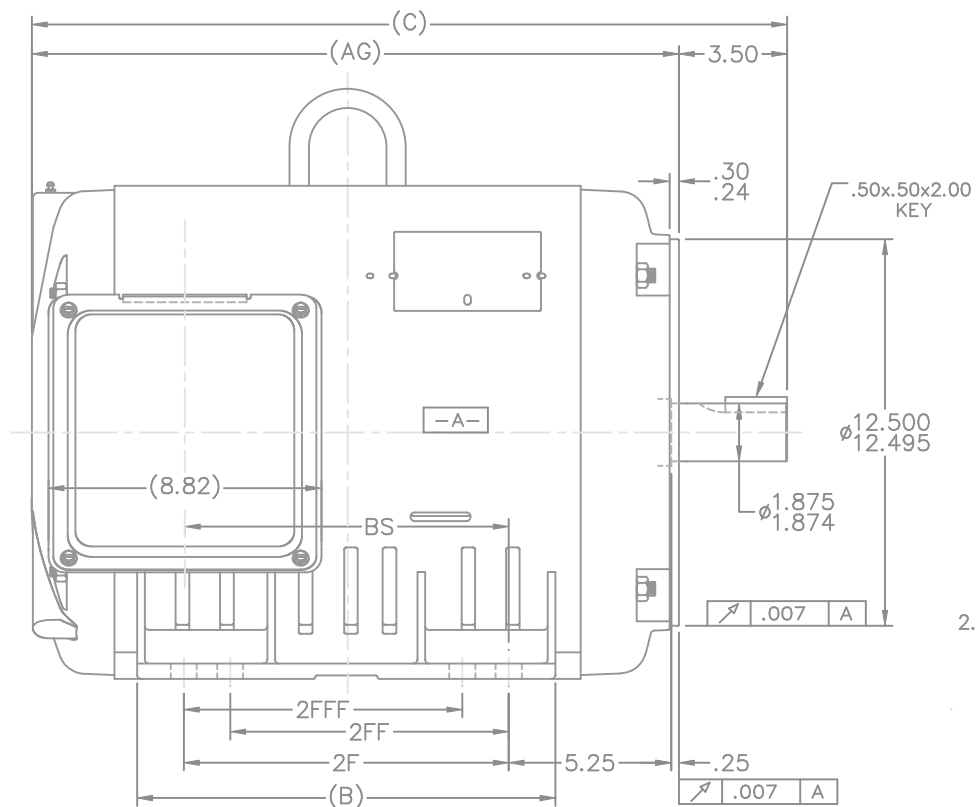

## NOTES:

1. CONDUIT BOX CAN BE ROTATED IN 90° STEPS.
2. NAMEPLATES TO BE READ FROM CONDUIT BOX SIDE OF MOTOR.

DASH	FRAME	C	AG	BS	B	2F	2FF	2FFF
1507	324TS	24.41	20.91	10.46	13.52	10.50		
1657	326TS	25.91	22.41	11.96	15.02	12.00	10.50	10.50

		TOLERANCES UNLESS SPECIFIED		Lincoln MOTORS		DRAWN CTO 03-26-2002	
		DEC.	INCHES			CHK	ML 04-01-2002
		.X	±.1			APPD	HNH 04-01-2002
		.XX	±.03	TITLE OUTLINE		SCALE 1=4	
		.XXX	±.005	320TS FR. - ODP UE - C'FACE		REF	
		HNH .XXXX	±.0005	MAT'L		FMF	
		CHK ANG	±7'30"	FINISH		PREV	
		RFP		CAD FILE xg2d1sc2		SIZE	DRAWING NO. PAGE OF REV.
		DIST BY				B	XG2D1SC2 2

THIS DRAWING IN DESIGN AND DETAIL IS OUR PROPERTY AND MUST NOT BE USED EXCEPT IN CONNECTION WITH OUR WORK. ALL RIGHTS OF DESIGN AND INVENTION ARE RESERVED. THIS IS AN ELECTRONICALLY GENERATED DOCUMENT - DO NOT SCALE THIS PRINT

T12 \_\_\_\_\_  
 T1 \_\_\_\_\_  
 T6 \_\_\_\_\_ L1  
 T7 \_\_\_\_\_

T2 \_\_\_\_\_  
 T4 \_\_\_\_\_  
 T8 \_\_\_\_\_ L2  
 T10 \_\_\_\_\_

T3 \_\_\_\_\_  
 T5 \_\_\_\_\_  
 T9 \_\_\_\_\_ L3  
 T11 \_\_\_\_\_

LOW VOLTAGE

T12 \_\_\_\_\_ L1  
 T1 \_\_\_\_\_

T4 \_\_\_\_\_  
 T7 \_\_\_\_\_

T2 \_\_\_\_\_ L2  
 T10 \_\_\_\_\_

T5 \_\_\_\_\_  
 T8 \_\_\_\_\_

T3 \_\_\_\_\_ L3  
 T11 \_\_\_\_\_

T6 \_\_\_\_\_  
 T9 \_\_\_\_\_

HIGH VOLTAGE



VIEW OF TERMINAL END

					✓ UNLESS OTHERWISE SPECIFIED DIMENSIONS ARE IN INCHES TOL. ON XX±.02 XXX±.005 XXXX±.0005 ANGLES± 7°30"		
2	08-09-1999	RE-ISSUE, ADDED '-' TO PART NUMBER	BLR		MAX. SURFACE ROUGHNESS UNLESS OTHERWISE NOTED		DRAWN BY TRB 07-16-1999
					FINISH		CHKD BY ML 06-18-1999
1	06-18-1999	NEW DRAWING	TRB		MATERIAL		APPD BY GK 06-18-1999
REV	DATE	CHANGE	NAME	PART NAME 3 PHASE CONNECTION DIAGRAM 2/1 DELTA - 12 LEADS			DRWG NO A- EE7308AA-LN
				PURCHASED	CADD FILE NO.	EE7308AALN	

ERROR: undefined  
OFFENDING COMMAND: Pscrip  
STACK:



**2100 WASHINGTON ST.  
GRAFTON, WI  
PH. 262-277-8810**

**CONN. DIAGRAM:** A-EE7308AA-LN

**CATALOG #:** LM13840

**OUTLINE:** XG2D1SC2-1657

**WINDING #:** L3262008 1

**MOUNTING:** F1 ONLY

**TYPICAL MOTOR PERFORMANCE DATA**

HP	kW	SYNC. RPM	F.L. RPM	FRAME	ENCLOSURE	KVA CODE	DESIGN
60	45.0	3600	3550	326TSC	DP	F	B

PH	Hz	VOLTS	AMPS	START TYPE	DUTY	INSL	S.F.	AMB°C
3	60	230/460	136/68	WYE START DELTA RUN	CONTINUOUS	F1	1.25	40

<b>FULL LOAD EFF:</b>	93.6	<b>3/4 LOAD EFF:</b>	94.5	<b>1/2 LOAD EFF:</b>	94.5	<b>GTD. EFF</b>		<b>ELEC. TYPE</b>
<b>FULL LOAD PF:</b>	88.5	<b>3/4 LOAD PF:</b>	88.5	<b>1/2 LOAD PF:</b>	87.5	92.4		SQ CAGE IND RUN

F.L. TORQUE	LOCKED ROTOR AMPS	L.R. TORQUE	B.D. TORQUE	F.L. RISE°C
89 <b>LB-FT</b>	700 / 350	145 <b>LB-FT</b> 163 %	185 <b>LB-FT</b> 208 %	50

SOUND PRESSURE @ 3 FT.	SOUND POWER	ROTOR WK^2	MAX. WK^2	SAFE STALL TIME	STARTS / HOUR	APPROX. MOTOR WGT
82 <b>dB</b>	92 <b>dB</b>	5.5 <b>LB-FT^2</b>	- <b>LB-FT^2</b>	- <b>SEC.</b>	-	- <b>LBS.</b>

**\*\*\* SUPPLEMENTAL INFORMATION \*\*\***

DE BRACKET TYPE	ODE BRACKET TYPE	MOUNT TYPE	ORIENTATION	SEVERE DUTY	HAZARDOUS LOCATION	DRIP COVER	SCREENS	PAINT
C-FACE	STANDARD	RIGID	HORIZONTAL	FALSE	NONE	FALSE	NONE	GRAY - LINCOLN

BEARINGS		GREASE	SHAFT TYPE	SPECIAL DE	SPECIAL ODE	SHAFT MATERIAL	FRAME MATERIAL
DE	ODE						
BALL	BALL	POLYREX EM	TS	NONE	NONE	1045 HOT ROLLED (C-204)	ROLLED STEEL
6311	6309						

THERMO-PROTECTORS				THERMISTORS	CONTROL	SPACE HEATERS
THERMOSTATS	PROTECTORS	WDG RTDs	BRG RTDs			
NONE	NOT	NONE	NONE	NONE	FALSE	NONE <b>VOLTS</b>

\*  
  
N  
  
O  
  
T  
  
E  
  
S  
  
\*

**INVERTER TORQUE:** NONE  
**INV. HP SPEED RANGE:** NONE

**ENCODER:** NONE  
NONE NONE  
NONE NONE PPR

**BRAKE:** NONE NONE  
NONE P/N NONE  
NONE NONE  
NONE FT-LB NONE V NONE Hz

## Data Sheet

Date: 1/23/2018

LM13840



Data @ 460 V

## Motor Load Data

Load	0%	25%	50%	75%	100%	115%	125%	LR	
Current (Amps)	11.0	19.5	34.0	50.5	68.0	79.0	87.0	350	
Torque (ft-lb)	0.00	22.0	44.0	66.5	89.0	103	112	145	
RPM	3600	3590	3575	3560	3550	3,540	3530	0	
Efficiency (%)		93.0	94.5	94.5	93.6	92.4	92.4		
P.F. (%)	7.0	77.0	87.5	88.5	88.5	88.0	87.5	33.0	

## Motor Speed Data

	LR	Pull-Up	BD	Rated	Idle
Speed (RPM)	0	1800	3315	3550	3600
Current (Amps)	350	315	250	68.0	11.0
Torque (ft-lb)	145	135	185	89.0	0.00

## Information Block

HP	60.0			
Sync. RPM	3600			
Frame	326			
Enclosure	DP			
Construction	TDR			
Voltage	230/460 V			
Frequency	60 Hz			
Design	B			
LR Code letter	F			
Service Factor	1.15			
Temp Rise @ FL	50 °C			
Duty	CONT			
Ambient	40 °C			
Elevation	1,000 feet			
Rotor/Shaft wk²	5.5 Lb-Ft²			
Ref Wdg	L3262008 NONE			
Sound Pressure @ 1M	82 dBA			
VFD Rating	NONE			
Outline Dwg	XG2D1SC2-1657			
Conn. Diag	A-EE7308AA-LN			
Additional Specifications:				
0				
0				
EQUIV CKT (OHMS / PHASE)				
R1	R2	X1	X2	Xm
0.0950	0.0660	0.5250	0.4400	24.0280

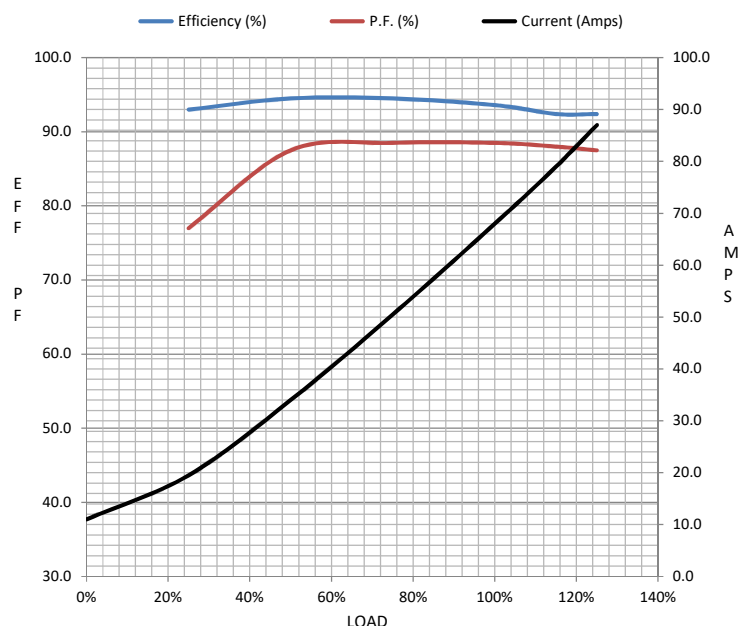

## Speed - Torque Curve

