

PRODUCT INFORMATION PACKET



Model No: E584M2
Catalog No: E584M2
30.0 HP General Purpose Motor, 3 phase, 3600 RPM, 230/460 V, 284TS Frame, ODP
General Purpose Motors



Regal and Century are trademarks of Regal Rexnord Corporation or one of its affiliated companies.
©2021 Regal Rexnord Corporation, All Rights Reserved. MC017097E





Nameplate Specifications

Output HP	30.0 Hp	Output KW	22.4 kW
Frequency	60 Hz	Voltage	230/460 V
Current	69.0/34.5 A	Speed	3535 rpm
Service Factor	1.15	Phase	3
Duty	Continuous	Insulation Class	F
Frame	S284TS	Enclosure	Drip Proof
Thermal Protection	None	Ambient Temperature	40 °C
UL	Recognized	CSA	Y
CE	N	Number of Speeds	1

Technical Specifications

Electrical Type	Three Phase	Starting Method	Across The Line
Poles	2	Rotation	Reversible Counterclockwise
Mounting	Rigid Base	Drive End Bearing	Ball
Opp Drive End Bearing	Ball	Frame Material	Rolled Steel
Shaft Type	Keyed	Overall Length	22.85 in
Frame Length	14.00 in	Shaft Diameter	1.625 in
Shaft Extension	3.72 in		
Connection Drawing	80022802.PCX	Outline Drawing	18722701-001-S01

This is an uncontrolled document once printed or downloaded and is subject to change without notice. Date Created:10/12/2021

REV	ECO	REV BY	DATE	APPD	DATE
B	0003531	K.PALOMO	01-07-09	C.CONTRERAS	01-07-09

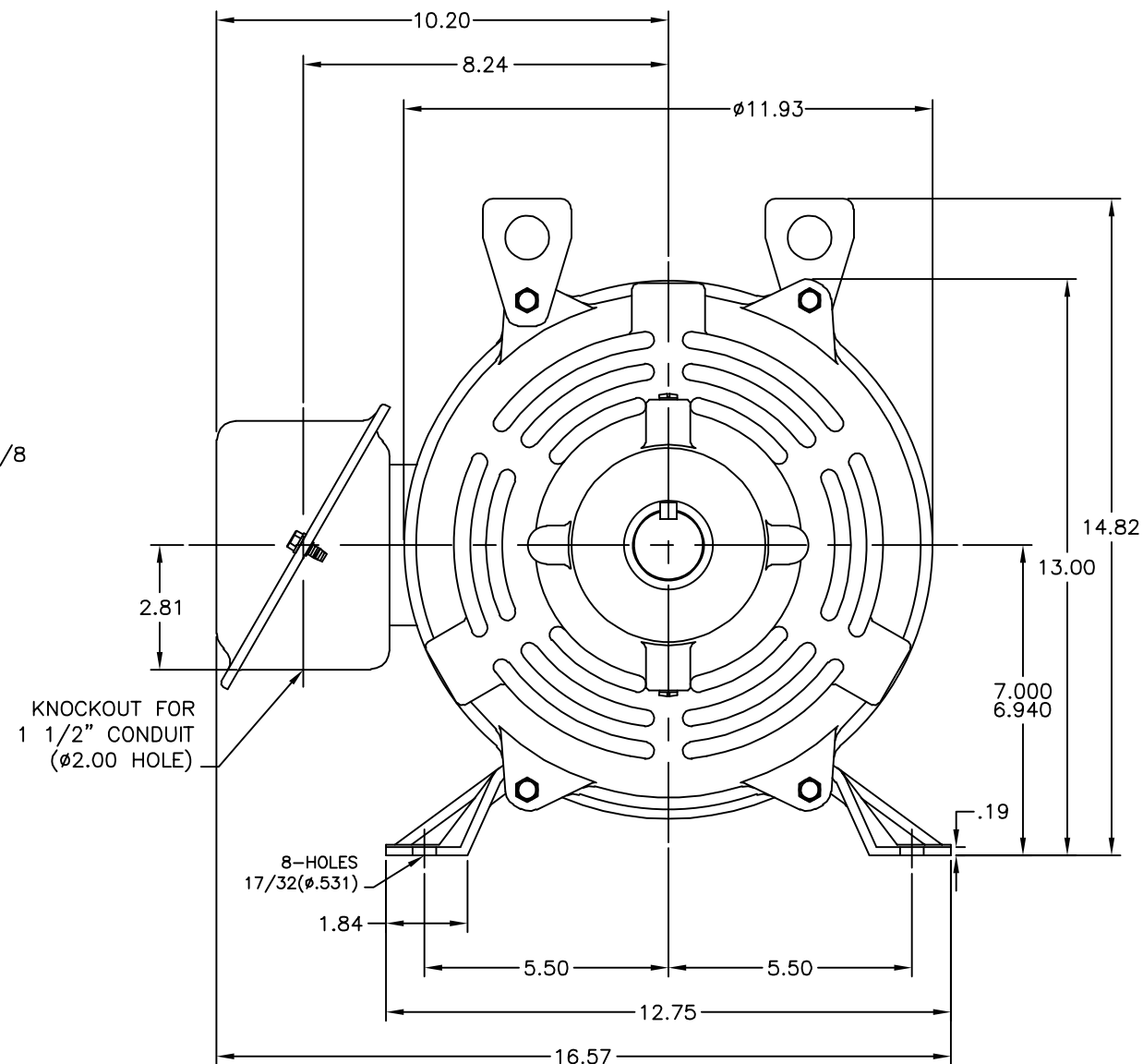
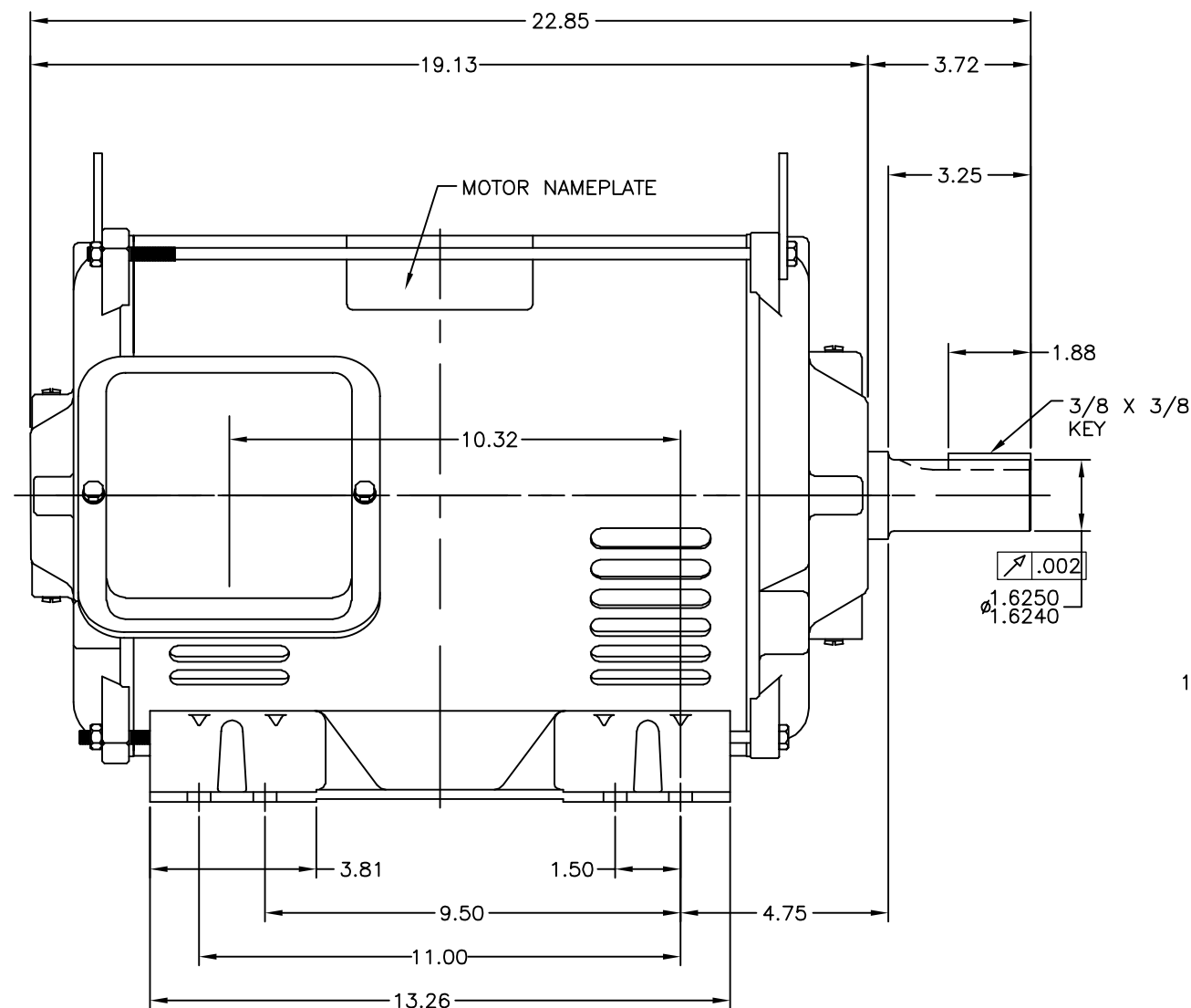

NOTES:

- 1- CONDUIT BOX MAY BE ROTATED IN 90° INCREMENTS.
- 2- MOTOR IS SUITABLE FOR FIELD CONVERSION FROM AN F1 TO AN F2 CONDUIT BOX LOCATION.
- 3- MOTOR VENTILATION: AIR INTAKE THROUGH OPENINGS IN THE FACE OF EACH BRACKET AND EXHAUSTED THROUGH THE VENT SLOTS ON EACH END OF THE SHELL.

MOTOR DESCRIPTION:

3 PHASE OPEN DRIPPROOF STEEL SHELL 284TS OR 286TS MOUNTING.
OTHER MOUNTING ORIENTATIONS ARE ACCEPTABLE; HOWEVER WHEN MOUNTED OTHER THAN HORIZONTAL; MOTOR WILL NOT BE DRIPPROOF AS DEFINED BY NEMA.

GEOMETRIC CHARACTERISTICS & SYMBOLS
□ FLATNESS
— STRAIGHTNESS
∠ ANGULARITY
⊥ PERPENDICULARITY (SQUARENESS)
// PARALLELISM
○ ROUNDNESS (CIRCULARITY)
⊘ CYLINDRICITY
△ PROFILE OF ANY SURFACE
⌒ PROFILE OF ANY LINE
⌒ RUNOUT
⊕ TRUE POSITION
◎ CONCENTRICITY
= SYMMETRY

UNLESS OTHERWISE SPECIFIED
DIM. TOLERANCES ARE AS FOLLOWS:
INCH ±.1 ±.02 ±.005 ±.0005
mm ±0.5 ±0.13 ±0.013
ANG. ±.50 DEG
REMOVE BURRS & BREAK SHARP EDGES:
INCH .003-.015 mm 0.1-0.4
CORNER FILLETS TO:
INCH .020 mm 0.5
MACHINE SURFACES:
INCH 125 mm 3.2
METRIC DIMS. SHOWN IN [BRACKETS]

DR BY:

AJB

01-19-04

APPD:

DVB

01-19-04

THIRD ANGLE PROJECTION

EDS DATE

EDS DATE

FORMAT REV

F

CONFIDENTIAL: THIS DRAWING AND ITS INFORMATION ARE THE EXCLUSIVE AND CONFIDENTIAL PROPERTY OF A.O. SMITH CORP. AND ARE NOT TO BE DISCLOSED, DUPLICATED, DISTRIBUTED OR OTHERWISE USED WITHOUT THE WRITTEN CONSENT OF A.O. SMITH CORP.
-ALL RIGHTS RESERVED.
ASME Y14.5M 1994

ACSmith
Innovation has a name.

**ELECTRICAL PRODUCTS
COMPANY**
A DIVISION OF A. O. SMITH CORPORATION

DESCRIPTION

OUTLINE

SIZE

D

DWG NO

18722701-001

SCALE

NONE

SHEET

1

REVISION:	ECO	REVISADO POR:	K.PALOMO	FECHA:	01-07-09	APROBADO POR:	C.CONTRERAS	FECHA:	01-07-09
B	0003531								

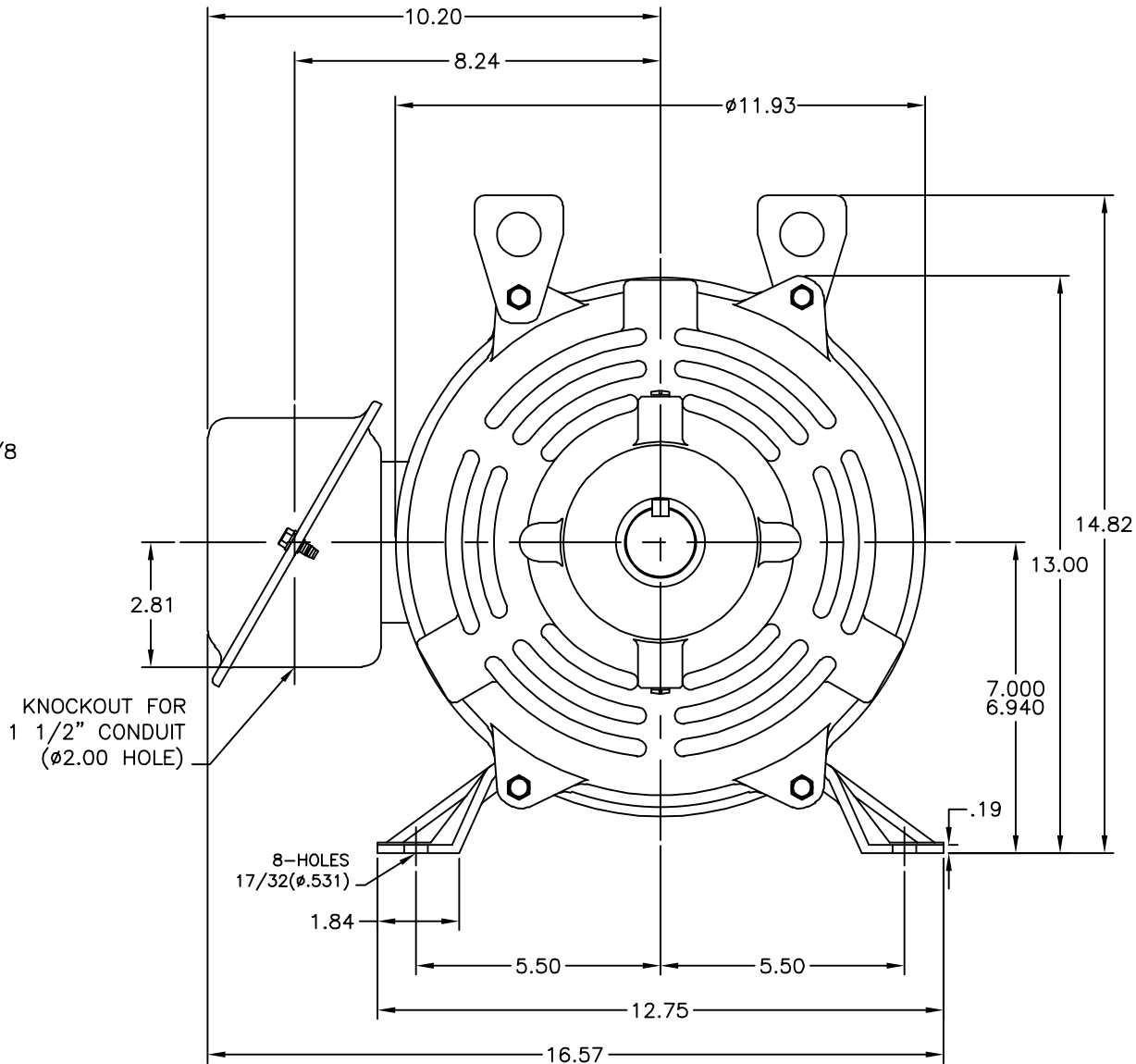
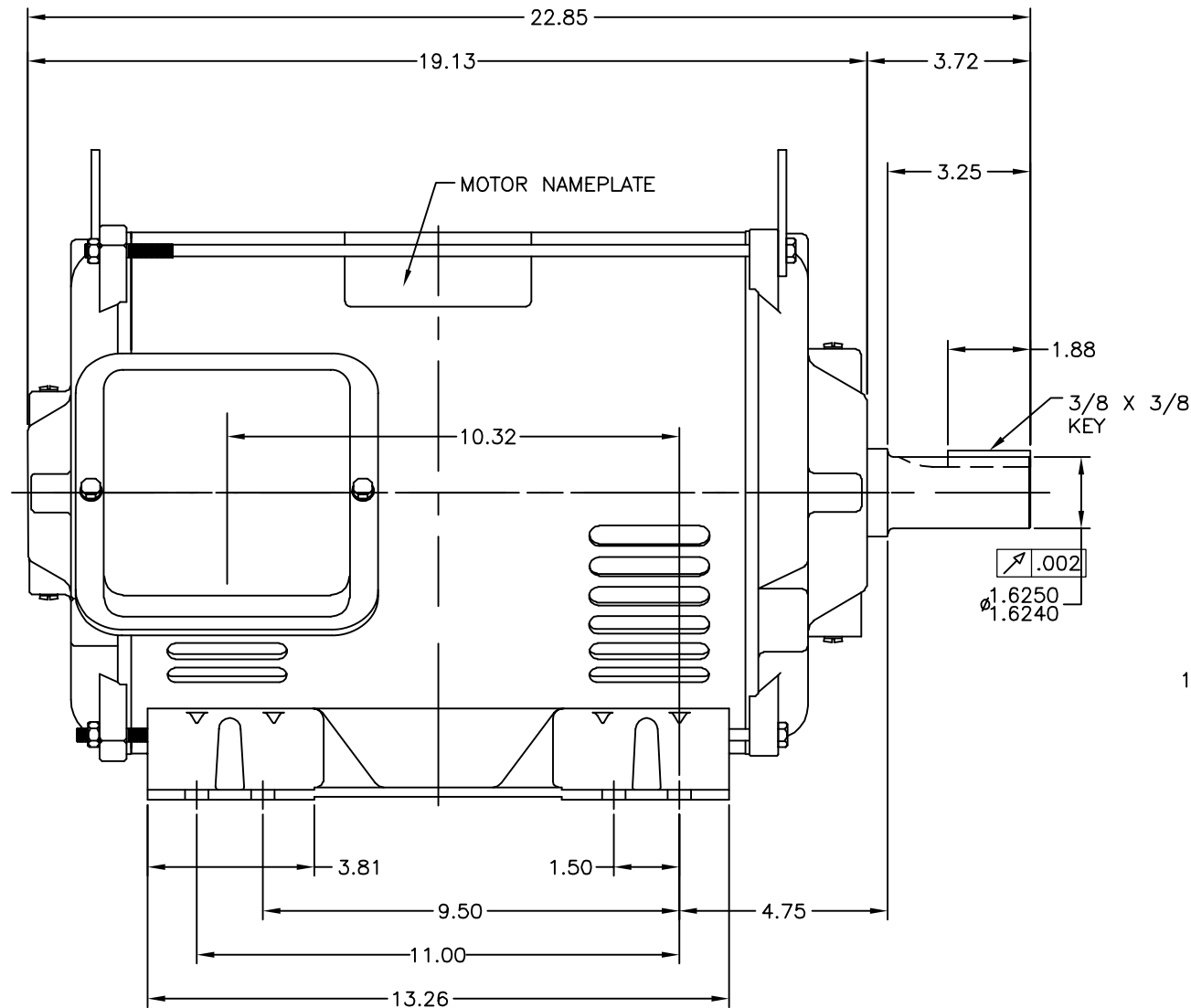

- NOTES:
- 1- CONDUIT BOX MAY BE ROTATED IN 90° INCREMENTS.
 - 2- MOTOR IS SUITABLE FOR FIELD CONVERSION FROM AN F1 TO AN F2 CONDUIT BOX LOCATION.
 - 3- MOTOR VENTILATION: AIR INTAKE THROUGH OPENINGS IN THE FACE OF EACH BRACKET AND EXHAUSTED THROUGH THE VENT SLOTS ON EACH END OF THE SHELL.

MOTOR DESCRIPTION:
3 PHASE OPEN DRIPPROOF STEEL SHELL 284TS OR 286TS MOUNTING.
OTHER MOUNTING ORIENTATIONS ARE ACCEPTABLE; HOWEVER WHEN MOUNTED OTHER THAN HORIZONTAL; MOTOR WILL NOT BE DRIPPROOF AS DEFINED BY NEMA.

CARACTERÍSTICAS DE GEOMETRÍA Y SÍMBOLOS		A MENOS QUE SE ESPECIFIQUE DE OTRA MANERA, LAS TOLERANCIAS DE LAS DIMS, SON LAS SIGUIENTES:		DIBUJADO POR: AUB		01-19-04		ACSmith		ELECTRICAL PRODUCTS COMPANY	
— RECTITUD		PULG ±.1 ±.02 ±.005 ±.0005		APROBADO POR: DVB		01-19-04		Innovation has a name.		A DIVISION OF A. O. SMITH CORPORATION	
— ANGULARIDAD		mm ±0.5 ±0.13 ±0.013		TERCER ANGULO DE PROYECCION		FECHA EDS: EDS DATE		DESCRIPCION:		OUTLINE	
⊥ PERPENDICULARIDAD (A ESCUADRA)		ANG ±50 GRADOS		ELIMINAR REBABAS Y ORILLAS FILOSAS DEL BORDE.		REV. FORMATO: F		TAMAÑO: D		NUMERO DE DIBUJO:	
// PARALELISMO		PULG .003-.015 mm 0.1-0.4		FILETEAR ESQUINA: PULG .020 mm 0.5		CONFIDENCIAL: ESTE DIBUJO Y SU INFORMACION SON PROPIEDAD DE USO EXCLUSIVO Y CONFIDENCIAL DE A.O.SMITH CORP. Y NO DEBERAN SER REVELADOS, DUPLICADOS, DISTRIBUIDOS O USARSE DE OTRA MANERA SIN EL CONSENTIMIENTO ESCRITO DE A.O. SMITH CORP.		ESCALA: NONE		18722701-001	
○ REDONDEZ (CIRCULARIDAD)		PULG 125 mm 3.2		DIMS METRICAS MOSTRADAS [PARENTESIS]		-TODOS LOS DERECHOS RESERVADOS.ASME Y14.5M 1994		HOJA: 1			
⌀ CILINDRICIDAD											
⌒ PERFIL DE CUALQUIER SUPERFICIE											
⌒ PERFIL DE CUALQUIER LINEA											
↑ VARIACION											
⊙ POSICION REAL											
⊙ CONCENTRICIDAD											
= SIMETRIA											

版本	ECO	编制	日期	批准	日期
B	0003531	K.PALOMO	01-07-09	C.CONTRERAS	01-07-09

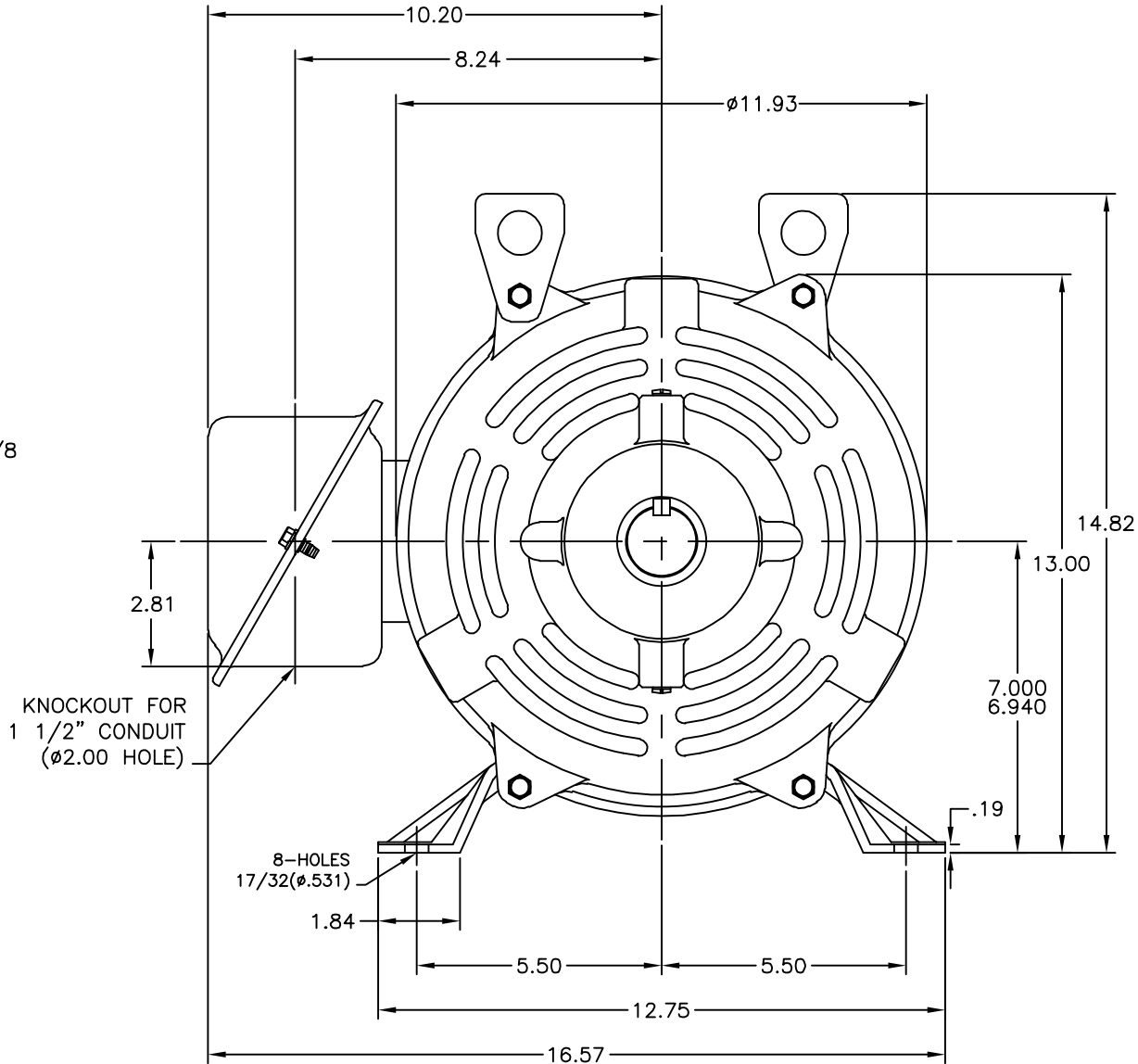
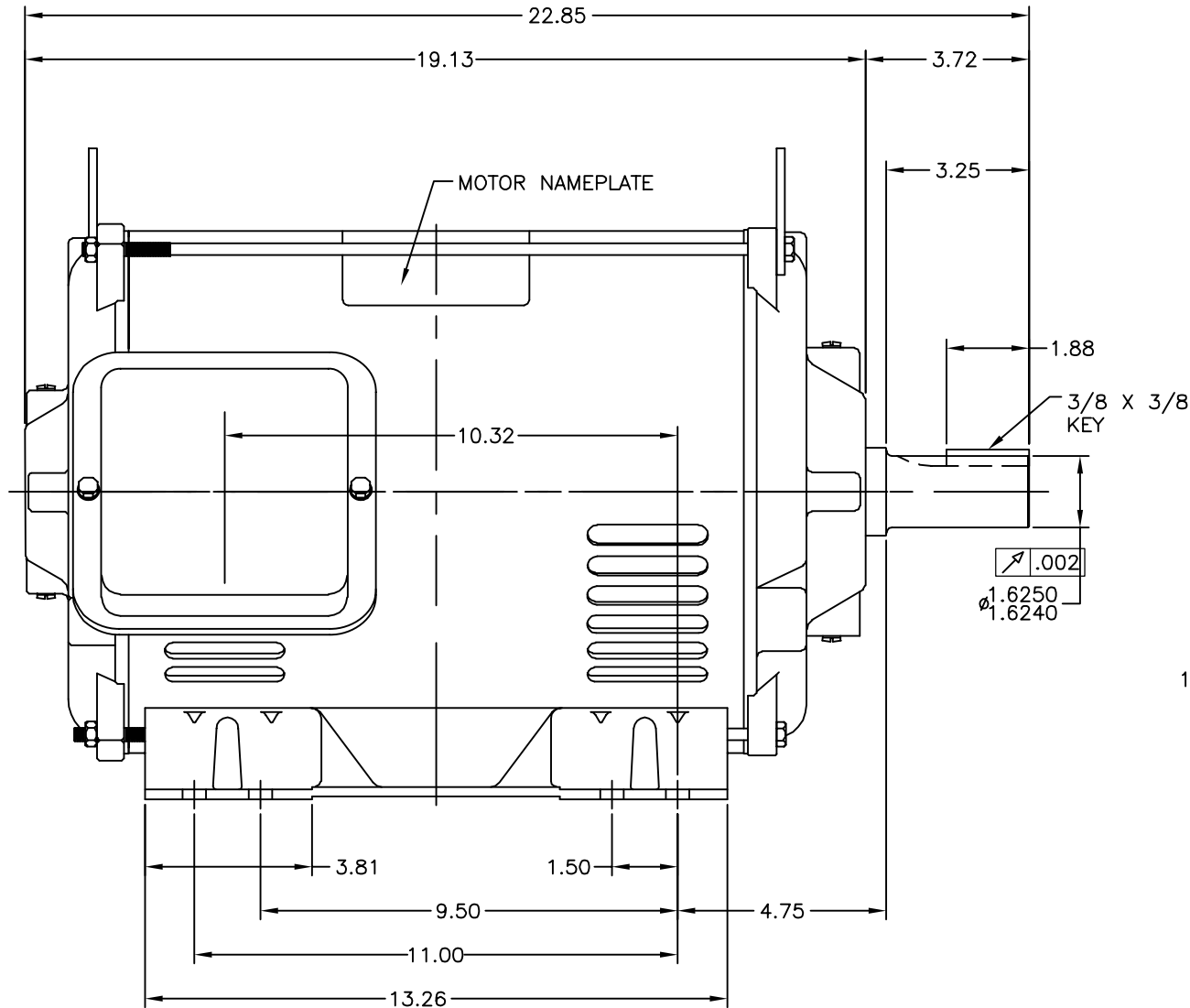

- NOTES:
- 1- CONDUIT BOX MAY BE ROTATED IN 90° INCREMENTS.
 - 2- MOTOR IS SUITABLE FOR FIELD CONVERSION FROM AN F1 TO AN F2 CONDUIT BOX LOCATION.
 - 3- MOTOR VENTILATION: AIR INTAKE THROUGH OPENINGS IN THE FACE OF EACH BRACKET AND EXHAUSTED THROUGH THE VENT SLOTS ON EACH END OF THE SHELL.

MOTOR DESCRIPTION:
3 PHASE OPEN DRIPPROOF STEEL SHELL 284TS OR 286TS MOUNTING.
OTHER MOUNTING ORIENTATIONS ARE ACCEPTABLE; HOWEVER WHEN MOUNTED OTHER THAN HORIZONTAL; MOTOR WILL NOT BE DRIPPROOF AS DEFINED BY NEMA.

形位公差 □ 平面度 — 直线度 ∠ 倾斜度 ⊥ 垂直度 ∥ 平行度 ○ 圆度 ⊙ 圆柱度 ⌒ 面轮廓度 ⌒ 线轮廓度 ⌒ 位置度 ⌒ 同轴度 ⌒ 对称度	除另有注明 尺寸公差如下: X XX XXX XXXX 英寸 ±.1 ±.02 ±.005 ±.0005 毫米 ±0.5 ±0.13 ±0.013 角度 ±.50 度 清理毛刺和尖棱 英寸 .003-.015 毫米 0.1-0.4 内圆角 英寸 .020 毫米 0.5 表面粗糙度 英制 125 米制 3.2 米制尺寸显示在[]	绘图: AJB 批准: DVB 第三角投影 图底格式发布日期 EDS DATE 图底格式版本 F	01-19-04 01-19-04 图底格式发布日期 EDS DATE 图底格式版本 F	名称 OUTLINE 图幅 D 图号 18722701-001 比例 NONE 页号 1
---	---	--	---	---