

PRODUCT INFORMATION PACKET



Model No: 364THTS18877
Catalog No: 364THTS18877
40,1200,TENV,364TZ,3/60/460

Regal and Marathon are trademarks of Regal Rexnord Corporation or one of its affiliated companies.
©2023 Regal Rexnord Corporation, All Rights Reserved. MC017097E



Nameplate Specifications

Phase	3	Output HP	40 Hp
Output KW	30.0 kW	Voltage	460 V
Speed	1182 rpm	Service Factor	1
Frame	364TR	Enclosure	Totally Enclosed Non Ventilated
Thermal Protection	Thermostat	Efficiency	93 %
Ambient Temperature	40 °C	Frequency	60 Hz
Current	51.5 A	Power Factor	78
Duty	60 Minute	Insulation Class	H
Design Code	INV	KVA Code	G
Drive End Bearing Size	6314	Opp Drive End Bearing Size	6312
UL	Recognized	CSA	Y
CE	Y	IP Code	54
Number of Speeds	1		

Technical Specifications

Electrical Type	Squirrel Cage Inverter Duty	Starting Method	Inverter Only
Poles	6	Rotation	Reversible
Resistance Main	.175 Ohms	Mounting	Rigid Base
Motor Orientation	Horizontal	Drive End Bearing	Ball
Opp Drive End Bearing	Ball	Frame Material	Cast Iron
Shaft Type	Special Extension Both Sides	Assembly/Box Mounting	F3
Outline Drawing	B-SS555170-1350	Connection Drawing	A-EE7300AK

This is an uncontrolled document once printed or downloaded and is subject to change without notice. Date Created:08/24/2023

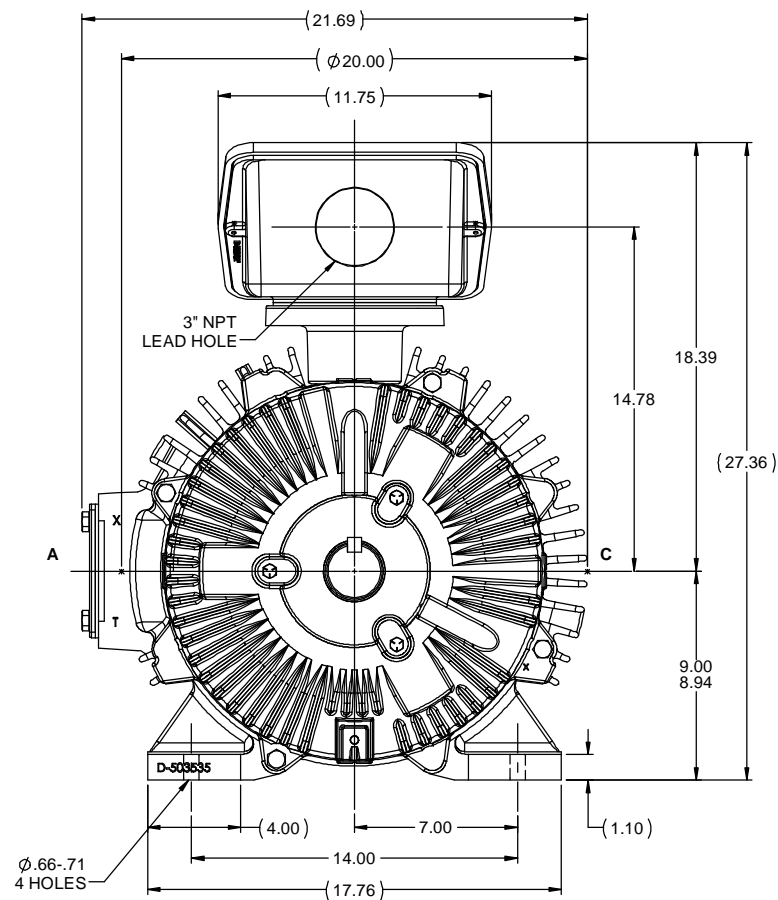
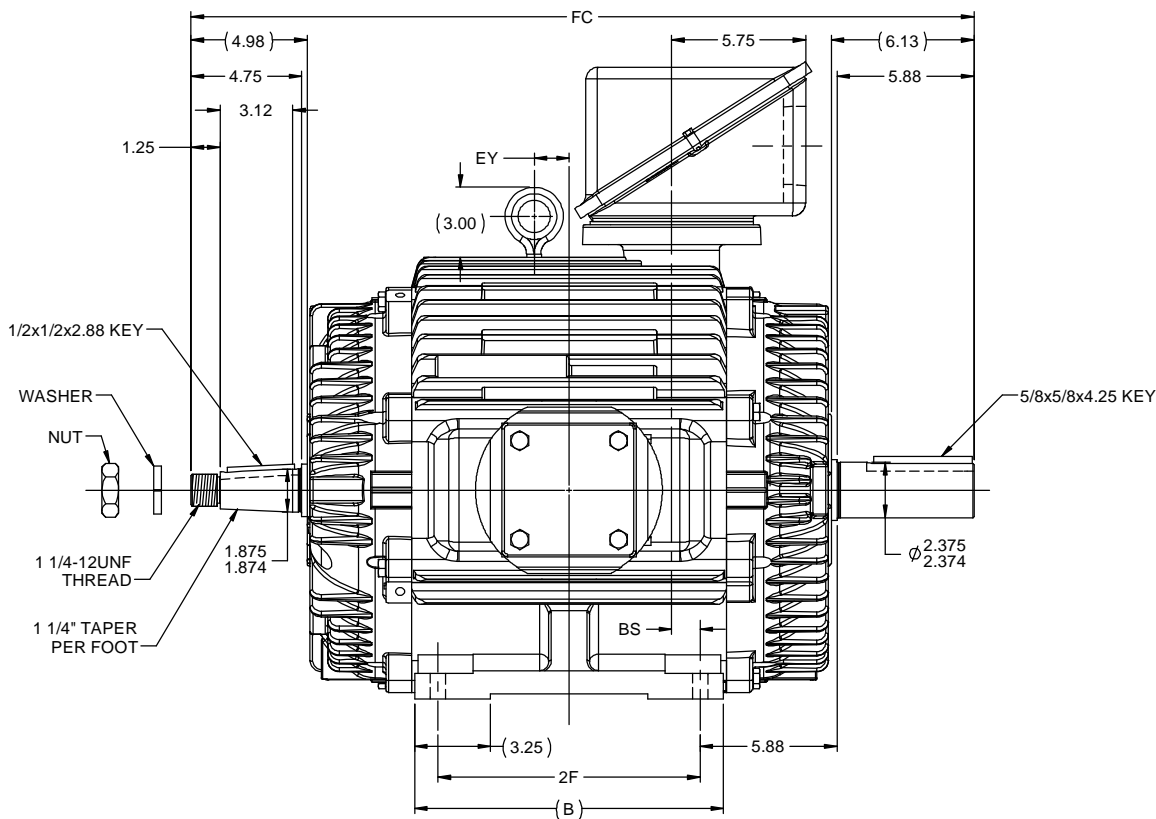

- NOTES:
1. CONDUIT BOX CAN BE ROTATED IN 90 ° STEPS.
 2. NAMEPLATE TO BE READ FROM "A" SIDE OF MOTOR.

DASH	FRAME	FC	B	2F	BS	EY	--	--
1350	364TR	33.62	13.25	11.25	1.25	1.50		
1450	365TR	34.62	14.25	12.25	1.75	1.81		

				TOLERANCES UNLESS SPECIFIED		marathon [®] electric	DRAWN HV 05-30-12
				DEC	INCHES		
				X	±.1	TITLE OUTLINE - TENV 360TR FR. - STD - TOP MTD. C'BOX	CHK MH 05-30-12
				XX	±.03		APPR DJK 05-30-12
				XXX	±.005		SCALE 3:16
				XXXX	±.0005		REF
NO	REVISION	BY & DATE	CHK	ANG	±7°30"	FINISH	FMF MU107673
			RFP			PREV	PAGE OF
NETWORK FILE NAME SS555170						SIZE B	DRAWING NO SS555170
							REV

THIRD ANGLE
PROJECTION

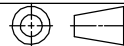

P1 AND P2 PROTECTORS TO VOLTAGE CONTROL

TO REVERSE ROTATION:
INTERCHANGE ANY TWO
LINE LEAD CONNECTIONS.

PROTECTORS
CONNECTED
IN SERIES.

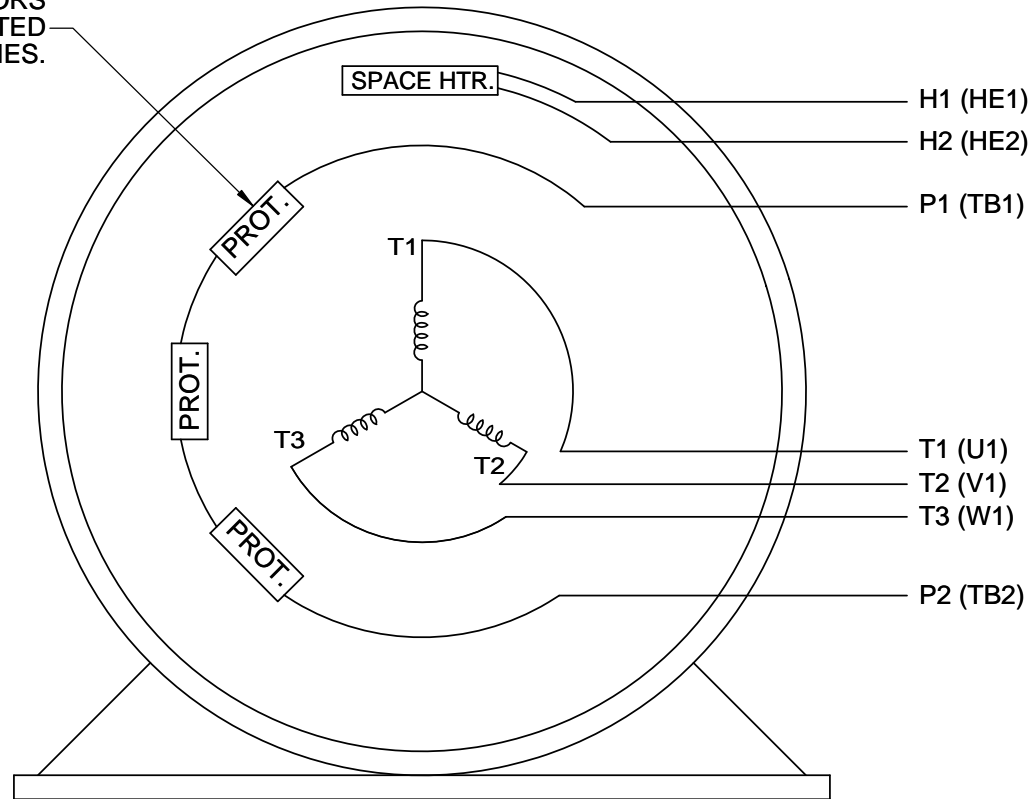

IF MOTOR OR GENERATOR
HAS 6 LEADS

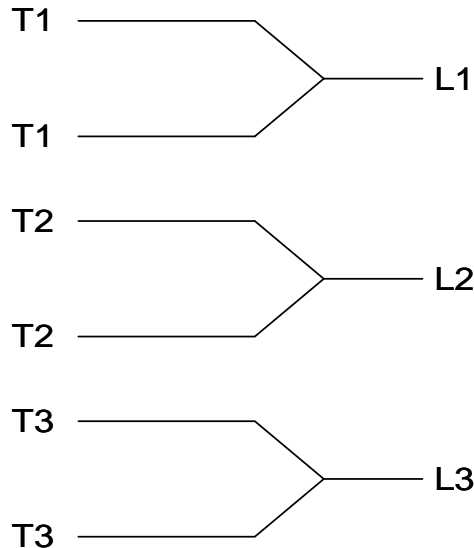

A-9806 DECAL

DRAWING REVISION J	REVISION BY J. OTTO	DATE 04-13-2017	TOLERANCES UNLESS OTHERWISE SPECIFIED: <div><div>DEC.</div><div>INCH</div><div>mm</div><div>ANGLE</div></div> <div><div>.X</div><div>±0.1</div><div>[±2.5]</div><div>±7' 30"</div></div> <div><div>.XX</div><div>±0.02</div><div>[±0.51]</div></div> <div><div>XXX</div><div>±0.005</div><div>[±0.127]</div></div> <div><div>.XXXX</div><div>±0.0005</div><div>[±0.0127]</div></div> <div>REMOVE BURRS & BREAK SHARP EDGES: .003/.015 [.076/.381] CORNER FILLETS: .02 [.51] MACHINED SURFACES: 200 INCH 5.1 mm mm SHOWN IN [BRACKETS]</div>		DRAWN BY MJD	<div><div>REGAL™</div><div>Regal Beloit America, Inc.</div></div>			
ECO ECO-0121568	APPROVED BY T. VUE	DATE 04-18-2017			DATE 06-24-2014				
ECO DESCRIPTION ADDED IEC NOTATIONS			DESCRIPTION CONN DIAGRAM-INTERNAL SINGLE VOLT-3Ø MOTOR		APPROVED BY TB	MATERIAL		PROCESS/FINISH	
COPYRIGHT REGAL BELOIT AMERICA, INC. ALL RIGHTS RESERVED. PROPRIETARY AND CONFIDENTIAL INFORMATION - THIS DOCUMENT IS THE PROPERTY OF REGAL BELOIT AMERICA, INC. ("OWNER") AND CONTAINS OWNER'S PROPRIETARY INFORMATION. ANY PERSON, CORPORATION OR OTHER FIRM RECEIVING IT IS DEEMED, BY RECEIVING IT, TO AGREE THAT IT, AND/OR ANY PART OF IT, SHALL NOT BE DISCLOSED TO ANY PERSON, CORPORATION OR OTHER ENTITY, DUPLICATED, AND/OR USED, EXCEPT AS EXPRESSLY APPROVED IN WRITING IN ADVANCE BY OWNER. THIS DOCUMENT SHALL BE RETURNED TO OWNER UPON REQUEST. IT MAY BE SUBJECT TO CERTAIN RESTRICTIONS UNDER APPLICABLE EXPORT CONTROL LAWS AND REGULATIONS.					DATE 07-06-1998				
			REFERENCE		THIRD ANGLE PROJECTION	SIZE A	DRAWING NUMBER EE7300AK	SHEET 1 OF 1	