

PRODUCT INFORMATION PACKET



Model No: 326TTDR14105

Catalog No: H191A

25 HP General Purpose Motor, 3 phase, 900 RPM, 230/460 V, 326T Frame, ODP
General Purpose Motors

Regal and Marathon are trademarks of Regal Rexnord Corporation or one of its affiliated companies.
©2021 Regal Rexnord Corporation, All Rights Reserved. MC017097E



Nameplate Specifications

Output HP	25 Hp	Output KW	18.7 kW
Frequency	60 Hz	Voltage	230/460 V
Current	73.0/36.5 A	Speed	880 rpm
Service Factor	1.15	Phase	3
Efficiency	90.2 %	Power Factor	71
Duty	Continuous	Insulation Class	F
Design Code	B	KVA Code	F
Frame	326T	Enclosure	Drip Proof
Thermal Protection	No	Ambient Temperature	40 °C
Drive End Bearing Size	6312	Opp Drive End Bearing Size	6311
UL	Recognized	CSA	Y
CE	Y	IP Code	22
Number of Speeds	1		

Technical Specifications

Electrical Type	Squirrel Cage Induction Run	Starting Method	Across The Line
Poles	8	Rotation	Reversible
Resistance Main	.32 Ohms	Mounting	Rigid Base
Motor Orientation	Horizontal	Drive End Bearing	Ball
Opp Drive End Bearing	Ball	Frame Material	Rolled Steel
Shaft Type	T	Overall Length	28.50 in
Frame Length	15.00 in	Shaft Diameter	2.125 in
Shaft Extension	5.5 in	Assembly/Box Mounting	F1/F2 Capable
Connection Drawing	A-EE7308	Outline Drawing	B-SS300978-1500

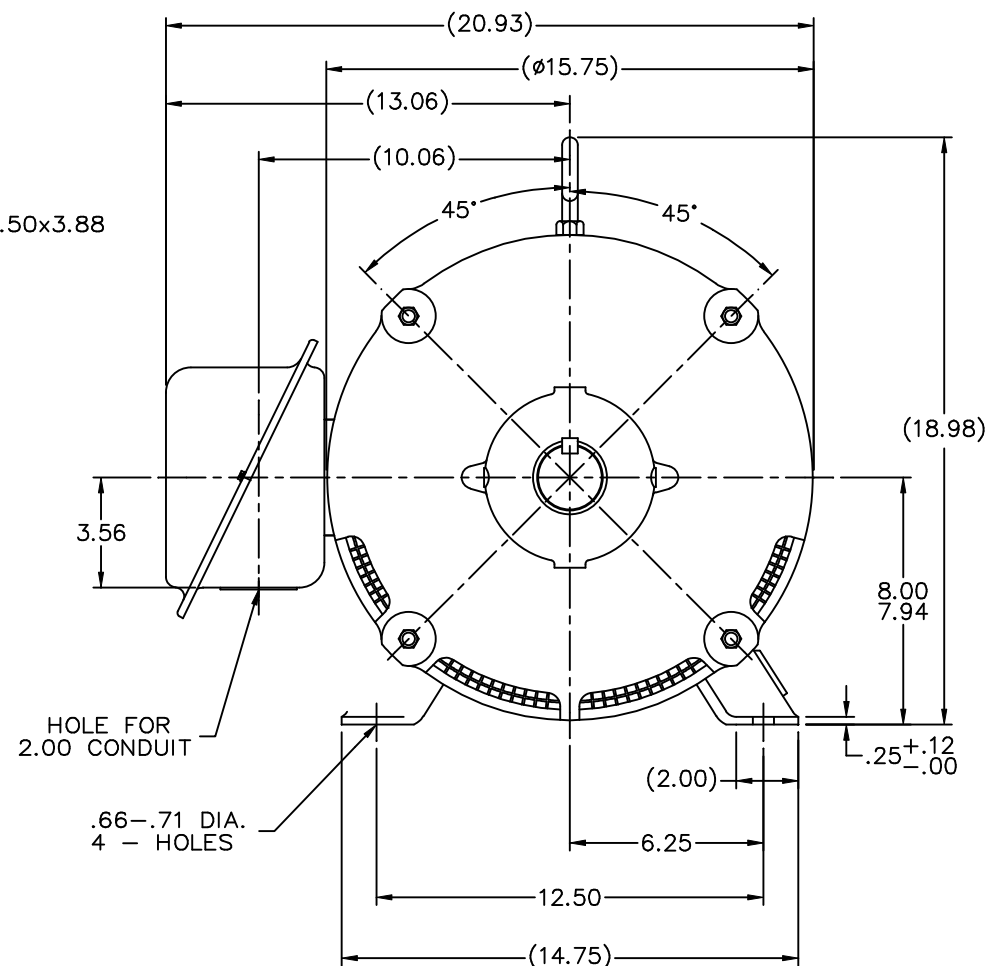
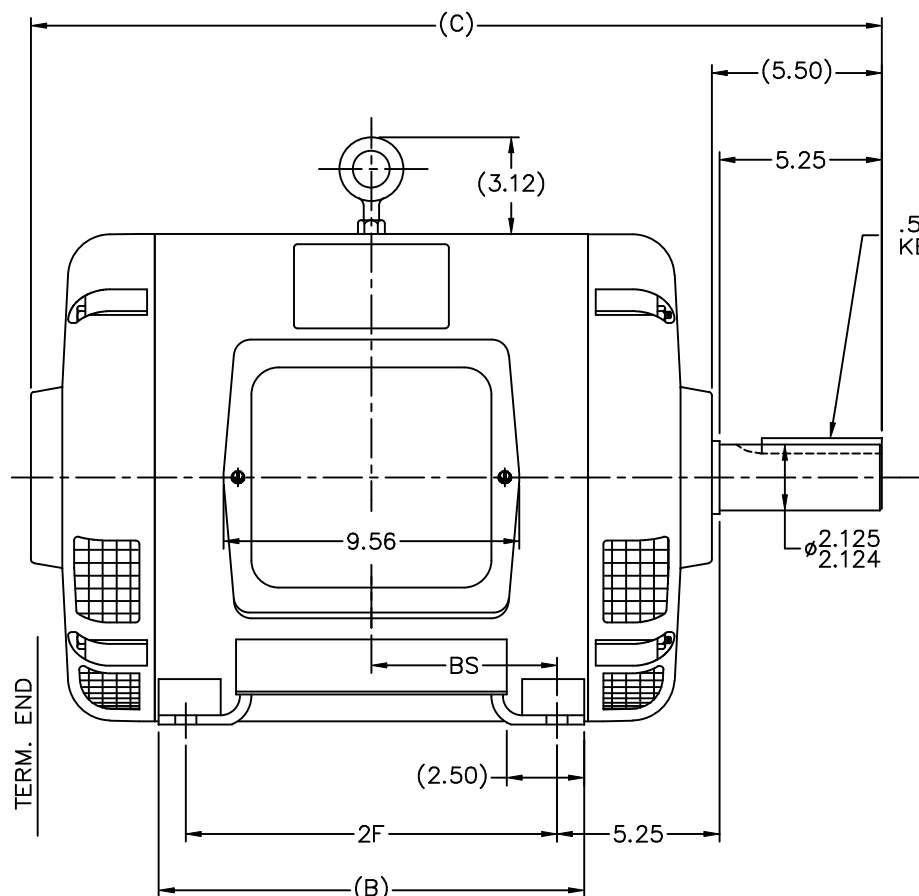

NOTES:

1. NAMEPLATE READ FROM C'BOX SIDE OF MOTOR
2. BOX CAN BE ROTATED IN 90° STEPS
3. BOX CAN BE MOUNTED ON OPPOSITE SIDE BY REMOVING BRACKETS AND TURNING FRAME 180°

DASH	FRAME	B	C	2F	BS	MTG.	TOLERANCES UNLESS SPECIFIED				MARATHON ELECTRIC		DRAWN MJD 2/11/2000	
							DEC.	INCHES					CHK ML 2/15/2000	
1250	324T	12.25	26.00	10.50	5.25	F1 OR F2	.X	±.1					APPD DD 2/15/2000	
1400	326T	13.75	27.50	12.00	6.00	F1 OR F2	ML .XX	±.03					SCALE 1=4	
1450	324T/6T	12.25	28.00	10.50	6.25	F1 OR F2	DD .XXX	±.005					REF	
1500	326T	13.75	28.50	12.00	6.40	F1 ONLY	DD .XXXX	±.0005					FMF	
1750	326T	13.75	31.00	12.00	9.12	F1 ONLY	CHK ANG	±1/2"					PREV	
THIS DRAWING IN DESIGN AND DETAIL IS OUR PROPERTY AND MUST NOT BE USED EXCEPT IN CONNECTION WITH OUR WORK ALL RIGHTS OF DESIGN AND INVENTION ARE RESERVED THIS IS AN ELECTRONICALLY GENERATED DOCUMENT - DO NOT SCALE THIS PRINT							RFP				CAD FILE SS300978	SIZE B	DRAWING NO. SS300978	PAGE 1 OF 1 REV. 3
							DIST LB							



NO.	REVISION	BY & DATE	CHK	ANG	TOLERANCES UNLESS SPECIFIED		DRAWN RM	11/20/1990
					DEC.	INCHES		
5	CHG TO REGAL LOGO	SL 09/10/2015	AB				CHK	ML 11/21/1990
4	REVISED IEC NOTATIONS	MSG 11/15/2011	CMN	.X	±.1		APPD	SAS 04/24/2003
3	ADDED IEC NOTATIONS... (U1), (V1) ETC. MU95194	MSG 5/10/2010	MJS	.XX	±.02		SCALE	1=1
2	ADDED THE OPTIONAL CORD CONNECTION MU46318	RDH 04/24/2003	DRS	.XXX	±.005		REF	
1	REDRAWN	RM 11/20/1990		.XXXX	±.0005		FMF	
					±7'30"		PREV	
THIS DRAWING IN DESIGN AND DETAIL IS OUR PROPERTY AND MUST NOT BE USED EXCEPT IN CONNECTION WITH OUR WORK ALL RIGHTS OF DESIGN AND INVENTION ARE RESERVED THIS IS AN ELECTRONICALLY GENERATED DOCUMENT - DO NOT SCALE THIS PRINT					RFP	CAD FILE ee7308	SIZE	DRAWING NO. PAGE OF REV.
					DIST WP		A	EE7308 5