

# PRODUCT INFORMATION PACKET

marathon®  
Motors

Model No: 326TSTDC6001

Catalog No: U778

General Purpose Motor, 60 & 60 HP, 3 Ph, 60 & 50 Hz, 208-230/460 & 200/400 V, 3600 & 3000 RPM,  
326TS Frame, DP



Regal and Marathon are trademarks of Regal Rexnord Corporation or one of its affiliated companies.

©2023 Regal Rexnord Corporation, All Rights Reserved. MC017097E

RegalRexnord



**Nameplate Specifications**

Phase	3	Output HP	60 & 60 Hp
Output KW	45.0 & 45.0 kW	Voltage	208-230/460 & 200/400 V
Speed	3555 & 2945 rpm	Service Factor	1.15 & 1.0
Frame	326TS	Enclosure	Drip Proof
Thermal Protection	No Protection	Efficiency	94.1 & 93.5 %
Ambient Temperature	40 °C	Frequency	60 & 50 Hz
Current	145-136/68 & 154/77 A	Power Factor	88
Duty	Continuous	Insulation Class	F
Design Code	B	KVA Code	H
Drive End Bearing Size	6312	Opp Drive End Bearing Size	6311
UL	Recognized	CSA	Y
CE	Y	IP Code	12
Number of Speeds	1		

**Technical Specifications**

Electrical Type	Squirrel Cage Induction Run	Starting Method	Part Wdg Start Low Volt Only & Wye Start Delta Run
Poles	2	Rotation	Reversible
Resistance Main	.098 Ohms	Mounting	Rigid Base
Motor Orientation	Horizontal	Drive End Bearing	Ball
Opp Drive End Bearing	Ball	Frame Material	Cast Iron
Shaft Type	TS	Overall Length	26.02 in
Shaft Diameter	1.875 in	Shaft Extension	3.75 in
Assembly/Box Mounting	F1 ONLY		
Connection Drawing	004172-01ME	Outline Drawing	SS622387

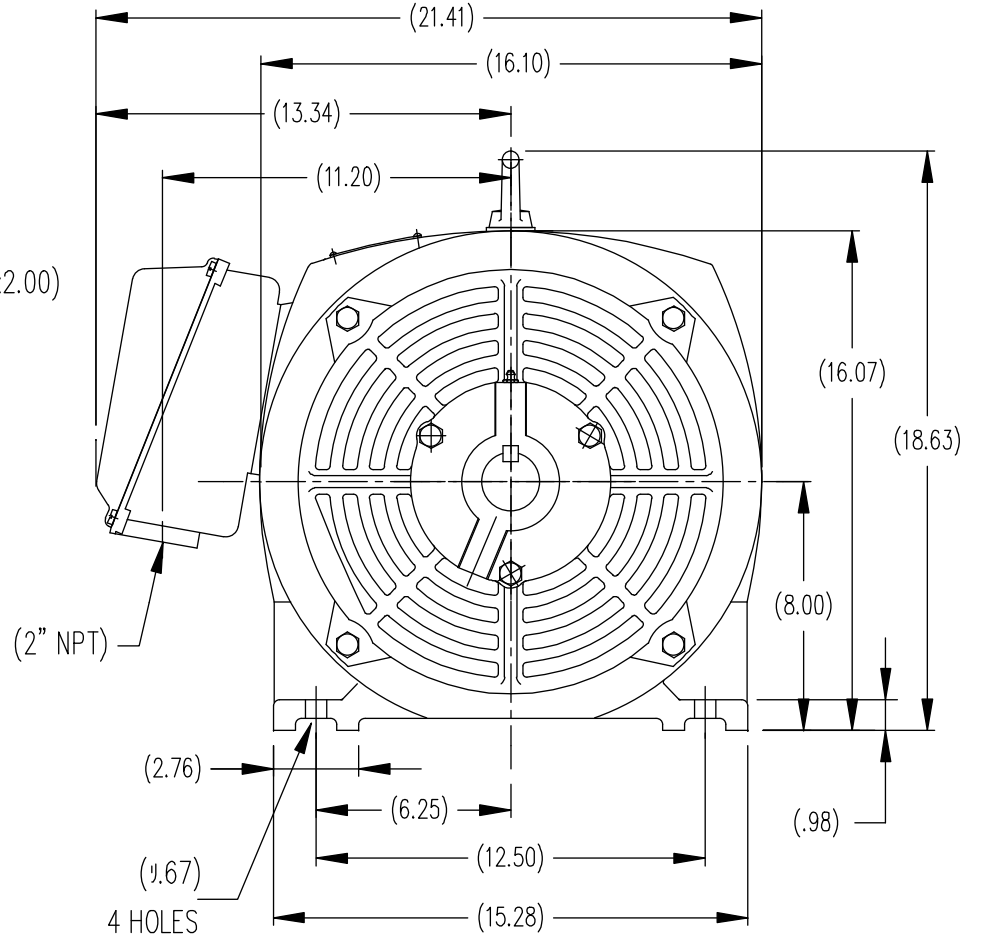
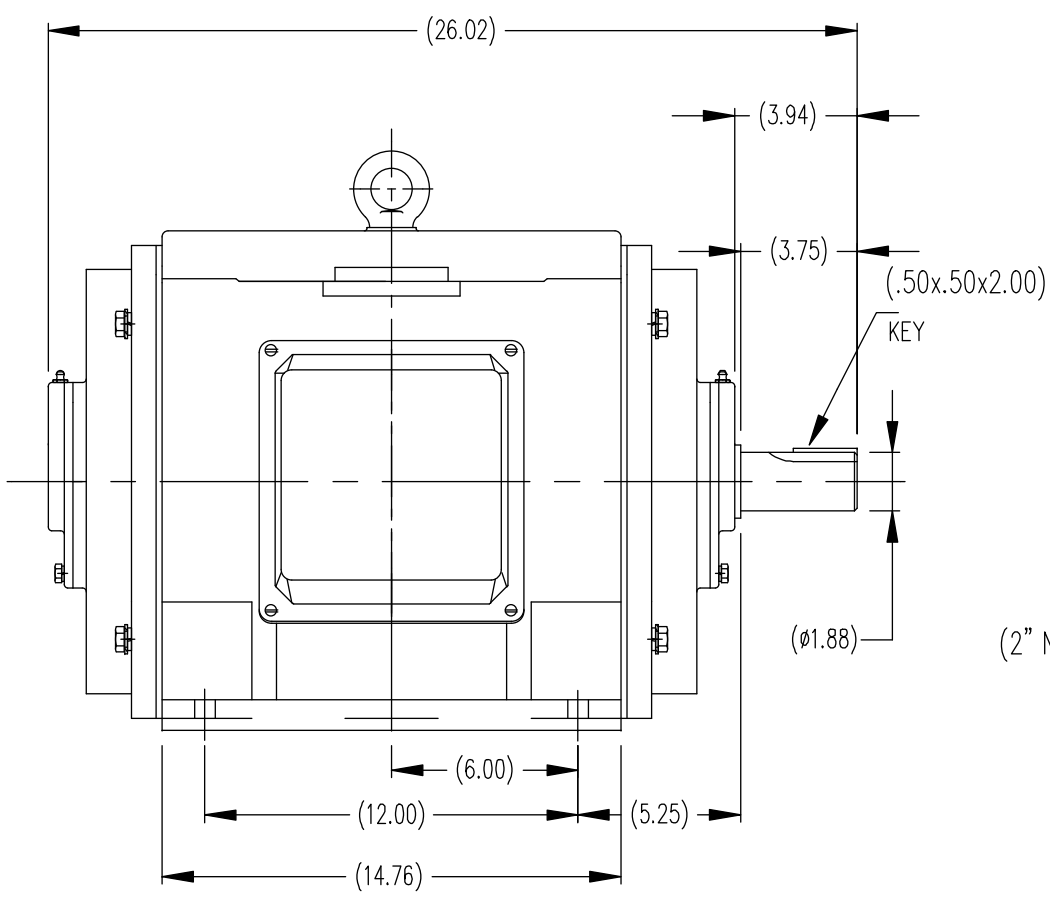

		TOLERANCES UNLESS SPECIFIED		<b>REGAL</b> REGAL-BELOIT CORPORATION	DRAWN MOL 12-15-2012								
		DEC.	INCHES		CHK MOL 12-15-2012								
		.X	±.1	TITLE OUTLINE 326TS FR.-ODP	APPD								
		.XX	±.03		SCALE 1=1								
		.XXX	±.005		REF 169555-60ME								
		.XXXX	±.0005		FMF U778								
NO.	REVISION	BY & DATE	CHK	ANG	±1/2	FINISH	RFP	CAD FILE	SS622387	SIZE	DRAWING NO.	REV.	
THIS DRAWING IN DESIGN AND DETAIL IS OUR PROPERTY AND MUST NOT BE USED EXCEPT IN CONNECTION WITH OUR WORK ALL RIGHTS OF DESIGN AND INVENTION ARE RESERVED THIS IS AN ELECTRONICALLY GENERATED DOCUMENT - DO NOT SCALE THIS PRINT							DIST				B	SS622387	

WYE - DELTA STARTING USEABLE ON 2, 4 AND 6 POLE MOTORS.

LOW VOLTAGE CONNECTION

HIGH VOLTAGE CONNECTION

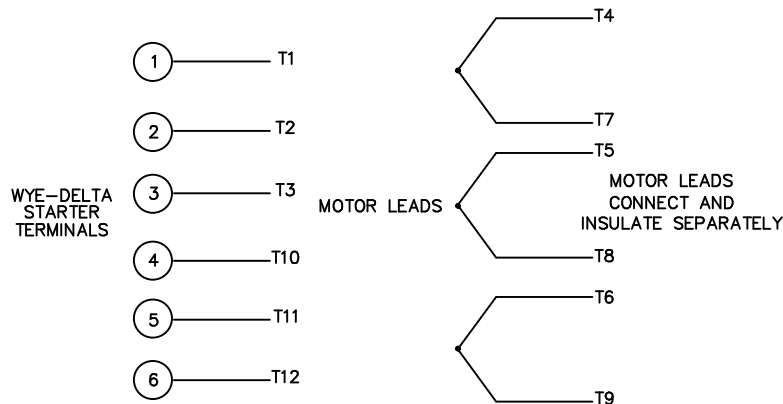
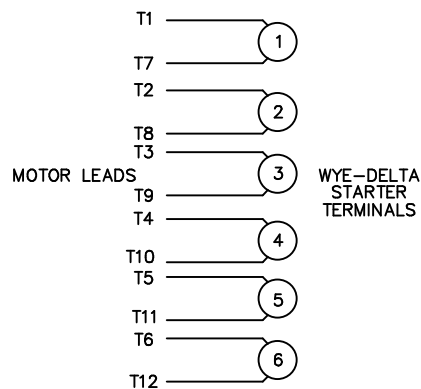

REFER TO THE WYE-DELTA STARTER CONNECTION INSTRUCTIONS FOR PROPER CONNECTION OF POWER LINES TO STARTER.

PART WINDING START USABLE ON 4 & 6 POLE MOTORS  
LOW VOLTAGE CONNECTION ONLY

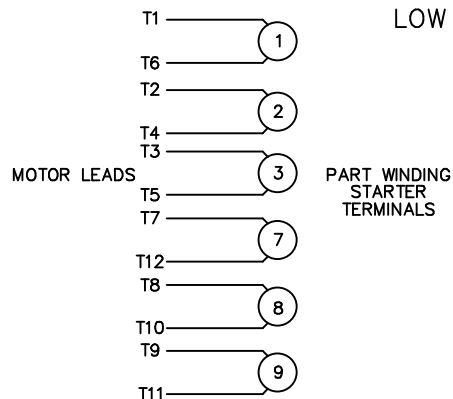

REFER TO THE PART WINDING STARTER INSTRUCTIONS FOR PROPER CONNECTION OF POWER LINES TO STARTER.

REFER TO THE CUTLER-HAMMER OR EQUIV. FOR PROPER SELECTION OF OVERLOAD HEATER COILS.

LINE LEADS

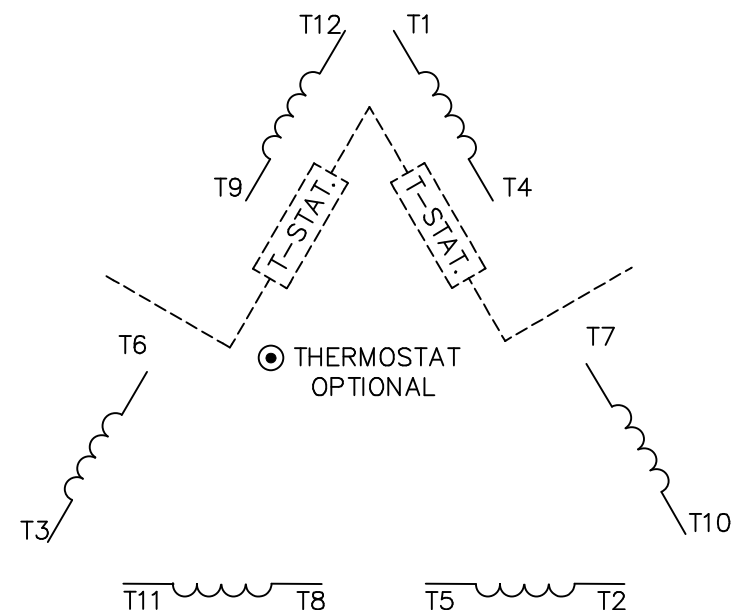

ROTATION CAN BE REVERSED BY INTERCHANGING ANY TWO LINE LEADS  
● RED LEADS OR P1, P2, FOR N/C THERMOSTAT

ACROSS THE LINE START & RUN

	LINE 1	LINE 2	LINE 3	JOIN & INSULATE SEPARATELY
HIGH VOLT	T1,T12	T2,T10	T3,T11	(T4,T7) (T5,T8) (T6,T9)
LOW VOLT	T1,T6 T7,T12	T2,T4 T8,T10	T3,T5 T9,T11	

TOLERANCES UNLESS SPECIFIED  
DEC. INCHES

.X	±.1
.XX	±.02
.XXX	±.005
.XXXX	±.0005
ANG	±7'30"



TITLE DELTA - WYE CONNECTION DIAGRAM

DRAWN	RJW 07-19-2007
CHK	ML 07-19-2007
APPD	GK 07-19-2007
SCALE	1=1
REF	MU61151
FMF	
PREV	

NO.	REVISION	BY & DATE	CHK	ANG	FINISH
			RFP	07-19-2007	CAD FILE 004172-01ME
				DIST LB	

THIS DRAWING IN DESIGN AND DETAIL IS OUR PROPERTY AND MUST NOT BE USED EXCEPT IN CONNECTION WITH OUR WORK ALL RIGHTS OF DESIGN AND INVENTION ARE RESERVED THIS IS AN ELECTRONICALLY GENERATED DOCUMENT - DO NOT SCALE THIS PRINT

RFP 07-19-2007

CAD FILE 004172-01ME

SIZE A DRAWING NO. PAGE 1 OF 1 REV.

004172-01ME