

PRODUCT INFORMATION PACKET

Model No: 324TTFC6081

Catalog No: E009

25 HP General Purpose Motor, 3 phase, 1200 RPM, 575 V, 324T Frame, TEFC
General Purpose Motors



Regal and Marathon are trademarks of Regal Rexnord Corporation or one of its affiliated companies.
©2021 Regal Rexnord Corporation, All Rights Reserved. MC017097E



Nameplate Specifications

Output HP	25 Hp	Output KW	18.7 kW
Frequency	60 Hz	Voltage	575 V
Current	26.4 A	Speed	1190 rpm
Service Factor	1.15	Phase	3
Efficiency	93.6 %	Power Factor	76
Duty	Continuous	Insulation Class	F
Design Code	B	KVA Code	G
Frame	324T	Enclosure	Totally Enclosed Fan Cooled
Thermal Protection	No	Ambient Temperature	40 °C
Drive End Bearing Size	6312	Opp Drive End Bearing Size	6312
UL	Recognized	CSA	Y
CE	Y	IP Code	43
Number of Speeds	1		

Technical Specifications

Electrical Type	Squirrel Cage Inverter Rated	Starting Method	Line Or Inverter
Poles	6	Rotation	Reversible
Mounting	Rigid Base	Motor Orientation	Horizontal
Drive End Bearing	Ball	Opp Drive End Bearing	Ball
Frame Material	Cast Iron	Shaft Type	T
Overall Length	29.53 in	Shaft Diameter	2.130 in
Shaft Extension	5.25 in	Assembly/Box Mounting	F1/F2 CAPABLE
Connection Drawing	00519001ME	Outline Drawing	16954160ME

This is an uncontrolled document once printed or downloaded and is subject to change without notice. Date Created:10/12/2021

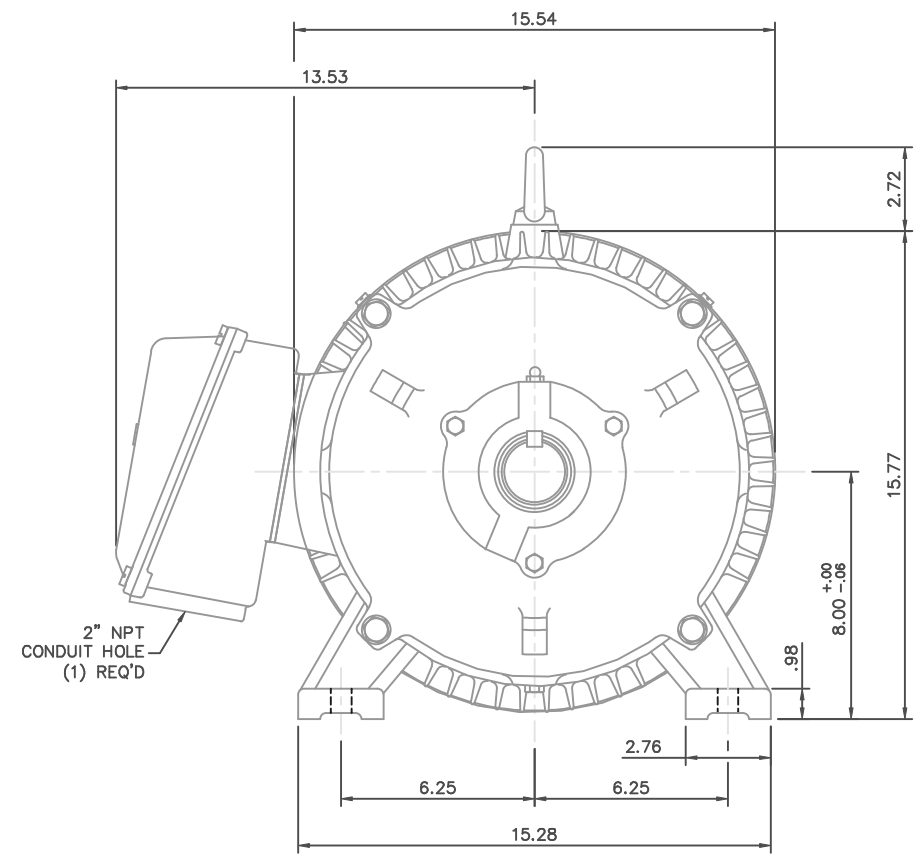
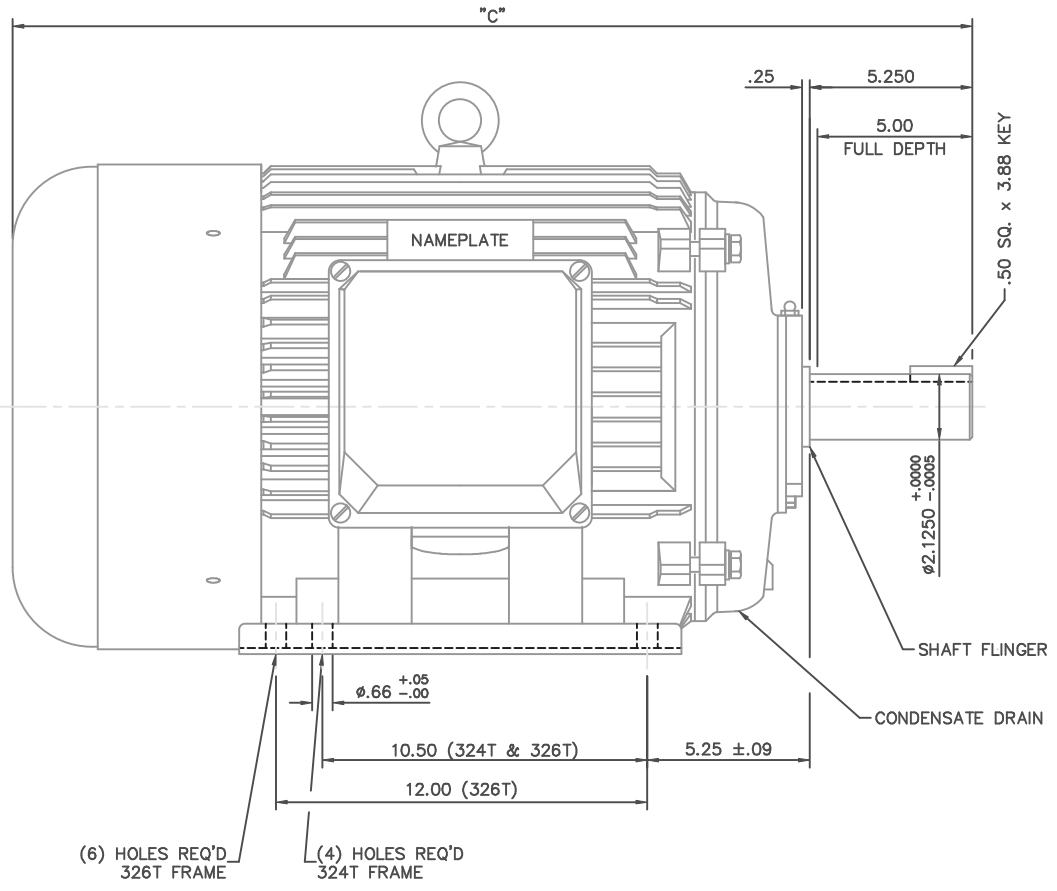

FRAME DESIGN	"C"
324T	29.53
326T	31.02

(6) HOLES REQ'D
326T FRAME

(4) HOLES REQ'D
324T FRAME

		TO TOLERANCES UNLESS SPECIFIED			DRAWN	JJK 03/29/99			
		DEC.	INCHES		CHK				
		.X	±.1	TITLE	OUTLINE - 320T FRAME				
		.XX	±.03	MAT'L	TEFC - RIGID				
		.XXX	±.005	FINISH	CAST IRON				
01	ADDED HOLE FOR 326T BASE	JJK	07/13/99	CHK	ANG	±1/2"			
NO.	REVISION	BY & DATE	CHK	ANG	±1/2"	FINISH			
THIS DRAWING IN DESIGN AND DETAIL IS OUR PROPERTY AND MUST NOT BE USED EXCEPT IN CONNECTION WITH OUR WORK ALL RIGHTS OF DESIGN AND INVENTION ARE RESERVED THIS IS AN ELECTRONICALLY GENERATED DOCUMENT - DO NOT SCALE THIS PRINT				RFP	CAD FILE	16954160ME	SIZE	DRAWING NO.	REV.
				DIST			B	169541-60ME	01

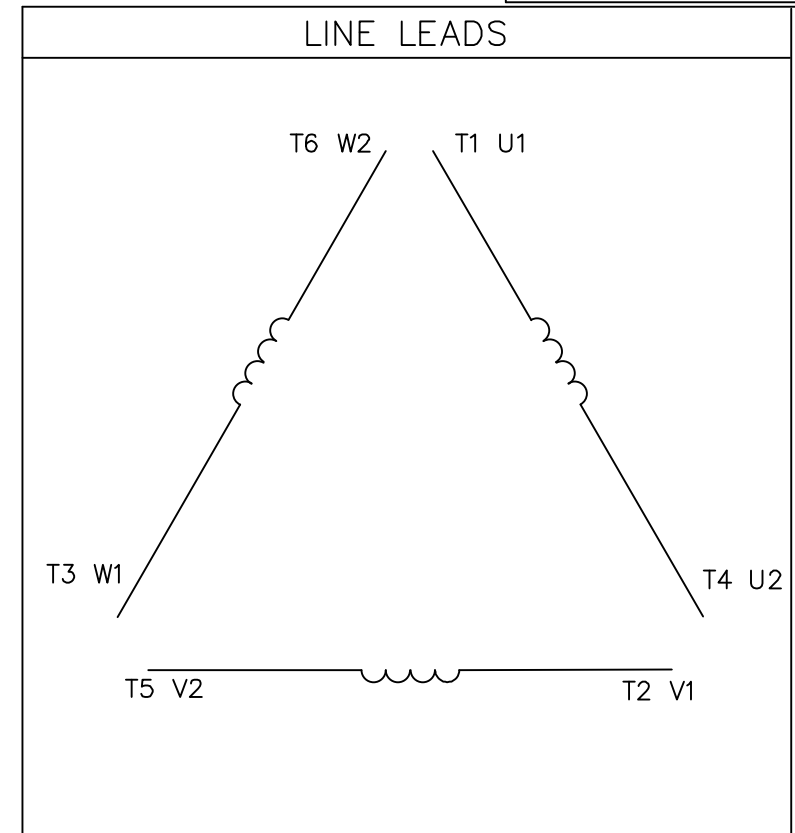
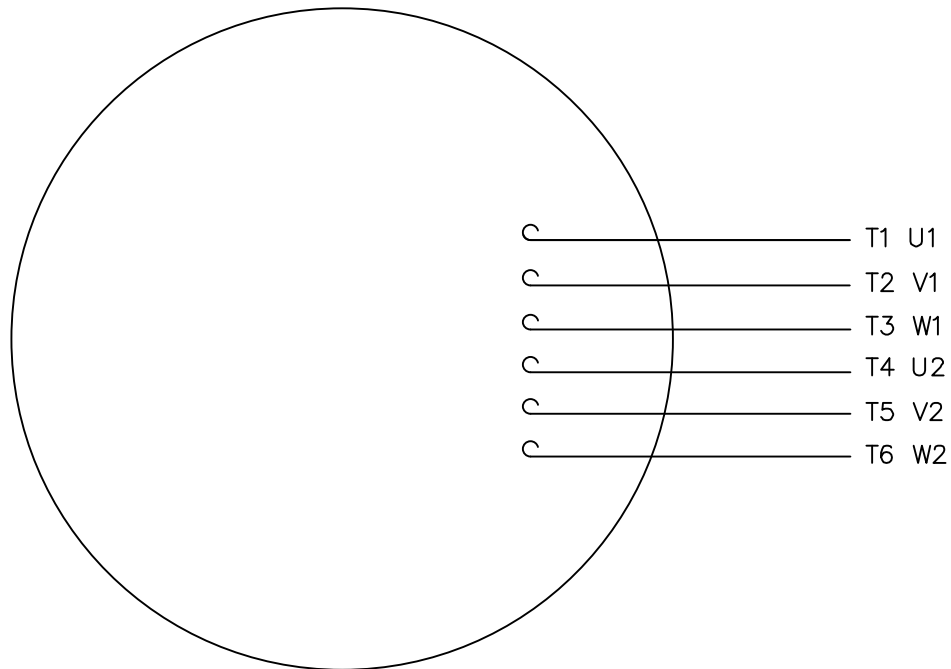

	L1	L2	L3	JOIN
START (WYE)	T1 U1	T2 V1	T3 U2	(T4,T5,T6) (U2,V2,W2)
RUN (DELTA)	(T1,T6) (U1,W2)	(T2,T4) (V1,U2)	(T3,T5) (W1,V2)	

				TOLERANCES UNLESS SPECIFIED				DRAWN PG 05/07/82	
				DEC.	INCHES			CHK	
				.X	±.1	TITLE EXTERNAL WIRING DIAGRAM STAR START - DELTA RUN		APPD TEM 05/07/82	
03	ADDED IEC DESIGNATIONS	MOL 04/27/12	.XX	±.01	MAT'L. Y-CONNECTED START - DELTA CONNECTED RUN			SCALE 1=1	
02	REMOVED OBSOLETE STATUS	KJH 06/28/99	.XXX	±.005			FINISH SINGLE VOLTAGE		REF
01	REDRAWN ON CAD	DBT 05/30/97	.XXXX	±.0005	NO. REVISION BY & DATE				FMF
			CHK	ANG			±1/2'	PREV	
THIS DRAWING IN DESIGN AND DETAIL IS OUR PROPERTY AND MUST NOT BE USED EXCEPT IN CONNECTION WITH OUR WORK ALL RIGHTS OF DESIGN AND INVENTION ARE RESERVED THIS IS AN ELECTRONICALLY GENERATED DOCUMENT - DO NOT SCALE THIS PRINT				RFP	CAD FILE 00519001ME		SIZE	DRAWING NO.	REV.
				DIST			A	005190-01ME	03

Data Sheet

324TTC6081

Date: 12/14/2018
 Customer: _____
 Attention: _____
 Submitted by: FAREEDA DUDEKULA



Submittal

Data @ 575 V

Motor Load Data

Load	0%	25%	50%	75%	100%	115%	125%	LR
Current (Amps)	11.6	13.2	16.8	21.2	26.4	30.4	32.8	146
Torque (ft-lb)	0.00	27.0	56.0	84.0	111	128	141	193
RPM	1200	1198	1195	1192	1190	1,188	1185	0
Efficiency (%)		84.0	92.4	93.6	93.6	93.0	93.0	
P.F. (%)	5.8	41.0	62.0	72.0	76.0	78.0	78.5	0.0

Motor Speed Data

	LR	Pull-Up	BD	Rated	Idle
Speed (RPM)	0	600	1100	1190	1200
Current (Amps)	146	140	108	26.4	11.6
Torque (ft-lb)	193	180	260	111	0.00

Information Block

HP	25.0			
Sync. RPM	1200			
Frame	324			
Enclosure	TEFC			
Construction	TFS			
Voltage	575 V			
Frequency	60 Hz			
Design	B			
LR Code letter	G			
Service Factor	1.15			
Temp Rise @ FL	48 °C			
Duty	CONT			
Ambient	40 °C			
Elevation	1,000 feet			
Rotor/Shaft wk ²	0.00 Lb-Ft ²			
Ref Wdg	T16106011 FR			
Sound Pressure @ 1M	70 dBA			
VFD Rating	VARIABLE 10:1			
Outline Dwg	16954160ME			
Conn. Diag	00519001ME			
Additional Specifications:				
0				
0				
EQUIV CKT (OHMS / PHASE)				
R1	R2	X1	X2	Xm
0.0000	0.0000	0.0000	0.0000	0.0000

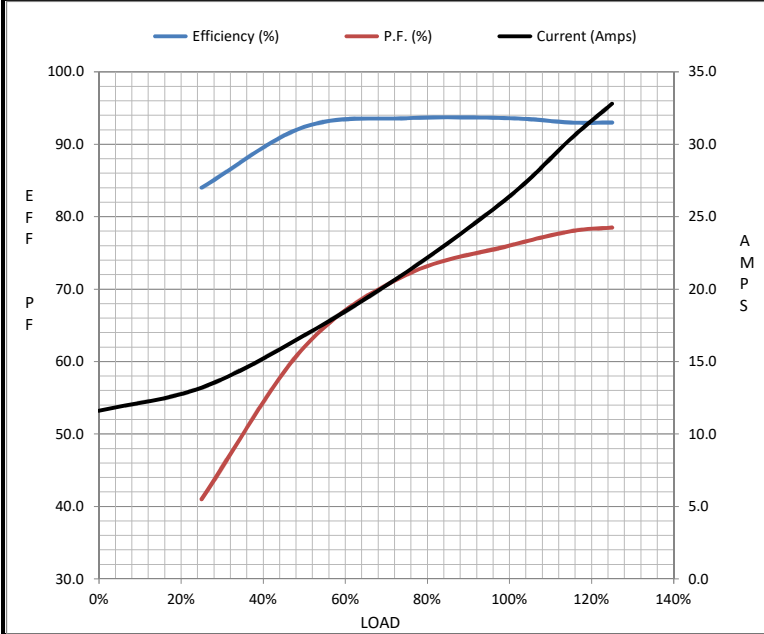

Speed - Torque Curve

