

PRODUCT INFORMATION PACKET

Model No: 324TTDP7687

Catalog No: Y217

Kiln Duty Motor, 25 HP, 3 Ph, 60 Hz, 460/796 V, 1200 RPM, 324T Frame, DP



Regal and Marathon are trademarks of Regal Rexnord Corporation or one of its affiliated companies.
©2022 Regal Rexnord Corporation, All Rights Reserved. MC017097E



Nameplate Specifications

Output HP	25 Hp	Output KW	18.7 kW
Frequency	60 Hz	Voltage	460/796 V
Current	34.0/19.7 A	Speed	1140 rpm
Service Factor	1.15	Phase	3
Efficiency	88.5 %	Power Factor	78
Duty	Oil Well	Insulation Class	F
Design Code	D	KVA Code	H
Frame	324T	Enclosure	Drip Proof
Thermal Protection	No Protection	Ambient Temperature	40 °C
Drive End Bearing Size	6312	Opp Drive End Bearing Size	6311
UL	No	CSA	N
CE	N	IP Code	12
Number of Speeds	1		

Technical Specifications

Electrical Type	Squirrel Cage Induction Run	Starting Method	Across The Line
Poles	6	Rotation	Reversible
Resistance Main	.32 Ohms	Mounting	Rigid Base
Motor Orientation	Horizontal	Drive End Bearing	Ball
Opp Drive End Bearing	Ball	Frame Material	Cast Iron
Shaft Type	T	Overall Length	26.00 in
Frame Length	13.62 in	Shaft Diameter	2.125 in
Shaft Extension	5.52 in	Assembly/Box Mounting	F2/F1 Capable
Connection Drawing	A-EE7304H	Outline Drawing	B-SS200218-1362

This is an uncontrolled document once printed or downloaded and is subject to change without notice. Date Created:11/28/2022

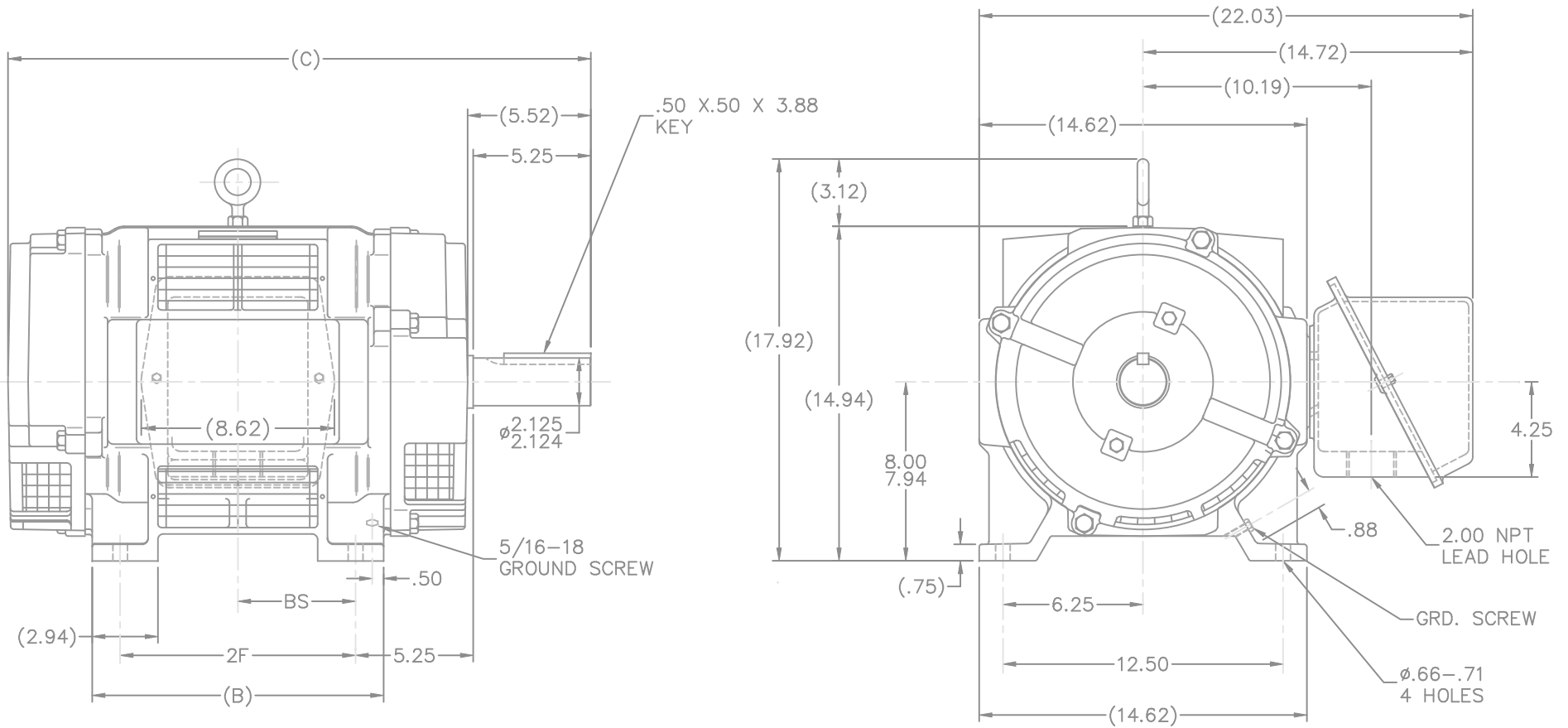

NOTES:

1. BOX CAN BE ROTATED IN 90° STEPS
2. BOX CAN BE MOUNTED F1 ON OPPOSITE SIDE BY REMOVING BRACKETS AND TURNING FRAME 180°
3. NAMEPLATE TO BE READ FROM CONDUIT BOX SIDE OF MOTOR

(SS200150)

DASH	FRAME	B	C	2F	BS
1362	324T	13.00	26.00	10.50	5.25
1512	326T	14.50	27.50	12.00	6.00

		TOLERANCES UNLESS SPECIFIED		MARATHON ELECTRIC		DRAWN JL 07-30-1990					
		DEC.	INCHES			CHK	ML 07-30-1990				
6	REDRAWN IN AUTOCAD	TAT	06-13-2005	ML	.X	±.1	APPD GK 07-30-1990				
5	UPDATED C'BOX GEOMETRY CN 28424	DRS	01-06-2000		.XX	±.03	SCALE 7=32				
4	UPDATED SHAFT HEIGHT CN 16763	DRS	09-27-1996		.XXX	±.005	REF				
3	REVISED TO F2 MOUNTING	DA	09-22-1992		.XXXX	±.0005	FMF				
NO.	REVISION	BY & DATE	CHK	ANG	±7'30"	MAT'L	PREV				
THIS DRAWING IN DESIGN AND DETAIL IS OUR PROPERTY AND MUST NOT BE USED EXCEPT IN CONNECTION WITH OUR WORK ALL RIGHTS OF DESIGN AND INVENTION ARE RESERVED THIS IS AN ELECTRONICALLY GENERATED DOCUMENT - DO NOT SCALE THIS PRINT						RFP	CAD FILE ss200218	SIZE B	DRAWING NO. SS200218	PAGE OF 6	REV. 6
						DIST WA					

"Y" RUN

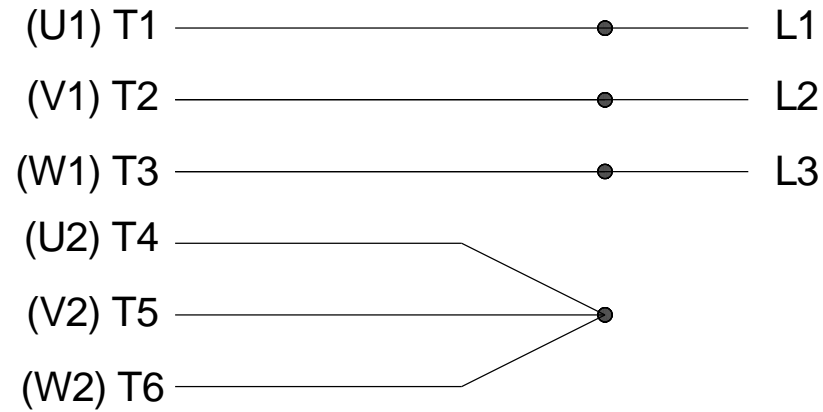

"Δ" BOOST

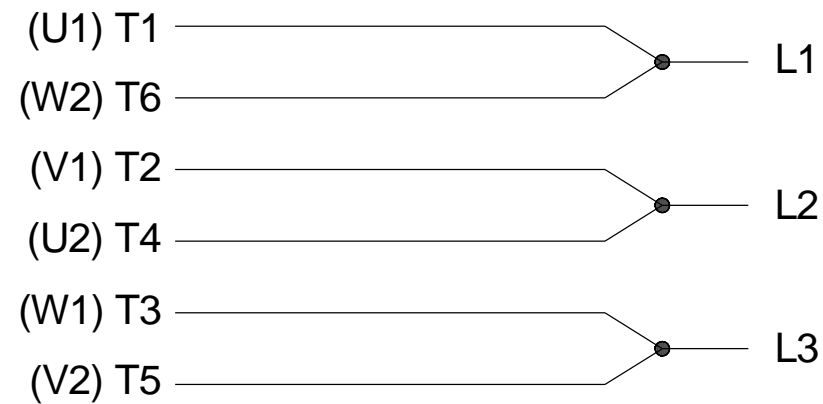

WHEN MORE THAN ONE
 PROTECTOR IS USED,
 CONNECT IN SERIES

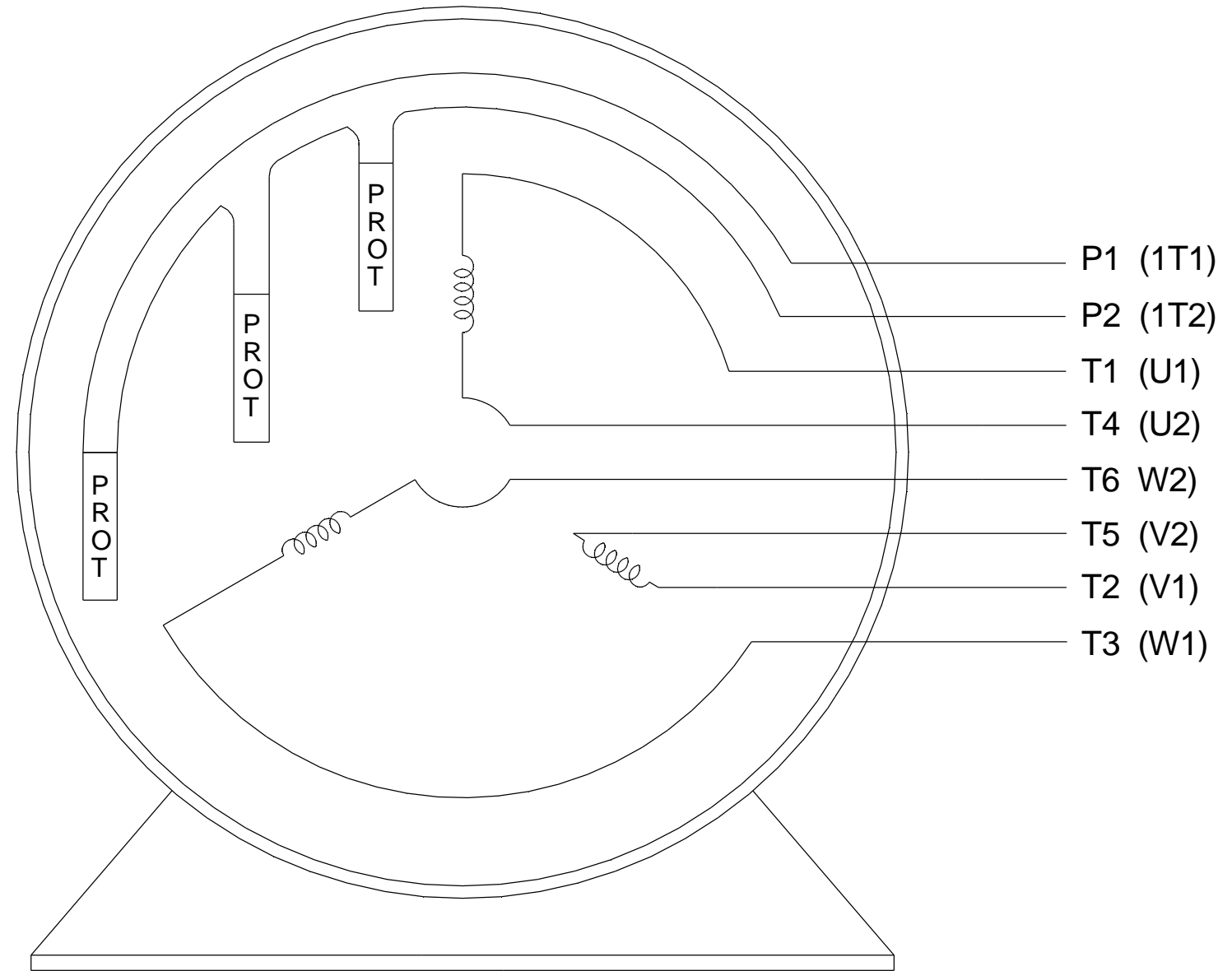

VIEW OF TERMINAL END
 3 ∅ DUAL VOLTAGE MOTOR

DRAWING REVISION A	REVISION BY HV	DATE 12-17-2014	TOLERANCES UNLESS OTHERWISE SPECIFIED: DEC. INCH mm ANGLE .X ±0.1 [±2.5] ±0.5° .XX ±0.01 [±0.25] .XXX ±0.005 [±0.127] .XXXX ±0.0005 [±0.0127] REMOVE BURRS & BREAK SHARP EDGES: .003/.015 [.076/.381] CORNER FILLETS: .02 [.51] MACHINED SURFACES: 125/ INCH 3.2/ mm	DRAWN BY BLR	Regal Beloit America, Inc.
ECO ECO-0065198	APPROVED BY EMH	DATE 12-17-2014		DATE 03-07-1998	
ECO DESCRIPTION REDRAWN IN SOLIDWORKS, REMOVED GRND. NOTE COPYRIGHT REGAL BELOIT AMERICA, INC. ALL RIGHTS RESERVED. PROPRIETARY AND CONFIDENTIAL INFORMATION - THIS DOCUMENT IS THE PROPERTY OF REGAL BELOIT AMERICA, INC. ("OWNER") AND CONTAINS OWNER'S PROPRIETARY INFORMATION. ANY PERSON, CORPORATION OR OTHER FIRM RECEIVING IT IS DEEMED, BY RECEIVING IT, TO AGREE THAT IT, AND/OR ANY PART OF IT, SHALL NOT BE DISCLOSED TO ANY PERSON, CORPORATION OR OTHER ENTITY, DUPLICATED, AND/OR USED, EXCEPT AS EXPRESSLY APPROVED IN WRITING IN ADVANCE BY OWNER. THIS DOCUMENT SHALL BE RETURNED TO OWNER UPON REQUEST. IT MAY BE SUBJECT TO CERTAIN RESTRICTIONS UNDER APPLICABLE EXPORT CONTROL LAWS AND REGULATIONS.			REFERENCE THIRD ANGLE PROJECTION	MATERIAL	PROCESS/FINISH
			SIZE A	DRAWING NUMBER EE7304H	SHEET 1 OF 1

Data Sheet

Date: 6/19/2017

324TTDP7687

Customer: _____



Attention: _____

Submittal

Submitted by: FAREEDA DUDEKULA

Data @ 460 V

Motor Load Data

Load	0%	25%	50%	75%	100%	115%	125%	LR
Current (Amps)	18.5	19.0	23.0	27.5	34.0	38.5	41.5	218
Torque (ft-lb)	0.00	28.0	56.0	85.5	115	135	147	317
RPM	1200	1185	1175	1155	1140	1,120	1105	0
Efficiency (%)		83.4	88.6	89.2	88.5	86.6	87.0	
P.F. (%)	7.0	37.0	58.0	71.0	78.0	81.5	81.5	48.0

Motor Speed Data

	LR	Pull-Up	BD	Rated	Idle
Speed (RPM)	0	100	750	1140	1200
Current (Amps)	218	217	158	34.0	18.5
Torque (ft-lb)	317	299	404	115	0.00

Information Block				
HP	25.0			
Sync. RPM	1200			
Frame	324			
Enclosure	DP			
Construction	TDP			
Voltage	460/796 V			
Frequency	60 Hz			
Design	A			
LR Code letter	H			
Service Factor	1.15			
Temp Rise @ FL	55 °C			
Duty	CONT			
Ambient	40 °C			
Elevation	1,000 feet			
Rotor/Shaft wk ²	4.4 Lb-Ft ²			
Ref Wdg	286669 NONE			
Sound Pressure @ 1M	69 dBA			
VFD Rating	NONE			
Outline Dwg	B-SS200218-1362			
Conn. Diag	A-EE7304H			
Additional Specifications:				
0				
0				
EQUIV CKT (OHMS / PHASE)				
R1	R2	X1	X2	Xm
0.1880	0.4850	1.0330	0.5360	15.3910

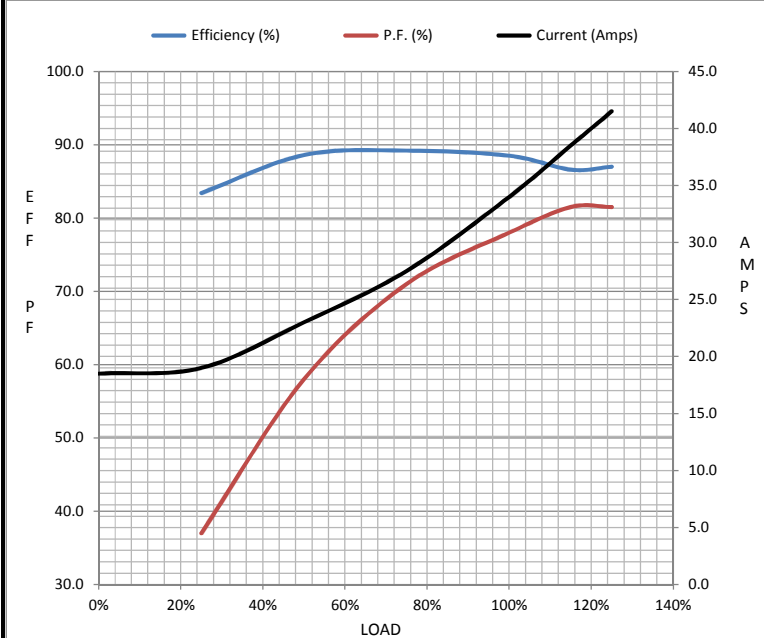

Speed -Torque Curve

