

PRODUCT INFORMATION PACKET

marathon®
Motors

Model No: 284TSTGP1001

Catalog No: U956

Other Purpose Motor, 25 & 20 HP, 3 Ph, 60 & 50 Hz, 230/460 & 190/380 V, 3600 & 3000 RPM,
284TS Frame, EPFC



Regal and Marathon are trademarks of Regal Rexnord Corporation or one of its affiliated companies.

©2023 Regal Rexnord Corporation, All Rights Reserved. MC017097E

RegalRexnord

Nameplate Specifications

Phase	3	Output HP	25 & 20 Hp
Output KW	18.7 & 14.9 kW	Voltage	230/460 & 190/380 V
Speed	3525 & 2925 rpm	Service Factor	1.15 & 1.15
Frame	284TS	Enclosure	Explosion Proof Fan cooled
Thermal Protection	No Protection	Efficiency	91 & 90.2 %
Ambient Temperature	40 °C	Frequency	60 & 50 Hz
Current	60/30 & 57.5/28.8 A	Power Factor	86.5
Duty	Continuous	Insulation Class	F
Design Code	B	KVA Code	G
Drive End Bearing Size	6311	Opp Drive End Bearing Size	6210
UL	Listed	CSA	Y
CE	N	IP Code	54
Number of Speeds	1		

Technical Specifications

Electrical Type	Squirrel Cage Inverter Rated	Starting Method	Line Or Inverter
Poles	2	Rotation	Reversible
Resistance Main	.033 Ohms	Mounting	Rigid Base
Motor Orientation	Horizontal	Drive End Bearing	Ball
Opp Drive End Bearing	Ball	Frame Material	Cast Iron
Shaft Type	TS	Overall Length	24.89 in
Frame Length	12.75 in	Shaft Diameter	1.625 in
Shaft Extension	3.25 in	Assembly/Box Mounting	F1 ONLY
Outline Drawing	B-SS311006-1275	Connection Drawing	A-EE7308

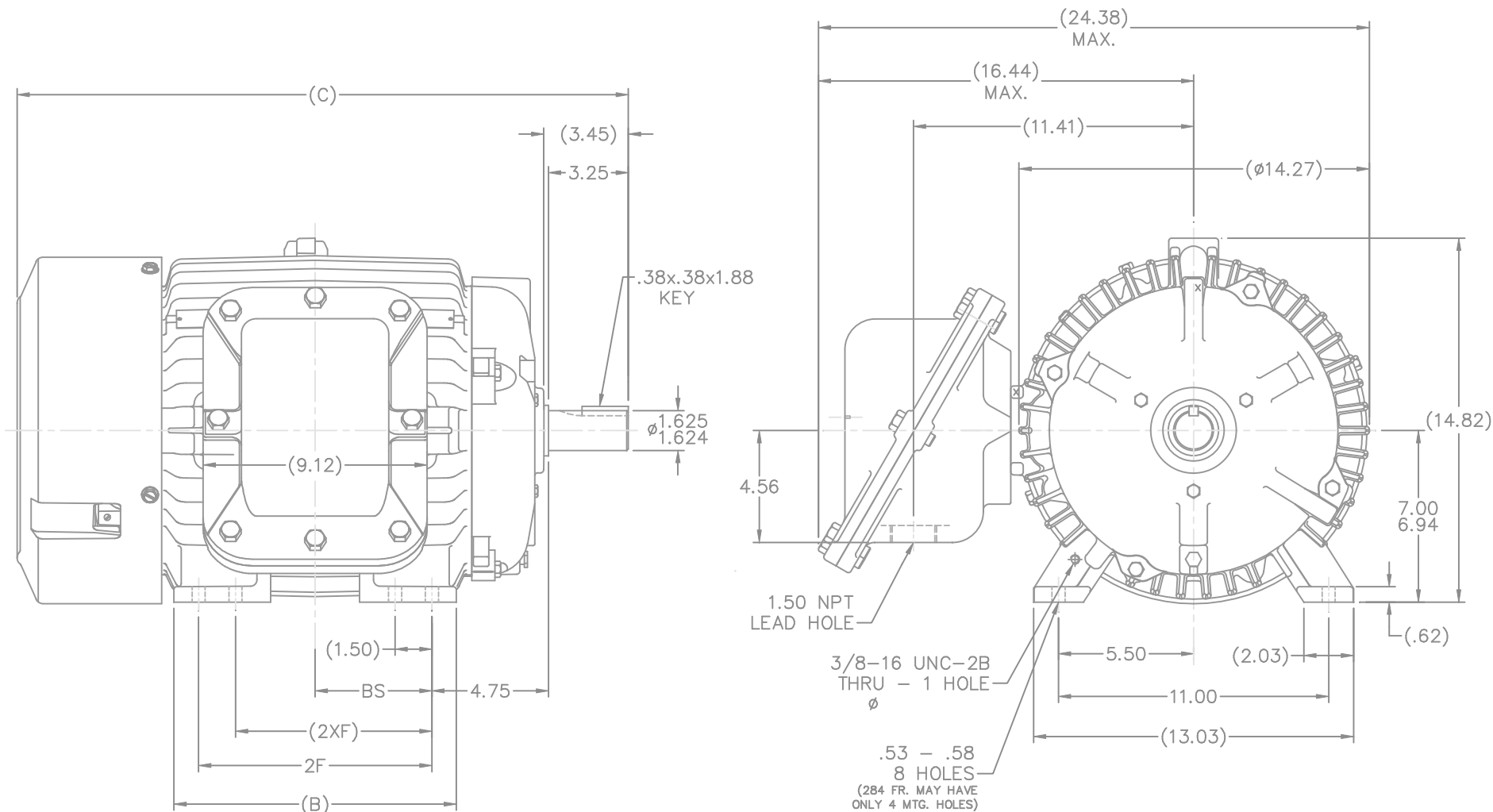

NOTES:

1. BOX CAN ONLY BE ROTATED CLOCKWISE UP TO 270° FROM ITS ORIGINAL POSITION.
2. NAMEPLATE TO BE READ FROM CONDUIT BOX SIDE OF MOTOR

DASH	FRAME	B	C	2F	2XF	BS
1275	284TS	11.50	24.89	9.50	---	4.75
1425	286TS	13.00	26.39	11.00	9.50	5.50

NO.	REVISION	BY & DATE	CHK	ANG	±7'30"	FINISH	PREV
7	UPDATED FRAME & ADDED COLUMN 2XF	JJB 03/07/2008	MG	UNLESS SPECIFIED			
6	UPDATED DRAWING	RJW 04-30-2007	DEC.	INCHES			
5	UPDATED C'BOX GEO. PER CASTING CHANGE CN29010	DRS 01-31-2000	.X	±.1			
4	REV'S. PER UPDATED CONDUIT BOX CN27400-239	DA 07-12-1999	.XX	±.03			
3	REMOVED SMALL C'BOX AND ADDED LARGE C'BOX	DA 04-14-1999	.XXX	±.005			
	W/R2.00 RADII CN27400-141		.XXX	±.0005			
THIS DRAWING IN DESIGN AND DETAIL IS OUR PROPERTY AND MUST NOT BE USED EXCEPT IN CONNECTION WITH OUR WORK. ALL RIGHTS OF DESIGN AND INVENTION ARE RESERVED. THIS IS AN ELECTRONICALLY GENERATED DOCUMENT - DO NOT SCALE THIS PRINT							
RFP							
DIST LB							
CAD FILE SS311006							
SIZE B							
DRAWING NO. SS311006							
PAGE OF 7							
REV.							



TITLE OUTLINE - EXP. PR. - TGP
280TS - BB - STD - 11.00 LAM
MAT'L

DRAWN DA 03-25-1999

CHK ML 03-25-1999

APPD SW 03-25-1999

SCALE 1=4

REF

FMF

PREV



				TOLERANCES UNLESS SPECIFIED		 Regal Beloit America, Inc.	DRAWN RM 11/20/1990				
5	CHG TO REGAL LOGO	SL 09/10/2015	AB	DEC.	INCHES		CHK ML 11/21/1990				
4	REVISED IEC NOTATIONS	MSG 11/15/2011	CMN	.X	±.1		APPD SAS 04/24/2003				
3	ADDED IEC NOTATIONS... (U1), (V1) ETC. MU95194	MSG 5/10/2010	MJS	.XX	±.02		SCALE 1=1				
2	ADDED THE OPTIONAL CORD CONNECTION MU46318	RDH 04/24/2003	DRS	.XXX	±.005	TITLE CONNECTION DIAGRAM 3ø – DUAL VOLTAGE MOTOR	REF				
1	REDRAWN	RM 11/20/1990		.XXXX	±.0005	MAT'L	FMF				
NO.	REVISION	BY & DATE	CHK	ANG	±7"30"	FINISH	PREV				
THIS DRAWING IN DESIGN AND DETAIL IS OUR PROPERTY AND MUST NOT BE USED EXCEPT IN CONNECTION WITH OUR WORK ALL RIGHTS OF DESIGN AND INVENTION ARE RESERVED THIS IS AN ELECTRONICALLY GENERATED DOCUMENT – DO NOT SCALE THIS PRINT			RFP		CAD FILE ee7308		SIZE	DRAWING NO.	PAGE	OF	REV.
			DIST WP				A	EE7308			5