

PRODUCT INFORMATION PACKET



Model No: 256TTFL4012

Catalog No: U352

20 HP Close-Coupled Pump Motor, 3 phase, 3600 RPM, 575 V, 256JM Frame, TEFC
Close-Coupled Pump Motors

Regal and Marathon are trademarks of Regal Rexnord Corporation or one of its affiliated companies.
©2021 Regal Rexnord Corporation, All Rights Reserved. MC017097E



Nameplate Specifications

Output HP	20 Hp	Output KW	14.9 kW
Frequency	60 Hz	Voltage	575 V
Current	18.8 A	Speed	3510 rpm
Service Factor	1.15	Phase	3
Efficiency	90.2 %	Power Factor	87.5
Duty	Continuous	Insulation Class	F
Design Code	B	KVA Code	G
Frame	256JM	Enclosure	Totally Enclosed Fan Cooled
Thermal Protection	No	Ambient Temperature	40 °C
Drive End Bearing Size	6309	Opp Drive End Bearing Size	6207
UL	Recognized	CSA	Y
CE	Y	IP Code	43
Number of Speeds	1		

Technical Specifications

Electrical Type	Squirrel Cage Induction Run	Starting Method	Across The Line
Poles	2	Rotation	Reversible
Resistance Main	.49 Ohms	Mounting	Rigid Base
Motor Orientation	Horizontal	Drive End Bearing	Ball
Opp Drive End Bearing	Ball	Frame Material	Aluminum
Shaft Type	JM	Overall Length	26.49 in
Shaft Diameter	1.625 in	Shaft Extension	5.28 in
Assembly/Box Mounting	F1/F2 Capable		
Connection Drawing	A-EE7300	Outline Drawing	B-SS84286-1275

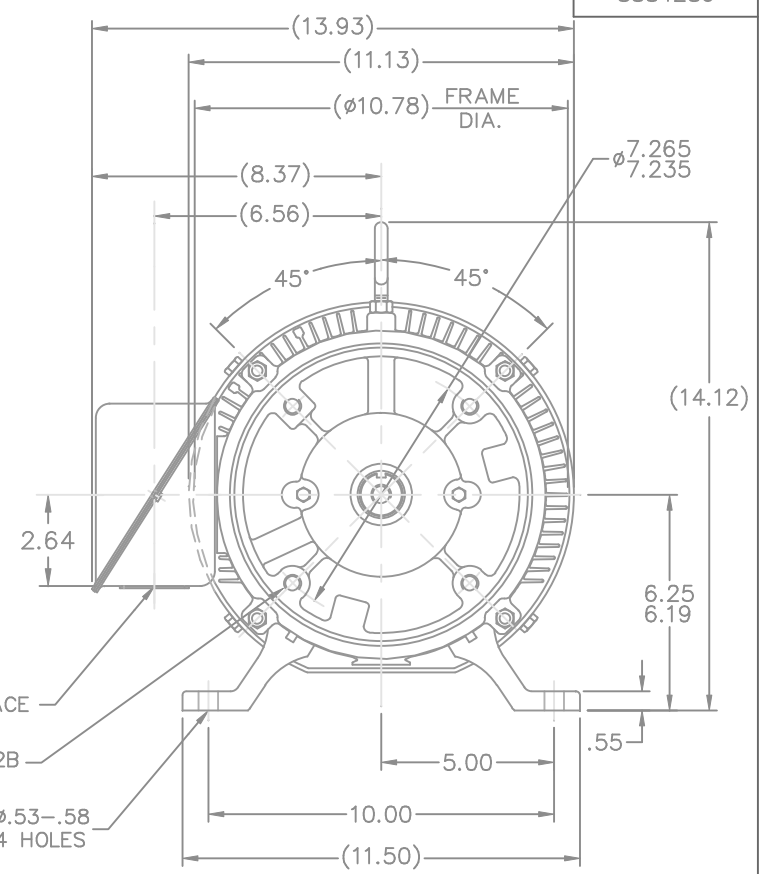
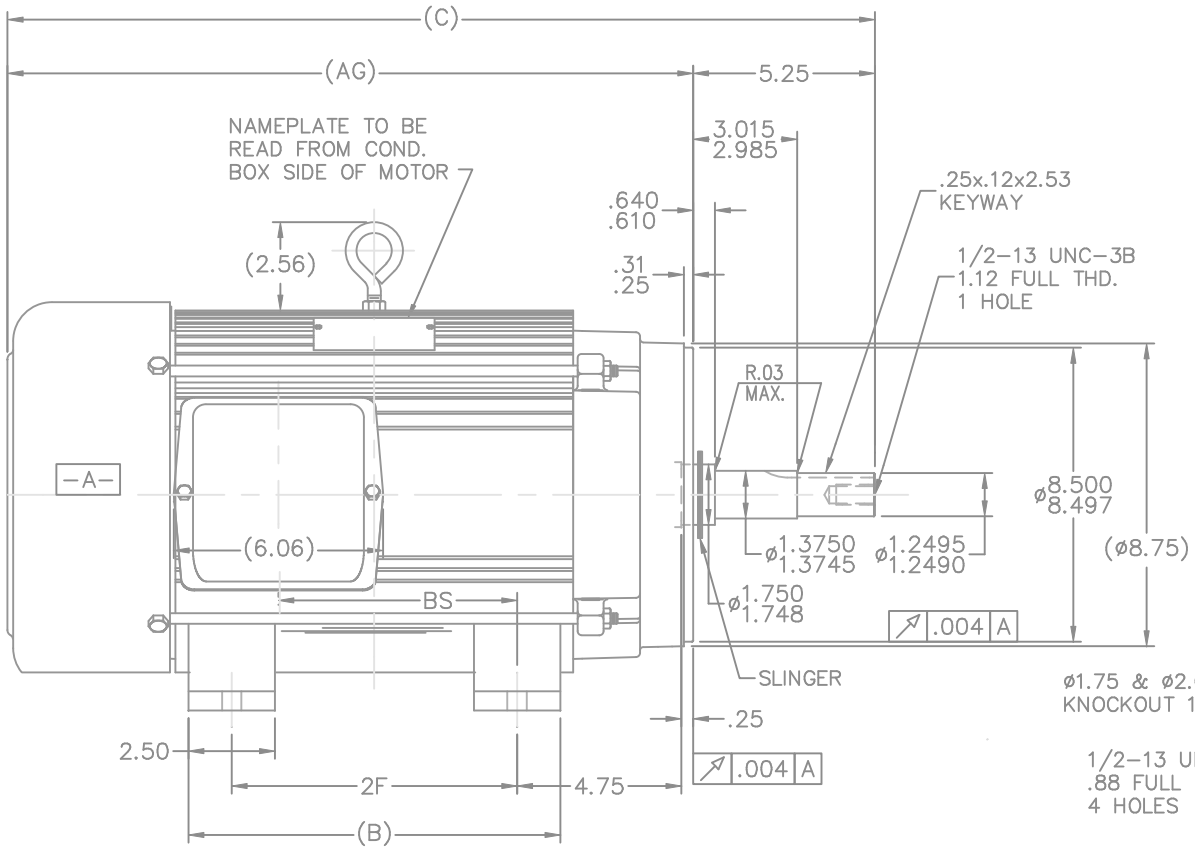

NOTES:
BOX CAN BE ROTATED IN 180° STEPS.
BOX CAN BE MOUNTED ON OPPOSITE SIDE
BY REMOVING BRACKETS & TURNING FRAME 180°.

DASH	FR.	C	B	2F	AG	BS	
						F1	F2
1150	254	25.24	10.75	8.25	19.99	7.15	1.75
1100	254	24.74	10.75	8.25	19.49	6.65	1.75
1275	254	26.49	10.75	8.25	21.24	8.40	1.75
1275	256	26.49	12.50	10.00	21.24	8.40	1.75
1325	254	26.99	10.75	8.25	21.74	6.90	N/A
1325	256	26.99	12.50	10.00	21.74	8.65	1.35
1475	256	28.49	12.50	10.00	23.24	10.15	N/A

TOLERANCES UNLESS SPECIFIED				MARATHON ELECTRIC				DRAWN DD 06-10-1993			
DEC. INCHES				TITLE OUTLINE - C' FACE				CHK ML 06-14-1993			
7	UPDATED DRAWING	TJW	04/27/2007	ML	.X	±.1		APPD GK 06-14-1993			
6	REDRAWN IN AUTOCAD	TAT	07-06-2004		.XX	±.03		SCALE 9=32			
5	UPDATED CONDUIT BOX PER CN 28427	TJB	01-25-2000		.XXX	±.005		REF			
4	ADDED DASH 1275, 1325, & 1475 / WAS 'A' SIZE	DRS	06-22-1999		.XXXX	±.0005		FMF			
3	CONDUIT HOLE WAS ø1.75 LEAD HOLE CN 25600-136	MRB	04-09-1998					PREV			
REVISION				BY & DATE				RFP			
THIS DRAWING IN DESIGN AND DETAIL IS OUR PROPERTY AND MUST NOT BE USED EXCEPT IN CONNECTION WITH OUR WORK ALL RIGHTS OF DESIGN AND INVENTION ARE RESERVED THIS IS AN ELECTRONICALLY GENERATED DOCUMENT - DO NOT SCALE THIS PRINT				CHK	ANG	±7'30"		CAD FILE ss84286			
				DIST LB				SIZE	DRAWING NO.	PAGE	REV.
								B	SS84286	7	

THREE PHASE - SINGLE VOLTAGE MOTOR - CONDUIT BOX @ 'A'

TO REVERSE ROTATION:
INTERCHANGE ANY TWO
LINE LEAD CONNECTIONS.

TERMINAL BLOCK WHEN SPECIFIED

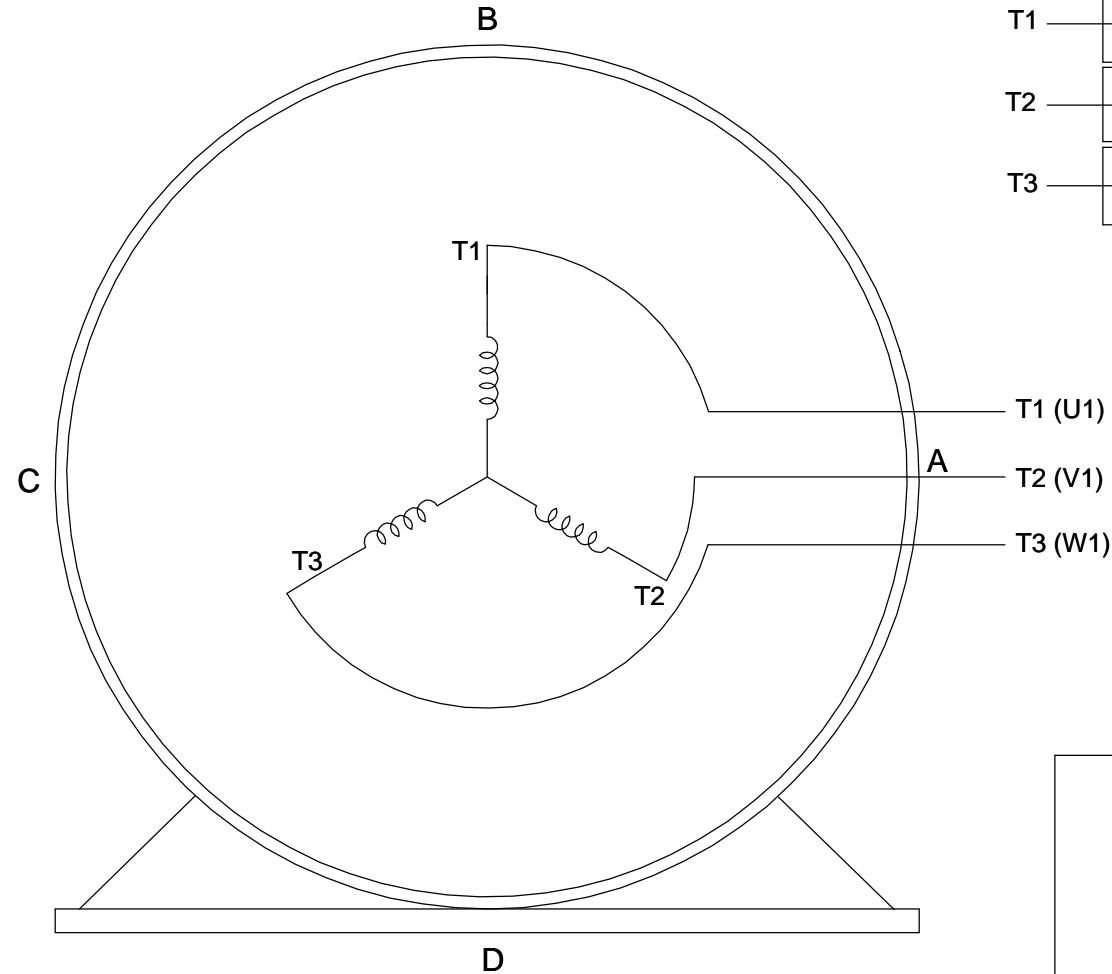

IF MOTOR HAS 6 LEADS

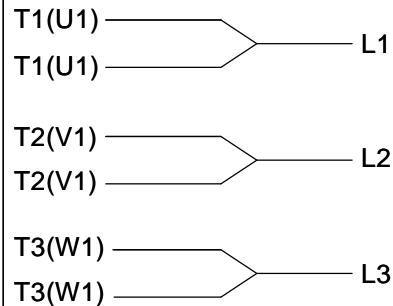

A-9806 DECAL

OPTIONAL CORD CONNECTION



VIEW OF TERMINAL END

DRAWING REVISION AB	REVISION BY JJB	DATE 06-27-2017
ECO ECO-0125361	APPROVED BY TB	DATE 06-27-2017
ECO DESCRIPTION UPDATED TO CURRENT STANDARDS		
<small>COPYRIGHT REGAL BELOIT AMERICA, INC. ALL RIGHTS RESERVED. PROPRIETARY AND CONFIDENTIAL INFORMATION - THIS DOCUMENT IS THE PROPERTY OF REGAL BELOIT AMERICA, INC. ("OWNER") AND CONTAINS OWNER'S PROPRIETARY INFORMATION. ANY PERSON, CORPORATION OR OTHER FIRM RECEIVING IT IS DEEMED, BY RECEIVING IT, TO AGREE THAT IT, AND/OR ANY PART OF IT, SHALL NOT BE DISCLOSED TO ANY PERSON, CORPORATION OR OTHER ENTITY, DUPLICATED, AND/OR USED, EXCEPT AS EXPRESSLY APPROVED IN WRITING IN ADVANCE BY OWNER. THIS DOCUMENT SHALL BE RETURNED TO OWNER UPON REQUEST. IT MAY BE SUBJECT TO CERTAIN RESTRICTIONS UNDER APPLICABLE EXPORT CONTROL LAWS AND REGULATIONS.</small>		

DRAWN BY DA
DATE 03-26-1993
APPROVED BY TB
DATE 03-26-1993
REFERENCE
THIRD ANGLE PROJECTION



Regal Beloit America, Inc.

DESCRIPTION
CONNECTION DIAGRAM
EXTERNAL - SINGLE VOLTAGE - 3Ø MOTOR

MATERIAL PROCESS/FINISH

SIZE A	DRAWING NUMBER EE7300	SHEET 1 OF 1
-----------	--------------------------	-----------------