

PRODUCT INFORMATION PACKET



Model No: 256THFNA8832
Catalog No: 256THFNA8832
12.5,1800,TEFC,256TCV,3/60/230/460

Regal and Marathon are trademarks of Regal Rexnord Corporation or one of its affiliated companies.
©2024 Regal Rexnord Corporation, All Rights Reserved. MC017097E



Nameplate Specifications

Phase	3	Output HP	12.50 Hp
Output KW	9.3 kW	Voltage	230/460 V
Speed	1785 rpm	Service Factor	1
Frame	256TCV	Enclosure	Totally Enclosed Fan Cooled
Thermal Protection	Thermostat	Efficiency	89.5 %
Ambient Temperature	19 °C	Frequency	60 Hz
Current	41.0/20.5 A	Power Factor	62.5
Duty	Continuous	Insulation Class	F
Design Code	A	KVA Code	P
Drive End Bearing Size	309	Opp Drive End Bearing Size	210
CSA	Y	IP Code	54
Number of Speeds	1		

Technical Specifications

Electrical Type	Squirrel Cage Inverter Duty	Starting Method	Inverter Only
Poles	4	Rotation	Reversible
Resistance Main	.3 Ohms	Mounting	Round
Motor Orientation	Shaft Down	Drive End Bearing	Ball
Opp Drive End Bearing	Ball	Frame Material	Cast Iron
Shaft Type	T	Assembly/Box Mounting	F1/F2 CAPABLE
Outline Drawing	B-SS203641-1225	Connection Drawing	A-EE7308T

This is an uncontrolled document once printed or downloaded and is subject to change without notice. Date Created:09/07/2024

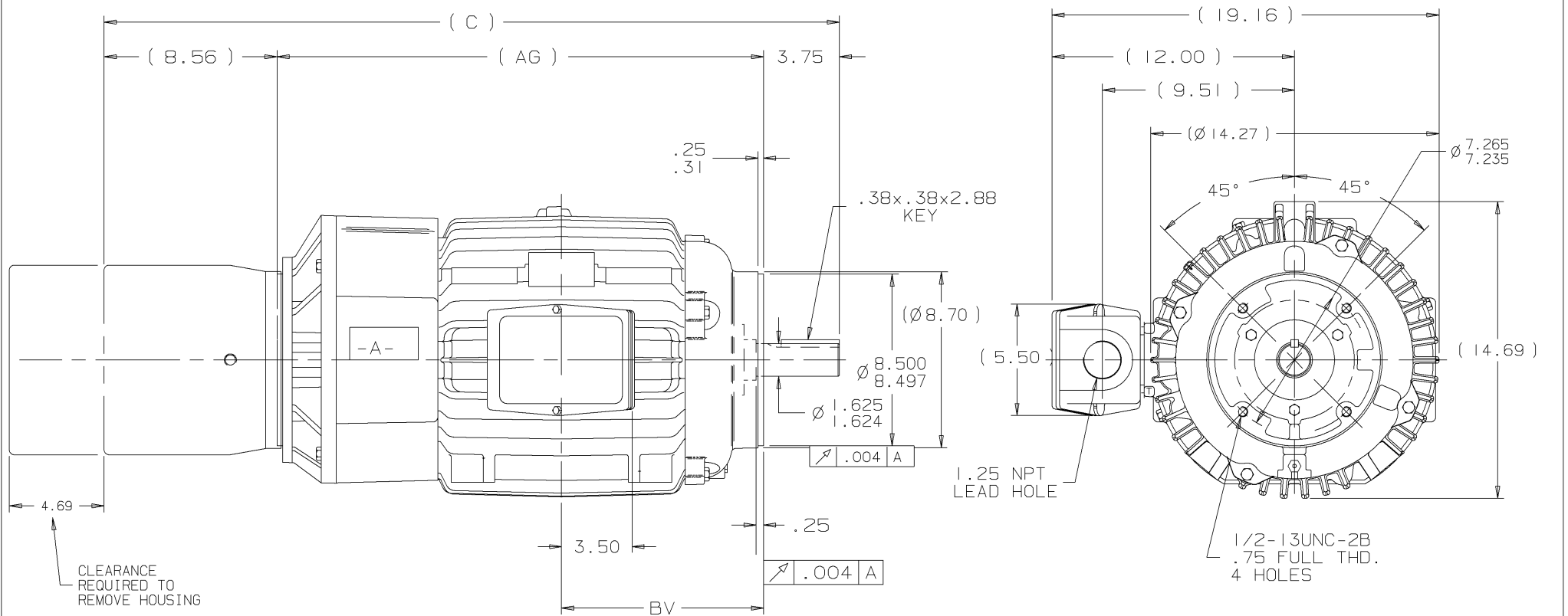

NOTES:

1. BOX CAN BE ROTATED ON ITS AXIS.
2. BOX CAN BE MOUNTED ON OPPOSITE SIDE BY REMOVING BRACKETS AND TURNING FRAME 180°.
3. NAMEPLATE TO READ FROM CONDUIT BOX SIDE OF MOTOR.

											<div>✓ MAX. SURFACE ROUGHNESS UNLESS NOTED OTHERWISE</div>	UNLESS OTHERWISE SPECIFIED DIMENSIONS ARE IN INCHES TOL. ON XX± .03 XXX± .005 XXXX± .0005 ANGLES± 7°30"			
DASH	FRAME		C		BV	AG	2	04-23-2001	DASH 1225; 'AG' DIMENSION WAS 31.96 CN 31532	DRS	MATL SPEC	<div><div><div><div></div><div>MARATHON</div><div>ELECTRIC</div></div><div>WAUSAU, WISCONSIN 54401</div></div><div>DRAWN BY DAH</div></div>		03-30-2001	
							1	04-02-2001	NEW DRAWING MU36373	DAH	FINISH	<div><div><div><div></div><div>MARATHON</div><div>ELECTRIC</div></div><div>WAUSAU, WISCONSIN 54401</div></div><div>CHKD BY ML</div></div>		04-02-2001	
												<div><div><div><div></div><div>MARATHON</div><div>ELECTRIC</div></div><div>WAUSAU, WISCONSIN 54401</div></div><div>APPD BY DR</div></div>		04-02-2001	
1225	254-6TC		36.38		10.00	24.07	REV	DATE	CHANGE	NAME	PART NAME OUTLINE - TEFC 250TC FR. - BB - TS		DRWG NO B- SS20364 I		
								SHOP BOOK		PURCHASED		DISTRIBUTION - WA - LB - WP - LM - BR		CADD FILE NO.	SS20364 I

HIGH VOLTAGE



NOTE FOR FACTORY USE ONLY:
TO SURGE TEST FOR COMMON CONNECT:
HIGH VOLT: CONNECT P1 TO T1
THEN P2 TO L1
LOW VOLT: CONNECT P1 TO T1 & T7,
THEN P2 TO L1

LOW VOLTAGE

THREE PHASE
DUAL VOLTAGE MOTOR

VIEW OF TERMINAL END

NOTE: LEAD'S COLOR CAN BE YELLOW OR WHITE FOR MT2 PLANT

DRAWING REVISION T	REVISION BY ZR	DATE 01-14-2019
ECO ECO-0159915	APPROVED BY DR	DATE 01-15-2019

ECO DESCRIPTION
ADDED TERMINAL CONNECTION DIAGRAM

COPYRIGHT REGAL BELOIT AMERICA, INC. ALL RIGHTS RESERVED.
PROPRIETARY AND CONFIDENTIAL INFORMATION - THIS DOCUMENT IS THE PROPERTY OF
REGAL BELOIT AMERICA, INC. ("OWNER") AND CONTAINS OWNER'S PROPRIETARY
INFORMATION. ANY PERSON, CORPORATION OR OTHER FIRM RECEIVING IT IS DEEMED,
BY RECEIVING IT, TO AGREE THAT IT, AND/OR ANY PART OF IT, SHALL NOT BE DISCLOSED
TO ANY PERSON, CORPORATION OR OTHER ENTITY, DUPLICATED, AND/OR USED, EXCEPT
AS EXPRESSLY APPROVED IN WRITING IN ADVANCE BY OWNER. THIS DOCUMENT SHALL
BE RETURNED TO OWNER UPON REQUEST. IT MAY BE SUBJECT TO CERTAIN
RESTRICTIONS UNDER APPLICABLE EXPORT CONTROL LAWS AND REGULATIONS.

DRAWN BY SMC
DATE 05-13-1992
APPROVED BY TB
DATE 05-13-1992
REFERENCE EE7308/EE7300

THIRD ANGLE PROJECTION
REFERENCE EE7308/EE7300

THIRD ANGLE PROJECTION

REGAL™ Regal Beloit America, Inc.

DESCRIPTION
CONN DIAGRAM-INTERNAL
3 PHASE - DUAL VOLTAGE MOTOR

MATERIAL PROCESS/FINISH

SIZE A DRAWING NUMBER EE7308T

SHEET 1 OF 1