

PRODUCT INFORMATION PACKET



Model No: 254TTDX14089

Catalog No: C155A

7.50 HP General Purpose Motor, 3 phase, 1200 RPM, 208-230/460 V, 254TC Frame, ODP
General Purpose Motors

Regal and Marathon are trademarks of Regal Rexnord Corporation or one of its affiliated companies.
©2021 Regal Rexnord Corporation, All Rights Reserved. MC017097E



Nameplate Specifications

| | | | |
|------------------------|------------------|----------------------------|---------------|
| Output HP | 7.50 Hp | Output KW | 5.6 kW |
| Frequency | 60 Hz | Voltage | 208-230/460 V |
| Current | 23.0-21.4/10.7 A | Speed | 1165 rpm |
| Service Factor | 1.15 | Phase | 3 |
| Efficiency | 88.5 % | Power Factor | 73.5 |
| Duty | Continuous | Insulation Class | F |
| Design Code | B | KVA Code | H |
| Frame | 254TC | Enclosure | Drip Proof |
| Thermal Protection | No | Ambient Temperature | 40 °C |
| Drive End Bearing Size | 6309 | Opp Drive End Bearing Size | 6208 |
| UL | Recognized | CSA | Y |
| CE | Y | IP Code | 12 |
| Number of Speeds | 1 | | |

Technical Specifications

| | | | |
|-----------------------|-----------------------------|-----------------------|-----------------|
| Electrical Type | Squirrel Cage Induction Run | Starting Method | Across The Line |
| Poles | 6 | Rotation | Reversible |
| Resistance Main | 1.4 Ohms | Mounting | Round |
| Motor Orientation | Horizontal | Drive End Bearing | Ball |
| Opp Drive End Bearing | Ball | Frame Material | Rolled Steel |
| Shaft Type | T | Overall Length | 20.92 in |
| Frame Length | 13.40 in | Shaft Diameter | 1.625 in |
| Shaft Extension | 4 in | Assembly/Box Mounting | F1/F2 Capable |
| Connection Drawing | A-EE7308 | Outline Drawing | A-SS86523-1340 |

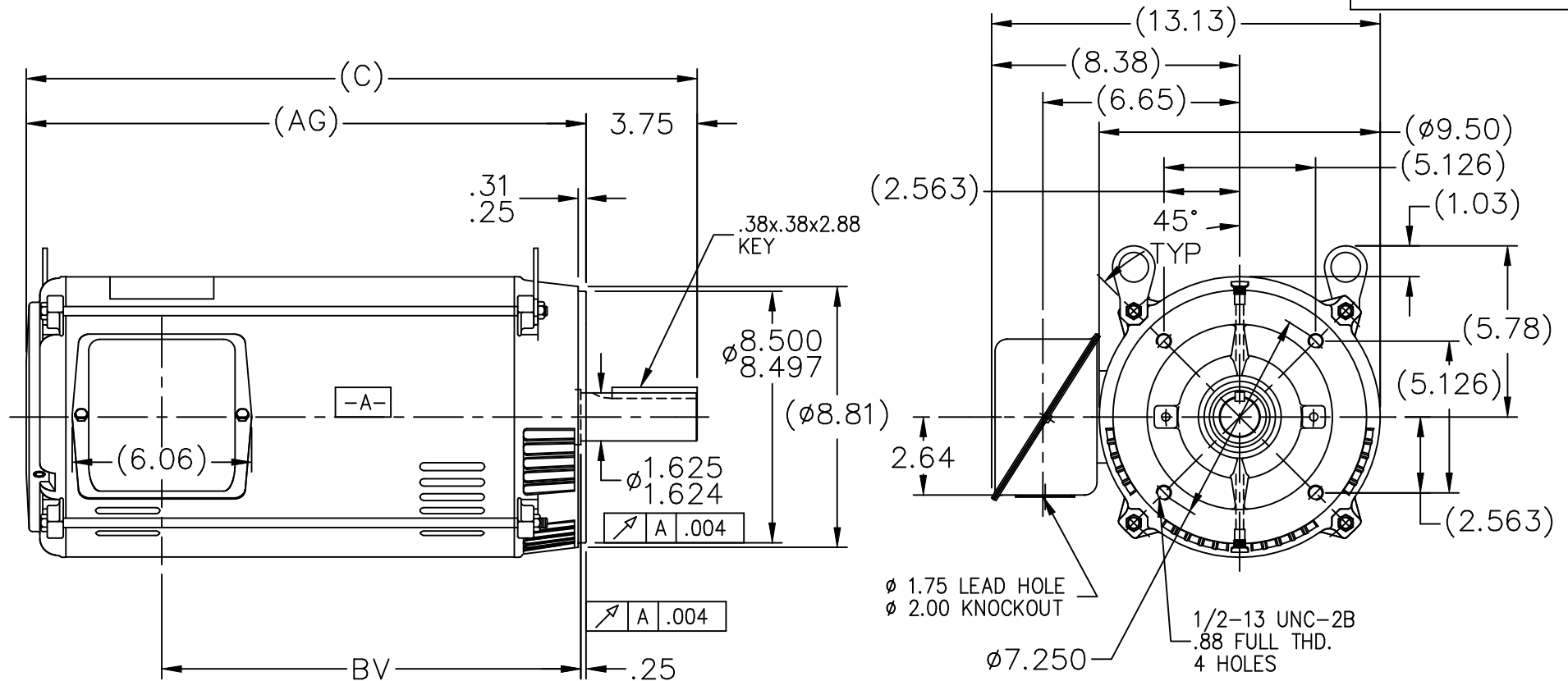

| DASH | FR. | C | BV | AG | MOUNTING |
|------|----------|-------|-------|-------|----------|
| 1340 | 254T | 20.92 | 12.68 | 17.17 | F1 OR F2 |
| 1515 | 254/256T | 22.67 | 14.43 | 18.92 | F1 OR F2 |

NOTES:

- NAMEPLATE TO BE READ FROM C'BOX SIDE OF MOTOR.
- BOX CAN BE MOUNTED IN 90° STEPS.
- BOX CAN BE MOUNTED ON OPPOSITE SIDE BY REMOVING BRACKETS AND TURNING FRAME 180°. (EXCEPT AS NOTED.)

| | | | TOLERANCES UNLESS SPECIFIED | | MARATHON ELECTRIC | DRAWN DJK 10/26/1993 | | |
|--|-------------------------------------|----------------|-----------------------------|------------------|---|----------------------|-------------|-------------|
| | | | DEC. | INCHES | | CHK | ML | 10/27/1993 |
| 4 | UPDATED DRAWING | TJW 05/14/2007 | .X | ±.1 | TITLE OUTLINE 250TC FR.-BB-TS-DR.PR.-'C'FACE MAT'L. FINISH | APPD | DRN | 10/27/1993 |
| 3 | UPDATED C'BOX MU31829 | CAV 6/16/2000 | .XX | ±.03 | | SCALE | 3=16 | |
| 2 | -1515 WAS FOR 256T FR. ONLY CN18683 | KL 10/11/1994 | .XXX | ±.005 | | REF | | |
| 1 | NEW DRAWING | DJK 10/27/1993 | .XXXX | ±.0005 | | FMF | | |
| NO. | REVISION | BY & DATE | CHK | ANG | ±7'30" | PREV | | |
| THIS DRAWING IN DESIGN AND DETAIL IS OUR PROPERTY AND MUST NOT BE USED EXCEPT IN CONNECTION WITH OUR WORK ALL RIGHTS OF DESIGN AND INVENTION ARE RESERVED THIS IS AN ELECTRONICALLY GENERATED DOCUMENT - DO NOT SCALE THIS PRINT | | | RFP | CAD FILE SS86523 | | SIZE | DRAWING NO. | PAGE 1 OF 1 |
| | | | DIST LB | | | A | SS86523 | REV. 4 |



| | | | | | | | | | | | |
|--|--|----------------|---------|--------------------------------|-----------------|---|---------------------|-------------|------|----|------|
| | | | | TOLERANCES UNLESS SPECIFIED | |  Regal Beloit America, Inc. | DRAWN RM 11/20/1990 | | | | |
| 5 | CHG TO REGAL LOGO | SL 09/10/2015 | AB | DEC. | INCHES | | CHK ML 11/21/1990 | | | | |
| 4 | REVISED IEC NOTATIONS | MSG 11/15/2011 | CMN | .X | ±.1 | | APPD SAS 04/24/2003 | | | | |
| 3 | ADDED IEC NOTATIONS... (U1), (V1) ETC. MU95194 | MSG 5/10/2010 | MJS | .XX | ±.02 | | SCALE 1=1 | | | | |
| 2 | ADDED THE OPTIONAL CORD CONNECTION MU46318 | RDH 04/24/2003 | DRS | .XXX | ±.005 | TITLE CONNECTION DIAGRAM 3Ø – DUAL VOLTAGE MOTOR | REF | | | | |
| 1 | REDRAWN | RM 11/20/1990 | | .XXXX | ±.0005 | MAT'L. | FMF | | | | |
| NO. | REVISION | BY & DATE | CHK | ANG | ±7"30" | FINISH | PREV | | | | |
| THIS DRAWING IN DESIGN AND DETAIL IS OUR PROPERTY AND MUST NOT BE USED EXCEPT IN CONNECTION WITH OUR WORK ALL RIGHTS OF DESIGN AND INVENTION ARE RESERVED THIS IS AN ELECTRONICALLY GENERATED DOCUMENT – DO NOT SCALE THIS PRINT | | | RFP | | CAD FILE ee7308 | | SIZE | DRAWING NO. | PAGE | OF | REV. |
| | | | DIST WP | | | | A | EE7308 | | | 5 |