

PRODUCT INFORMATION PACKET

Model No: 215TTFWD16017

Catalog No: M884B

Vertical Pump Motor, 10 HP, 3 Ph, 60 Hz, 230/460 V, 3600 RPM, 215HPV Frame, TEFC



Regal and are trademarks of Regal Rexnord Corporation or one of its affiliated companies.
©2022 Regal Rexnord Corporation, All Rights Reserved. MC017097E

Nameplate Specifications

Output HP	10 Hp	Output KW	7.5 kW
Frequency	60 Hz	Voltage	230/460 V
Current	23.6/11.8 A	Speed	3525 rpm
Service Factor	1.15	Phase	3
Efficiency	90.2 %	Power Factor	87.9
Duty	Continuous	Insulation Class	F
Design Code	B	KVA Code	H
Frame	215HPV	Enclosure	Totally Enclosed Fan Cooled
Thermal Protection	No Protection	Ambient Temperature	40 °C
Drive End Bearing Size	6309	Opp Drive End Bearing Size	6206
UL	Recognized	CSA	Y
CE	Y	IP Code	43
Number of Speeds	1		

Technical Specifications

Electrical Type	Squirrel Cage Induction Run	Starting Method	Across The Line
Poles	2	Rotation	Reversible
Resistance Main	.8 Ohms	Mounting	Round
Motor Orientation	Shaft Down	Drive End Bearing	Ball
Opp Drive End Bearing	Ball	Frame Material	Rolled Steel
Shaft Type	HP	Overall Length	22.66 in
Frame Length	11.15 in	Shaft Diameter	1.125 in
Shaft Extension	2.75 in	Assembly/Box Mounting	F1/F2 CAPABLE
Outline Drawing	A-SS86643-1115	Connection Drawing	005010.01

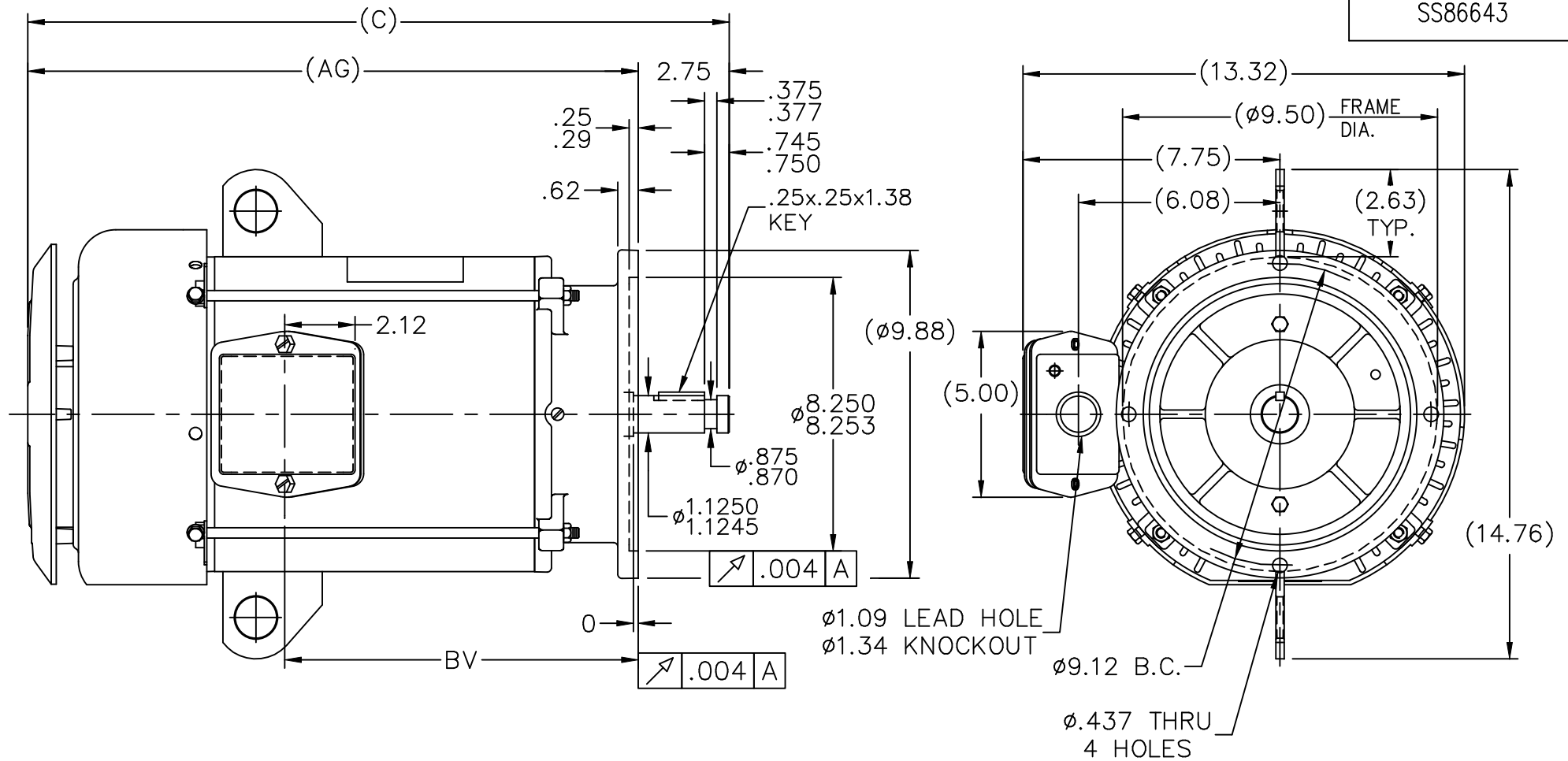

DASH	FR.	C	AG	BV
965	213T	21.16	18.41	10.66
1115	213/15T	22.66	19.91	12.16
1240	213/15T	23.91	21.16	13.41

NOTES:

- NAMEPLATE TO BE READ FROM SHAFT EXT. END OF MOTOR.
- BOX CAN BE MOUNTED IN 90° STEPS.

				TOLERANCES UNLESS SPECIFIED		MARATHON ELECTRIC	DRAWN MRB 11-05-1996	
NO.	REVISION	BY & DATE	CHK	ANG	±7'30"		PREV	
7	UPDATED DRAWING	TJW 04/30/2007		DEC.	INCHES	TITLE OUTLINE 210T FR.-TEFC-P' BASE-R/S FRAME	CHK	ML 11-07-1996
6	REDRAWN IN AUTOCAD	TAT 07-22-2004	ML	.X	±.1		APPD	DN 11-08-1996
5	ADDED $\phi 9.12$ B.C. & $\phi .437$ (4) HOLES CN 29200-1501	HLB 02-27-2001		.XX	±.03		SCALE	7=32
4	UPDATED C' BOX GEOMETRY CN 28425	DRS 01-31-2000		.XXX	±.005		REF	
3	REMOVED GROUND SCREW FROM FRAME CN 24453	MJD 10-01-1997		.XXXX	±.0005		FMF	
THIS DRAWING IN DESIGN AND DETAIL IS OUR PROPERTY AND MUST NOT BE USED EXCEPT IN CONNECTION WITH OUR WORK ALL RIGHTS OF DESIGN AND INVENTION ARE RESERVED THIS IS AN ELECTRONICALLY GENERATED DOCUMENT - DO NOT SCALE THIS PRINT		RFP	CAD FILE ss86643		SIZE	DRAWING NO.	PAGE	OF
		DIST LB			A	SS86643		7

005010-01

VIEW FROM OUTSIDE OF MOTOR AT SWITCH END.



				TOLERANCES UNLESS SPECIFIED		 Regal Beloit America, Inc.			DRAWN RDW 04/12/02		
				DEC.	INCHES				CHK		
				.X	±.1				APPD		
				.XX	±.01				SCALE 1=1		
				.XXX	±.005	TITLE EXTERNAL WIRING DIAGRAM 3 PHASE W/O PROTECTOR			REF FIG.2-51		
A	UPDATED TO REGAL LOGO	SAJ 06/26/15	AJY	.XXXX	±.0005				MAT'L. DECAL - 004014		
NO.	REVISION	BY & DATE	CHK	ANG	±1/2"	FINISH			PREV		
THIS DRAWING IN DESIGN AND DETAIL IS OUR PROPERTY AND MUST NOT BE USED EXCEPT IN CONNECTION WITH OUR WORK ALL RIGHTS OF DESIGN AND INVENTION ARE RESERVED THIS IS AN ELECTRONICALLY GENERATED DOCUMENT - DO NOT SCALE THIS PRINT				RFP 04/12/02		CAD FILE 00501001			SIZE	DRAWING NO.	REV
				DIST BRF-NLV					A	005010-01	A

CERTIFICATION DATA SHEET

Model#: 215TTFWD16017 AA
 CONN. DIAGRAM: 005010.01
 OUTLINE: A-SS86643-1115

WINDING#: K2152226 NONE 2
 ASSEMBLY: F1/F2 CAPABLE

TYPICAL MOTOR PERFORMANCE DATA

HP	KW	SYNC. RPM	F.L. RPM	FRAME	ENCLOSURE	KVA CODE	DESIGN
10	7.5	3600	3525	215HPV	TEFC	H	B

PH	Hz	VOLTS	FL AMPS	START TYPE	DUTY	INSL	S.F	AMB°C	ELEVATION
3	60	230/460	23.6/11.8	ACROSS THE LINE	CONTINUOUS	F3	1.15	40	3300

FULL LOAD EFF: 90.2	3/4 LOAD EFF: 91.5	1/2 LOAD EFF: 90.8	GTD. EFF	ELEC. TYPE	NO LOAD AMPS
FULL LOAD PF: 87.9	3/4 LOAD PF: 83.5	1/2 LOAD PF: 73.7	88.5	SQ CAGE IND RUN	8.8 / 4.4

F.L. TORQUE	LOCKED ROTOR AMPS	L.R. TORQUE	B.D. TORQUE	F.L. RISE°C
14.9 LB-FT	159 / 79.5	27.7 LB-FT 186	47.1 LB-FT 316	60

SOUND PRESSURE @ 3 FT.	SOUND POWER	ROTOR WK^2	MAX. WK^2	SAFE STALL TIME	STARTS /HOUR	APPROX. MOTOR WGT
72 dBA	82 dBA	0.55 LB-FT^2	18 LB-FT^2	15 SEC.	2	120 LBS.

*** SUPPLEMENTAL INFORMATION ***

DE BRACKET TYPE	ODE BRACKET TYPE	MOUNT TYPE	ORIENTATION	SEVERE DUTY	HAZARDOUS LOCATION	DRIP COVER	SCREENS	PAINT
P-BASE	STANDARD	ROUND	SHAFT DOWN	FALSE	NONE	TRUE	NONE	BLUE (ENAMEL)

BEARINGS		GREASE	SHAFT TYPE	SPECIAL DE	SPECIAL ODE	SHAFT MATERIAL	FRAME MATERIAL
DE	OPE						
BALL	BALL						
6309	6206	POLYREX EM	HP	NONE	NONE	AISI 1045 (C-240)	ROLLED STEEL

THERMO-PROTECTORS				THERMISTORS	CONTROL	SPACE /n HEATERS
THERMOSTATS	PROTECTORS	WDG RTDs	BRG RTDs			
NONE	NOT	NONE	NONE	NONE	FALSE	NONE VOLTS

If Inverter equals NONE, contact factory for further information

* N O T E S *	INVERTER TORQUE: NONE			
	INV. HP SPEED RANGE: NONE			
	ENCODER: NONE			
	NONE NONE			
	NONE NONE PPR			
	BRAKE: NONE NONE			
	NONE P/N NONE			
	NONE NONE			
	NONE FT-LB NONE V NONE Hz			

DATE: 06/22/2017 08:29:57 AM
 FORM 3531 REV.3 02/07/99
 ** Subject to change without notice.

Data Sheet

Date: 6/29/2017

Customer: _____

Attention: _____

Submitted by: FAREEDA DUDEKULA



215TTFWD16017

Submittal

Data @ 460 V

Motor Load Data

Load	0%	25%	50%	75%	100%	115%	125%	LR	
Current (Amps)	4.4	5.2	7.0	9.2	11.8	13.4	14.6	79.5	
Torque (ft-lb)	0.00	3.7	7.4	11.1	14.9	17.2	18.8	27.7	
RPM	3600	3580	3564	3545	3525	3,510	3500	0	
Efficiency (%)		86.4	90.8	91.5	90.2	90.1	89.9		
P.F. (%)	7.4	52.1	73.7	83.5	87.9	89.2	89.1	46.3	

Motor Speed Data

	LR	Pull-Up	BD	Rated	Idle	Information Block																														
Speed (RPM)	0	700	3070	3525	3600	HP	10.0																													
Current (Amps)	79.5	78.0	52.0	11.8	4.4	Sync. RPM	3600																													
Torque (ft-lb)	27.7	28.5	47.1	14.9	0.00	Frame	215																													
<div><div>— Efficiency (%) — P.F. (%) — Current (Amps)</div><table><caption>Graph Data Points (Estimated)</caption><thead><tr><th>Load (%)</th><th>Efficiency (%)</th><th>P.F. (%)</th><th>Current (Amps)</th></tr></thead><tbody><tr><td>25</td><td>86</td><td>52</td><td>4.5</td></tr><tr><td>40</td><td>89</td><td>65</td><td>5.5</td></tr><tr><td>60</td><td>92</td><td>78</td><td>7.5</td></tr><tr><td>80</td><td>91</td><td>85</td><td>10.0</td></tr><tr><td>100</td><td>90</td><td>88</td><td>12.5</td></tr><tr><td>125</td><td>90</td><td>89</td><td>14.5</td></tr></tbody></table></div>						Load (%)	Efficiency (%)	P.F. (%)	Current (Amps)	25	86	52	4.5	40	89	65	5.5	60	92	78	7.5	80	91	85	10.0	100	90	88	12.5	125	90	89	14.5	Voltage	230/460	V
						Load (%)	Efficiency (%)	P.F. (%)	Current (Amps)																											
						25	86	52	4.5																											
						40	89	65	5.5																											
						60	92	78	7.5																											
						80	91	85	10.0																											
						100	90	88	12.5																											
						125	90	89	14.5																											
						Frequency	60	Hz																												
						Design	B																													
						LR Code letter	H																													
						Service Factor	1.15																													
						Temp Rise @ FL	60	° C																												
						Duty	CONT																													
						Ambient	40	° C																												
						Elevation	1,000	feet																												
						Rotor/Shaft wk ²	0.55	Lb-Ft ²																												
						Ref Wdg	K2152226	NONE																												
						Sound Pressure @ 1M	72	dBA																												
						VFD Rating	NONE																													
						Outline Dwg	A-SS86643-1115																													
						Conn. Diag	005010.01																													
						Additional Specifications:																														
0																																				
0																																				
EQUIV CKT (OHMS / PHASE)																																				
R1	R2	X1	X2	Xm																																
0.8280	0.5020	1.9740	1.3470	58.5630																																

Speed -Torque Curve

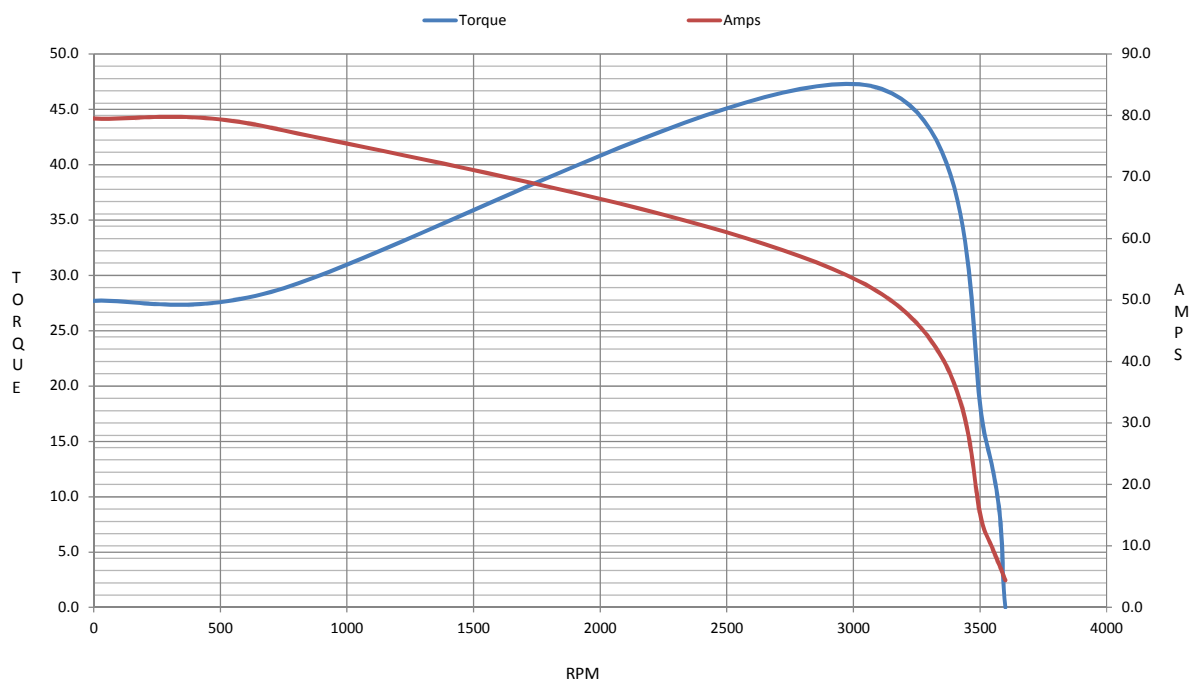

EC Declaration of Conformity

The undersigned representing
the manufacturer:

Regal Beloit America
100 East Randolph St.
Wausau, WI 54401

and the authorized representative
established within the Community:

Marathon Electric UK
6F Thistleton Road Ind. Estate
Market Overton
Oakham, Rutland LE15 7PP UK

are committed to providing customers with products that comply with applicable regulations and international protocols to which they are subject, including the requirements of the European Parliament Directive on the Harmonization of the laws relating to electrical equipment designed for use within certain voltage limits (2014/35/EU).

Regal Beloit America declares that the following product(s), to which this declaration relates, are in conformity with the relevant sections of the EC standards listed below.

This statement supersedes any statements previously issued pertaining to the product(s) listed below and is subject to change without notice.

Model No : 215TTFWD16017

(Model No. may contain prefix and/or suffix characters)

Catalog No : M884B

Rework No : N/A

Directives :

Low Voltage Directive 2014/35/EU

Harmonized Standards Used :

EN 60034-1: 2010 (IEC 60034-1: 2010)

EN 60034-5: 2001/A1:2007 (IEC 60034-5: 2000/A1:2006)

Authorized Representative:



Michael A. Logsdon
Vice President, Technology

Authorized Representative in the Community:



Julian Clark
Marketing Engineer

Created on 09/01/2022

CE 22