

PRODUCT INFORMATION PACKET

Model No: 215TCDW7012

Catalog No: Z314

Crop Dryer Motor, 7.50 & 10.50 HP, 1 Ph, 60 & 60 Hz, 230 & 230 V, 3600 & 3600 RPM, 215TZ Frame,
DPAO



Regal and Marathon are trademarks of Regal Rexnord Corporation or one of its affiliated companies.

©2023 Regal Rexnord Corporation, All Rights Reserved. MC017097E

Nameplate Specifications

| | | | |
|------------------------|-----------------|----------------------------|---------------------|
| Phase | 1 | Output HP | 7.50 & 10.50 Hp |
| Output KW | 5.6 & 7.8 kW | Voltage | 230 & 230 V |
| Speed | 3515 & 3485 rpm | Service Factor | 1.4 & 1.0 |
| Frame | 215TZ | Enclosure | Drip Proof Air Over |
| Thermal Protection | No Protection | Efficiency | 84 & 82.5 % |
| Ambient Temperature | 40 °C | Frequency | 60 & 60 Hz |
| Current | 37 & 49.5 A | Power Factor | 78 |
| Duty | Continuous | Insulation Class | F |
| Design Code | No Design Code | KVA Code | F |
| Drive End Bearing Size | 6307 | Opp Drive End Bearing Size | 6206 |
| UL | Recognized | CSA | Y |
| CE | N | IP Code | 22 |
| Number of Speeds | 1 | | |

Technical Specifications

| | | | |
|-----------------------|-------------------------------|-----------------------|----------------------------|
| Electrical Type | Capacitor Start Induction Run | Starting Method | Across The Line |
| Poles | 2 | Rotation | Selective Counterclockwise |
| Resistance Main | .156 Ohms | Mounting | Rigid Base |
| Motor Orientation | Horizontal | Drive End Bearing | Ball |
| Opp Drive End Bearing | Ball | Frame Material | Rolled Steel |
| Shaft Type | Single Special Extension | Overall Length | 19.16 in |
| Frame Length | 11.15 in | Shaft Diameter | 1.125 in |
| Shaft Extension | 4.59 in | Assembly/Box Mounting | F3 |
| Outline Drawing | A-SS87927-1115 | Connection Drawing | A-EE9048PF |

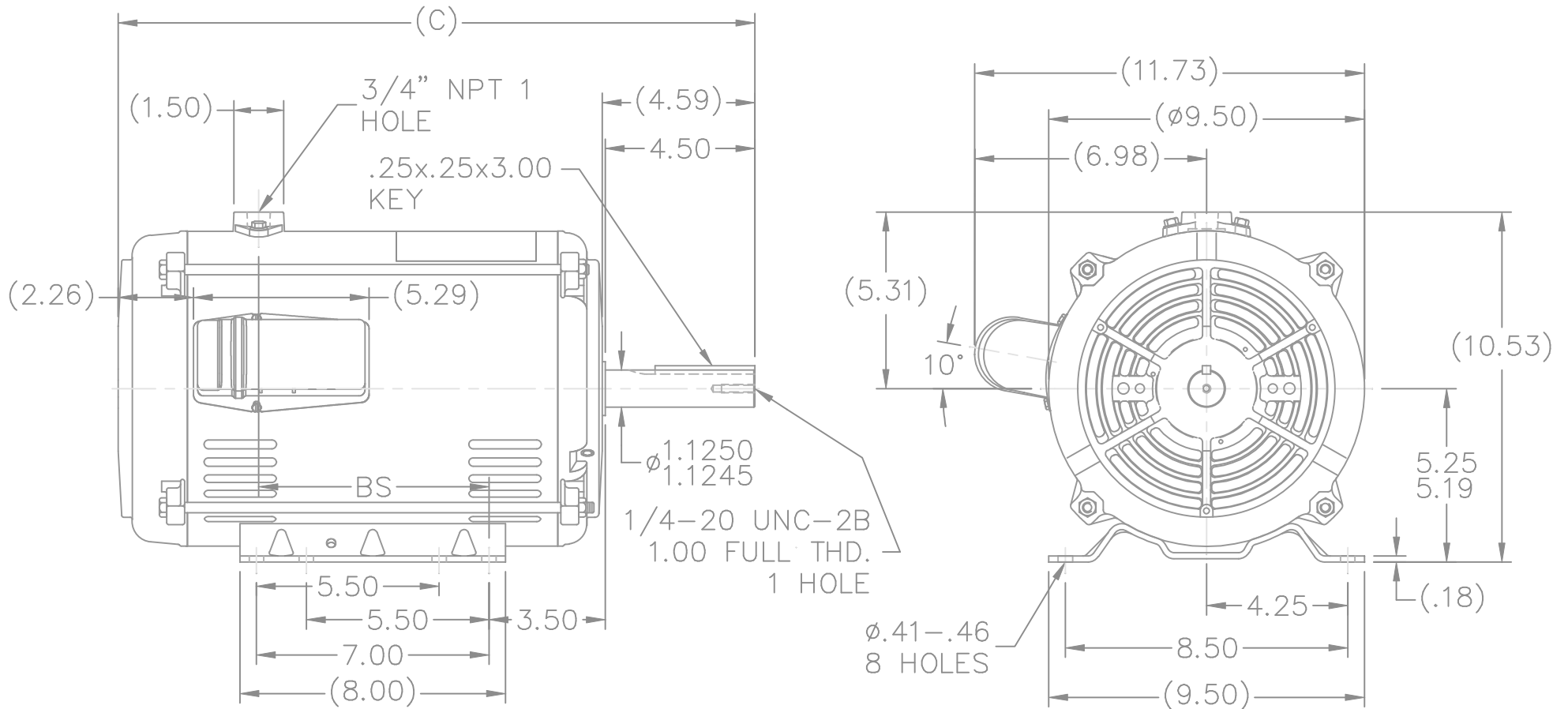

| DASH | FR. | C | BS | MOUNTING |
|------|---------|-------|------|----------|
| 1115 | 213/15T | 19.16 | 6.93 | |

NOTES:

1. NAMEPLATE TO BE READ FROM CAPACITOR SIDE OF MOTOR.
2. SEE MODEL FOR LEAD LENGTH.

| | | | | | | | | | | |
|--|---|----------------|-----|-----------------------------|------------------|--------|----------------------|---------------------|---------|--------|
| 6 | REPLACED ADAPTER PLATE W/LEESON PLATE 07-1734 | MSG 11-14-2008 | MSG | TOLERANCES UNLESS SPECIFIED | | | DRAWN MJD 08-13-1999 | | | |
| 5 | UPDATED DRAWING | TJW 04/30/2007 | | DEC. | INCHES | | CHK ML 08-18-1999 | | | |
| 4 | REDRAWN IN AUTOCAD | TAT 06-13-2005 | ML | .X | ±.1 | | APPD DR 08-18-1999 | | | |
| 3 | CHANGED WORDING OF NOTE #1 CN 27400-391 | NJS 09-17-1999 | | .XX | ±.03 | | SCALE 7=32 | | | |
| 2 | REMOVED EYEBOLT CN 27700-781 | MJD 08-31-1999 | | .XXX | ±.005 | | REF | | | |
| 1 | NEW DRAWING MU26426 | MJD 08-18-1999 | | .XXXX | ±.0005 | | FMF | | | |
| NO. | REVISION | BY & DATE | CHK | ANG | ±7'30" | MAT'L. | PREV | | | |
| THIS DRAWING IN DESIGN AND DETAIL IS OUR PROPERTY AND MUST NOT BE USED EXCEPT IN CONNECTION WITH OUR WORK ALL RIGHTS OF DESIGN AND INVENTION ARE RESERVED THIS IS AN ELECTRONICALLY GENERATED DOCUMENT - DO NOT SCALE THIS PRINT | | | | RFP | CAD FILE ss87927 | | SIZE A | DRAWING NO. SS87927 | PAGE OF | REV. 6 |
| | | | | DIST LB | | | | | | |

CCW ROTATION

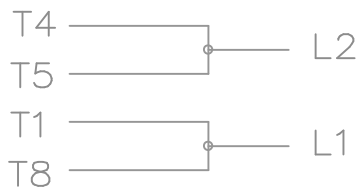

CW ROTATION

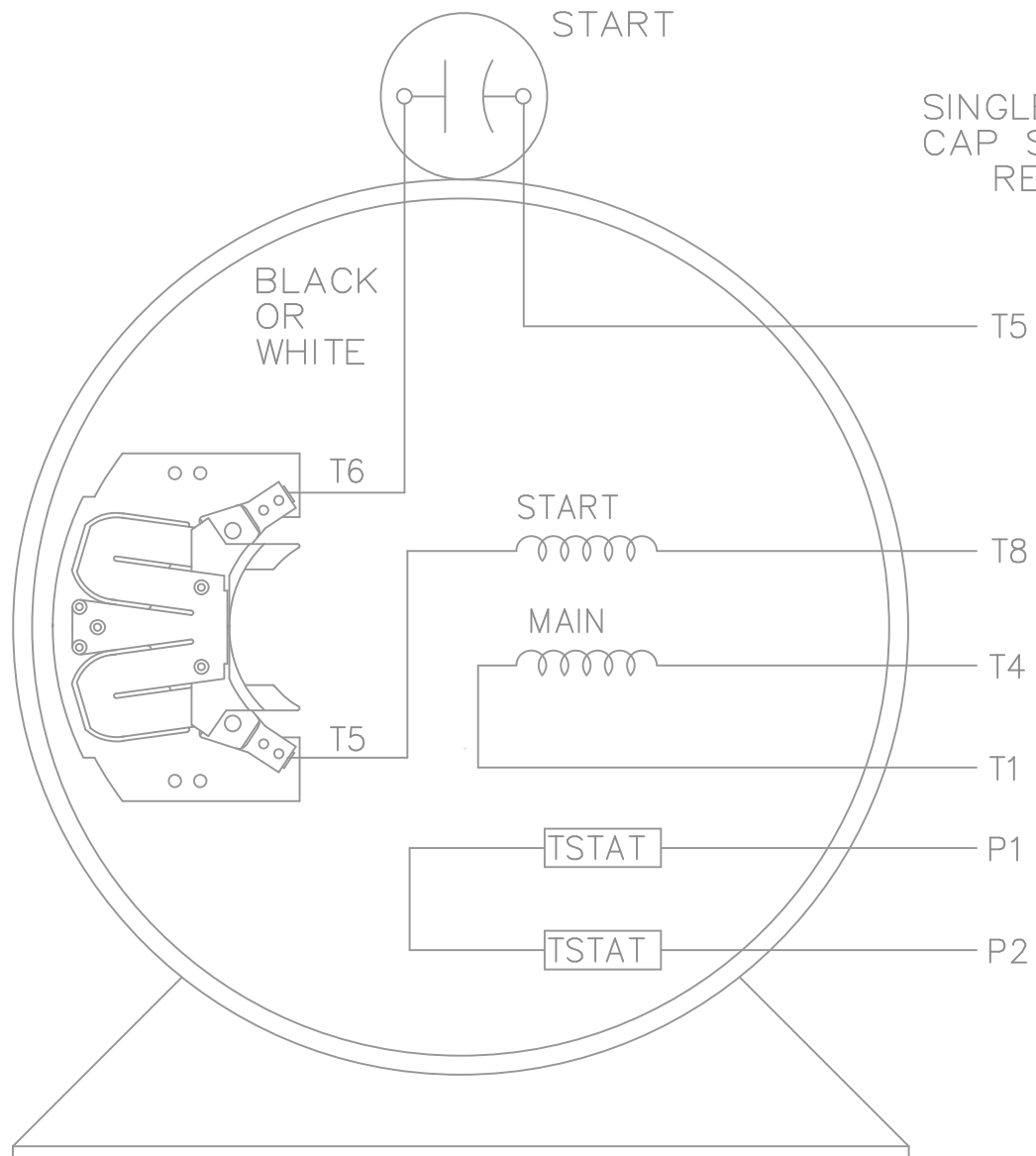
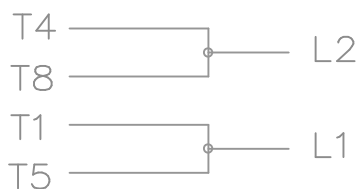

SINGLE VOLTAGE
CAP START, IND RUN
REVERSIBLE

VIEW OF TERMINAL END

| | | | | | | | | | |
|--|--|----------------|-----------------------------|-------------------|--------------------------|----------------------|----------------------|-----------|--------|
| | | | TOLERANCES UNLESS SPECIFIED | | | DRAWN MJD 08-13-1999 | | | |
| | | | DEC. | INCHES | | CHK ML 08-18-1999 | | | |
| | | | .X | ±.1 | APPD DR 08-18-1999 | SCALE | | | |
| 3 | ADDED "T6" | RJW 07-19-2007 | ML | .XX ±.02 | TITLE CONNECTION DIAGRAM | | REF | | |
| 2 | REV. LEAD TO BE WHITE OR BLACK CN27400-509 | NJS 10-29-1999 | | .XXX ±.005 | MAT'L. | | FMF | | |
| 1 | NEW DRAWING MU26426 | MJD 08-18-1999 | | .XXXX ±.0005 | FINISH | | PREV | | |
| NO. | REVISION | BY & DATE | CHK | ANG ±7'30" | | | | | |
| THIS DRAWING IN DESIGN AND DETAIL IS OUR PROPERTY AND MUST NOT BE USED EXCEPT IN CONNECTION WITH OUR WORK ALL RIGHTS OF DESIGN AND INVENTION ARE RESERVED THIS IS AN ELECTRONICALLY GENERATED DOCUMENT - DO NOT SCALE THIS PRINT | | | RFP | CAD FILE EE9048PF | | SIZE A | DRAWING NO. EE9048PF | PAGE OF 3 | REV. 3 |
| | | | DIST WA | | | | | | |