

PRODUCT INFORMATION PACKET

Model No: 215TBDW7079

Catalog No: I144

General Purpose Motor, 3 HP, 1 Ph, 60 Hz, 230 V, 1200 RPM, 215T Frame, DP



Regal and Marathon are trademarks of Regal Rexnord Corporation or one of its affiliated companies.

©2022 Regal Rexnord Corporation, All Rights Reserved. MC017097E



Nameplate Specifications

Output HP	3 Hp	Output KW	2.2 kW
Frequency	60 Hz	Voltage	230 V
Current	16.0 A	Speed	1155 rpm
Service Factor	1.15	Phase	1
Efficiency	80 %	Power Factor	78
Duty	Continuous	Insulation Class	B
Design Code	L	KVA Code	G
Frame	215T	Enclosure	Drip Proof
Thermal Protection	No Protection	Ambient Temperature	40 °C
Drive End Bearing Size	6307	Opp Drive End Bearing Size	6206
UL	Recognized	CSA	Y
CE	Y	IP Code	22
Number of Speeds	1		

Technical Specifications

Electrical Type	Capacitor Start Capacitor Run	Starting Method	Across The Line
Poles	6	Rotation	Selective Counterclockwise
Resistance Main	.593 Ohms	Mounting	Rigid Base
Motor Orientation	Horizontal	Drive End Bearing	Ball
Opp Drive End Bearing	Ball	Frame Material	Rolled Steel
Shaft Type	T	Overall Length	18.05 in
Frame Length	11.15 in	Shaft Diameter	1.375 in
Shaft Extension	3.47 in	Assembly/Box Mounting	F1 ONLY
Outline Drawing	A-SS86561-1115	Connection Drawing	A-EE9048MF

This is an uncontrolled document once printed or downloaded and is subject to change without notice. Date Created:11/28/2022

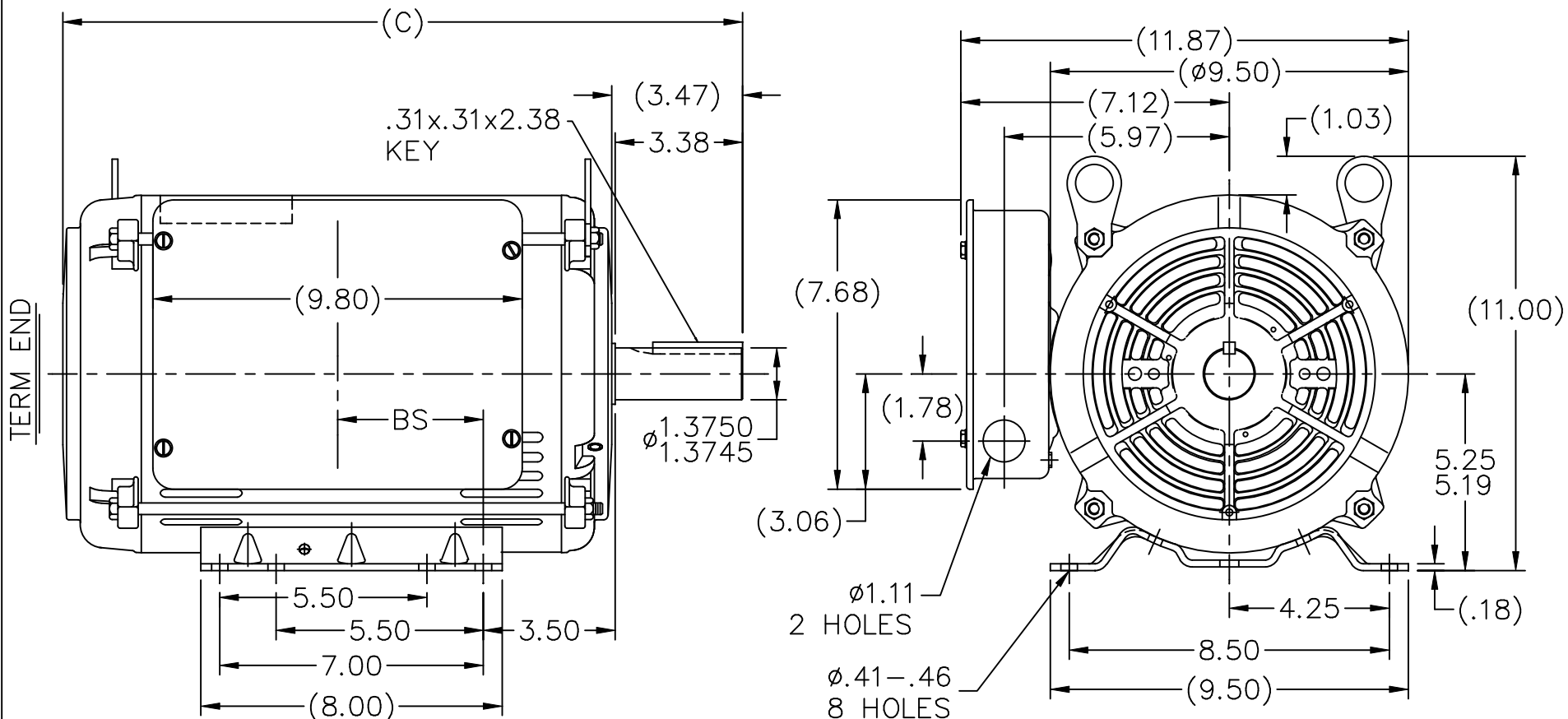

DASH	FR.	C	BS
965	213T	16.55	2.45
1115	213/15T	18.05	3.95
1240	213/15T	19.30	5.20

NOTES:

1. NAMEPLATE TO BE READ FROM C'BOX SIDE OF MOTOR.

NO.	REVISION	BY & DATE	CHK	ANG	TOLERANCES UNLESS SPECIFIED		DRAWN	CHK	APPD	SCALE	
10	CHG. C'BOX BACK TO OLD BOX 07-1847	RWR 04-14-2008			DEC. INCHES			SLJ 09-01-1994	SMC 09-01-1994	DRN 09-01-1994	1=4.2
9	NEW C'BOX 07-1847	RJW 01-07-2008	ML			TITLE OUTLINE 210 T FR. - BB - TS - DR.PR.				REF	
8	UPDATED DRAWING	TJW 04-27-2007		.X	±.1						FMF
7	REDRAWN IN AUTOCAD	TAT 05-19-2005	ML	.XX	±.03	MAT'L. FINISH				PREV	
6	REM. 2 ADD'L ø1.38 CONDUIT BOX HOLES CN 26624	MRB 07-16-1998		.XXX	±.005						
5	ADDED ADD'L ø1.38 HOLE TO COND. BOX CN 26000-304	MJD 04-23-1998		.XXXX	±.0005						
THIS DRAWING IN DESIGN AND DETAIL IS OUR PROPERTY AND MUST NOT BE USED EXCEPT IN CONNECTION WITH OUR WORK ALL RIGHTS OF DESIGN AND INVENTION ARE RESERVED THIS IS AN ELECTRONICALLY GENERATED DOCUMENT - DO NOT SCALE THIS PRINT			RFP		CAD FILE	ss86561	SIZE	DRAWING NO.	PAGE	OF	REV.
			DIST	LB			A	SS86561			10

ERROR: syntaxerror
OFFENDING COMMAND: --nostringval--

STACK:

/im
-savelevel-

C.W. ROTATION

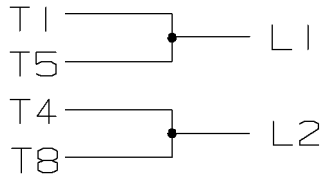

C.C.W. ROTATION

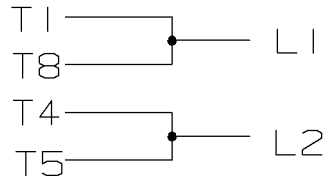

SINGLE VOLTAGE
CAPACITOR START
CAPACITOR RUN
REVERSIBLE

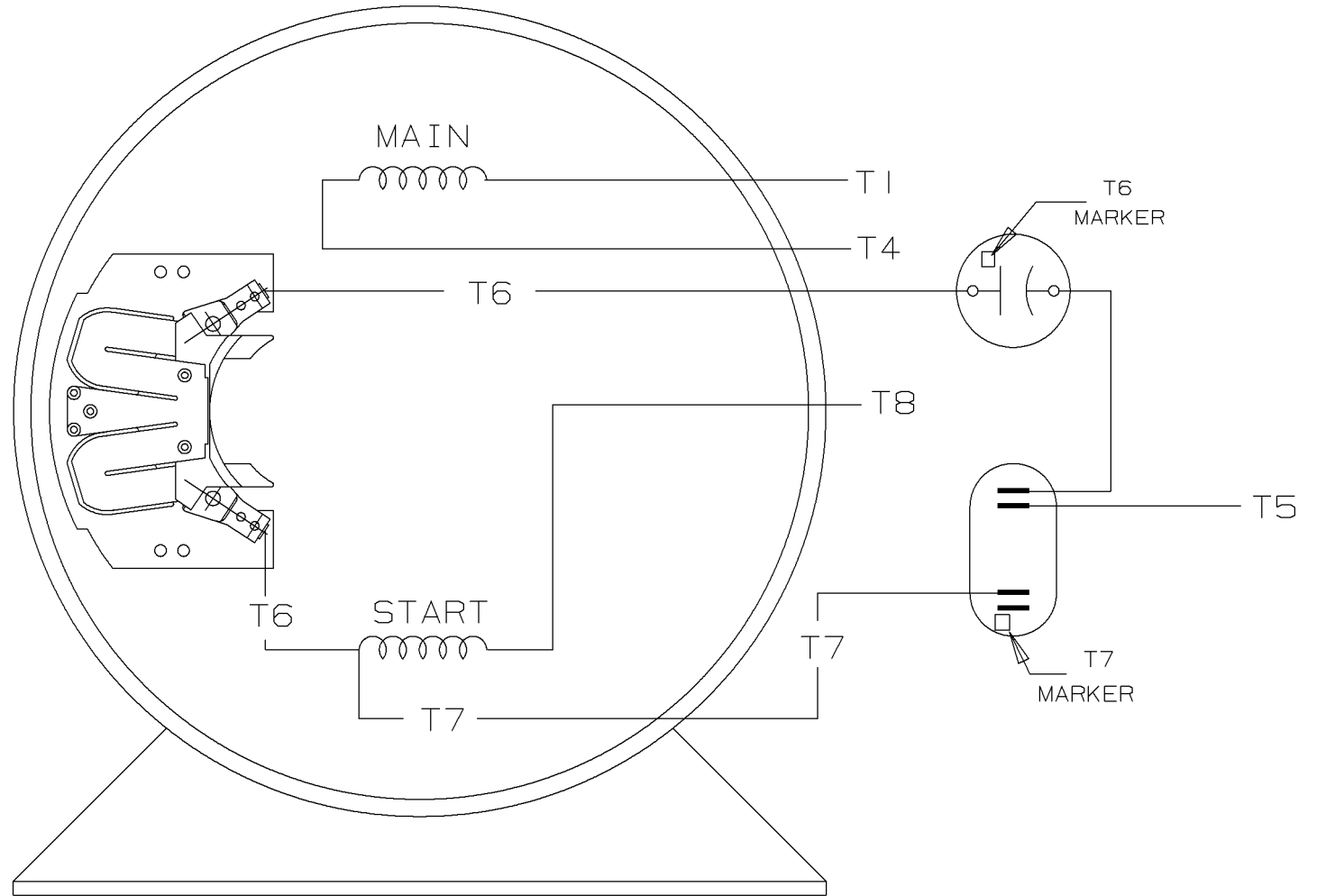

VIEW OF TERMINAL END

				<input checked="" type="checkbox"/> MAX. SURFACE ROUGHNESS UNLESS NOTED OTHERWISE	UNLESS OTHERWISE SPECIFIED DIMENSIONS ARE IN INCHES TOL. ON XX± XXX±.005 XXXX±.0005 ANGLES±			
				MATL SPEC	180 - 210 SWITCH	DRAWN BY	GK	11-01-1986
				FINISH		CHKD BY	ML	11-01-1986
				REFERENCE DRW.		WAUSAU, WISCONSIN 54401	APPD BY	FG
				PART NAME	CONNECTION DIAGRAM		DRWG NO	A-EE9048MF

REV	DATE	CHANGE	NAME	SHOP BOOK	PURCHASED	DISTRIBUTION - WA - LB - WP - LM - BR	CADD FILE NO.	EE9048MF
-----	------	--------	------	-----------	-----------	---------------------------------------	---------------	----------



MARATHON ELECTRIC CORPORATION
TYPICAL PERFORMANCE CURVE for AC MOTOR

Customer _____ Curve at 230 Volts HP 3.00 PHASE 1
 Model No 215TBDW7079 60 HZ
3 HP VOLTS 230
 Catalog No I144 HZ 60 RPM 1155

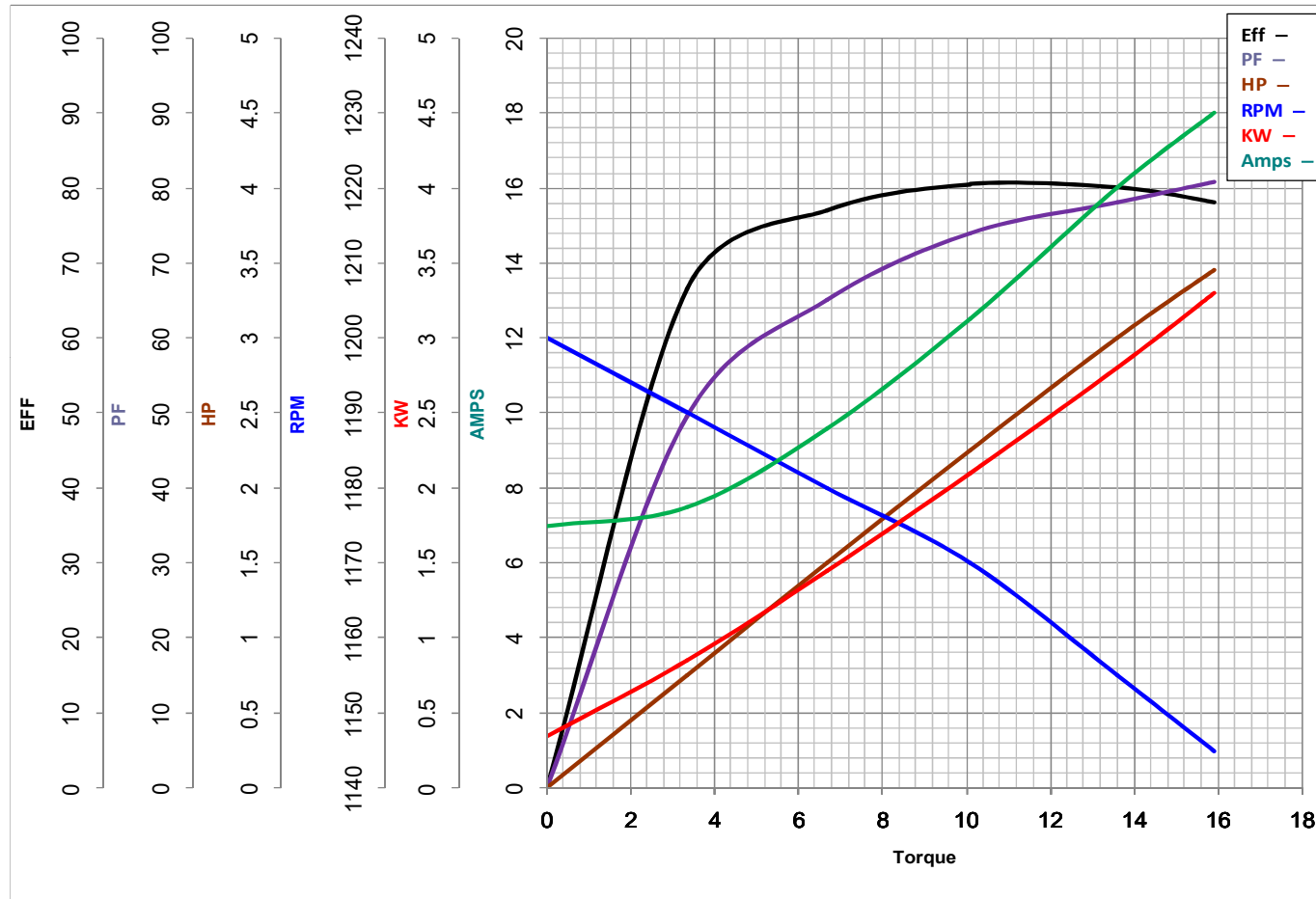

				Torque in Lb.Ft	
FL TORQUE	<u>13.6</u>	Lb.Ft	FL AMPS	<u>16</u>	
BD TORQUE	<u>24.6</u>	Lb.Ft	PU TORQUE	<u>16.9</u>	Lb.Ft
LR TORQUE	<u>16</u>	Lb.Ft	LR AMPS	<u>77</u>	
WINDING	BK10623-2		Date	<u>1/17/2019</u>	

EC Declaration of Conformity

The undersigned representing
the manufacturer:

Regal Beloit America
100 East Randolph St.
Wausau, WI 54401

and the authorized representative
established within the Community:

Marathon Electric UK
6F Thistleton Road Ind. Estate
Market Overton
Oakham, Rutland LE15 7PP UK

are committed to providing customers with products that comply with applicable regulations and international protocols to which they are subject, including the requirements of the European Parliament Directive on the Harmonization of the laws relating to electrical equipment designed for use within certain voltage limits (2014/35/EU).

Regal Beloit America declares that the following product(s), to which this declaration relates, are in conformity with the relevant sections of the EC standards listed below.

This statement supersedes any statements previously issued pertaining to the product(s) listed below and is subject to change without notice.

Model No : 215TBDW7079

(Model No. may contain prefix and/or suffix characters)

Catalog No : I144

Rework No : N/A

Directives :

Low Voltage Directive 2014/35/EU

Harmonized Standards Used :

EN 60034-1: 2010 (IEC 60034-1: 2010)

EN 60034-5: 2001/A1:2007 (IEC 60034-5: 2000/A1:2006)

Authorized Representative:



Michael A. Logsdon
Vice President, Technology

Authorized Representative in the Community:



Julian Clark
Marketing Engineer

Created on 09/01/2022

CE 22