

PRODUCT INFORMATION PACKET

marathon®
Motors

Model No: 213TTFWD16016

Catalog No: M881B

Vertical Pump Motor, 7.50 HP, 3 Ph, 60 Hz, 230/460 V, 3600 RPM, 213HPV Frame, TEFC

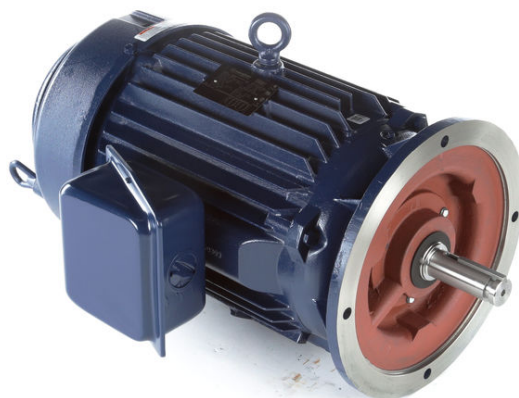

Regal and Marathon are trademarks of Regal Rexnord Corporation or one of its affiliated companies.

©2023 Regal Rexnord Corporation, All Rights Reserved. MC017097E

RegalRexnord

Nameplate Specifications

Output HP	7.50 Hp	Output KW	5.6 kW
Frequency	60 Hz	Voltage	230/460 V
Current	18.6/9.3 A	Speed	3525 rpm
Service Factor	1.15	Phase	3
Efficiency	89.5 %	Power Factor	84.6
Duty	Continuous	Insulation Class	F
Design Code	B	KVA Code	H
Frame	213HPV	Enclosure	Totally Enclosed Fan Cooled
Thermal Protection	No Protection	Ambient Temperature	40 °C
Drive End Bearing Size	6309	Opp Drive End Bearing Size	6206
UL	Recognized	CSA	Y
CE	Y	IP Code	43
Number of Speeds	1		

Technical Specifications

Electrical Type	Squirrel Cage Induction Run	Starting Method	Across The Line
Poles	2	Rotation	Reversible
Resistance Main	.1725 Ohms	Mounting	Round
Motor Orientation	Shaft Down	Drive End Bearing	Ball
Opp Drive End Bearing	Ball	Frame Material	Rolled Steel
Shaft Type	HP	Overall Length	21.16 in
Frame Length	9.65 in	Shaft Diameter	1.125 in
Shaft Extension	2.75 in	Assembly/Box Mounting	F1/F2 CAPABLE
Connection Drawing	EE7308	Outline Drawing	SS86643-965

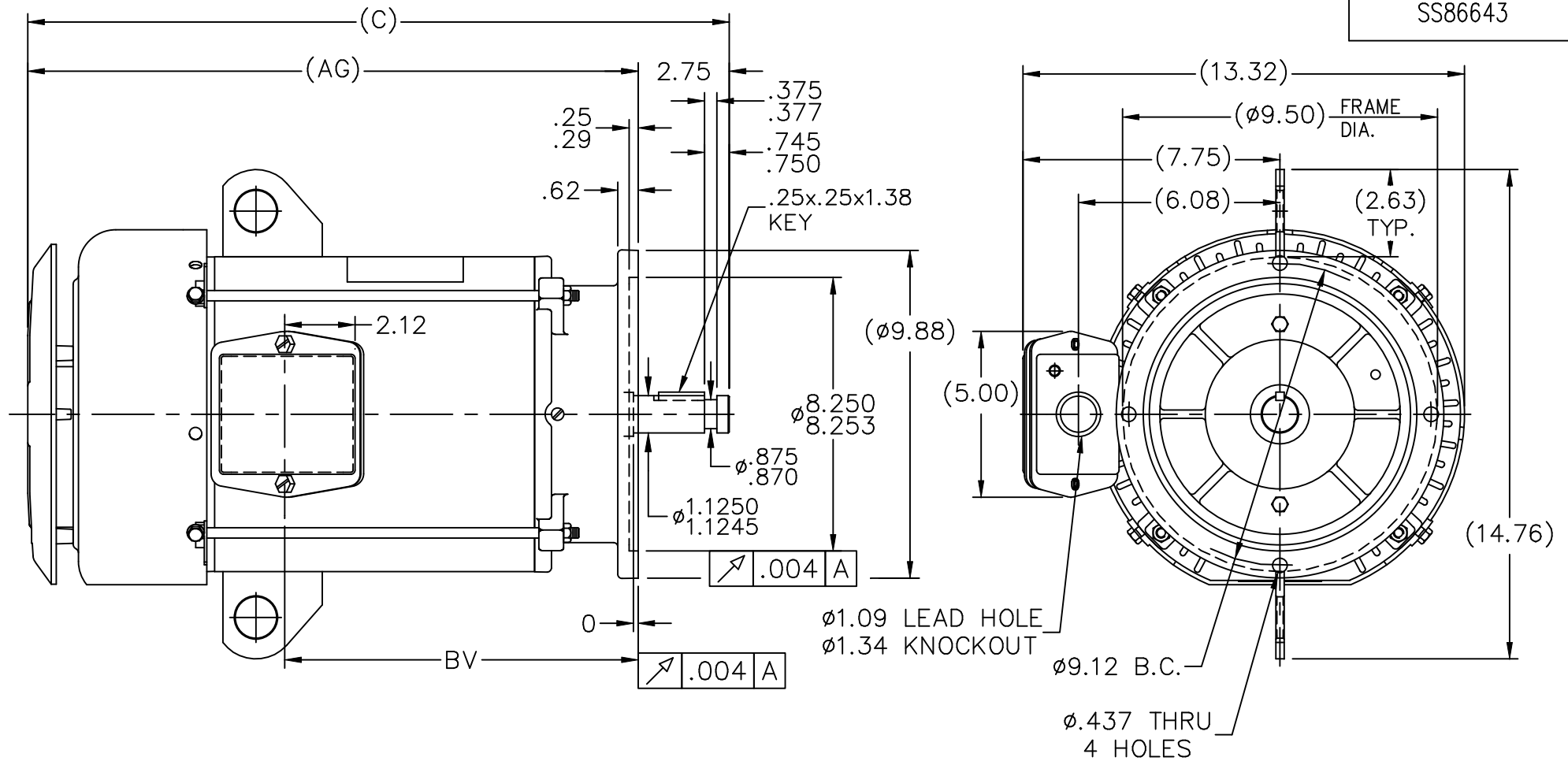

DASH	FR.	C	AG	BV
965	213T	21.16	18.41	10.66
1115	213/15T	22.66	19.91	12.16
1240	213/15T	23.91	21.16	13.41

NOTES:

- NAMEPLATE TO BE READ FROM SHAFT EXT. END OF MOTOR.
- BOX CAN BE MOUNTED IN 90° STEPS.

				TOLERANCES UNLESS SPECIFIED		MARATHON ELECTRIC	DRAWN MRB 11-05-1996	
NO.	REVISION	BY & DATE	CHK	ANG	±7'30"		PREV	
7	UPDATED DRAWING	TJW 04/30/2007	DEC.	INCHES		TITLE OUTLINE 210T FR.-TEFC-P' BASE-R/S FRAME	CHK	ML 11-07-1996
6	REDRAWN IN AUTOCAD	TAT 07-22-2004	ML	.X	±.1		APPD	DN 11-08-1996
5	ADDED $\phi 9.12$ B.C. & $\phi .437$ (4) HOLES CN 29200-1501	HLB 02-27-2001		.XX	±.03		SCALE	7=32
4	UPDATED C' BOX GEOMETRY CN 28425	DRS 01-31-2000		.XXX	±.005		REF	
3	REMOVED GROUND SCREW FROM FRAME CN 24453	MJD 10-01-1997		.XXXX	±.0005		FMF	
THIS DRAWING IN DESIGN AND DETAIL IS OUR PROPERTY AND MUST NOT BE USED EXCEPT IN CONNECTION WITH OUR WORK ALL RIGHTS OF DESIGN AND INVENTION ARE RESERVED THIS IS AN ELECTRONICALLY GENERATED DOCUMENT - DO NOT SCALE THIS PRINT		RFP	CAD FILE ss86643		SIZE	DRAWING NO.	PAGE	OF
		DIST LB			A	SS86643		7



				TOLERANCES UNLESS SPECIFIED		 Regal Beloit America, Inc.	DRAWN RM 11/20/1990				
5	CHG TO REGAL LOGO	SL 09/10/2015	AB	DEC.	INCHES		CHK ML 11/21/1990				
4	REVISED IEC NOTATIONS	MSG 11/15/2011	CMN	.X	±.1		APPD SAS 04/24/2003				
3	ADDED IEC NOTATIONS... (U1), (V1) ETC. MU95194	MSG 5/10/2010	MJS	.XX	±.02		SCALE 1=1				
2	ADDED THE OPTIONAL CORD CONNECTION MU46318	RDH 04/24/2003	DRS	.XXX	±.005	TITLE CONNECTION DIAGRAM 3ø – DUAL VOLTAGE MOTOR	REF				
1	REDRAWN	RM 11/20/1990		.XXXX	±.0005	MAT'L	FMF				
NO.	REVISION	BY & DATE	CHK	ANG	±7"30"	FINISH	PREV				
THIS DRAWING IN DESIGN AND DETAIL IS OUR PROPERTY AND MUST NOT BE USED EXCEPT IN CONNECTION WITH OUR WORK ALL RIGHTS OF DESIGN AND INVENTION ARE RESERVED THIS IS AN ELECTRONICALLY GENERATED DOCUMENT – DO NOT SCALE THIS PRINT			RFP		CAD FILE ee7308		SIZE	DRAWING NO.	PAGE	OF	REV.
			DIST WP				A	EE7308			5

CERTIFICATION DATA SHEET

**P.O. BOX 8003
WAUSAU, WI 54401-8003
PH. 715-675-3311**

CONN. DIAGRAM: EE7308

MODEL #: 213TTFWD16016 AA

OUTLINE: SS86643-965

MOUNTING: F1/F2 CAPABLE

WINDING #: K2132124 2

TYPICAL MOTOR PERFORMANCE DATA

HP	kW	SYNC. RPM	F.L. RPM	FRAME	ENCLOSURE	KVA CODE	DESIGN
7 1/2	5.60	3600	3525	213HPV	TEFC	H	B

PH	Hz	VOLTS	AMPS	START TYPE	DUTY	INSL	S.F.	AMB°C
3	60	230/460	18.6/9.3	ACROSS THE LINE	CONTINUOUS	F3	1.15	40

FULL LOAD EFF:	89.5	3/4 LOAD EFF:	88.9	1/2 LOAD EFF:	88.1	GTD. EFF		ELEC. TYPE
FULL LOAD PF:	84.6	3/4 LOAD PF:	79.7	1/2 LOAD PF:	68.4	89.5		SQ CAGE IND RUN

F.L. TORQUE		LOCKED ROTOR AMPS		L.R. TORQUE		B.D. TORQUE		F.L. RISE°C
11.2 LB-FT		126 / 63		19.3 LB-FT 172 %		33 LB-FT 295 %		55

SOUND PRESSURE @ 3 FT.		SOUND POWER		ROTOR WK^2		MAX. WK^2		SAFE STALL TIME		STARTS / HOUR		APPROX. MOTOR WGT
72 dBA		82 dBA		0.55 LB-FT^2		12 LB-FT^2		20 SEC.		2		165 LBS.

***** SUPPLEMENTAL INFORMATION *****

DE BRACKET TYPE	ODE BRACKET TYPE	MOUNT TYPE	ORIENTATION	SEVERE DUTY	HAZARDOUS LOCATION	DRIP COVER	SCREENS	PAINT
P-BASE	STANDARD	ROUND	SHAFT DOWN	FALSE	NONE	TRUE	NONE	BLUE (ENAMEL)

BEARINGS		GREASE	SHAFT TYPE	SPECIAL DE	SPECIAL ODE	SHAFT MATERIAL	FRAME MATERIAL
DE	ODE						
BALL	BALL	POLYREX EM	HP	NONE	NONE	1045 HOT ROLLED (C-204)	ROLLED STEEL
6309	6206						

THERMO-PROTECTORS				THERMISTORS	CONTROL	SPACE HEATERS
THERMOSTATS	PROTECTORS	WDG RTDs	BRG RTDs			
NONE	NOT	NONE	NONE	NONE	FALSE	NONE VOLTS

*

N

O

T

E

S

*

INVERTER TORQUE:	NONE
INV. HP SPEED RANGE:	NONE
ENCODER:	NONE
NONE	NONE
NONE	NONE PPR
BRAKE:	NONE NONE
NONE	P/N NONE
NONE	NONE
NONE FT-LB	NONE V NONE Hz

MARATHON ELECTRIC CORPORATION

TYPICAL PERFORMANCE CURVE for AC MOTOR

Customer

Curve at

460

Volts

HP 7.50PHASE 3Model No 213TTFWD1601660

HZ

VOLTS 230/4607.5

HP

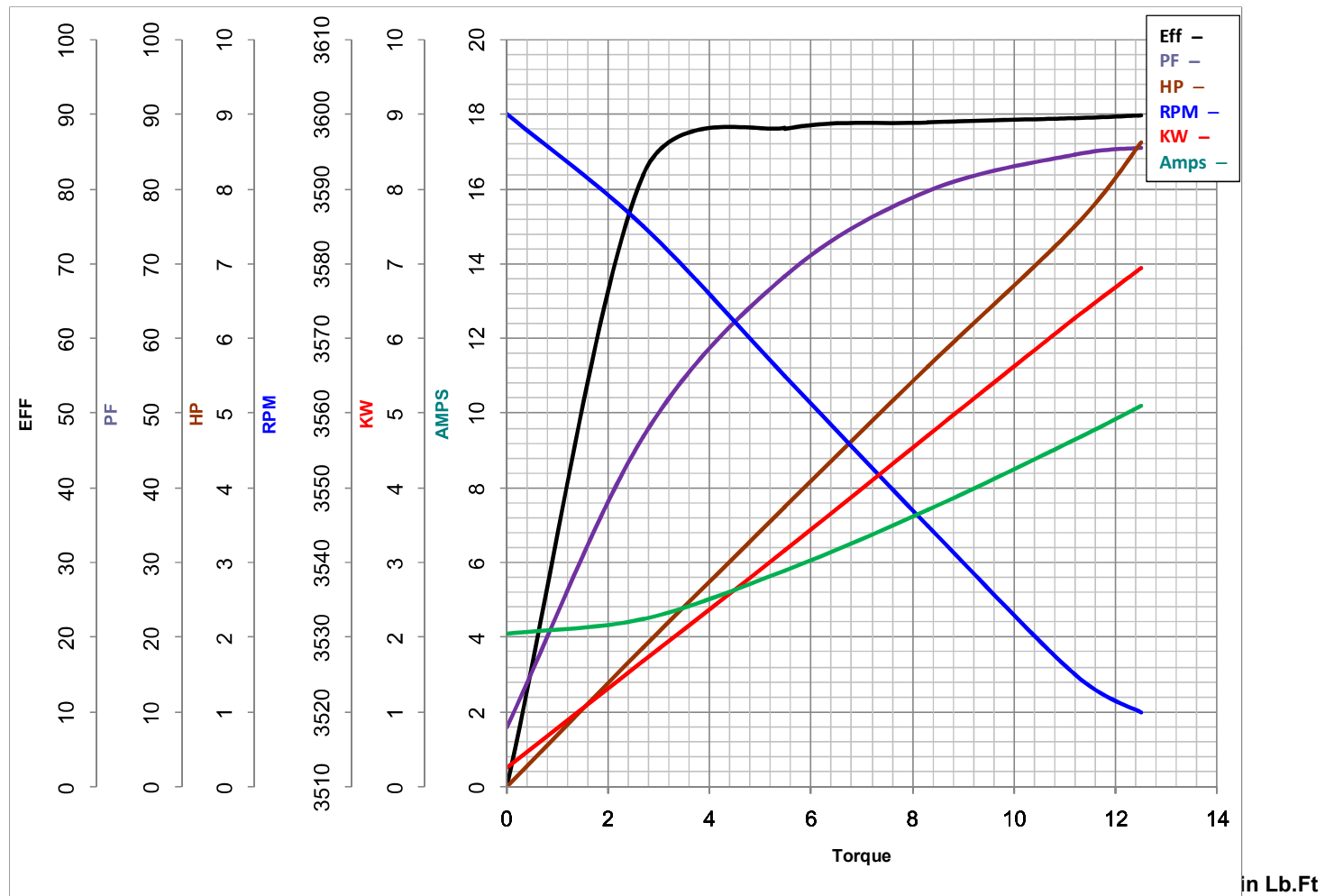
HZ 60RPM 3525Catalog No M881B

FL TORQUE 11.2 Lb.Ft
 BD TORQUE 33.0 Lb.Ft
 LR TORQUE 19.3 Lb.Ft

FL AMPS 18.6/9.3
 PU TORQUE 19.0 Lb.Ft
 LR AMPS 63

WINDING

K2132124-2

Prepared By

ANUSHA.M

Date

11/5/2018

EC Declaration of Conformity

The undersigned representing
the manufacturer:

Regal Beloit America
100 East Randolph St.
Wausau, WI 54401

and the authorized representative
established within the Community:

Marathon Electric UK
6F Thistleton Road Ind. Estate
Market Overton
Oakham, Rutland LE15 7PP UK

are committed to providing customers with products that comply with applicable regulations and international protocols to which they are subject, including the requirements of the European Parliament Directive on the Harmonization of the laws relating to electrical equipment designed for use within certain voltage limits (2014/35/EU).

Regal Beloit America declares that the following product(s), to which this declaration relates, are in conformity with the relevant sections of the EC standards listed below.

This statement supersedes any statements previously issued pertaining to the product(s) listed below and is subject to change without notice.

Model No : 213TTFWD16016

(Model No. may contain prefix and/or suffix characters)

Catalog No : M881B

Rework No : N/A

Directives :

Low Voltage Directive 2014/35/EU

Harmonized Standards Used :

EN 60034-1: 2010 (IEC 60034-1: 2010)

EN 60034-5: 2001/A1:2007 (IEC 60034-5: 2000/A1:2006)

Authorized Representative:

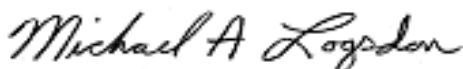

Michael A. Logsdon
Vice President, Technology

Authorized Representative in the Community:



Julian Clark
Marketing Engineer

Created on 09/01/2022

CE 22