

PRODUCT INFORMATION PACKET



Model No: 213TTDW7101

Catalog No: H184

2 HP General Purpose Motor, 3 phase, 900 RPM, 230/460 V, 213T Frame, ODP
General Purpose Motors

Regal and Marathon are trademarks of Regal Rexnord Corporation or one of its affiliated companies.
©2021 Regal Rexnord Corporation, All Rights Reserved. MC017097E



Nameplate Specifications

Output HP	2 Hp	Output KW	1.5 kW
Frequency	60 Hz	Voltage	230/460 V
Current	9.0/4.5 A	Speed	870 rpm
Service Factor	1.15	Phase	3
Efficiency	80 %	Power Factor	51.5
Duty	Continuous	Insulation Class	B
Design Code	B	KVA Code	J
Frame	213T	Enclosure	Drip Proof
Thermal Protection	No	Ambient Temperature	40 °C
Drive End Bearing Size	6307	Opp Drive End Bearing Size	6206
UL	Recognized	CSA	Y
CE	Y	IP Code	22
Number of Speeds	1		

Technical Specifications

Electrical Type	Squirrel Cage Induction Run	Starting Method	Across The Line
Poles	8	Rotation	Reversible
Resistance Main	5.73 Ohms	Mounting	Rigid Base
Motor Orientation	Horizontal	Drive End Bearing	Ball
Opp Drive End Bearing	Ball	Frame Material	Rolled Steel
Shaft Type	T	Overall Length	15.80 in
Frame Length	9.65 in	Shaft Diameter	1.375 in
Shaft Extension	3.38 in	Assembly/Box Mounting	F1/F2 CAPABLE
Connection Drawing	A-EE7308	Outline Drawing	A-SS89083-965

This is an uncontrolled document once printed or downloaded and is subject to change without notice. Date Created:10/12/2021

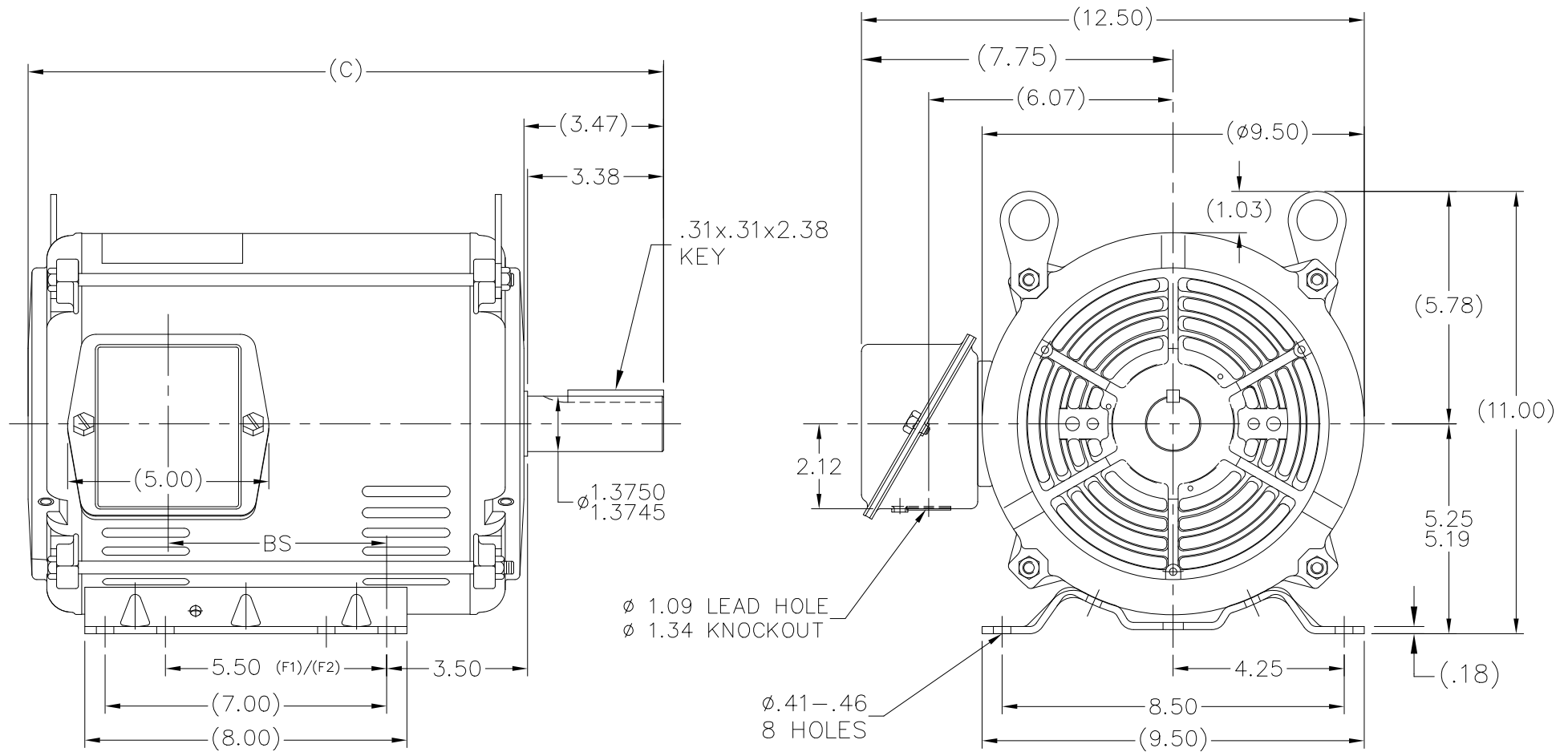

NOTES:

1. NAMEPLATE TO BE READ FROM C'BOX SIDE OF MOTOR.
2. BOX CAN BE MOUNTED IN 90° STEPS.
3. BOX WILL BE AT OPPOSITE SIDE END IN F2 MOUNTING.
4. BOX CAN BE MOUNTED ON OPPOSITE SIDE BY REMOVING BRACKETS AND TURNING FRAME 180°. (EXCEPT AS NOTED.)

DASH	FR.	C	BS	MOUNTING
965	213T	15.80	5.43	F1 & F2
1115	213/215T	17.30	6.93	F1 & F2

NO.	REVISION	BY & DATE	CHK	ANG
N	ADDED -1115 CONFIGURATION	JVD 07/20/2021	AP	.XX
10	UPDATED DRAWING	TJW 05/04/2007		.XXX
9	REDRAWN ON CADD	DRS 07-12-2004		.XXXX

TOLERANCES
UNLESS SPECIFIED

DEC. INCHES

.X $\pm .1$.XX $\pm .03$.XXX $\pm .005$.XXXX $\pm .0005$ ANG $\pm 7'30''$ 

TITLE OUTLINE

210 FR. - BB - T - DR. PR.

MAT'L.

FINISH

DRAWN DRS 07-12-2004

CHK ML 07-13-2004

APPD GK 07-13-2004

SCALE 1=4

REF

FMF CN 38252

PREV

THIS DRAWING IN DESIGN AND DETAIL IS OUR PROPERTY AND MUST NOT BE USED EXCEPT
IN CONNECTION WITH OUR WORK ALL RIGHTS OF DESIGN AND INVENTION ARE RESERVED
THIS IS AN ELECTRONICALLY GENERATED DOCUMENT - DO NOT SCALE THIS PRINT

RFP

DIST LB

CAD FILE ss89083

SIZE

A

DRAWING NO. PAGE 1 OF 1

SS89083

REV.

N



NO.	REVISION	BY & DATE	CHK	ANG	TOLERANCES UNLESS SPECIFIED		DRAWN RM	11/20/1990
					DEC.	INCHES		
5	CHG TO REGAL LOGO	SL 09/10/2015	AB				CHK	ML 11/21/1990
4	REVISED IEC NOTATIONS	MSG 11/15/2011	CMN	.X	±.1		APPD	SAS 04/24/2003
3	ADDED IEC NOTATIONS... (U1), (V1) ETC. MU95194	MSG 5/10/2010	MJS	.XX	±.02		SCALE	1=1
2	ADDED THE OPTIONAL CORD CONNECTION MU46318	RDH 04/24/2003	DRS	.XXX	±.005		REF	
1	REDRAWN	RM 11/20/1990		.XXXX	±.0005		FMF	
					±7'30"		PREV	
THIS DRAWING IN DESIGN AND DETAIL IS OUR PROPERTY AND MUST NOT BE USED EXCEPT IN CONNECTION WITH OUR WORK ALL RIGHTS OF DESIGN AND INVENTION ARE RESERVED THIS IS AN ELECTRONICALLY GENERATED DOCUMENT - DO NOT SCALE THIS PRINT					RFP	CAD FILE ee7308	SIZE	DRAWING NO. PAGE OF REV.
					DIST WP		A	EE7308 5