

PRODUCT INFORMATION PACKET

Model No: 213TCDW7026

Catalog No: I117

5 HP General Purpose Motor, 1 phase, 1800 RPM, 208-230 V, 213T Frame, ODP
General Purpose Motors



Regal and Marathon are trademarks of Regal Rexnord Corporation or one of its affiliated companies.
©2021 Regal Rexnord Corporation, All Rights Reserved. MC017097E



Nameplate Specifications

Output HP	5 Hp	Output KW	3.7 kW
Frequency	60 Hz	Voltage	208-230 V
Current	30.5-28.0 A	Speed	1730 rpm
Service Factor	1.15	Phase	1
Efficiency	78.5 %	Power Factor	73
Duty	Continuous	Insulation Class	B
Design Code	L	KVA Code	H
Frame	213T	Enclosure	Drip Proof
Thermal Protection	No	Ambient Temperature	40 °C
Drive End Bearing Size	6307	Opp Drive End Bearing Size	6206
UL	Recognized	CSA	Y
CE	Y	IP Code	22
Number of Speeds	1		

Technical Specifications

Electrical Type	Capacitor Start Induction Run	Starting Method	Across The Line
Poles	4	Rotation	Selective Counterclockwise
Resistance Main	0 Ohms	Mounting	Rigid Base
Motor Orientation	Horizontal	Drive End Bearing	Ball
Opp Drive End Bearing	Ball	Frame Material	Rolled Steel
Shaft Type	T	Overall Length	18.05 in
Frame Length	11.15 in	Shaft Diameter	1.375 in
Shaft Extension	3.47 in	Assembly/Box Mounting	F1 ONLY
Connection Drawing	A-EE7090JL	Outline Drawing	A-SS86561-1115

This is an uncontrolled document once printed or downloaded and is subject to change without notice. Date Created:10/12/2021

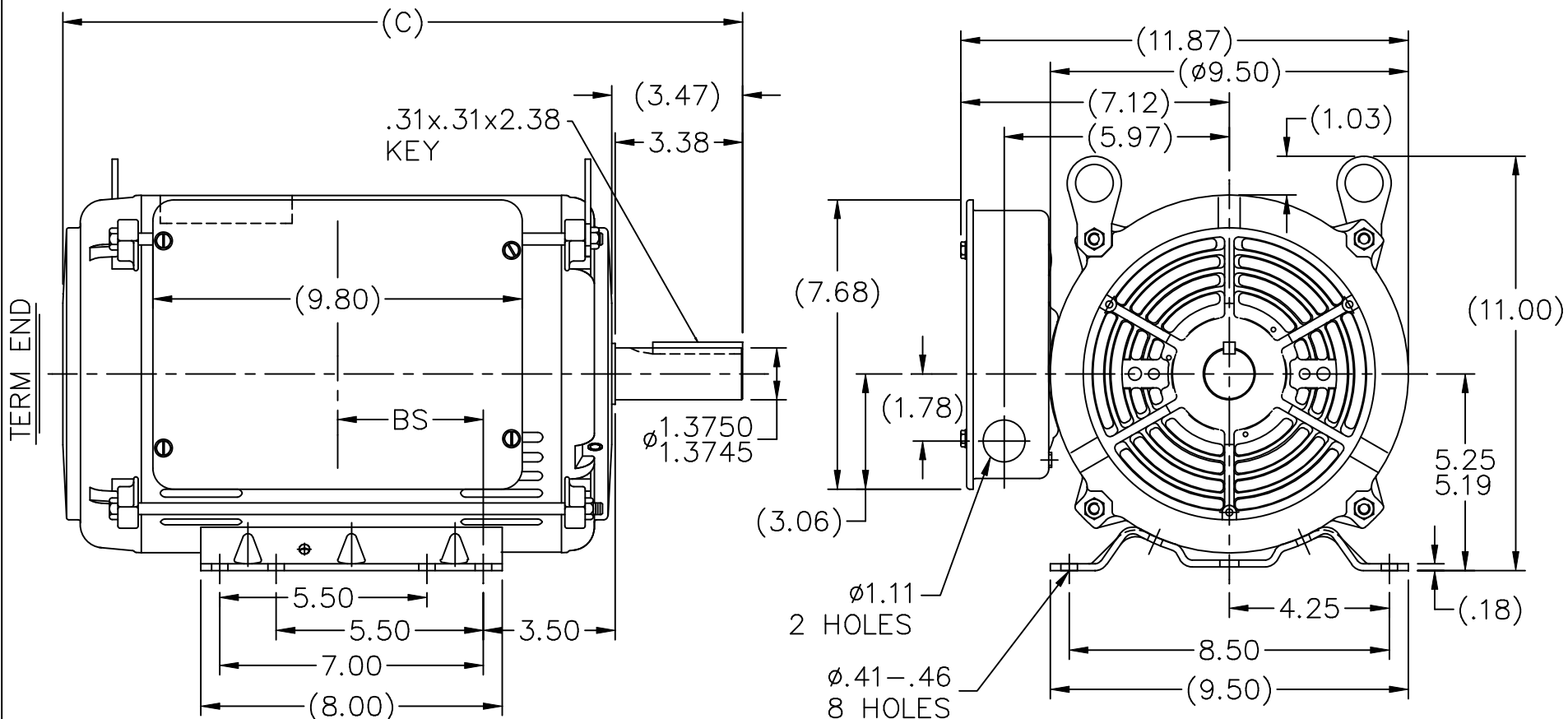

DASH	FR.	C	BS
965	213T	16.55	2.45
1115	213/15T	18.05	3.95
1240	213/15T	19.30	5.20

NOTES:

1. NAMEPLATE TO BE READ FROM C'BOX SIDE OF MOTOR.

NO.	REVISION	BY & DATE	CHK	ANG	TOLERANCES UNLESS SPECIFIED	FINISH	PREV
10	CHG. C'BOX BACK TO OLD BOX 07-1847	RWR 04-14-2008					
9	NEW C'BOX 07-1847	RJW 01-07-2008	ML	DEC.	INCHES		
8	UPDATED DRAWING	TJW 04-27-2007		.X	±.1		
7	REDRAWN IN AUTOCAD	TAT 05-19-2005	ML	.XX	±.03		
6	REM. 2 ADD'L ø1.38 CONDUIT BOX HOLES CN 26624	MRB 07-16-1998		.XXX	±.005		
5	ADDED ADD'L ø1.38 HOLE TO COND. BOX CN 26000-304	MJD 04-23-1998		.XXXX	±.0005		
					±7'30"		

		DRAWN SLJ 09-01-1994 CHK SMC 09-01-1994 APPD DRN 09-01-1994
TITLE OUTLINE 210 T FR. - BB - TS - DR.PR.		SCALE 1=4.2 REF
MAT'L.		FMF
RFP		PREV
CAD FILE ss86561		SIZE A
DIST LB		DRAWING NO. SS86561
		PAGE OF 10
		REV. 10

ERROR: syntaxerror
OFFENDING COMMAND: --nostringval--

STACK:

/im
-savelevel-

SINGLE VOLTAGE CAPACITOR START MOTOR, ELECTRICALLY REVERSIBLE

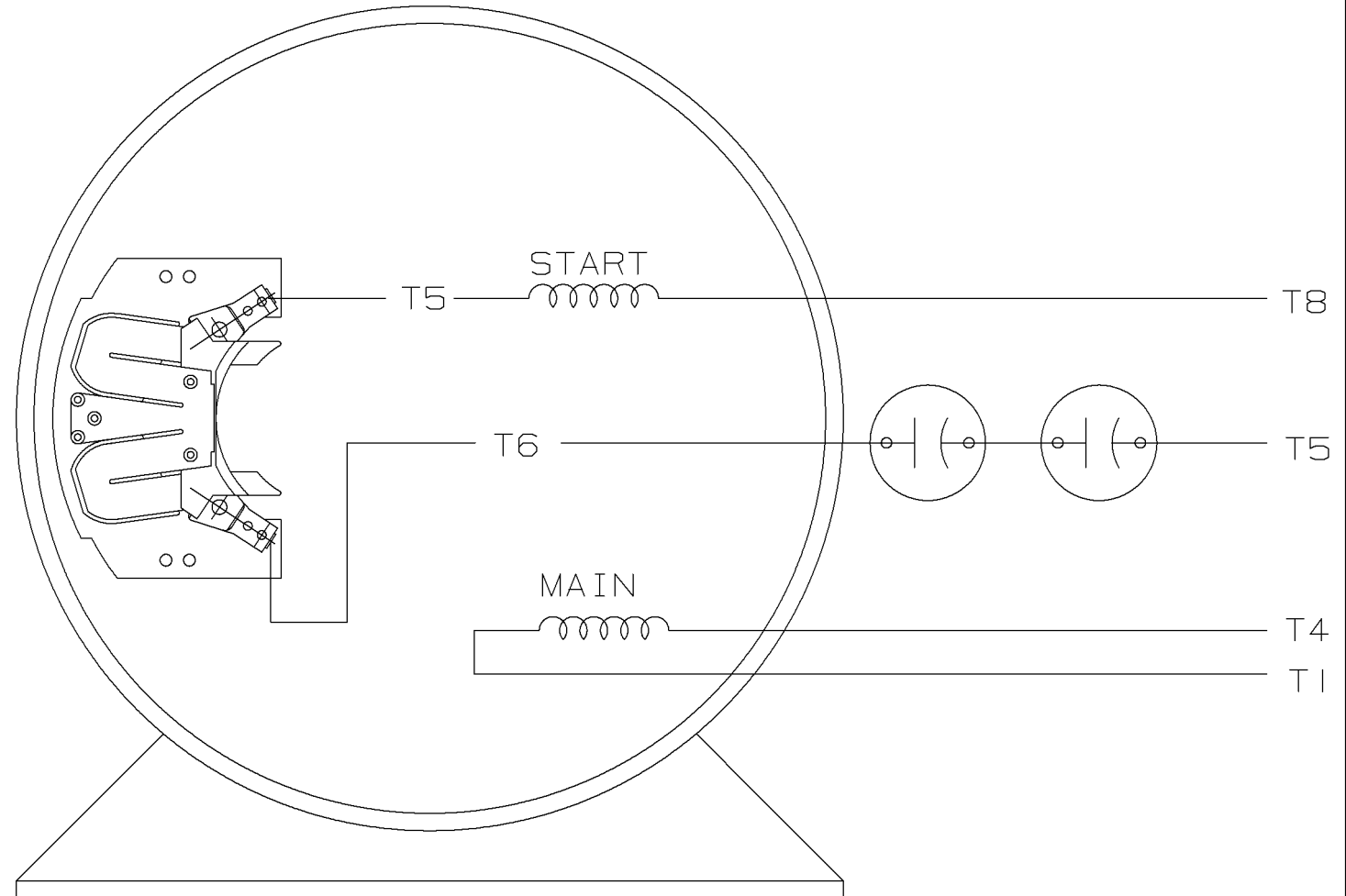
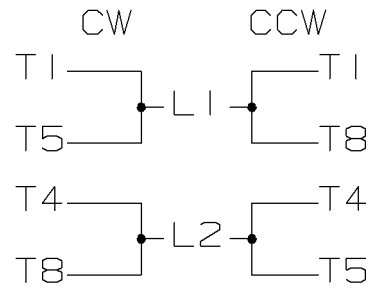

VIEW OF TERMINAL END

				✓ MAX. SURFACE ROUGHNESS UNLESS NOTED OTHERWISE	UNLESS OTHERWISE SPECIFIED DIMENSIONS ARE IN INCHES TOL. ON XX±.02 XXX±.005 XXXX±.0005 ANGLES± 7'30"		
				MATL SPEC	180 - 210 SWITCH	DRAWN BY GK	09-24-1986
				FINISH	MARATHON ELECTRIC	CHKD BY ML	11-04-1986
I	11-04-1986	NEW DRAWING	CN 7664C	GK	REFERENCE DRW.	WAUSAU, WISCONSIN 54401	APPD BY FG 11-04-1986
REV	DATE	CHANGE	NAME	PART NAME CONNECTION DIAGRAM			DRWG NO A- EE7090JL

SHOP BOOK

PURCHASED

DISTRIBUTION - WA - LB - WP - LM - BR

CADD FILE NO.

EE7090JL

```
ERROR: undefined
OFFENDING COMMAND: de
```

```
STACK:
```

```
{pop pop pop pop }
/B
-dictionary-
/Pscript_WinNT_Compat
-dictionary-
```

CERTIFICATION DATA SHEET

Model#: 213TCDW7026 AB
 CONN. DIAGRAM: A-EE7090JL
 OUTLINE: A-SS86561-1115

WINDING#: CK10481 NONE 1
 ASSEMBLY: F1 ONLY

TYPICAL MOTOR PERFORMANCE DATA

HP	KW	SYNC. RPM	F.L. RPM	FRAME	ENCLOSURE	KVA CODE	DESIGN			
5	3.7	1800	1730	213T	DP	H	L			
PH	Hz	VOLTS	FL AMPS	START TYPE	DUTY	INSL	S.F	AMB°C	ELEVATION	
1	60	208-230	30.5-28	ACROSS THE LINE	CONTINUOUS	B3	1.15	40	3300	
FULL LOAD EFF: 78.5		3/4 LOAD EFF: -	1/2 LOAD EFF: -	GTD. EFF		ELEC. TYPE		NO LOAD AMPS		
FULL LOAD PF: 73		3/4 LOAD PF: -	1/2 LOAD PF: -	0		CAP START IND RUN		16.7		
F.L. TORQUE		LOCKED ROTOR AMPS		L.R. TORQUE		B.D. TORQUE		F.L. RISE°C		
15.2 LB-FT		148		33.3 LB-FT -		36.9 LB-FT -		60		
SOUND PRESSURE @ 3 FT.	SOUND POWER	ROTOR WK^2		MAX. WK^2		SAFE STALL TIME		STARTS / HOUR		APPROX. MOTOR WGT
- dBA	- dBA	0 LB-FT^2		- LB-FT^2		- SEC.		-		0 LBS.

*** SUPPLEMENTAL INFORMATION ***

DE BRACKET TYPE	ODE BRACKET TYPE	MOUNT TYPE	ORIENTATION	SEVERE DUTY	HAZARDOUS LOCATION	DRIP COVER	SCREENS	PAINT
STANDARD	STANDARD	RIGID	HORIZONTAL	FALSE	NONE	FALSE	NONE	GRAY (ENAMEL)

BEARINGS		GREASE	SHAFT TYPE	SPECIAL DE	SPECIAL ODE	SHAFT MATERIAL	FRAME MATERIAL
DE	OPE						
BALL	BALL						
6307	6206	POLYREX EM	T	NONE	NONE	1144 STRESSPROOF (C-223)	ROLLED STEEL

THERMO-PROTECTORS				THERMISTORS	CONTROL	SPACE /n HEATERS
THERMOSTATS	PROTECTORS	WDG RTDs	BRG RTDs			
NONE	NOT	NONE	NONE			
				NONE	FALSE	NONE VOLTS

If Inverter equals NONE, contact factory for further information

*
N
O
T
E
S
*

INVERTER TORQUE: NONE
INV. HP SPEED RANGE: NONE
ENCODER: NONE
NONE NONE
NONE NONE PPR
BRAKE: NONE NONE
NONE P/N NONE
NONE NONE
- FT-LB NONE V NONE Hz



MARATHON ELECTRIC CORPORATION
TYPICAL PERFORMANCE CURVE for AC MOTOR

Customer

Curve at

230
60
5

Volts
HZ
HP

HP 5.00

PHASE 1

Model No 213TCDW7026

VOLTS 208-230

Catalog No 1117

HZ 60

RPM 1730

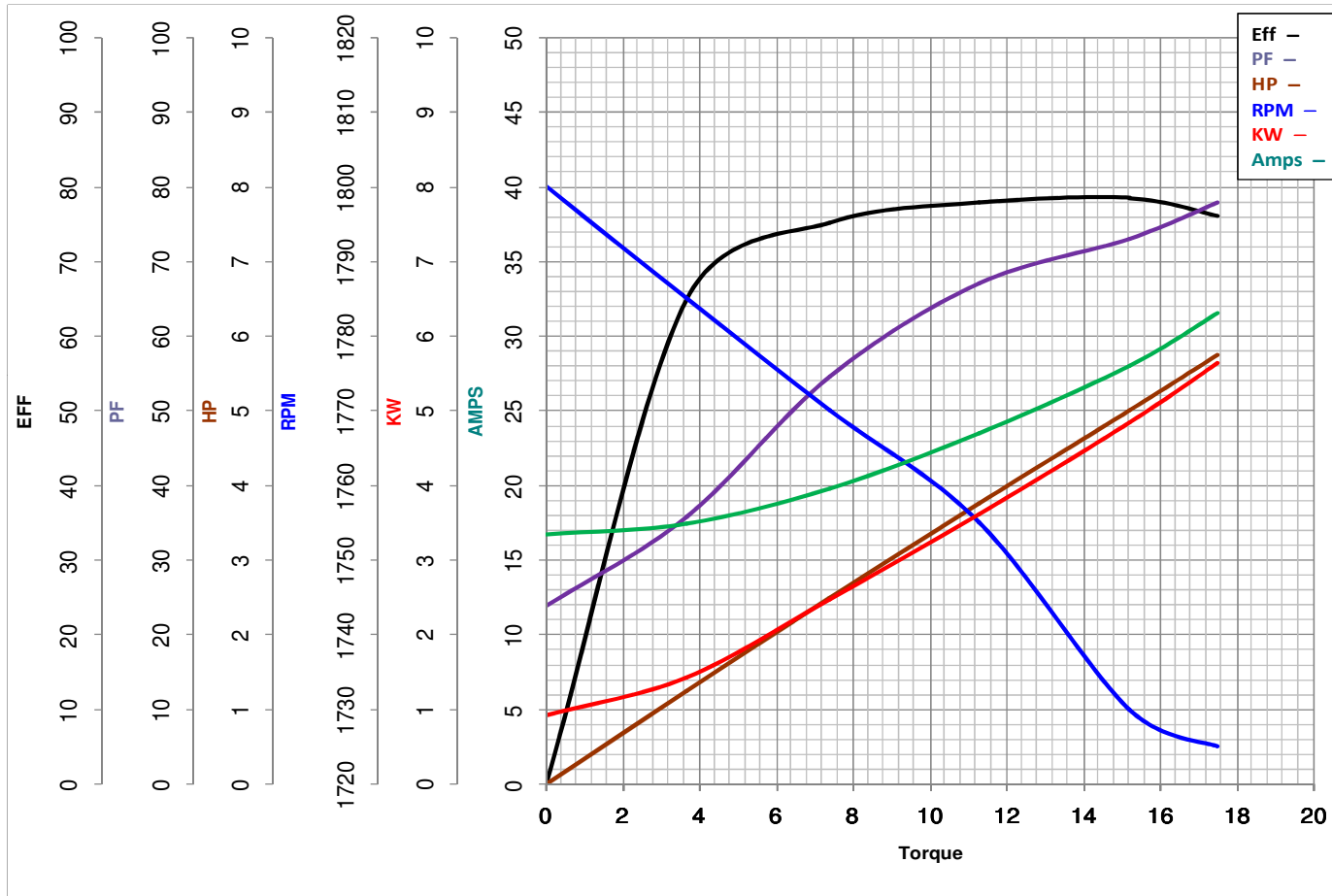

Torque in Lb.Ft

FL TORQUE 15.2 Lb.Ft
BD TORQUE 36.9 Lb.Ft
LR TORQUE 33.3 Lb.Ft

FL AMPS 30.5-28
PU TORQUE 30.9 Lb.Ft
LR AMPS 148

WINDING CK10481-1

Date 1/25/2019