

# PRODUCT INFORMATION PACKET

Model No: 213TCDW7001

Catalog No: I105

Air Compressor Motor, 7.50 HP, 1 Ph, 60 Hz, 208-230 V, 3600 RPM, 213T Frame, DP



Regal and are trademarks of Regal Rexnord Corporation or one of its affiliated companies.  
©2022 Regal Rexnord Corporation, All Rights Reserved. MC017097E

### Nameplate Specifications

|                        |                      |                            |                   |
|------------------------|----------------------|----------------------------|-------------------|
| Output HP              | <b>7.50 Hp</b>       | Output KW                  | <b>5.6 kW</b>     |
| Frequency              | <b>60 Hz</b>         | Voltage                    | <b>208-230 V</b>  |
| Current                | <b>40.0-37.0 A</b>   | Speed                      | <b>3470 rpm</b>   |
| Service Factor         | <b>1.15</b>          | Phase                      | <b>1</b>          |
| Efficiency             | <b>78.5 %</b>        | Power Factor               | <b>82.5</b>       |
| Duty                   | <b>Continuous</b>    | Insulation Class           | <b>B</b>          |
| Design Code            | <b>L</b>             | KVA Code                   | <b>F</b>          |
| Frame                  | <b>213T</b>          | Enclosure                  | <b>Drip Proof</b> |
| Thermal Protection     | <b>No Protection</b> | Ambient Temperature        | <b>40 °C</b>      |
| Drive End Bearing Size | <b>6307</b>          | Opp Drive End Bearing Size | <b>6206</b>       |
| UL                     | <b>Recognized</b>    | CSA                        | <b>Y</b>          |
| CE                     | <b>Y</b>             | IP Code                    | <b>22</b>         |
| Number of Speeds       | <b>1</b>             |                            |                   |

### Technical Specifications

|                       |                                      |                       |                                   |
|-----------------------|--------------------------------------|-----------------------|-----------------------------------|
| Electrical Type       | <b>Capacitor Start Induction Run</b> | Starting Method       | <b>Across The Line</b>            |
| Poles                 | <b>2</b>                             | Rotation              | <b>Selective Counterclockwise</b> |
| Resistance Main       | <b>0 Ohms</b>                        | Mounting              | <b>Rigid Base</b>                 |
| Motor Orientation     | <b>Horizontal</b>                    | Drive End Bearing     | <b>Ball</b>                       |
| Opp Drive End Bearing | <b>Ball</b>                          | Frame Material        | <b>Rolled Steel</b>               |
| Shaft Type            | <b>T</b>                             | Overall Length        | <b>16.55 in</b>                   |
| Frame Length          | <b>9.65 in</b>                       | Shaft Diameter        | <b>1.375 in</b>                   |
| Shaft Extension       | <b>3.47 in</b>                       | Assembly/Box Mounting | <b>F1 ONLY</b>                    |
| Outline Drawing       | <b>037642-965</b>                    | Connection Drawing    | <b>A-EE7090JR</b>                 |

037642

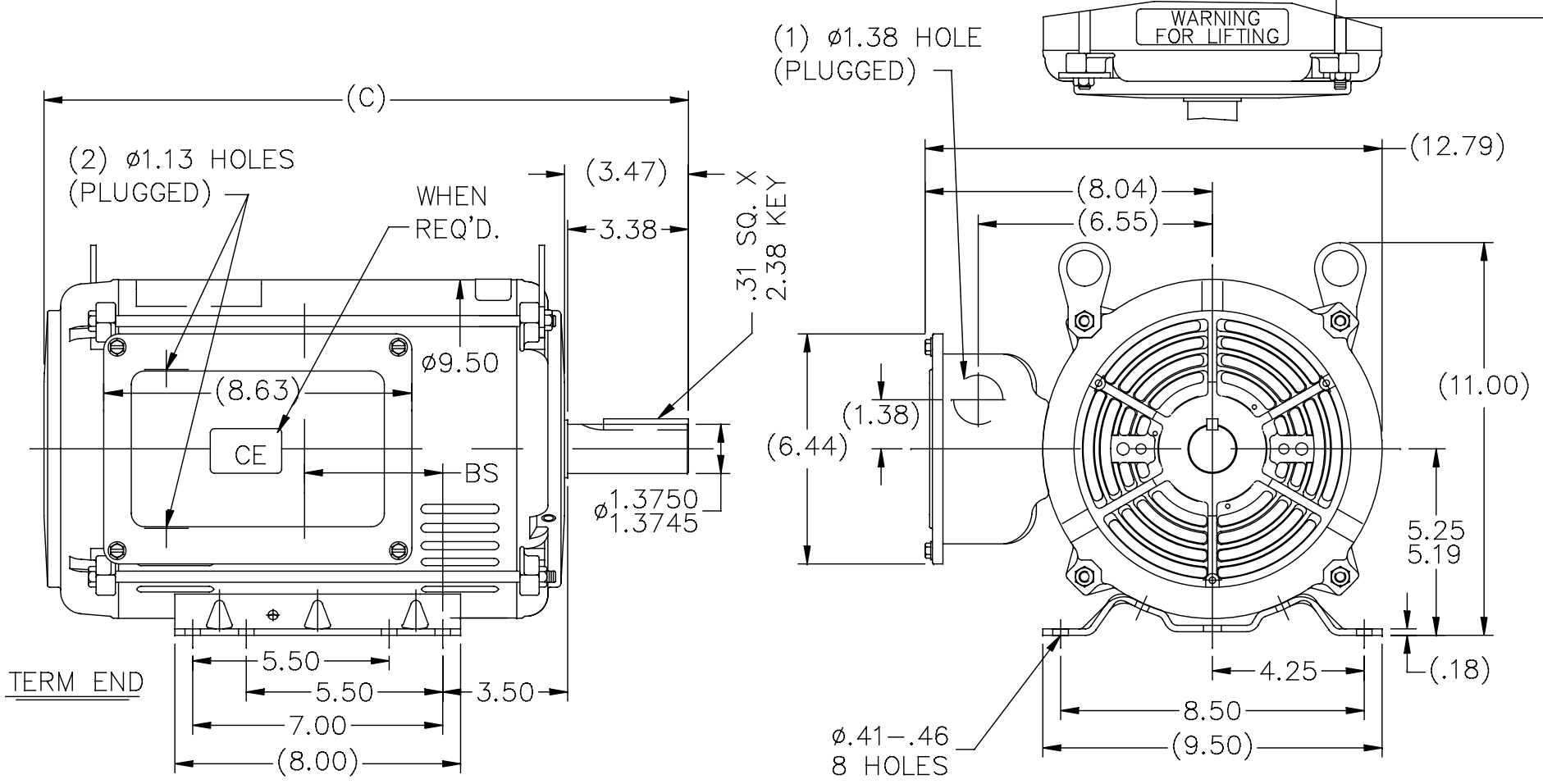

| DASH | FR.     | C     | BS   |
|------|---------|-------|------|
| 965  | 213T    | 16.55 | 2.45 |
| 1115 | 213/15T | 18.05 | 3.95 |
| 1240 | 213/15T | 19.30 | 5.20 |

NOTES:  
 1. NAMEPLATE TO BE READ FROM C'BOX SIDE OF MOTOR.

|  |   |             |     | TOLERANCES UNLESS SPECIFIED |        | <b>Regal Beloit America, Inc.</b> | DRAWN GRB 11/14/08 |                    |             |         |
|--|---|-------------|-----|-----------------------------|--------|-----------------------------------|--------------------|--------------------|-------------|---------|
|  |   |             |     | DEC.                        | INCHES |                                   | CHK SK 11/14/08    | APPD               |             |         |
|  |   |             |     | .X                          | ±.1    |                                   | SCALE 1=4.2        |                    |             |         |
|  |   |             |     | .XX                         | ±.03   | TITLE OUTLINE - 210T              | REF SS86561        |                    |             |         |
| 02   | CHANGED LOGO TO REGAL                   | SL 01/28/16 | GR  | .XXX                        | ±.005  | DP - RIGID - STD                  | FMF                |                    |             |         |
| 01   | DESCRIPTION CHANGED TO DP - RIGID - STD | AK 02/22/10 |     | .XXXX                       | ±.0005 | MAT'L.                            | PREV               |                    |             |         |
| NO.  | REVISION                                | BY & DATE   | CHK | ANG                         | ±7'30" | FINISH                            |                    |                    |             |         |
| THIS DRAWING IN DESIGN AND DETAIL IS OUR PROPERTY AND MUST NOT BE USED EXCEPT IN CONNECTION WITH OUR WORK ALL RIGHTS OF DESIGN AND INVENTION ARE RESERVED THIS IS AN ELECTRONICALLY GENERATED DOCUMENT - DO NOT SCALE THIS PRINT |   |             |     | RFP                         |        | CAD FILE 037642                   | SIZE A             | DRAWING NO. 037642 | PAGE 1 OF 1 | REV. 02 |
|  |   |             |     | DIST                        | LB     |                                   |                    |                    |             |         |

SINGLE VOLTAGE CAPACITOR START MOTOR, ELECTRICALLY REVERSIBLE

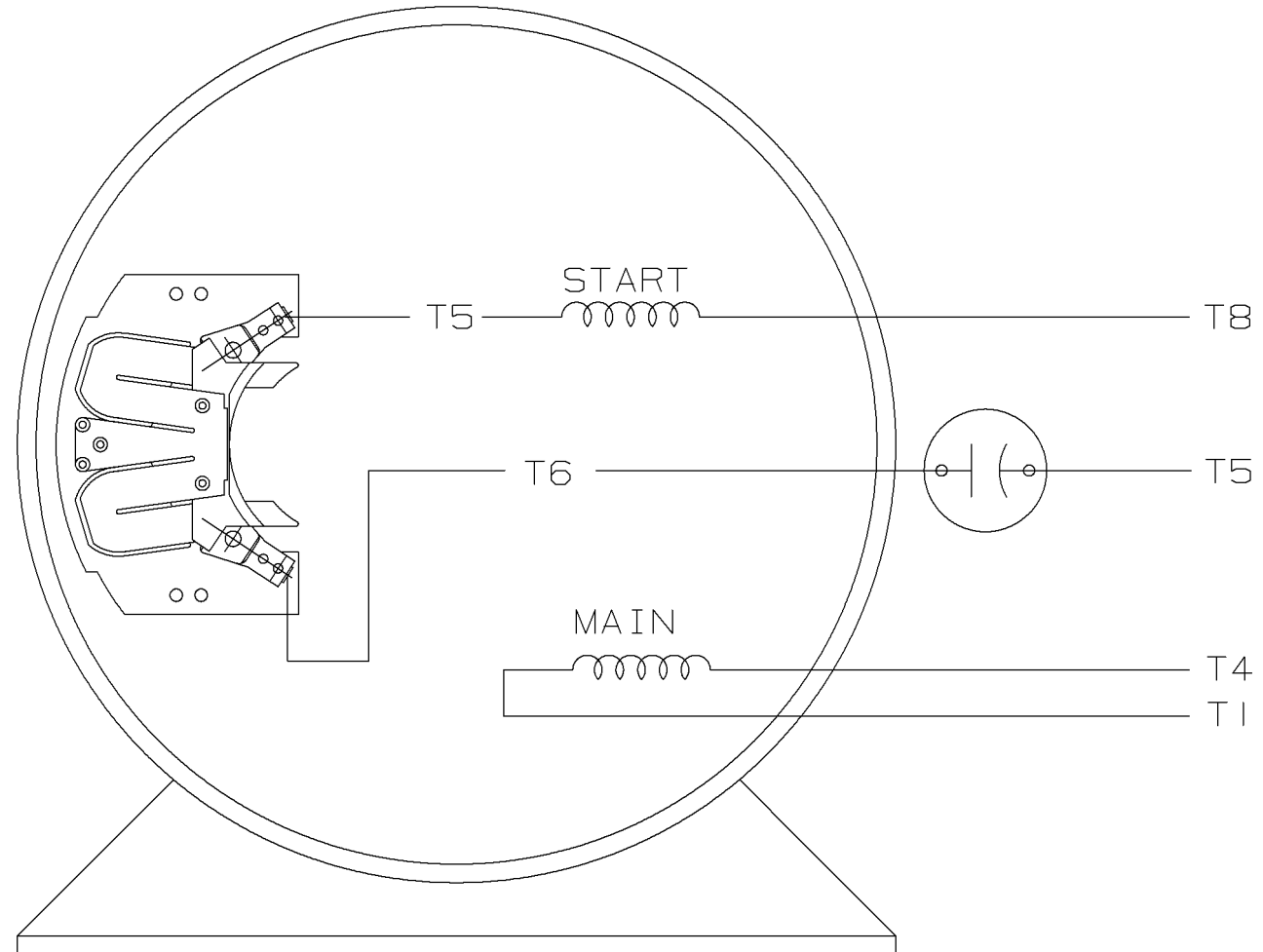
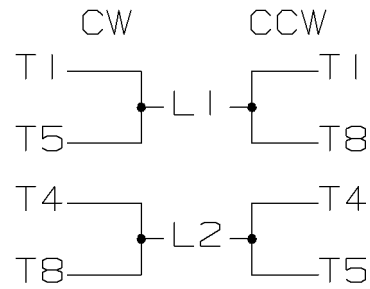

VIEW OF TERMINAL END

|     |            |             |          |   |   |  |                        |
|-----|------------|-------------|----------|---|---|--|------------------------|
|     |            |             |          | ✓ MAX. SURFACE ROUGHNESS UNLESS NOTED OTHERWISE | UNLESS OTHERWISE SPECIFIED DIMENSIONS ARE IN INCHES<br>TOL. ON XX±.02 XXX±.005 XXXX±.0005 ANGLES± 7'30" |  |                        |
|     |            |             |          | MATL SPEC                                       |   |  | DRAWN BY GK 01-10-1987 |
|     |            |             |          | FINISH  |   |  | CHKD BY                |
| 1   | 01-10-1987 | NEW DRAWING | CN-7664C | GK  | REFERENCE DRW. WAUSAU, WISCONSIN 54401  |  | APPD BY                |
| REV | DATE       | CHANGE      |          | NAME  | PART NAME CONNECTION DIAGRAM  |  | DRWG NO<br>A- EE7090JR |

SHOP BOOK

PURCHASED

DISTRIBUTION - WA - LB - WP - LM - BR

CADD FILE NO.

EE7090JR

ERROR: syntaxerror  
OFFENDING COMMAND: --nostringval--

STACK:

214  
/Otilde  
213  
/Ocircumflex  
212  
/Oacute  
211  
/Ograve  
210  
/Ntilde  
209  
/Eth  
208  
/Idieresis  
207  
/Icircumflex  
206  
/Iacute  
205  
/Igrave  
204  
/Edieresis  
203  
/Ecircumflex  
202  
/Eacute  
201  
/Egrave  
200  
/Ccedilla  
199  
/AE  
198  
/Aring  
197  
/Adieresis  
196  
/Atilde  
195  
/Acircumflex  
194  
/Aacute  
193  
/Agrave  
192  
/questiondown  
191  
/threequarters  
190  
/onehalf  
189  
/onequarter  
188  
/guillemotright  
187  
/ordmasculine  
186  
/onesuperior  
185  
/cedilla  
184  
/periodcentered  
183  
/paragraph  
182  
/mu  
181  
/acute



**MARATHON ELECTRIC CORPORATION**

TYPICAL PERFORMANCE CURVE for AC MOTOR

Customer CATALOG

Curve at

230

Volts

HP 7.50

PHASE 1

Model No 213TCDW7001

60

HZ

VOLTS 208-230

7.5

HP

Catalog No I105

HZ 60

RPM 3470

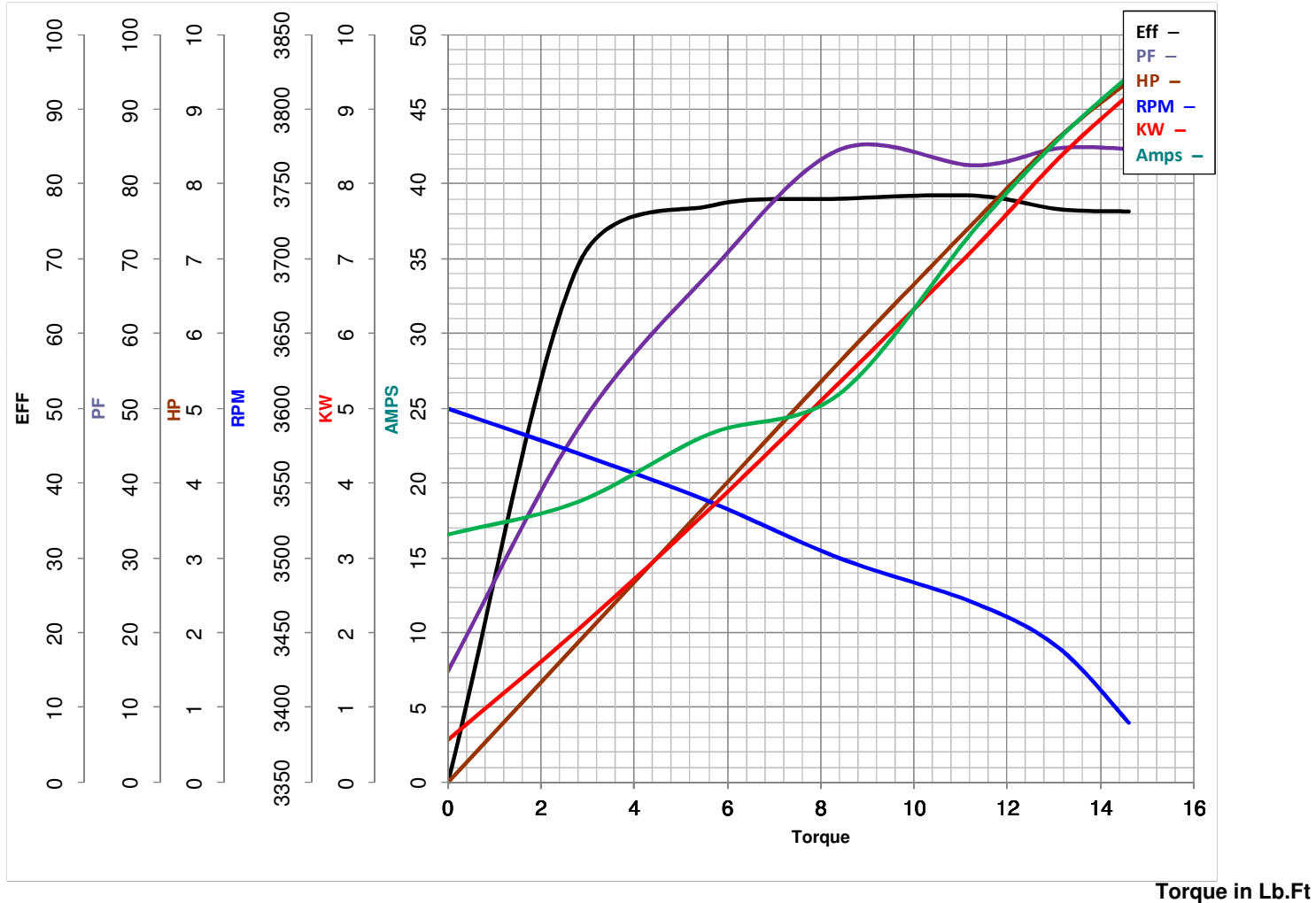

Torque in Lb.Ft

FL TORQUE 11.3 Lb.Ft  
 BD TORQUE 23.2 Lb.Ft  
 LR TORQUE 15.6 Lb.Ft

FL AMPS 40-37  
 PU TORQUE 14.0 Lb.Ft  
 LR AMPS 173

WINDING CK10249-2 Prepared By SRIKANTH Date 6/20/2017