

PRODUCT INFORMATION PACKET

marathon®
Motors

Model No: 200LTFC6538

Catalog No: R346A

Globetrotter® IEC Cast Iron Motor, 40 & 40 HP, 3 Ph, 60 & 50 Hz, 230/460 & 200/400 V,
1800 & 1500 RPM, 200L Frame, TEFC



Regal and Marathon are trademarks of Regal Rexnord Corporation or one of its affiliated companies.

©2023 Regal Rexnord Corporation, All Rights Reserved. MC017097E

RegalRexnord



Nameplate Specifications

Phase	3	Output HP	40 & 40 Hp
Output KW	30.0 & 30.0 kW	Voltage	230/460 & 200/400 V
Speed	1780 & 1475 rpm	Service Factor	1.15 & 1.15
Frame	200L	Enclosure	Totally Enclosed Fan Cooled
Thermal Protection	No Protection	Efficiency	94.1 & 92.4 %
Ambient Temperature	40 °C	Frequency	60 & 50 Hz
Current	92/46 & 106/53 A	Power Factor	86
Duty	Continuous	Insulation Class	F
Design Code	B	KVA Code	G
Drive End Bearing Size	6312	Opp Drive End Bearing Size	6212
UL	No	CSA	Y
CE	Y	IP Code	55
Number of Speeds	1		

Technical Specifications

Electrical Type	Squirrel Cage Inverter Rated	Starting Method	Part Wdg Start & Wye Start Delta Run Or Inverter
Poles	4	Rotation	Reversible
Resistance Main	.042 Ohms	Mounting	Rigid Base
Motor Orientation	Horizontal	Drive End Bearing	Ball
Opp Drive End Bearing	Ball	Frame Material	Cast Iron
Shaft Type	IEC	Overall Length	29.52 in
Shaft Diameter	2.166 in	Shaft Extension	4.31 in
Assembly/Box Mounting	F3	Inverter Load	CONSTANT 2:1
Outline Drawing	B-SS622240	Connection Drawing	004172.03ME

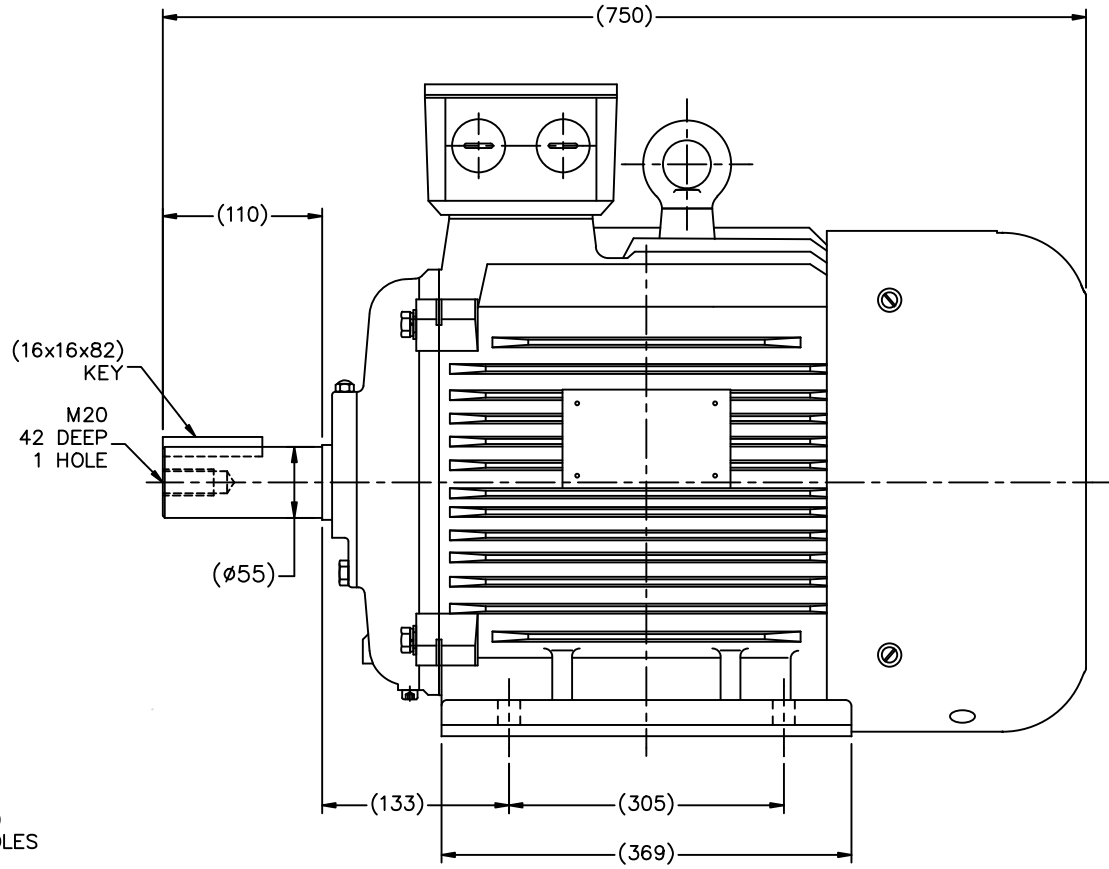
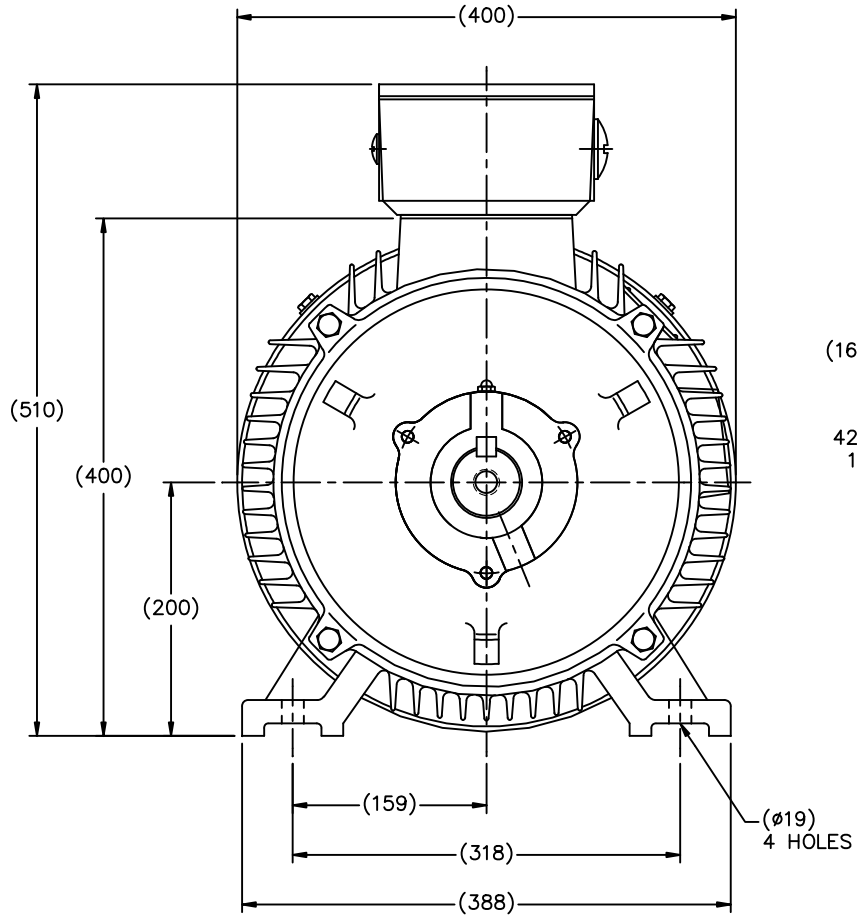

(MAY NOT BE DRAWN TO SCALE)

(DIMENSIONS ARE IN MILLIMETERS)

DF200L	193327.60
	193330.60
	193328.60
	193323.60
	193326.60
FRAME	PART #

				TOLERANCES UNLESS SPECIFIED			DRAWN MSG 11-17-2010
				DEC.	METRIC		CHK MJS 11-18-2010
				.X	±2.5	APPD SB 11-18-2010	SCALE 1=4
				.XX	±.76	TITLE OUTLINE - IEC PREMIUM	
				.XXX	±.127	DF200L-2, 4, 6	
				.XXXX	±.0127	MAT'L	REF
				NO.	REVISION	BY & DATE	FMF HEBEI
				CHK	ANG	±7'30"	PREV
THIS DRAWING IN DESIGN AND DETAIL IS OUR PROPERTY AND MUST NOT BE USED EXCEPT IN CONNECTION WITH OUR WORK ALL RIGHTS OF DESIGN AND INVENTION ARE RESERVED THIS IS AN ELECTRONICALLY GENERATED DOCUMENT - DO NOT SCALE THIS PRINT				RFP	11-18-2010	CAD FILE SS622240	SIZE B
				DIST			DRAWING NO. PAGE OF REV. SS622240

WYE - DELTA STARTING USEABLE ON 2,4 AND 6 POLE MOTORS.

LOW VOLTAGE CONNECTION

HIGH VOLTAGE CONNECTION

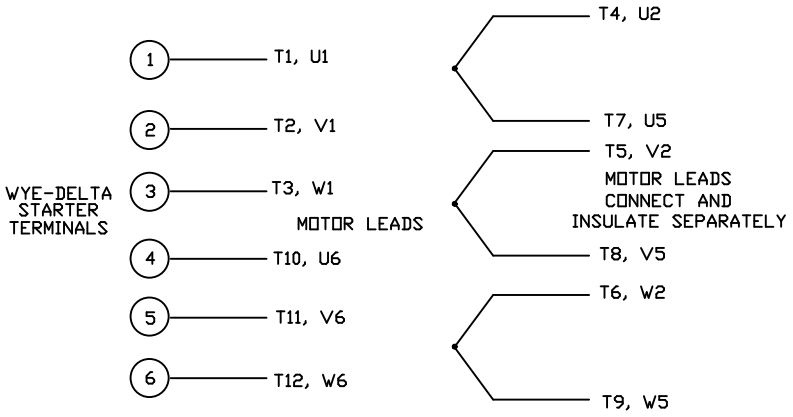
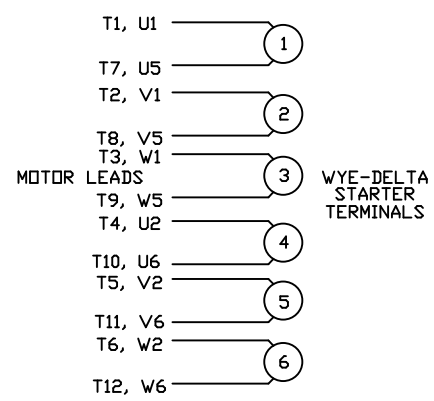

REFER TO THE WYE-DELTA STARTER CONNECTION INSTRUCTIONS FOR PROPER CONNECTION OF POWER LINES TO STARTER.

PART WINDING START USABLE ON 4 & 6 POLE MOTORS
LOW VOLTAGE CONNECTION ONLY

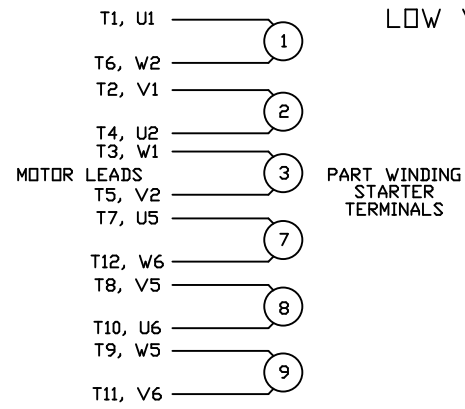

REFER TO THE PART WINDING STARTER INSTRUCTIONS FOR PROPER CONNECTION OF POWER LINES TO STARTER.

REFER TO THE CUTLER - HAMMER OR EQUIV. FOR PROPER SELECTION OF OVERLOAD HEATER COILS.

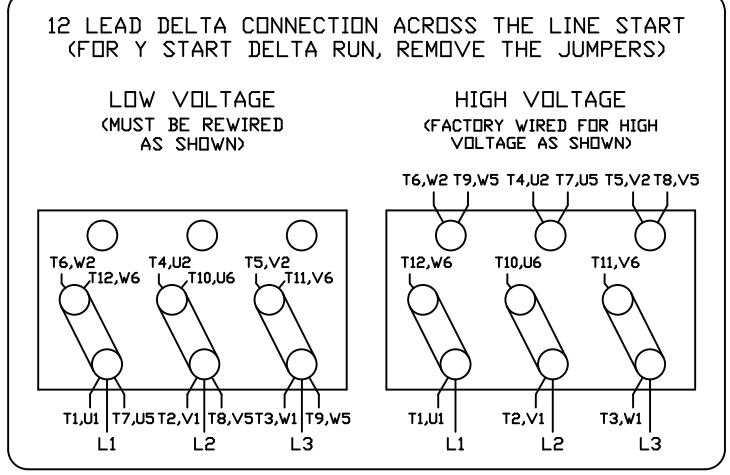
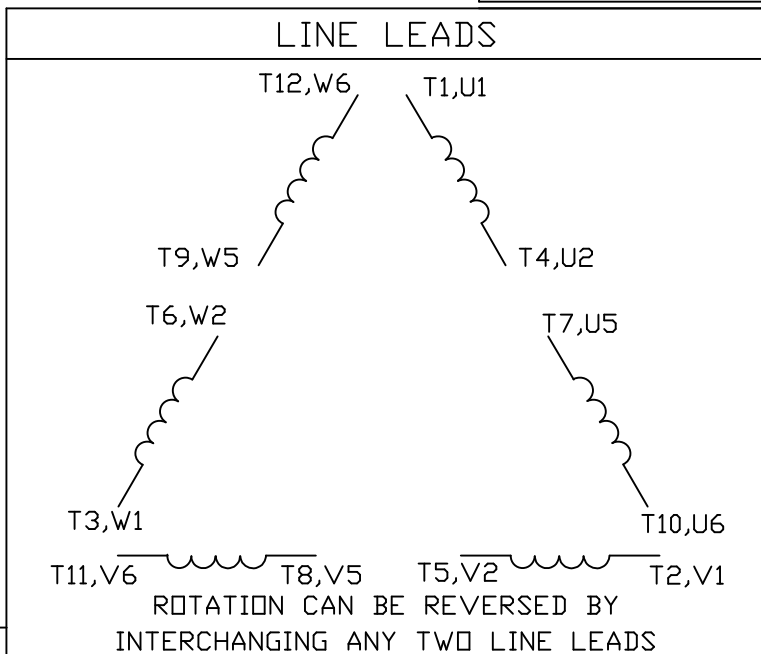

NO.	REVISION	BY & DATE	CHK	TOLERANCES UNLESS SPECIFIED	
				DEC.	INCHES
				.X	±.1
				.XX	±.01
				.XXX	±.005
				.XXXX	±.0005
				ANG	±1/2*

MARATHON ELECTRIC

TITLE DELTA - WYE CONNECTION DIAGRAM
IEC CAST IRON MOTORS

MAT'L. _____
FINISH _____

CAD FILE 00417203ME
SIZE A

DRAWN CJW 08/28/02
CHK
APPD
SCALE 1=1
REF
FMF
PREV
DRAWING NO. 004172-03ME
REV.

CERTIFICATION DATA SHEET

Model#: 200LTFC6538 AA **WINDING#:** T16104005 NONE 3
CONN. DIAGRAM: 004172.03ME **ASSEMBLY:** F3
OUTLINE: B-SS622240

TYPICAL MOTOR PERFORMANCE DATA

HP	KW	SYNC. RPM	F.L. RPM	FRAME	ENCLOSURE	KVA CODE	DESIGN
40&40	30.0&30.0	1800	1780&1475	200L	TEFC	G	B

PH	Hz	VOLTS	FL AMPS	START TYPE	DUTY	INSL	S.F	AMB°C	ELEVATION
3	60/50	230/460#200/ 400	92/46&106/53	PWS & YDRUN OR INV	CONTINUOU S	F2	1.15/1.15	40	3300

FULL LOAD EFF: 94.1&92.4	3/4 LOAD EFF: 94.5	1/2 LOAD EFF: 94.5	GTD. EFF	ELEC. TYPE	NO LOAD AMPS
FULL LOAD PF: 86&87.5	3/4 LOAD PF: 82	1/2 LOAD PF: 74.5	93	SQ CAGE INV RATED	35 / 17.5

F.L. TORQUE	LOCKED ROTOR AMPS	L.R. TORQUE	B.D. TORQUE	F.L. RISE°C
119 LB-FT	580 / 290	225 LB-FT 189	350 LB-FT 294	65

SOUND PRESSURE @ 3 FT.	SOUND POWER	ROTOR WK^2	MAX. WK^2	SAFE STALL TIME	STARTS /HOUR	APPROX. MOTOR WGT
57 dBA	67 dBA	6.32 LB-FT^2	- LB-FT^2	20 SEC.	2	538 LBS.

***** SUPPLEMENTAL INFORMATION *****

DE BRACKET TYPE	ODE BRACKET TYPE	MOUNT TYPE	ORIENTATION	SEVERE DUTY	HAZARDOUS LOCATION	DRIP COVER	SCREENS	PAINT
STANDARD	STANDARD	RIGID	HORIZONTAL	PREMIUM SEVERE DUTY	NONE	FALSE	NONE	BLUE (ENAMEL)

BEARINGS		GREASE	SHAFT TYPE	SPECIAL DE	SPECIAL ODE	SHAFT MATERIAL	FRAME MATERIAL
DE	OPE						
BALL	BALL	POLYREX EM	STANDARD IEC	NONE	NONE	1045 HOT ROLLED (C-204)	CAST IRON
6312	6212						

THERMO-PROTECTORS				THERMISTORS	CONTROL	SPACE /n HEATERS
THERMOSTATS	PROTECTORS	WDG RTDs	BRG RTDs			
NONE	NOT	NONE	NONE	NONE	FALSE	NONE VOLTS

If Inverter equals NONE, contact factory for further information

*
N
O
T
E
S
*

INVERTER TORQUE: CONSTANT 2:1 INV. HP SPEED RANGE: 1.5 X BASE SPEED
ENCODER: NONE NONE NONE NONE NONE PPR
BRAKE: NONE NONE NONE P/N NONE NONE NONE - FT-LB NONE V NONE Hz

DATE: 06/22/2017 03:44:45 AM
 FORM 3531 REV.3 02/07/99

** Subject to change without notice.

Data Sheet

Date: 29-06-2017
 Customer: _____
 Attention: _____
 Submitted by: FAREEDA DUDEKULA



200LTC6538

Submittal

Data @ 460 V

Motor Load Data

Load	0%	25%	50%	75%	100%	115%	125%	LR
Current (Amps)	17.5	20.0	27.0	36.5	46.0	56.5	60.0	290
Torque (ft-lb)	0.00	30.5	60.5	90.5	119	137	150	225
RPM	1800	1795	1790	1785	1780	1,775	1772	0
Efficiency (%)		92.4	94.5	94.5	94.1	93.6	93.6	
P.F. (%)	4.5	52.0	74.5	82.0	86.0	86.5	87.0	0.0

Motor Speed Data

	LR	Pull-Up	BD	Rated	Idle
Speed (RPM)	0	900	1625	1780	1800
Current (Amps)	290	260	190	46.0	17.5
Torque (ft-lb)	225	200	350	119	0.00

Information Block				
HP	40.0			
Sync. RPM	1800			
Frame	324			
Enclosure	TEFC			
Construction	TFC			
Voltage	230/460#200/40(V)			
Frequency	60 Hz			
Design	A			
LR Code letter	G			
Service Factor	1.15			
Temp Rise @ FL	46 ° C			
Duty	CONT			
Ambient	40 ° C			
Elevation	1,000 feet			
Rotor/Shaft wk ²	6.3 Lb-Ft ²			
Ref Wdg	T16104005 NONE			
Sound Pressure @ 1M	57 dBA			
VFD Rating	CONSTANT 2:1			
Outline Dwg	B-SS622240			
Conn. Diag	004172.03ME			
Additional Specifications:				
0				
365THFS8036				
EQUIV CKT (OHMS / PHASE)				
R1	R2	X1	X2	Xm
0.0000	0.0000	0.0000	0.0000	0.0000

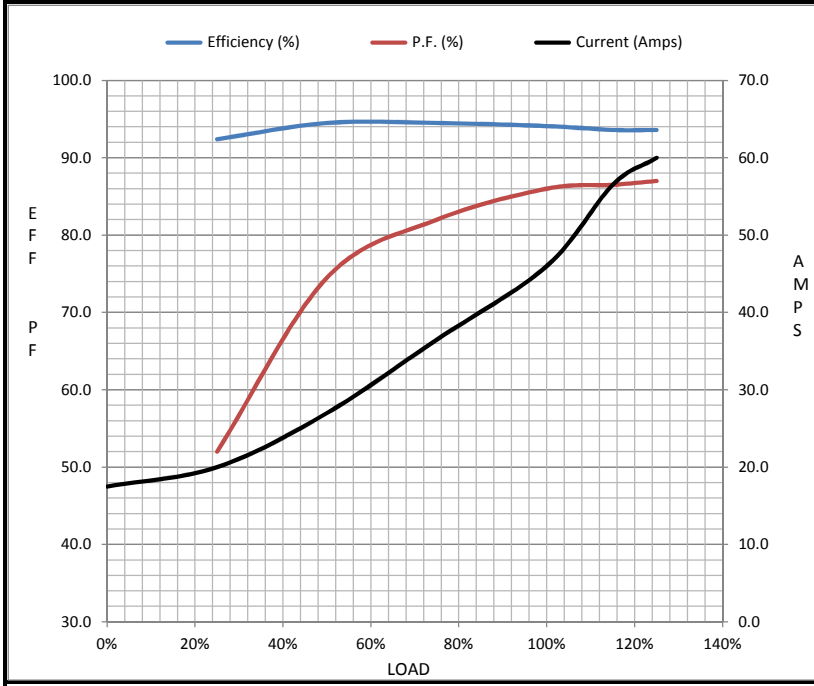

Speed - Torque Curve

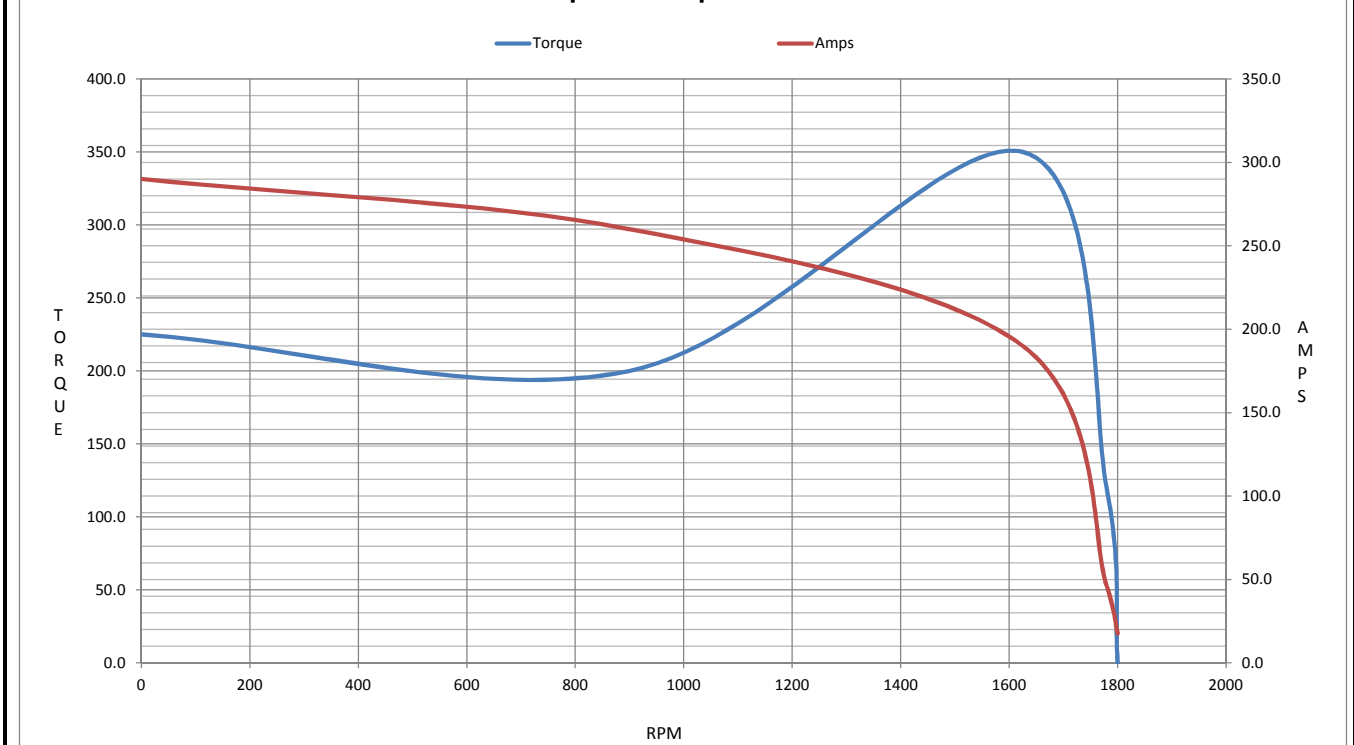

EC Declaration of Conformity

The undersigned representing
the manufacturer:

Regal Beloit America
100 East Randolph St.
Wausau, WI 54401

and the authorized representative
established within the Community:

Marathon Electric UK
6F Thistleton Road Ind. Estate
Market Overton
Oakham, Rutland LE15 7PP UK

are committed to providing customers with products that comply with applicable regulations and international protocols to which they are subject, including the requirements of the European Parliament Directive on the Harmonization of the laws relating to electrical equipment designed for use within certain voltage limits (2014/35/EU).

Regal Beloit America declares that the following product(s), to which this declaration relates, are in conformity with the relevant sections of the EC standards listed below.

This statement supersedes any statements previously issued pertaining to the product(s) listed below and is subject to change without notice.

Model No : 200LTFC6538

(Model No. may contain prefix and/or suffix characters)

Catalog No : R346A

Rework No : N/A

Directives :

Low Voltage Directive 2014/35/EU

Harmonized Standards Used :

EN 60034-1: 2010 (IEC 60034-1: 2010)

EN 60034-5: 2001/A1:2007 (IEC 60034-5: 2000/A1:2006)

Authorized Representative:



Michael A. Logsdon
Vice President, Technology

Authorized Representative in the Community:



Julian Clark
Marketing Engineer

Created on 09/01/2022

CE 22