

PRODUCT INFORMATION PACKET

marathon®
Motors

Model No: 200LTFC6511

Catalog No: R345A

Globetrotter® IEC Cast Iron Motor, 40 & 30 HP, 3 Ph, 60 & 50 Hz, 230/460 & 200/400 V,
3600 & 3000 RPM, 200L Frame, TEFC



Regal and Marathon are trademarks of Regal Rexnord Corporation or one of its affiliated companies.

©2023 Regal Rexnord Corporation, All Rights Reserved. MC017097E

RegalRexnord



Nameplate Specifications

Phase	3	Output HP	40 & 30 Hp
Output KW	30.0 & 22.4 kW	Voltage	230/460 & 200/400 V
Speed	3560 & 2970 rpm	Service Factor	1.15 & 1.15
Frame	200L	Enclosure	Totally Enclosed Fan Cooled
Thermal Protection	No Protection	Efficiency	93 & 93 %
Ambient Temperature	40 °C	Frequency	60 & 50 Hz
Current	91/45.5 & 80/40 A	Power Factor	88
Duty	Continuous	Insulation Class	F
Design Code	B	KVA Code	G
Drive End Bearing Size	6212	Opp Drive End Bearing Size	6212
UL	No	CSA	Y
CE	Y	IP Code	55
Number of Speeds	1		

Technical Specifications

Electrical Type	Squirrel Cage Inverter Rated	Starting Method	Part Wdg Start & Wye Start Delta Run Or Inverter
Poles	2	Rotation	Reversible
Resistance Main	.148 Ohms	Mounting	Rigid Base
Motor Orientation	Horizontal	Drive End Bearing	Ball
Opp Drive End Bearing	Ball	Frame Material	Cast Iron
Shaft Type	IEC	Overall Length	29.52 in
Shaft Diameter	2.166 in	Shaft Extension	4.33 in
Assembly/Box Mounting	F3		
Connection Drawing	004172.01ME	Outline Drawing	SS622240

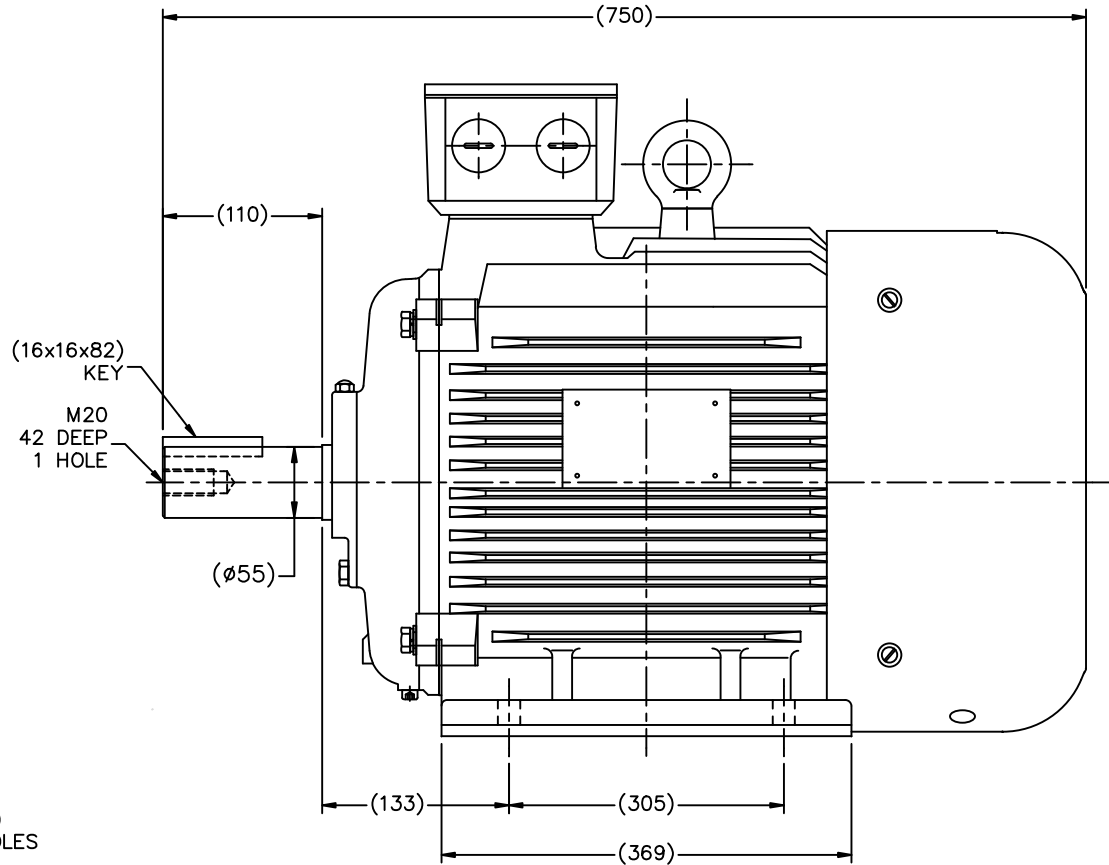
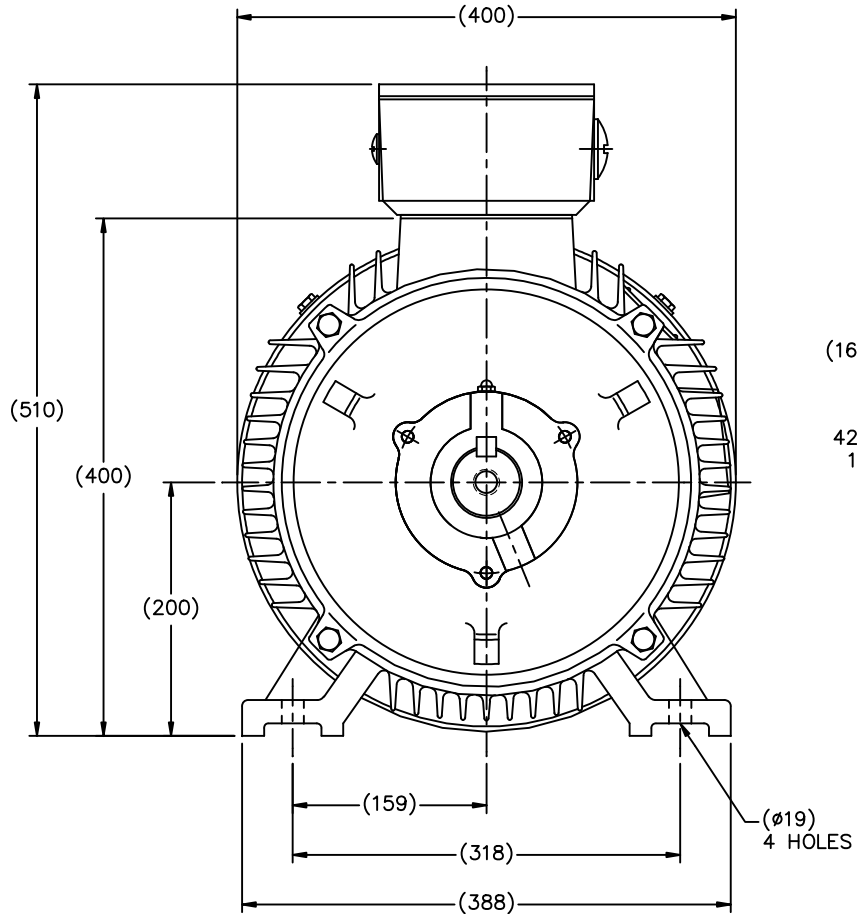

(MAY NOT BE DRAWN TO SCALE)

(DIMENSIONS ARE IN MILLIMETERS)

DF200L	193327.60
	193330.60
	193328.60
	193323.60
	193326.60
FRAME	PART #

				TOLERANCES UNLESS SPECIFIED				DRAWN MSG 11-17-2010	
				DEC.	METRIC			CHK MJS 11-18-2010	
				.X	±2.5	APPD SB 11-18-2010		SCALE 1=4	
				.XX	±.76	TITLE OUTLINE - IEC PREMIUM		REF	
				.XXX	±.127	DF200L-2, 4, 6		FMF HEBEI	
				.XXXX	±.0127	MAT'L		PREV	
NO.	REVISION	BY & DATE	CHK	ANG	±7'30"	FINISH			
THIS DRAWING IN DESIGN AND DETAIL IS OUR PROPERTY AND MUST NOT BE USED EXCEPT IN CONNECTION WITH OUR WORK ALL RIGHTS OF DESIGN AND INVENTION ARE RESERVED THIS IS AN ELECTRONICALLY GENERATED DOCUMENT - DO NOT SCALE THIS PRINT				RFP	11-18-2010	CAD FILE	SS622240	SIZE B	DRAWING NO. PAGE OF REV. SS622240
				DIST					

WYE - DELTA STARTING USEABLE ON 2,4 AND 6 POLE MOTORS.

LOW VOLTAGE CONNECTION

HIGH VOLTAGE CONNECTION

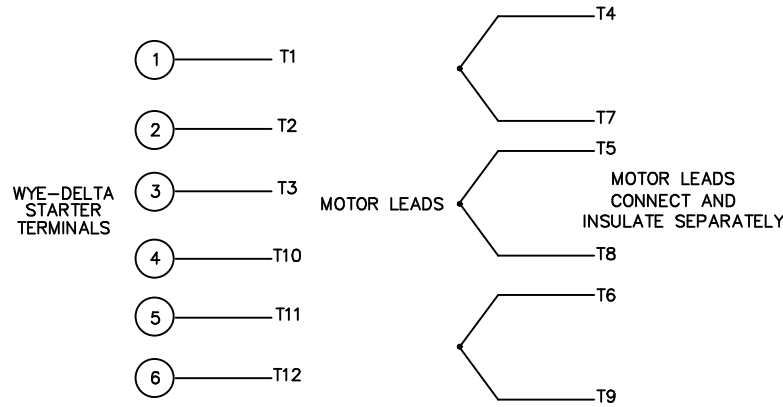
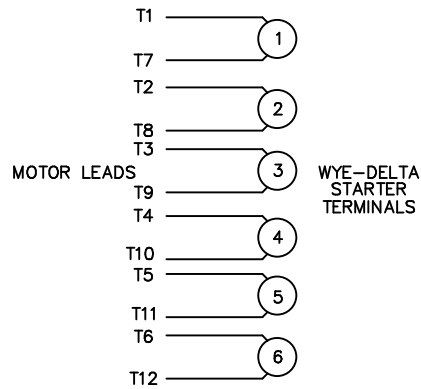

REFER TO THE WYE-DELTA STARTER CONNECTION INSTRUCTIONS FOR PROPER CONNECTION OF POWER LINES TO STARTER.

PART WINDING START USABLE ON 4 & 6 POLE MOTORS
LOW VOLTAGE CONNECTION ONLY

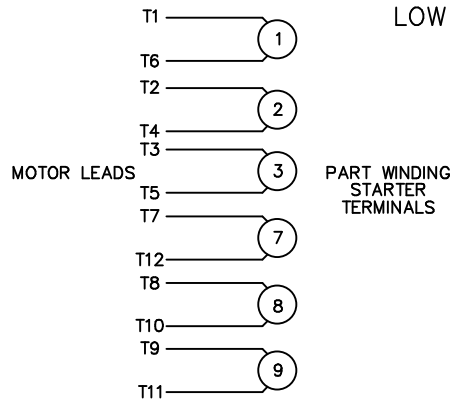

REFER TO THE PART WINDING STARTER INSTRUCTIONS FOR PROPER CONNECTION OF POWER LINES TO STARTER.

REFER TO THE CUTLER - HAMMER OR EQUIV. FOR PROPER SELECTION OF OVERLOAD HEATER COILS.

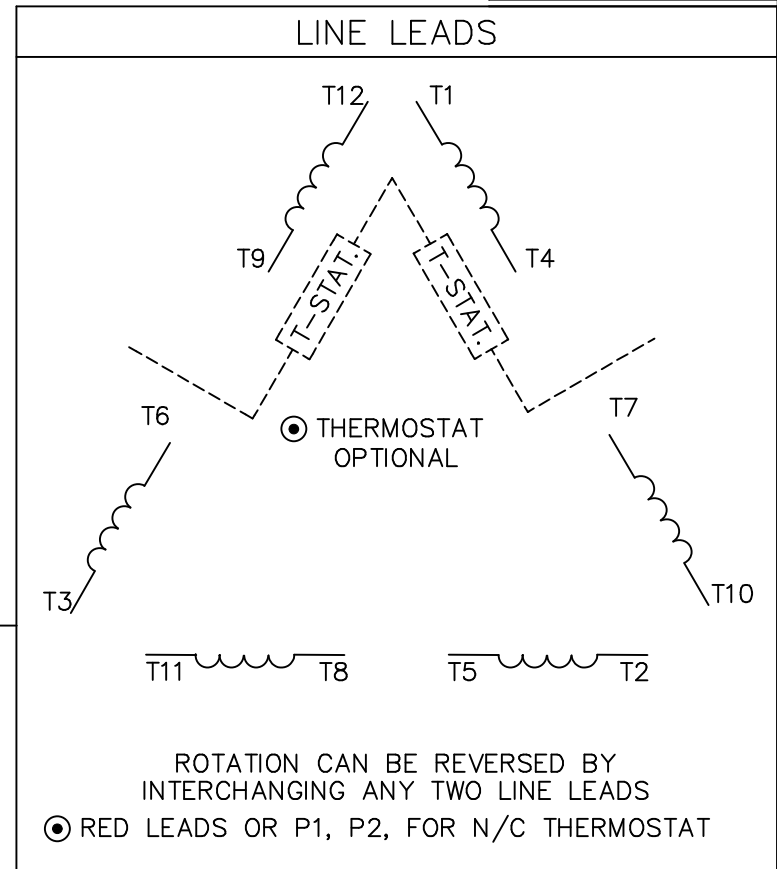

ACROSS THE LINE START & RUN				
	LINE 1	LINE 2	LINE 3	JOIN & INSULATE SEPARATELY
HIGH VOLT	T1, T12	T2, T10	T3, T11	(T4, T7) (T5, T8) (T6, T9)
LOW VOLT	T1, T6 T7, T12	T2, T4 T8, T10	T3, T5 T9, T11	

NO.	REVISION	BY & DATE	CHK	TOLERANCES UNLESS SPECIFIED	
				DEC.	INCHES
				.X	±.1
03	REV'D LOW VOLTAGE CONN. LEADS PER ELEC.	BJB 06/07/00		.XX	±.01
02	ADDED T-STAT. NOTES PER ELECTRICAL	KMM 06/02/98		.XXX	±.005
01	REDRAWN TO CAD	DBT 06/02/97		.XXXX	±.0005
				ANG	±1/2°

MARATHON ELECTRIC

DRAWN WLW 09/08/77
 CHK RPB 09/12/77
 APPD JCW 09/12/77
 TITLE DELTA - WYE CONNECTION DIAGRAM
 SCALE 1=1
 REF
 FMF
 PREV

RFP CAD FILE 00417201ME SIZE A DRAWING NO. 004172-01ME REV. 03
 DIST

CERTIFICATION DATA SHEET

Model#: 200LTFC6511 AA **WINDING#:** T16102019 NONE 1
CONN. DIAGRAM: 004172.01 **ASSEMBLY:** F3
OUTLINE: SS622240

TYPICAL MOTOR PERFORMANCE DATA

HP	KW	SYNC. RPM	F.L. RPM	FRAME	ENCLOSURE	KVA CODE	DESIGN
40&30	30&22.4	3600	3560&2970	200L	TEFC	G	B

PH	Hz	VOLTS	FL AMPS	START TYPE	DUTY	INSL	S.F	AMB°C	ELEVATION
3	60/50	230/460#200/ 400	91/45.5&80/40	PWS & YDRUN OR INV	CONTINUOU S	F5	1.15/1.15	40	3300

FULL LOAD EFF: 93&93	3/4 LOAD EFF: 93	1/2 LOAD EFF: 91.7	GTD. EFF	ELEC. TYPE	NO LOAD AMPS
FULL LOAD PF: 88&86.5	3/4 LOAD PF: 86	1/2 LOAD PF: 80	92.4	SQ CAGE INV RATED	24 / 12

F.L. TORQUE	LOCKED ROTOR AMPS	L.R. TORQUE	B.D. TORQUE	F.L. RISE°C
59.2 LB-FT	620 / 310	120 LB-FT 202	165 LB-FT 278	55

SOUND PRESSURE @ 3 FT.	SOUND POWER	ROTOR WK^2	MAX. WK^2	SAFE STALL TIME	STARTS /HOUR	APPROX. MOTOR WGT
72 dBA	82 dBA	3.24 LB-FT^2	- LB-FT^2	25 SEC.	2	- LBS.

***** SUPPLEMENTAL INFORMATION *****

DE BRACKET TYPE	ODE BRACKET TYPE	MOUNT TYPE	ORIENTATION	SEVERE DUTY	HAZARDOUS LOCATION	DRIP COVER	SCREENS	PAINT
STANDARD	STANDARD	RIGID	HORIZONTAL	FALSE	NONE	FALSE	NONE	BLUE (ENAMEL)

BEARINGS		GREASE	SHAFT TYPE	SPECIAL DE	SPECIAL ODE	SHAFT MATERIAL	FRAME MATERIAL
DE	OPE						
BALL	BALL	POLYREX EM	STANDARD IEC	NONE	NONE	1045 HOT ROLLED (C-204)	CAST IRON
6212	6212						

THERMO-PROTECTORS				THERMISTORS	CONTROL	SPACE /n HEATERS
THERMOSTATS	PROTECTORS	WDG RTDs	BRG RTDs			
NONE	NOT	NONE	NONE	NONE	FALSE	NONE VOLTS

If Inverter equals NONE, contact factory for further information

*
N
O
T
E
S
*

INVERTER TORQUE: CONSTANT 20:1 INV. HP SPEED RANGE: 1.5 X BASE SPEED
ENCODER: NONE NONE NONE NONE NONE PPR
BRAKE: NONE NONE NONE P/N NONE NONE NONE NONE FT-LB NONE V NONE Hz

DATE: 06/22/2017 03:37:16 AM
FORM 3531 REV.3 02/07/99

** Subject to change without notice.

Data Sheet

Date: 1/4/2019
Customer: _____
Attention: _____
Submitted by: FAREEDA DUDEKULA



200LTC6511

Submittal
 Data @ 460 V

Motor Load Data

Load	0%	25%	50%	75%	100%	115%	125%	LR
Current (Amps)	12.0	16.5	25.0	34.5	45.5	52.0	56.8	310
Torque (ft-lb)	0.00	14.8	29.6	44.4	59.2	68.0	74.0	120
RPM	3600	3592	3582	3572	3560	3555	3550	0
Efficiency (%)		88.5	91.7	93.0	93.0	93.0	92.4	
P.F. (%)	8.5	64.0	80.0	86.0	88.0	88.5	88.5	35.0

Motor Speed Data

	LR	Pull-Up	BD	Rated	Idle
Speed (RPM)	0	1800	3425	3560	3600
Current (Amps)	310	285	178	45.5	12.0
Torque (ft-lb)	120	100	165	59.2	0.00

Information Block				
HP	40.0			
Sync. RPM	3600			
Frame	200			
Enclosure	TEFC			
Construction	TFC			
Voltage	230/460#200/400 V			
Frequency	60 Hz			
Design	B			
LR Code letter	G			
Service Factor	1.15			
Temp Rise @ FL	55 °C			
Duty	CONT			
Ambient	40 °C			
Elevation	3,300 feet			
Rotor/Shaft wk ²	3.2 Lb-Ft ²			
Ref Wdg	T16102019 NONE			
Sound Pressure @ 1M	72 dBA			
VFD Rating	CONSTANT 20:1			
Outline Dwg	SS622240			
Conn. Diag	004172.01			
Additional Specifications:				
0				
0				
EQUIV CKT (OHMS / PHASE)				
R1	R2	X1	X2	Xm
0.1060	0.0570	0.4540	0.5600	22.0500

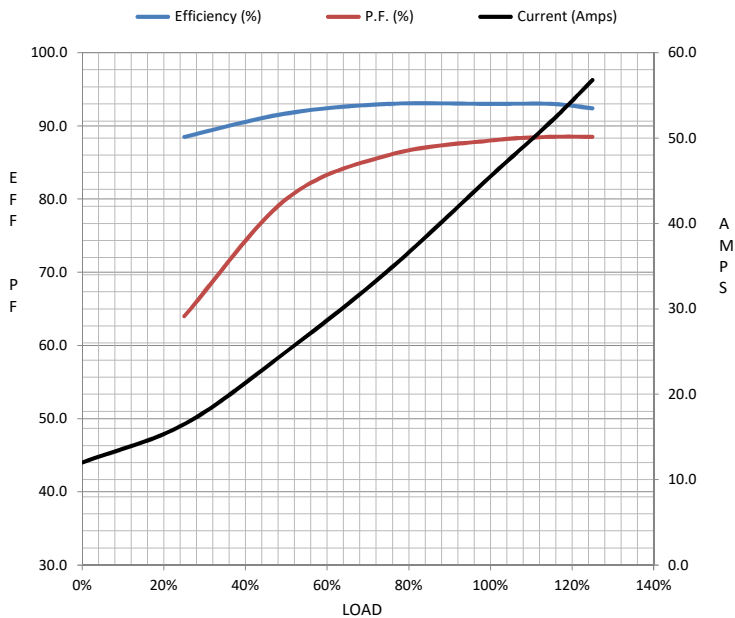

Speed - Torque Curve

