

# PRODUCT INFORMATION PACKET



Model No: 193382.60  
Catalog No: 193382.60  
5.50 HP General Purpose, 3 phase, 3600 RPM, 575 V, 112M Frame, TEFC  
Cast Iron Motors



Regal and Leeson are trademarks of Regal Rexnord Corporation or one of its affiliated companies.  
©2021 Regal Rexnord Corporation, All Rights Reserved. MC017097E





### Nameplate Specifications

Output HP	5.50 Hp	Output KW	4.1 kW
Frequency	60 Hz	Voltage	575 V
Current	5.1 A	Speed	3510 rpm
Service Factor	1.15	Phase	3
Efficiency	89.5 %	Power Factor	91
Duty	Continuous	Insulation Class	F
Design Code	B	KVA Code	J
Frame	112M	Enclosure	Totally Enclosed Fan Cooled
Thermal Protection	No	Ambient Temperature	40 °C
Drive End Bearing Size	6206	Opp Drive End Bearing Size	6205
UL	Recognized	CSA	Y
CE	Y	IP Code	55
Number of Speeds	1		

### Technical Specifications

Electrical Type	Squirrel Cage Inverter Rated	Starting Method	Line Or Inverter
Poles	2	Rotation	Reversible
Mounting	Rigid Base	Motor Orientation	Horizontal
Drive End Bearing	Ball	Opp Drive End Bearing	Ball
Frame Material	Cast Iron	Shaft Type	IEC
Overall Length	16.14 in	Shaft Diameter	1.125 in
Shaft Extension	2.36 in	Assembly/Box Mounting	F3
Outline Drawing	SS622256	Connection Drawing	005102

This is an uncontrolled document once printed or downloaded and is subject to change without notice. Date Created:10/12/2021

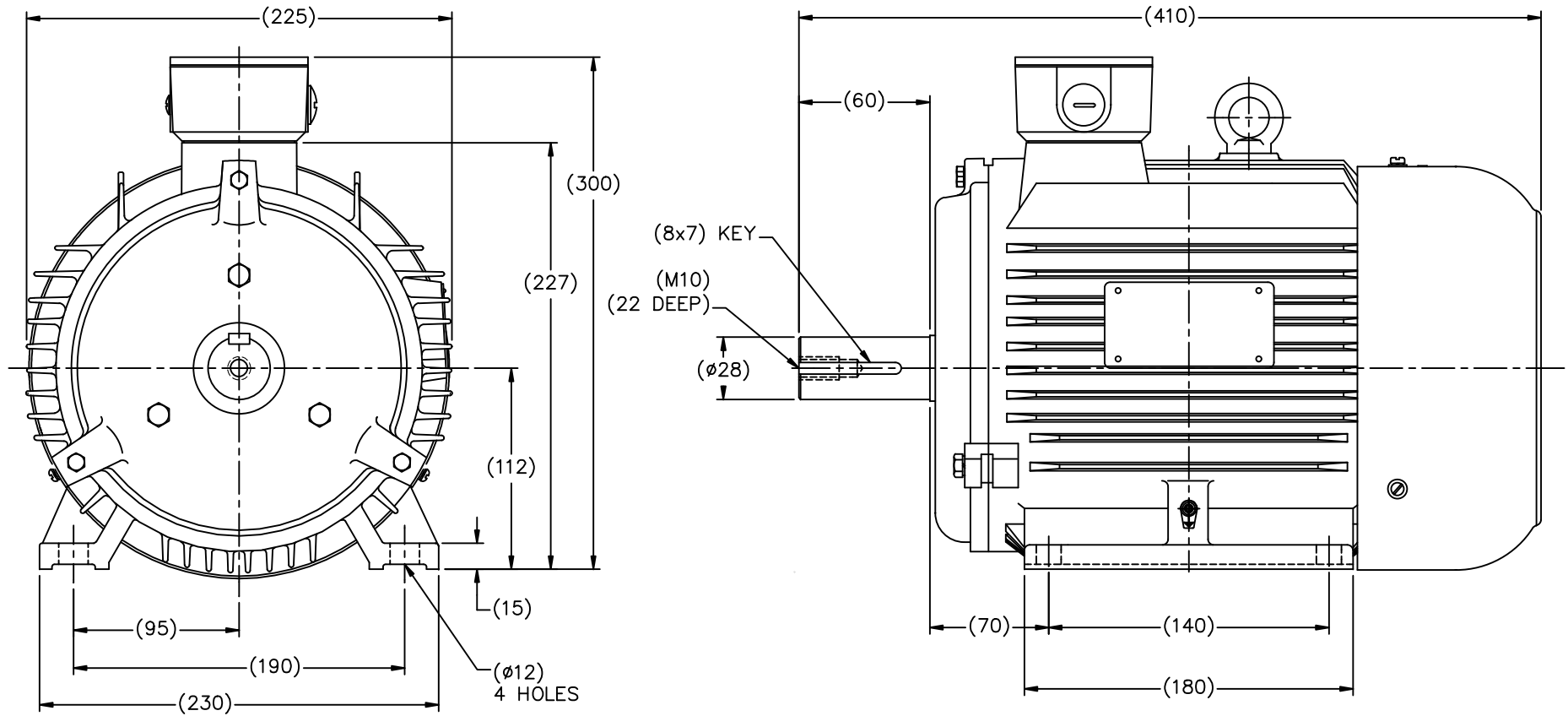

(MAY NOT BE DRAWN TO SCALE)

(DIMENSIONS ARE IN MILLIMETERS)

Cat.No		FRAME
193306.60	193307.60	DF112M

TOLERANCES UNLESS SPECIFIED		DEC. METRIC		REGAL-BELOIT CORPORATION		DRAWN HLB 12-06-2010	
.X	±2.5	.XX	±.76	TITLE OUTLINE DF112M-2,4		CHK	DJK 12-17-2010
.XXX	±.127	.XXXX	±.0127			APPD	SB 12-13-2010
.XXXX	±.0127	.XXXX	±.0127			SCALE	1=18
NO.		REVISION		BY & DATE		REF	12-22-2010
NO.		REVISION		BY & DATE		CAD FILE	SS622256
NO.		REVISION		BY & DATE		SIZE	B
NO.		REVISION		BY & DATE		DRAWING NO.	SS622256
NO.		REVISION		BY & DATE		PAGE	OF
NO.		REVISION		BY & DATE		REV.	



CERTIFICATION DATA SHEET

1051 CHEYENNE AVE.  
GRAFTON, WI 53024  
PH. 262-377-8810

CATALOG #: 193382.60

CONN. DIAGRAM: 005102

OUTLINE: SS622256

MOUNTING: F3

WINDING #: T08702015 4

TYPICAL MOTOR PERFORMANCE DATA

HP	kW	SYNC. RPM	F.L. RPM	FRAME	ENCLOSURE	KVA CODE	DESIGN
5 1/2	4.10	3600	3510	112M	TEFC	J	B

PH	Hz	VOLTS	AMPS	START TYPE	DUTY	INSL	S.F.	AMB°C
3	60	575	5.1	LINE OR INVERTER	CONTINUOUS	F5	1.15	40

FULL LOAD EFF:	89.5	3/4 LOAD EFF:	90.2	1/2 LOAD EFF:	90.2	GTD. EFF	ELEC. TYPE
FULL LOAD PF:	91	3/4 LOAD PF:	88.5	1/2 LOAD PF:	81.5	87.5	SQ CAGE INV RATED

F.L. TORQUE	LOCKED ROTOR AMPS	L.R. TORQUE	B.D. TORQUE	F.L. RISE°C
8.2 LB-FT	40.4	17.7 LB-FT 215 %	26.4 LB-FT 322 %	64

SOUND PRESSURE @ 3 FT.	SOUND POWER	ROTOR WK^2	MAX. WK^2	SAFE STALL TIME	STARTS / HOUR	APPROX. MOTOR WGT
44.5 dBA	54.5 dBA	0.12 LB-FT^2	- LB-FT^2	15 SEC.	2	110 LBS.

\*\*\* SUPPLEMENTAL INFORMATION \*\*\*

DE BRACKET TYPE	ODE BRACKET TYPE	MOUNT TYPE	ORIENTATION	SEVERE DUTY	HAZARDOUS LOCATION	DRIP COVER	SCREENS	PAINT
STANDARD	STANDARD	RIGID	HORIZONTAL	FALSE	NONE	FALSE	NONE	BLUE (ENAMEL)

BEARINGS		GREASE	SHAFT TYPE	SPECIAL DE	SPECIAL ODE	SHAFT MATERIAL	FRAME MATERIAL
DE	ODE						
BALL	BALL						
6206	6205	POLYREX EM	STANDARD IEC	NONE	NONE	AISI 1045 (C-240)	CAST IRON

THERMO-PROTECTORS				THERMISTORS	CONTROL	SPACE HEATERS
THERMOSTATS	PROTECTORS	WDG RTDs	BRG RTDs			
NONE	NOT	NONE	NONE	NONE	FALSE	NONE VOLTS

\*  
N  
O  
T  
E  
S  
\*

INVERTER TORQUE: CONSTANT 10:1
INV. HP SPEED RANGE: NONE
ENCODER: NONE NONE NONE NONE NONE PPR
BRAKE: NONE NONE NONE P/N NONE NONE NONE NONE FT-LB NONE V NONE Hz

## Data Sheet

Date: 1/23/2018

193382.60



Data @ 575 V

## Motor Load Data

Load	0%	25%	50%	75%	100%	115%	125%	LR	
Current (Amps)	1.52	1.92	2.80	3.8	5.0	5.8	6.4	40.4	
Torque (ft-lb)	0.00	2.00	4.1	6.1	8.2	9.5	10.4	17.7	
RPM	3600	3580	3560	3535	3510	3,495	3485	0	
Efficiency (%)		87.5	90.2	90.2	89.5	88.5	87.5		
P.F. (%)	8.5	62.5	81.5	88.5	91.0	91.5	92.0	55.5	

## Motor Speed Data

	LR	Pull-Up	BD	Rated	Idle
Speed (RPM)	0	1800	2930	3510	3600
Current (Amps)	40.4	35.6	23.6	5.0	1.52
Torque (ft-lb)	17.7	19.9	26.4	8.2	0.00

## Information Block

HP	5.5			
Sync. RPM	3600			
Frame	112			
Enclosure	TEFC			
Construction	TFC			
Voltage	575 V			
Frequency	60 Hz			
Design	A			
LR Code letter	J			
Service Factor	1.15			
Temp Rise @ FL	64 °C			
Duty	CONT			
Ambient	40 °C			
Elevation	1,000 feet			
Rotor/Shaft wk²	0.12 Lb-Ft²			
Ref Wdg	T08702015 NONE			
Sound Pressure @ 1M	45 dBA			
VFD Rating	CONSTANT 10:1			
Outline Dwg	SS622256			
Conn. Diag	005102			
Additional Specifications:				
0				
0				
EQUIV CKT (OHMS / PHASE)				
R1	R2	X1	X2	Xm
0.0000	0.0000	0.0000	0.0000	0.0000

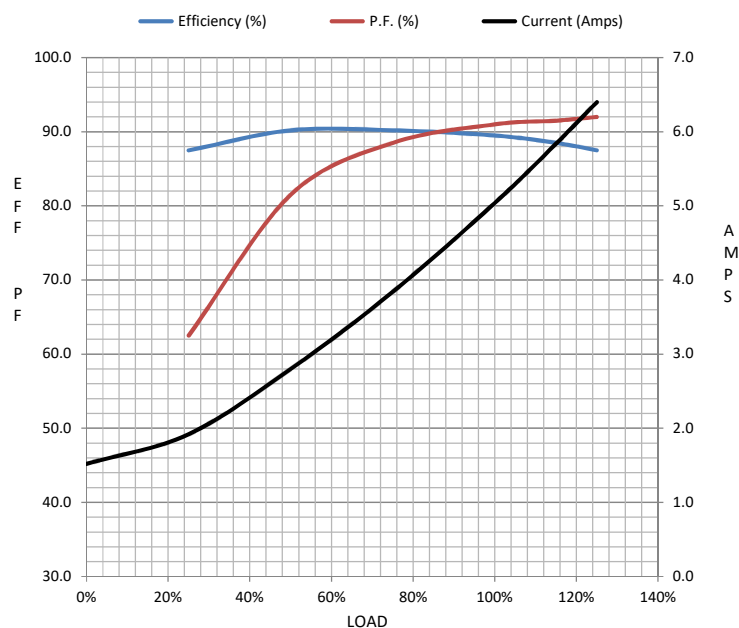

## Speed - Torque Curve

