

PRODUCT INFORMATION PACKET

Model No: 184UTTS8078

Catalog No: P317

Automotive Duty Motor, 1.50 HP, 3 Ph, 60 Hz, 460 V, 1200 RPM, 184U Frame, TENV

Regal and are trademarks of Regal Rexnord Corporation or one of its affiliated companies.
©2022 Regal Rexnord Corporation, All Rights Reserved. MC017097E



Nameplate Specifications

Output HP	1.50 Hp	Output KW	1.1 kW
Frequency	60 Hz	Voltage	460 V
Current	2.2 A	Speed	1175 rpm
Service Factor	1	Phase	3
Efficiency	86.5 %	Power Factor	71.5
Duty	Continuous	Insulation Class	F
Design Code	B	KVA Code	L
Frame	184U	Enclosure	Totally Enclosed Non Ventilated
Thermal Protection	No Protection	Ambient Temperature	65 °C
Drive End Bearing Size	6206	Opp Drive End Bearing Size	6205
UL	Recognized	CSA	Y
CE	Y	IP Code	43
Number of Speeds	1		

Technical Specifications

Electrical Type	Squirrel Cage Induction Run	Starting Method	Across The Line
Poles	6	Rotation	Reversible
Resistance Main	7.75 Ohms	Mounting	Rigid Base
Motor Orientation	Horizontal	Drive End Bearing	Ball
Opp Drive End Bearing	Ball	Frame Material	Cast Iron
Shaft Type	U	Overall Length	13.21 in
Frame Length	6.75 in	Shaft Diameter	0.880 in
Shaft Extension	2.28 in	Assembly/Box Mounting	F1/F2 Capable
Outline Drawing	A-SS68737-675	Connection Drawing	A-EE7300

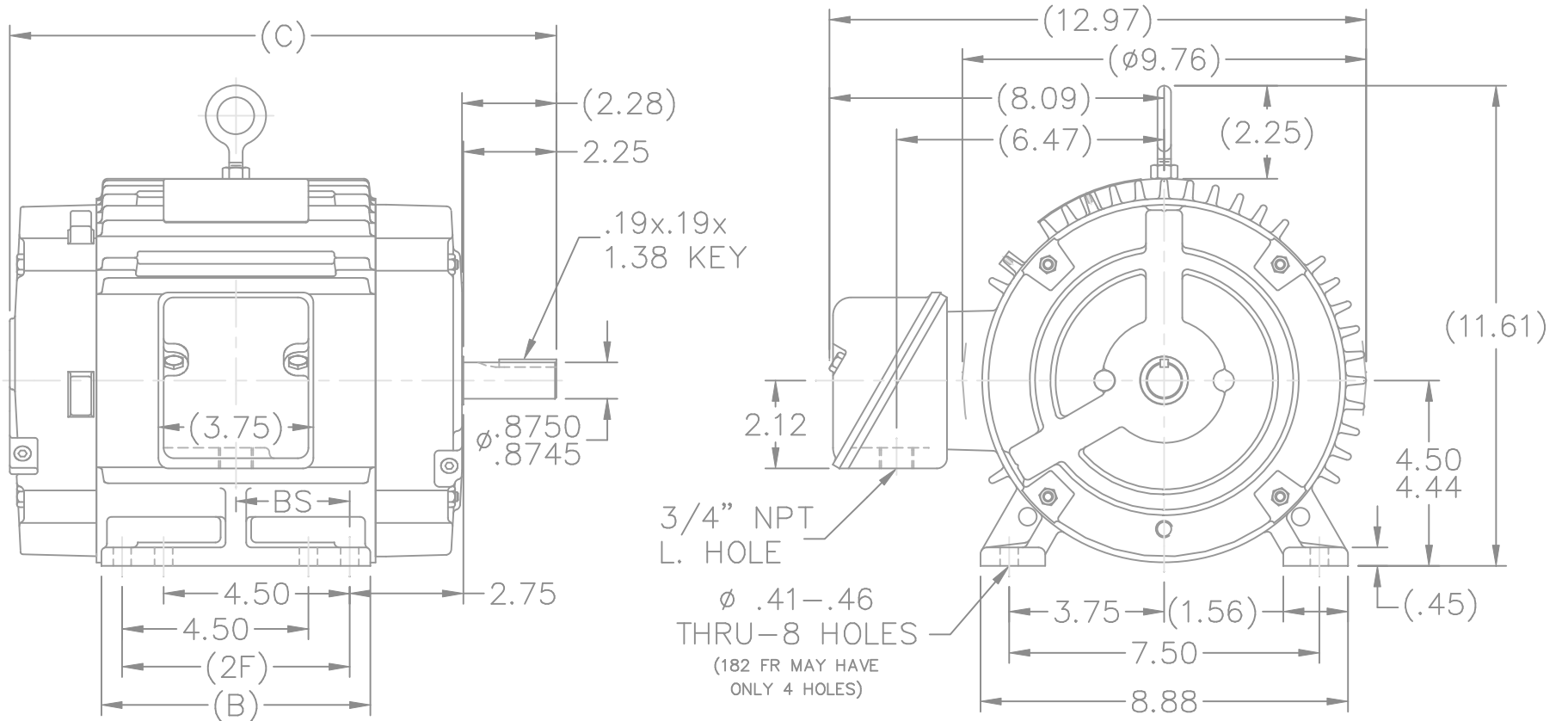

- NOTES:
1. CONDUIT BOX CAN BE ROTATED IN 90° STEPS.
 2. CONDUIT BOX CAN BE MOUNTED ON OPPOSITE SIDE BY REMOVING BRACKETS AND TURNING FRAME 180°.
 3. NAMEPLATE TO BE READ FROM CONDUIT BOX SIDE OF MOTOR

DASH	FRAME	B	C	2F	BS
575	182TZ	5.50	12.21	4.50	2.25
675	184TZ	6.50	13.21	5.50	2.75

			TOLERANCES UNLESS SPECIFIED			DRAWN MRB 10-22-1998					
			DEC.	INCHES		CHK ML 10-26-1998					
			.X	±.1		APPD GK 10-29-1998					
3	REDRAWN IN AUTOCAD	TAT 05-19-2005	ML	.XX	±.03	SCALE 1=4					
2	REVISED TO CAST IRON COND. BOX MU36616	KL 04-23-2001		.XXX	±.005	REF					
1	NEW DRAWING CN 26867	MRB 10-29-1998		.XXXX	±.0005	FMF					
NO.	REVISION	BY & DATE	CHK	ANG	±'	FINISH	PREV				
			RFP			CAD FILE ss68737	SIZE A	DRAWING NO. SS68737	PAGE	OF	REV. 3
			DIST	LB							

THREE PHASE - SINGLE VOLTAGE
MOTOR - CONDUIT BOX @ 'A'

TERMINAL BLOCK WHEN SPECIFIED

TO REVERSE ROTATION:
INTERCHANGE ANY TWO LINE
LEAD CONNECTIONS



IF MOTOR HAS
9 LEADS

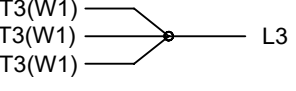
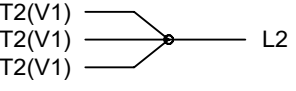
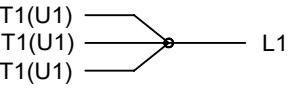

IF MOTOR HAS
6 LEADS

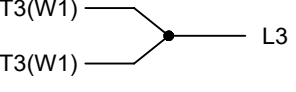
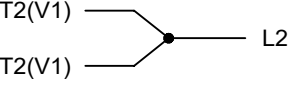
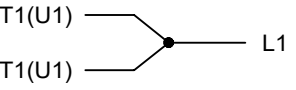

A-9806 DECAL

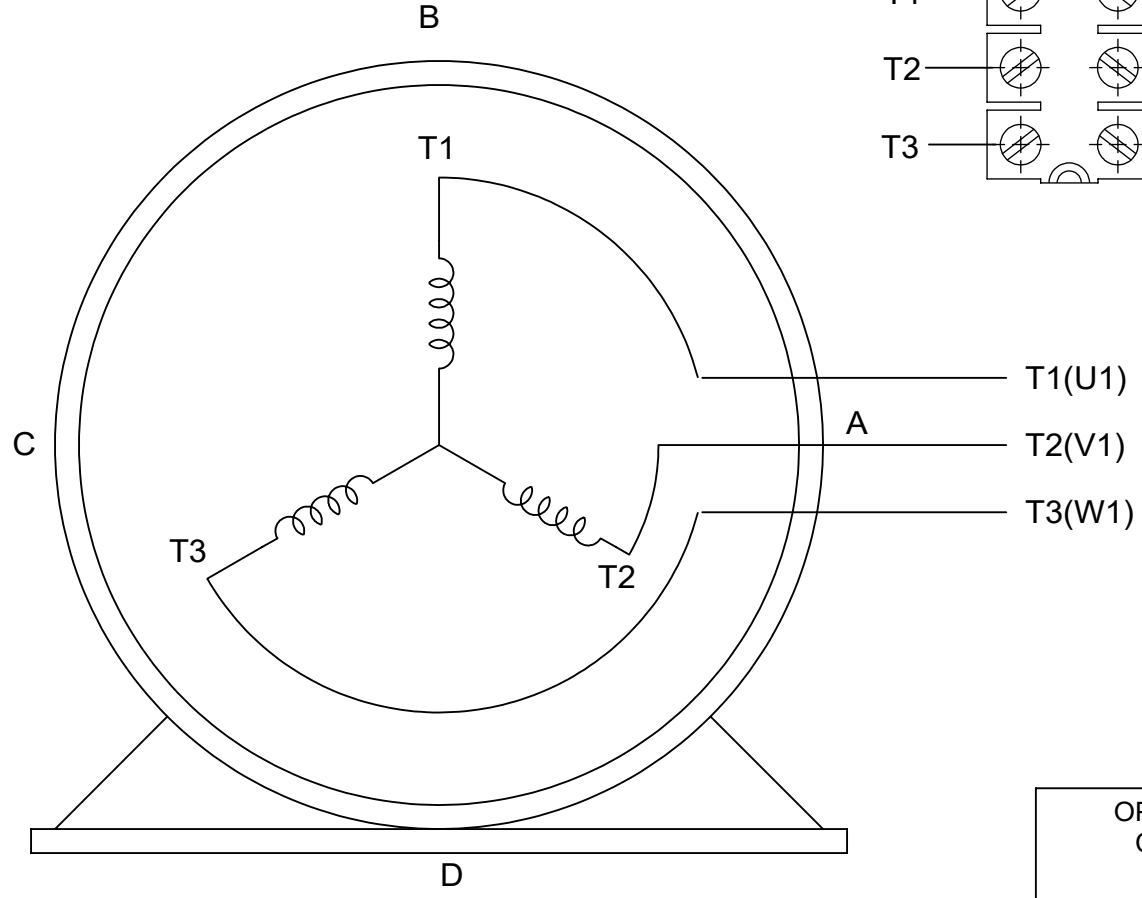

VIEW OF TERMINAL END

OPTIONAL CORD CONNECTION	
L1	WHITE
L2	RED
L3	BLACK

DRAWING REVISION AC	REVISION BY BS	REV DATE/© DATE 26/07/2022
REQUEST NUMBER CR-0010402	APPROVED BY SN	DATE 26/07/2022

PRIMARY DIMENSIONS ARE INCH
mm DIMENSIONS IN [BRACKETS]
ARE FOR REFERENCE ONLY

DRAWN BY DA	DATE 03-26-1993
APPROVED BY TB	DATE 03-26-1993
REFERENCE	
THIRD ANGLE PROJECTION	

		Regal Beloit America, Inc.	
DESCRIPTION CONNECTION DIAGRAM EXTERNAL - SINGLE VOLTAGE - 3Ø MOTOR			
MATERIAL		PROCESS/FINISH	
SIZE A	DRAWING NUMBER EE7300		SHEET 1 OF 1

COPYRIGHT (PER REVISION DATE) REGAL BELOIT AMERICA, INC. ALL RIGHTS RESERVED. PROPRIETARY AND CONFIDENTIAL INFORMATION - THIS DOCUMENT IS THE PROPERTY OF REGAL BELOIT AMERICA, INC. ("OWNER") AND CONTAINS OWNER'S PROPRIETARY INFORMATION. ANY PERSON, CORPORATION OR OTHER FIRM RECEIVING IT IS DEEMED, BY RECEIVING IT, TO AGREE THAT IT, AND/OR ANY PART OF IT, SHALL NOT BE DISCLOSED TO ANY PERSON, CORPORATION OR OTHER ENTITY, DUPLICATED, AND/OR USED, EXCEPT AS EXPRESSLY APPROVED IN WRITING IN ADVANCE BY OWNER. THIS DOCUMENT SHALL BE RETURNED TO OWNER UPON REQUEST. IT MAY BE SUBJECT TO CERTAIN RESTRICTIONS UNDER APPLICABLE EXPORT CONTROL LAWS AND REGULATIONS.