

PRODUCT INFORMATION PACKET



Model No: 184TTDR4002

Catalog No: E109

Close-Coupled Pump Motor, 7.50 & 5 HP, 3 Ph, 60 & 50 Hz, 230/460 & 190/380 V, 3600 & 3000 RPM,
184JM Frame, DP

Regal and Marathon are trademarks of Regal Rexnord Corporation or one of its affiliated companies.

©2023 Regal Rexnord Corporation, All Rights Reserved. MC017097E



Nameplate Specifications

| | | | |
|------------------------|-----------------------|----------------------------|---------------------|
| Phase | 3 | Output HP | 7.50 & 5 Hp |
| Output KW | 5.6 & 3.7 kW | Voltage | 230/460 & 190/380 V |
| Speed | 3460 & 2900 rpm | Service Factor | 1.15 & 1.15 |
| Frame | 184JM | Enclosure | Drip Proof |
| Thermal Protection | No Protection | Efficiency | 87.5 & 87.5 % |
| Ambient Temperature | 40 °C | Frequency | 60 & 50 Hz |
| Current | 17.6/8.8 & 14.4/7.2 A | Power Factor | 90.5 |
| Duty | Continuous | Insulation Class | B |
| Design Code | B | KVA Code | H |
| Drive End Bearing Size | 6307 | Opp Drive End Bearing Size | 6205 |
| UL | Recognized | CSA | Y |
| CE | Y | IP Code | 22 |
| Number of Speeds | 1 | | |

Technical Specifications

| | | | |
|-----------------------|-----------------------------|-----------------------|-----------------|
| Electrical Type | Squirrel Cage Induction Run | Starting Method | Across The Line |
| Poles | 2 | Rotation | Reversible |
| Resistance Main | 1.86 Ohms | Mounting | Rigid Base |
| Motor Orientation | Horizontal | Drive End Bearing | Ball |
| Opp Drive End Bearing | Ball | Frame Material | Rolled Steel |
| Shaft Type | JM | Overall Length | 17.09 in |
| Frame Length | 7.75 in | Shaft Diameter | 0.875 in |
| Shaft Extension | 4.28 in | Assembly/Box Mounting | F1 ONLY |
| Connection Drawing | A-EE7308 | Outline Drawing | A-SS67309-775 |

SS67309

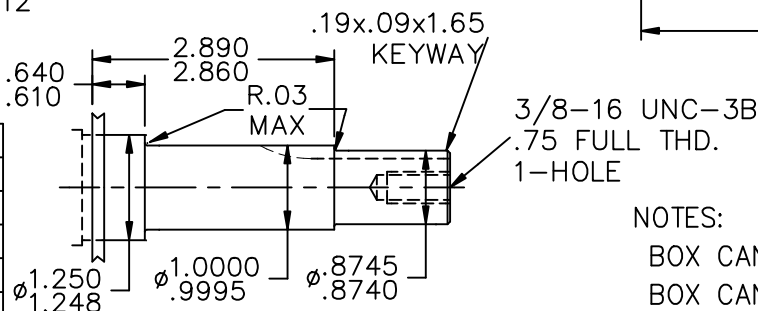
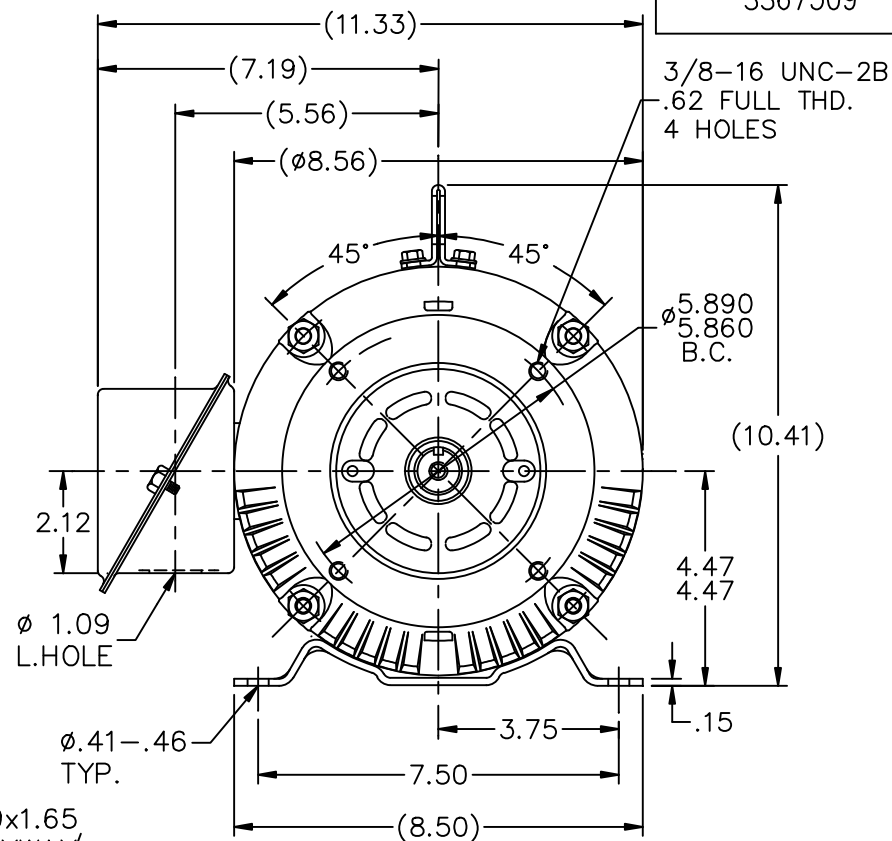
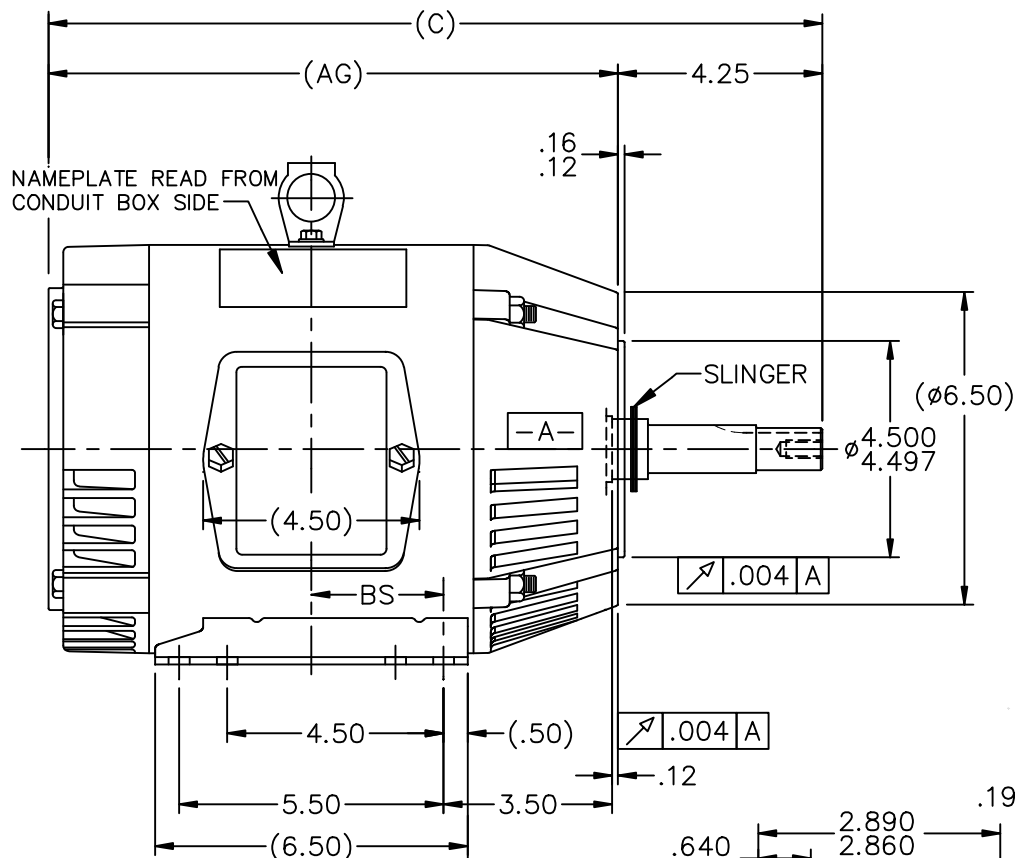

DETAIL OF SHAFT EXT.

NOTES:

BOX CAN BE ROTATED IN 90° STEPS.
BOX CAN BE MOUNTED ON OPPOSITE SIDE BY
REMOVING BRACKETS AND TURNING FRAME 180°

| DASH | FR | AG | C | BS | MOUNTING |
|------|--------|-------|-------|------|----------|
| 575 | 182T | 10.84 | 15.09 | 2.25 | F1 OR F2 |
| 625 | 182T | 11.34 | 15.59 | 2.50 | F1 ONLY |
| 675 | 182/4T | 11.84 | 16.09 | 2.75 | F1 OR F2 |
| 725 | 182/4T | 12.34 | 16.59 | 3.00 | F1 ONLY |
| 775 | 182/4T | 12.84 | 17.09 | 3.25 | F1 ONLY |
| 825 | 182/4T | 13.34 | 17.59 | 3.50 | F1 ONLY |
| 875 | 182/4T | 13.84 | 18.09 | 3.75 | F1 ONLY |

| | | | TOLERANCES UNLESS SPECIFIED | | | DRAWN DJK 04-26-1993 | | | |
|--|--|----------------|--------------------------------|--------|--------|--------------------------------------|-------------|------------|------|
| | | | DEC. | INCHES | | CHK | ML | 07-22-1993 | |
| 11 | REDRAWN IN AUTOCAD | TAT 07-06-2004 | ML | .X | ±.1 | | | | |
| 10 | ADDED LIFT LUG CN 34025 | NJS 07-20-2001 | | .XX | ±.03 | TITLE OUTLINE - JM EXT. | | | |
| 9 | ADDED FRAME SIZE TO -825 & -875 CN 27400-320 | CAE 11-03-1999 | | .XXX | ±.005 | 180 FR. - BB - TS - DR.PR. - C' FACE | | | |
| 8 | REVISED DASH TABLE CN 27451 | MRB 05-11-1999 | | .XXXX | ±.0005 | SCALE 1=4 | | | |
| NO. | REVISION | BY & DATE | CHK | ANG | ±7'30" | REF | | | |
| THIS DRAWING IN DESIGN AND DETAIL IS OUR PROPERTY AND MUST NOT BE USED EXCEPT IN CONNECTION WITH OUR WORK ALL RIGHTS OF DESIGN AND INVENTION ARE RESERVED THIS IS AN ELECTRONICALLY GENERATED DOCUMENT - DO NOT SCALE THIS PRINT | | | | | | FMF | | | |
| | | | | | | PREV | | | |
| | | | | | | RFP | | | |
| | | | | | | DIST LB | | | |
| | | | | | | CAD FILE ss67309 | | | |
| | | | | | | SIZE | DRAWING NO. | PAGE | OF |
| | | | | | | A | SS67309 | 1 | REV. |
| | | | | | | | | | 11 |



| NO. | REVISION | BY & DATE | CHK | ANG | TOLERANCES UNLESS SPECIFIED | FINISH | DRAWING NO. | PAGE | OF | REV. |
|--|--|----------------|-----|-------|--------------------------------|---------|-----------------|--------|--------------------|--------|
| | | | | | | | | | | |
| 5 | CHG TO REGAL LOGO | SL 09/10/2015 | AB | DEC. | INCHES | | | | | |
| 4 | REVISED IEC NOTATIONS | MSG 11/15/2011 | CMN | .X | ±.1 | | | | | |
| 3 | ADDED IEC NOTATIONS... (U1), (V1) ETC. MU95194 | MSG 5/10/2010 | MJS | .XX | ±.02 | | | | | |
| 2 | ADDED THE OPTIONAL CORD CONNECTION MU46318 | RDH 04/24/2003 | DRS | .XXX | ±.005 | | | | | |
| 1 | REDRAWN | RM 11/20/1990 | | .XXXX | ±.0005 | | | | | |
| | | | | | ±7'30" | | | | | |
| THIS DRAWING IN DESIGN AND DETAIL IS OUR PROPERTY AND MUST NOT BE USED EXCEPT IN CONNECTION WITH OUR WORK ALL RIGHTS OF DESIGN AND INVENTION ARE RESERVED THIS IS AN ELECTRONICALLY GENERATED DOCUMENT - DO NOT SCALE THIS PRINT | | | | | | RFP | CAD FILE ee7308 | SIZE A | DRAWING NO. EE7308 | PAGE 5 |
| | | | | | | DIST WP | | | | |