

PRODUCT INFORMATION PACKET

Model No: 184TBDW7632

Catalog No: I131A

Pressure Washer Motor, 5 HP, 1 Ph, 60 Hz, 208-230 V, 1800 RPM, 184T Frame, DP



Regal and are trademarks of Regal Rexnord Corporation or one of its affiliated companies.
©2022 Regal Rexnord Corporation, All Rights Reserved. MC017097E

Nameplate Specifications

| | | | |
|------------------------|-----------------------|----------------------------|-------------------|
| Output HP | 5 Hp | Output KW | 3.7 kW |
| Frequency | 60 Hz | Voltage | 208-230 V |
| Current | 22.0-20.0 A | Speed | 1750 rpm |
| Service Factor | 1.15 | Phase | 1 |
| Efficiency | 84 % | Power Factor | 98 |
| Duty | Continuous | Insulation Class | F |
| Design Code | NO DESIGN CODE | KVA Code | G |
| Frame | 184T | Enclosure | Drip Proof |
| Thermal Protection | No Protection | Ambient Temperature | 40 °C |
| Drive End Bearing Size | 6206 | Opp Drive End Bearing Size | 6205 |
| UL | Recognized | CSA | Y |
| CE | N | IP Code | 22 |
| Number of Speeds | 1 | | |

Technical Specifications

| | | | |
|-----------------------|--------------------------------------|-----------------------|----------------------------|
| Electrical Type | Capacitor Start Capacitor Run | Starting Method | Across The Line |
| Poles | 4 | Rotation | Selective Clockwise |
| Resistance Main | 0 Ohms | Mounting | Rigid Base |
| Motor Orientation | Horizontal | Drive End Bearing | Ball |
| Opp Drive End Bearing | Ball | Frame Material | Rolled Steel |
| Shaft Type | T | Overall Length | 15.19 in |
| Frame Length | 11.00 in | Shaft Diameter | 1.125 in |
| Shaft Extension | 2.81 in | Assembly/Box Mounting | F1 ONLY |
| Connection Drawing | 005018.01ME | Outline Drawing | 035654-1100 |

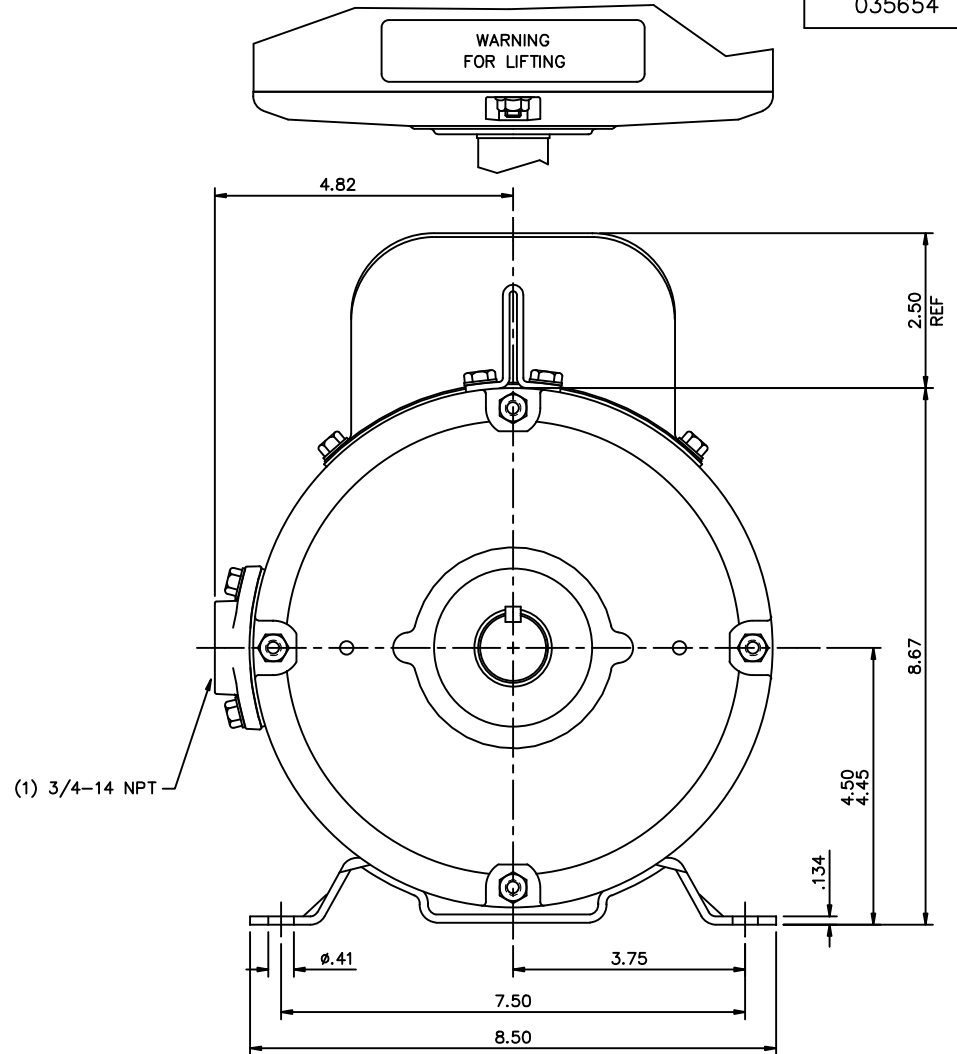
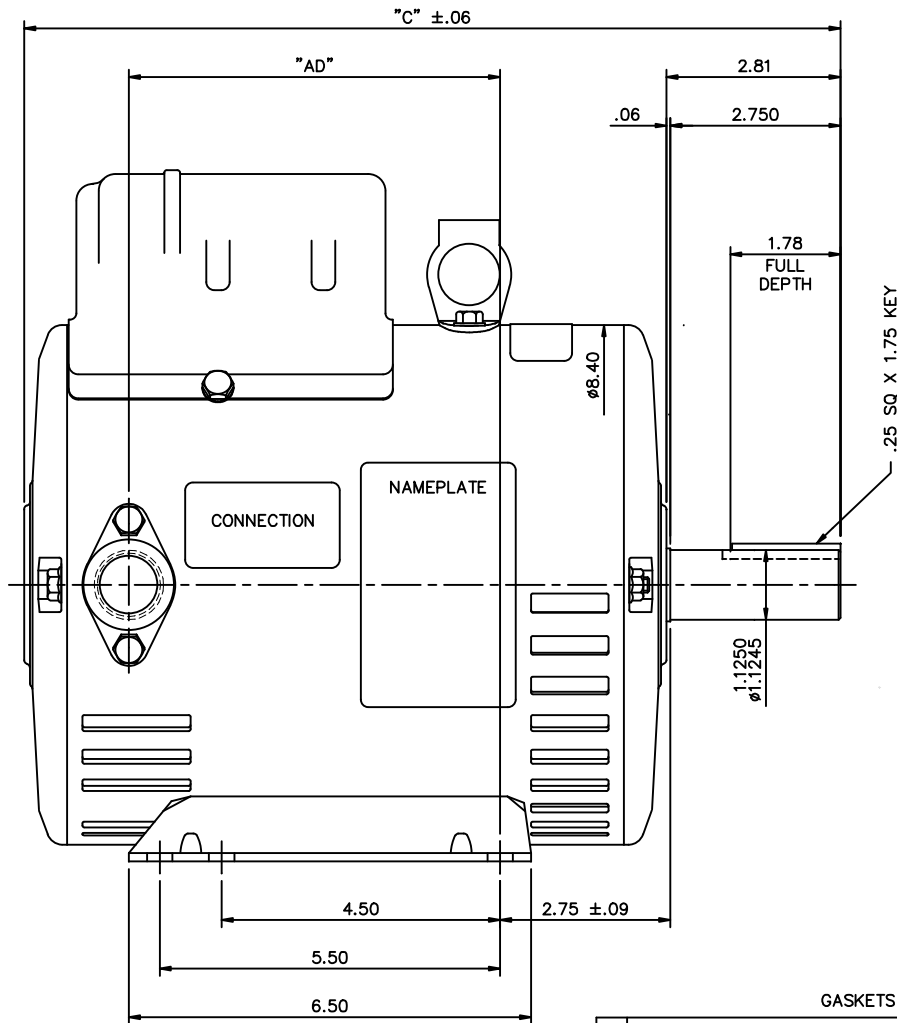

| DASH NO. | "C" | "AD" |
|----------|-------|------|
| 900 | 13.19 | 5.75 |
| 950 | 13.69 | 6.25 |
| 1000 | 14.19 | 6.75 |
| 1050 | 14.69 | 7.25 |
| 1100 | 15.19 | 7.75 |
| 1150 | 15.69 | 8.25 |

| REVISION | | BY & DATE | CHK | ANG | FINISH | DRAWING NO. | | REV. |
|----------|--------------------------------------|---------------|-----|-----|--------|-------------|--------|------|
| A | REMOVED THE LEADS COMING OUT FROM F1 | VV 11/14/2008 | | | | B | 035654 | A |
| NO. | | | | | | DRAWING NO. | | |
| | | | | | | 035654 | | |
| | | | | | | DRAWING NO. | | |
| | | | | | | 035654 | | |

THIS DRAWING IN DESIGN AND DETAIL IS OUR PROPERTY AND MUST NOT BE USED EXCEPT IN CONNECTION WITH OUR WORK ALL RIGHTS OF DESIGN AND INVENTION ARE RESERVED THIS IS AN ELECTRONICALLY GENERATED DOCUMENT - DO NOT SCALE THIS PRINT

| TOLERANCES UNLESS SPECIFIED | | MARATHON ELECTRIC | | DRAWN | |
|-----------------------------|--------|---------------------|--------|-----------------|---|
| DEC. | INCHES | TITLE | | VV 03/12/08 | |
| .X | ±.1 | OUTLINE- 180T FRAME | | CHK | |
| .XX | ±.03 | DRIP PROOF- RIGID | | APPD | |
| .XXX | ±.005 | SCALE 1=2 | | REF 035472 | |
| .XXXX | ±.0005 | MAT'L | | FMF 184TCDW7026 | |
| RFP | 6/5/03 | CAD FILE | 035654 | SIZE | B |
| DIST | | | | | |

VIEW FROM OUTSIDE OF MOTOR AT SWITCH END.

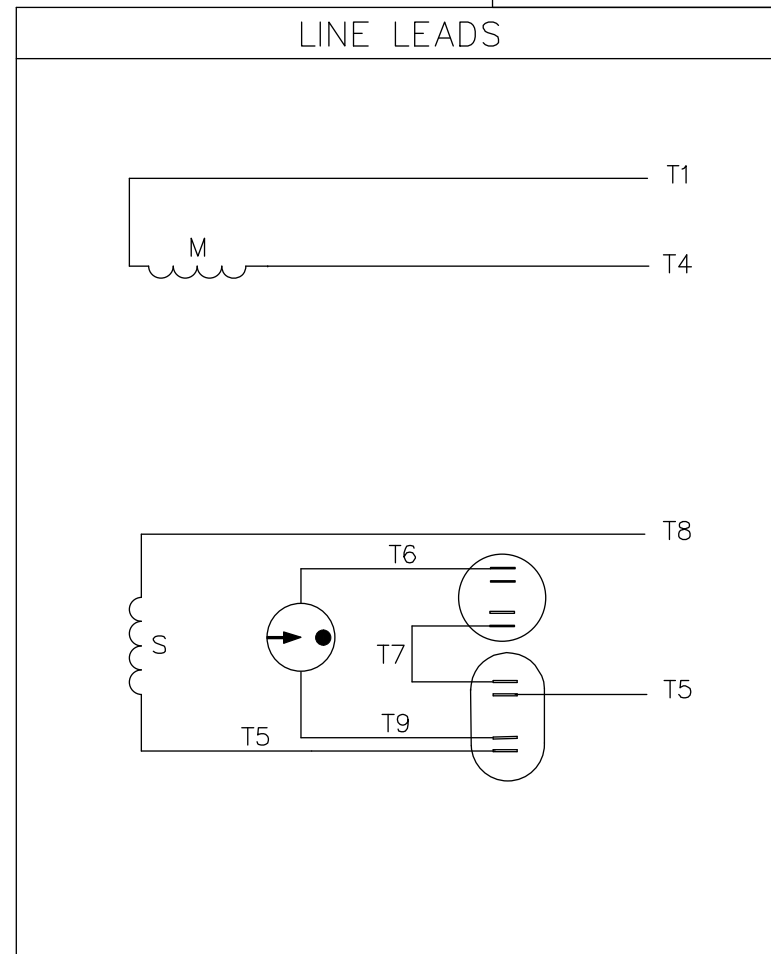
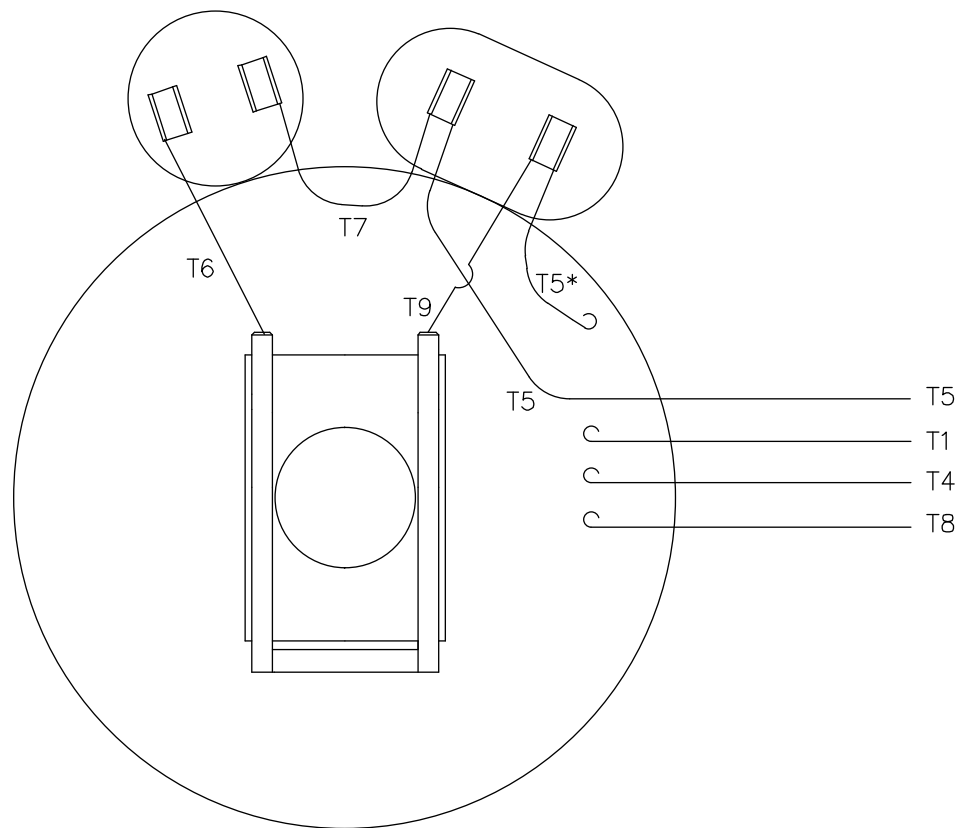

| | | |
|--------------------------|-------|-------|
| ROTATION FACING LEAD END | L1 | L2 |
| C.C.W. | T1,T8 | T4,T5 |
| C.W. | T1,T5 | T4,T8 |

* THIS LEAD MAY BE WHITE

| | | TOLERANCES UNLESS SPECIFIED | | | DRAWN RDW 6/5/03 CHK APPD SCALE 1=1 REF 005018 FMF 139047 PREV | | | | | |
|-----|----------|-----------------------------|--------|--------|--|----------|------------|----------------|-------------|------|
| | | DEC. | INCHES | | | | | | | |
| | | .X | ±.1 | | | | | | | |
| | | .XX | ±.01 | | | | | | | |
| | | .XXX | ±.005 | | | | | | | |
| | | .XXXX | ±.0005 | | | | | | | |
| NO. | REVISION | BY & DATE | CHK | ANG | ±1/2' | FINISH | TITLE | DECAL - 004018 | | |
| | | | RFP | 6/5/03 | | CAD FILE | 00501801ME | SIZE | DRAWING NO. | REV. |
| | | | DIST | | | | | A | 005018-01ME | |

THIS DRAWING IN DESIGN AND DETAIL IS OUR PROPERTY AND MUST NOT BE USED EXCEPT IN CONNECTION WITH OUR WORK ALL RIGHTS OF DESIGN AND INVENTION ARE RESERVED THIS IS AN ELECTRONICALLY GENERATED DOCUMENT - DO NOT SCALE THIS PRINT

CERTIFICATION DATA SHEET

Model#: 184TBDW7632 AA **WINDING#:** K84104 NONE 2
CONN. DIAGRAM: 005018.01ME **ASSEMBLY:** F1 ONLY
OUTLINE: 035654-1100

TYPICAL MOTOR PERFORMANCE DATA

| HP | KW | SYNC. RPM | F.L. RPM | FRAME | ENCLOSURE | KVA CODE | DESIGN |
|----|-----|-----------|----------|-------|-----------|----------|----------------|
| 5 | 3.7 | 1800 | 1750 | 184T | DP | G | NO DESIGN CODE |

| PH | Hz | VOLTS | FL AMPS | START TYPE | DUTY | INSL | S.F | AMB°C | ELEVATION |
|----|----|---------|---------|-----------------|------------|------|------|-------|-----------|
| 1 | 60 | 208-230 | 22-20 | ACROSS THE LINE | CONTINUOUS | F4 | 1.15 | 40 | 3300 |

| FULL LOAD EFF: 84 | 3/4 LOAD EFF: 84.3 | 1/2 LOAD EFF: 80.8 | GTD. EFF | ELEC. TYPE | NO LOAD AMPS |
|-------------------|--------------------|--------------------|----------|-------------------|--------------|
| FULL LOAD PF: 98 | 3/4 LOAD PF: 96.6 | 1/2 LOAD PF: 94.3 | 81.5 | CAP START CAP RUN | 2.9 |

| F.L. TORQUE | LOCKED ROTOR AMPS | L.R. TORQUE | B.D. TORQUE | F.L. RISE°C |
|-------------|-------------------|----------------|--------------|-------------|
| 15 LB-FT | 131.5 | 34.9 LB-FT 233 | 39 LB-FT 260 | 60 |

| SOUND PRESSURE @ 3 FT. | SOUND POWER | ROTOR WK^2 | MAX. WK^2 | SAFE STALL TIME | STARTS /HOUR | APPROX. MOTOR WGT |
|------------------------|-------------|------------|-----------|-----------------|--------------|-------------------|
| - dBA | - dBA | 0 LB-FT^2 | - LB-FT^2 | 10 SEC. | - | 0 LBS. |

***** SUPPLEMENTAL INFORMATION *****

| DE BRACKET TYPE | ODE BRACKET TYPE | MOUNT TYPE | ORIENTATION | SEVERE DUTY | HAZARDOUS LOCATION | DRIP COVER | SCREENS | PAINT |
|-----------------|------------------|------------|-------------|-------------|--------------------|------------|---------|---------------|
| STANDARD | STANDARD | RIGID | HORIZONTAL | FALSE | NONE | FALSE | NONE | BLUE (ENAMEL) |

| BEARINGS | | GREASE | SHAFT TYPE | SPECIAL DE | SPECIAL ODE | SHAFT MATERIAL | FRAME MATERIAL |
|----------|------|------------|------------|------------|-------------|-------------------|----------------|
| DE | OPE | | | | | | |
| BALL | BALL | POLYREX EM | T | NONE | NONE | AISI 1045 (C-240) | ROLLED STEEL |
| 6206 | 6205 | | | | | | |

| THERMO-PROTECTORS | | | | THERMISTORS | CONTROL | SPACE /n HEATERS |
|-------------------|------------|----------|----------|-------------|---------|------------------|
| THERMOSTATS | PROTECTORS | WDG RTDs | BRG RTDs | | | |
| NONE | NOT | NONE | NONE | NONE | FALSE | NONE VOLTS |

If Inverter equals NONE, contact factory for further information

*
N
O
T
E
S
*

| |
|---------------------------|
| INVERTER TORQUE: NONE |
| INV. HP SPEED RANGE: NONE |
| ENCODER: NONE |
| NONE NONE |
| NONE NONE PPR |
| BRAKE: NONE NONE |
| NONE P/N NONE |
| NONE NONE |
| NONE FT-LB NONE V NONE Hz |

DATE: 07/08/2017 12:46:51 AM
 FORM 3531 REV.3 02/07/99
 ** Subject to change without notice.



MARATHON ELECTRIC CORPORATION
TYPICAL PERFORMANCE CURVE for AC MOTOR

Customer

Curve at

230

Volts

HP 5.00

PHASE 1

Model No 184TBDW7632

60

HZ

VOLTS 208-230

5

HP

Catalog No I131A

HZ 60

RPM 1750

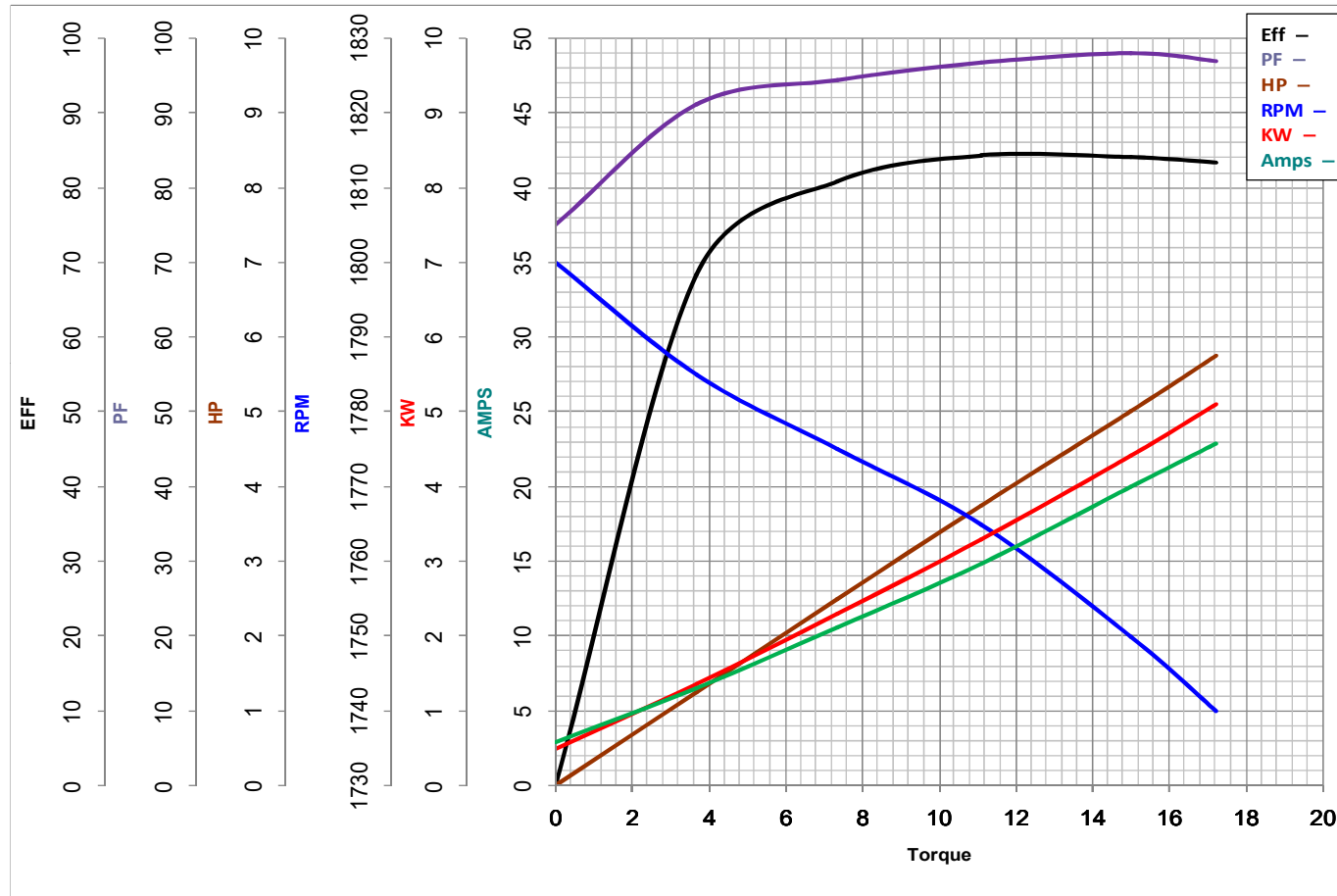

| | | | | | |
|-----------|-------------|-------|-----------|------------------|-------|
| | | | | Torque in Lb.Ft | |
| FL TORQUE | <u>15</u> | Lb.Ft | FL AMPS | <u>22-20</u> | |
| BD TORQUE | <u>39.0</u> | Lb.Ft | PU TORQUE | <u>29.3</u> | Lb.Ft |
| LR TORQUE | <u>34.9</u> | Lb.Ft | LR AMPS | <u>131.5</u> | |
| WINDING | K84104-2 | | Date | <u>1/10/2019</u> | |