

PRODUCT INFORMATION PACKET

Model No: 184TBDW7631

Catalog No: I128A

Pressure Washer Motor, 3 HP, 1 Ph, 60 Hz, 208-230 V, 1800 RPM, 184T Frame, DP



Regal and are trademarks of Regal Rexnord Corporation or one of its affiliated companies.
©2022 Regal Rexnord Corporation, All Rights Reserved. MC017097E

Nameplate Specifications

Output HP	3 Hp	Output KW	2.2 kW
Frequency	60 Hz	Voltage	208-230 V
Current	13.8-12.8-12.8 A	Speed	1760 rpm
Service Factor	1.15	Phase	1
Efficiency	81.5 %	Power Factor	92.5
Duty	Continuous	Insulation Class	F
Design Code	NO DESIGN CODE	KVA Code	G
Frame	184T	Enclosure	Drip Proof
Thermal Protection	No Protection	Ambient Temperature	40 °C
Drive End Bearing Size	6206	Opp Drive End Bearing Size	6205
UL	Recognized	CSA	Y
CE	N	IP Code	12
Number of Speeds	1		

Technical Specifications

Electrical Type	Capacitor Start Capacitor Run	Starting Method	Across The Line
Poles	4	Rotation	Selective Counterclockwise
Resistance Main	0 Ohms	Mounting	Rigid Base
Motor Orientation	Horizontal	Drive End Bearing	Ball
Opp Drive End Bearing	Ball	Frame Material	Rolled Steel
Shaft Type	T	Overall Length	13.69 in
Frame Length	9.50 in	Shaft Diameter	1.125 in
Shaft Extension	2.81 in	Assembly/Box Mounting	F1 ONLY
Outline Drawing	035654-950	Connection Drawing	005018.01ME

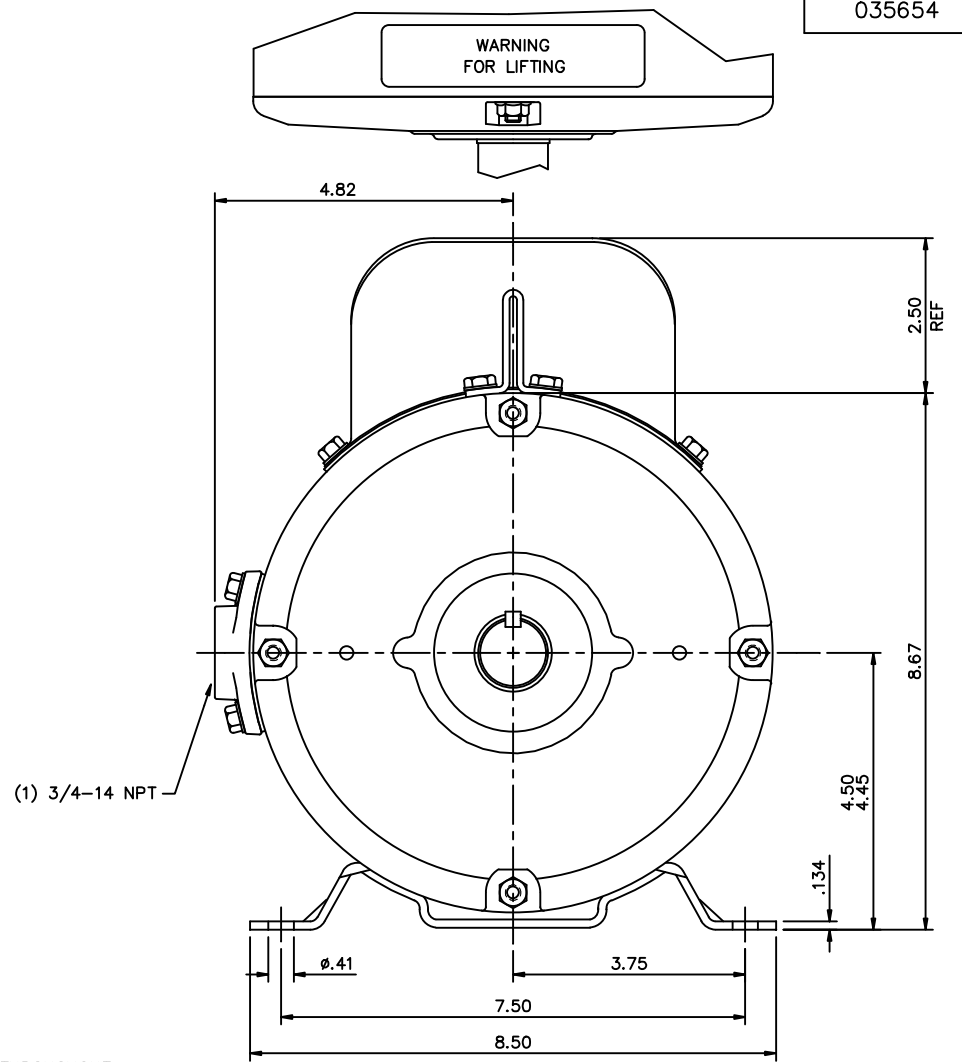
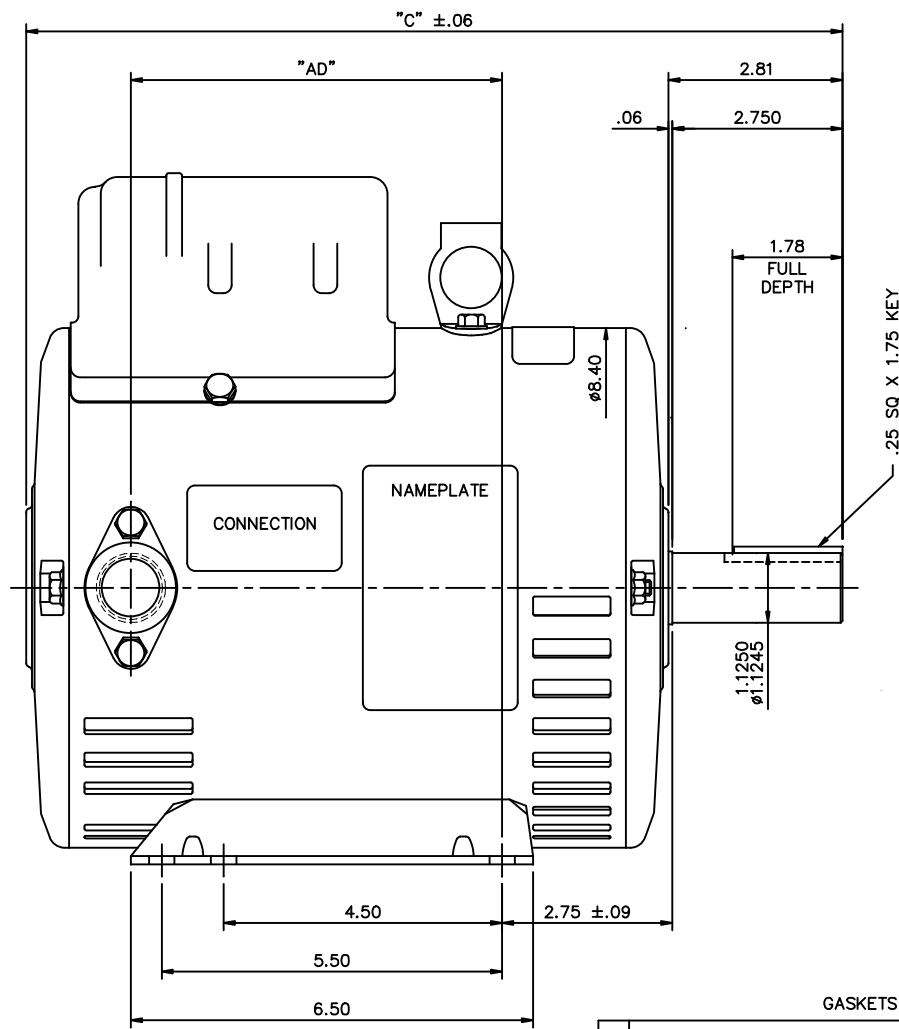

GASKETS THROUGHOUT

DASH NO.	"C"	"AD"
900	13.19	5.75
950	13.69	6.25
1000	14.19	6.75
1050	14.69	7.25
1100	15.19	7.75
1150	15.69	8.25

		TOLERANCES UNLESS SPECIFIED				DRAWN VV 03/12/08				
		DEC.	INCHES			CHK				
		.X	±.1		TITLE	SCALE 1=2				
		.XX	±.03		OUTLINE- 180T FRAME		REF 035472			
		.XXX	±.005		DRIP PROOF- RIGID		FMF 184TCDW7026			
A	REMOVED THE LEADS COMING OUT FROM F1	VV 11/14/2008			MAT'L	PREV				
NO.	REVISION	BY & DATE	CHK	ANG	±1/2'	FINISH				
THIS DRAWING IN DESIGN AND DETAIL IS OUR PROPERTY AND MUST NOT BE USED EXCEPT IN CONNECTION WITH OUR WORK ALL RIGHTS OF DESIGN AND INVENTION ARE RESERVED THIS IS AN ELECTRONICALLY GENERATED DOCUMENT - DO NOT SCALE THIS PRINT				RFP	6/5/03	CAD FILE	035654	SIZE	DRAWING NO.	REV.
				DIST				B	035654	A

VIEW FROM OUTSIDE OF MOTOR AT SWITCH END.

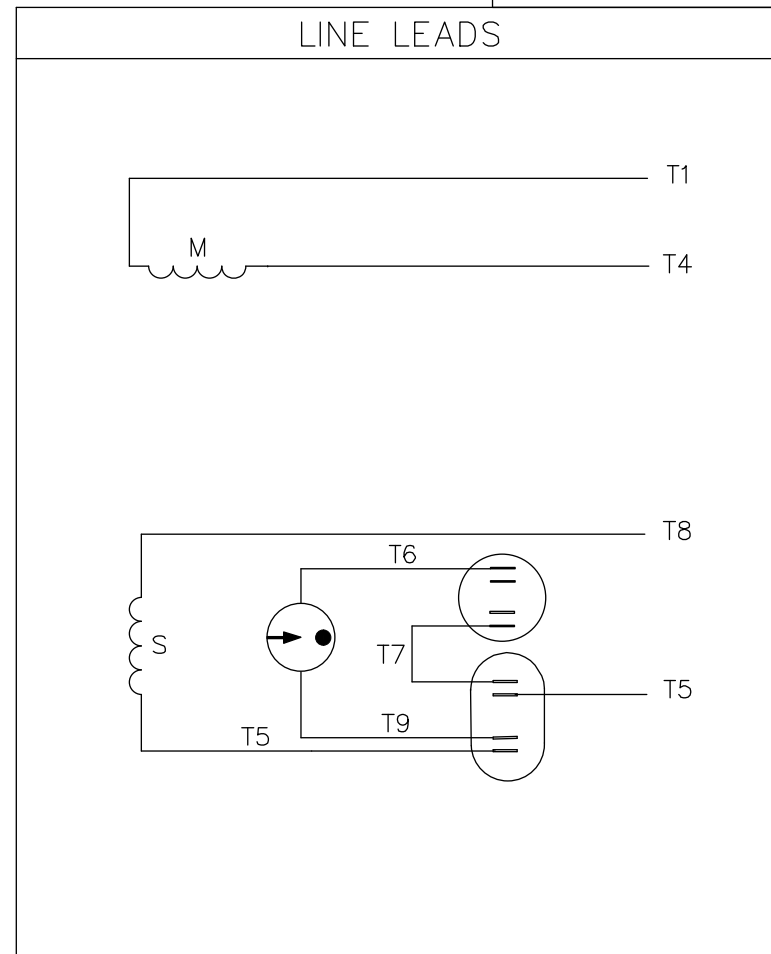
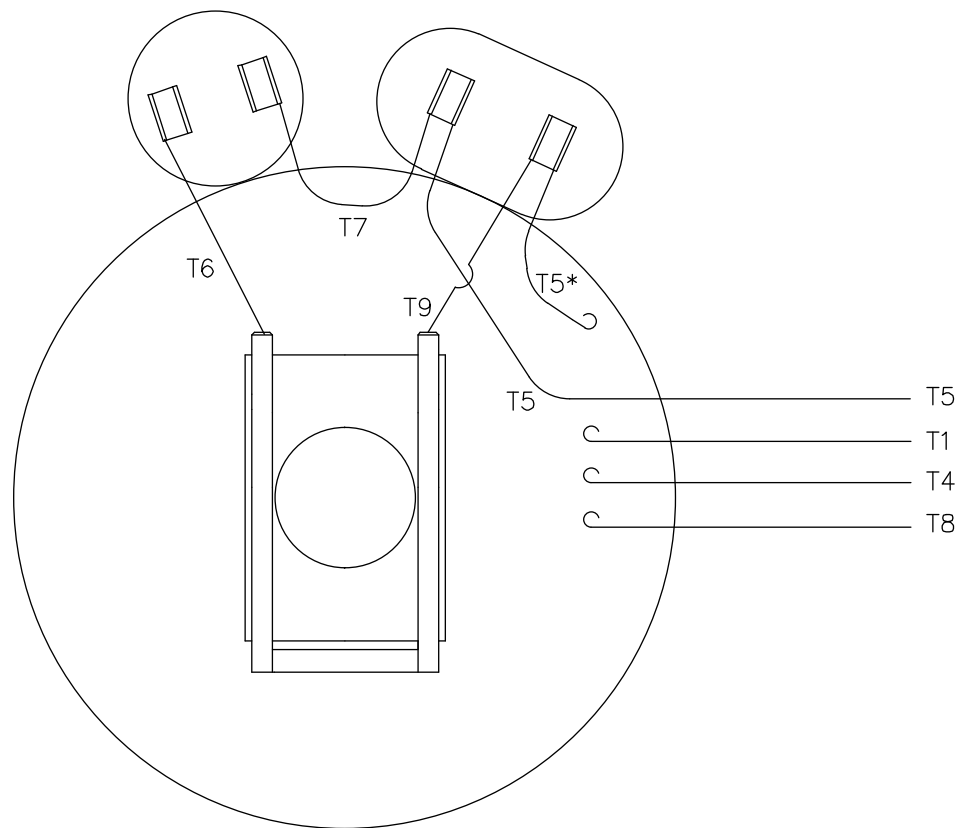

ROTATION FACING LEAD END	L1	L2
C.C.W.	T1,T8	T4,T5
C.W.	T1,T5	T4,T8

* THIS LEAD MAY BE WHITE

		TOLERANCES UNLESS SPECIFIED		DRAWN RDW 6/5/03	
		DEC.	INCHES	CHK	
		.X	±.1	APPD	
		.XX	±.01	SCALE 1=1	
		.XXX	±.005	REF 005018	
		.XXXX	±.0005	FMF 139047	
NO.	REVISION	BY & DATE	CHK	ANG ±1/2'	PREV
THIS DRAWING IN DESIGN AND DETAIL IS OUR PROPERTY AND MUST NOT BE USED EXCEPT IN CONNECTION WITH OUR WORK ALL RIGHTS OF DESIGN AND INVENTION ARE RESERVED THIS IS AN ELECTRONICALLY GENERATED DOCUMENT - DO NOT SCALE THIS PRINT			RFP	6/5/03	CAD FILE 00501801ME
			DIST		SIZE A DRAWING NO. 005018-01ME
					REV.



TITLE EXTERNAL WIRING DIAGRAM TYPE "K" W/O PROTECTOR
 MAT'L. DECAL - 004018

CERTIFICATION DATA SHEET

Model#: 184TBDW7631 AA **WINDING#:** K84101 NONE 2
CONN. DIAGRAM: 005018.01ME **ASSEMBLY:** F1 ONLY
OUTLINE: 035654-950

TYPICAL MOTOR PERFORMANCE DATA

HP	KW	SYNC. RPM	F.L. RPM	FRAME	ENCLOSURE	KVA CODE	DESIGN
3	2.24	1800	1760	184T	DP	G	NO DESIGN CODE

PH	Hz	VOLTS	FL AMPS	START TYPE	DUTY	INSL	S.F	AMB°C	ELEVATION
1	60	208-230	13.8-12.8	ACROSS THE LINE	CONTINUOUS	F4	1.15	40	3300

FULL LOAD EFF: 81.5	3/4 LOAD EFF: 82.4	1/2 LOAD EFF: 77.3	GTD. EFF	ELEC. TYPE	NO LOAD AMPS
FULL LOAD PF: 92.5	3/4 LOAD PF: 89.8	1/2 LOAD PF: 84.3	0	CAP START CAP RUN	4.5

F.L. TORQUE	LOCKED ROTOR AMPS	L.R. TORQUE	B.D. TORQUE	F.L. RISE°C
8.94 LB-FT	86.3	19.5 LB-FT 218	23.7 LB-FT 265	38

SOUND PRESSURE @ 3 FT.	SOUND POWER	ROTOR WK^2	MAX. WK^2	SAFE STALL TIME	STARTS /HOUR	APPROX. MOTOR WGT
0 dBA	10 dBA	0.147 LB-FT^2	0 LB-FT^2	10 SEC.	0	0 LBS.

*** SUPPLEMENTAL INFORMATION ***

DE BRACKET TYPE	ODE BRACKET TYPE	MOUNT TYPE	ORIENTATION	SEVERE DUTY	HAZARDOUS LOCATION	DRIP COVER	SCREENS	PAINT
STANDARD	STANDARD	RIGID	HORIZONTAL	FALSE	NONE	FALSE	NONE	BLUE (ENAMEL)

BEARINGS		GREASE	SHAFT TYPE	SPECIAL DE	SPECIAL ODE	SHAFT MATERIAL	FRAME MATERIAL
DE	OPE						
BALL	BALL	POLYREX EM	T	NONE	NONE	AISI 1045 (C-240)	ROLLED STEEL
6206	6205						

THERMO-PROTECTORS				THERMISTORS	CONTROL	SPACE /n HEATERS
THERMOSTATS	PROTECTORS	WDG RTDs	BRG RTDs			
NONE	NOT	NONE	NONE	NONE	FALSE	NONE VOLTS

If Inverter equals NONE, contact factory for further information

INVERTER TORQUE: NONE
INV. HP SPEED RANGE: NONE
ENCODER: NONE
NONE NONE
NONE NONE PPR
BRAKE: NONE NONE
NONE P/N NONE
NONE NONE
NONE FT-LB NONE V NONE Hz

*
N
O
T
E
S
*

DATE: 07/08/2017 12:46:12 AM
FORM 3531 REV.3 02/07/99
** Subject to change without notice.



MARATHON ELECTRIC CORPORATION
TYPICAL PERFORMANCE CURVE for AC MOTOR

Customer

Curve at

230

Volts

HP 3.00

PHASE 1

Model No 184TBDW7631

60

HZ

VOLTS 208-230

3

HP

Catalog No I128A

HZ 60

RPM 1760

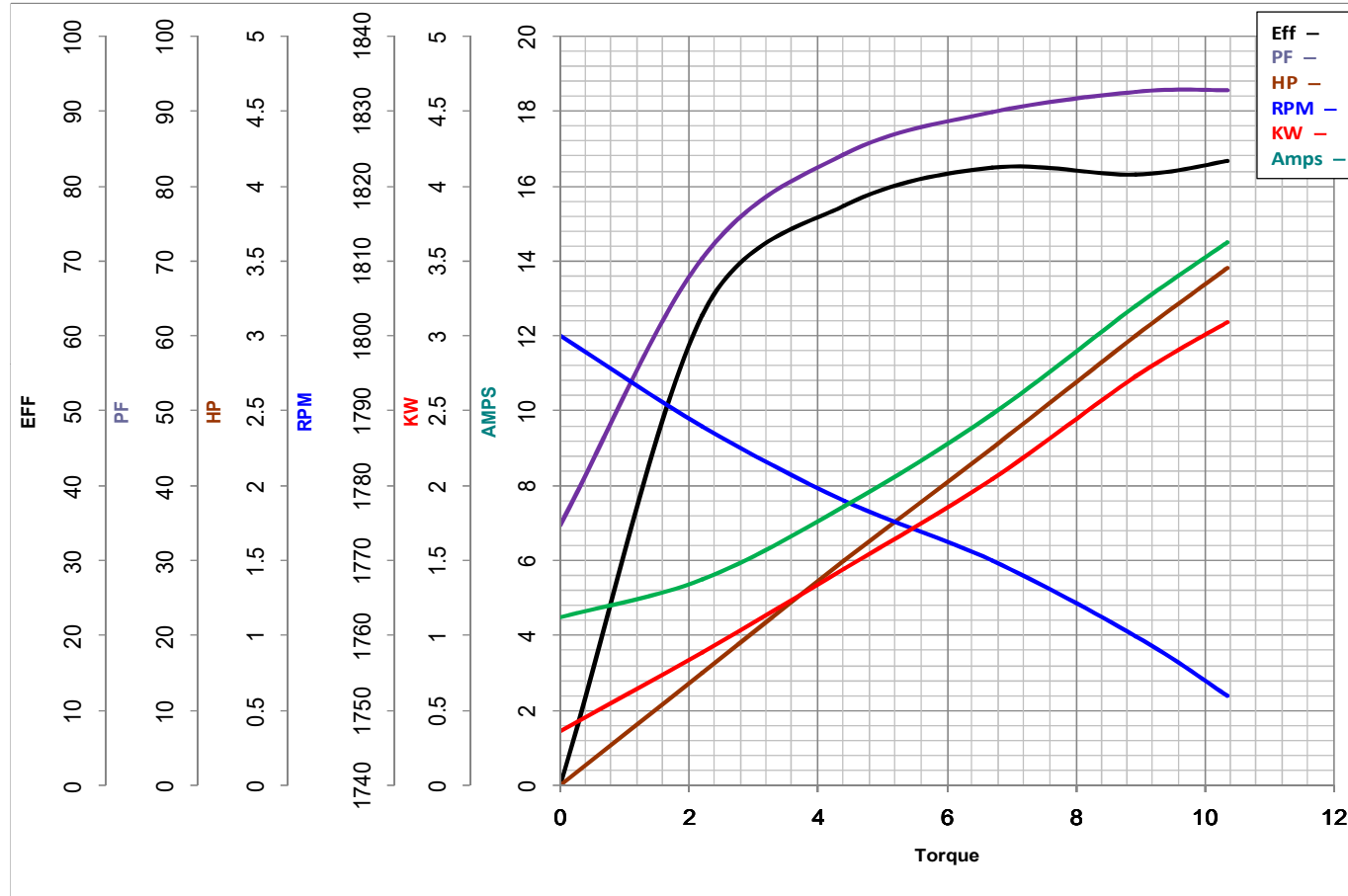

		Torque in Lb.Ft			
FL TORQUE	<u>8.94</u>	Lb.Ft	FL AMPS	<u>13.8-12.8</u>	
BD TORQUE	<u>23.7</u>	Lb.Ft	PU TORQUE	<u>17.6</u>	Lb.Ft
LR TORQUE	<u>19.5</u>	Lb.Ft	LR AMPS	<u>86.3</u>	
WINDING	K84101-2		Date	1/10/2019	