

PRODUCT INFORMATION PACKET

marathon[®]
Motors

Model No: 182TTFB4026

Catalog No: E953

Other Purpose Motor, 3 & 2 HP, 3 Ph, 60 & 50 Hz, 208-230/460 & 190/380 V, 1800 & 1500 RPM,
182T Frame, TEFC

Regal and Marathon are trademarks of Regal Rexnord Corporation or one of its affiliated companies.

©2023 Regal Rexnord Corporation, All Rights Reserved. MC017097E

RegalRexnord



Nameplate Specifications

Phase	3	Output HP	3 & 2 Hp
Output KW	2.2 & 1.5 kW	Voltage	208-230/460 & 190/380 V
Speed	1760 & 1470 rpm	Service Factor	1.15 & 1.15
Frame	182T	Enclosure	Totally Enclosed Fan Cooled
Thermal Protection	No Protection	Efficiency	87.5 & 87.5 %
Ambient Temperature	40 °C	Frequency	60 & 50 Hz
Current	8.8-8.2/4.1 & 6.8/3.4 A	Power Factor	80
Duty	Continuous	Insulation Class	F
Design Code	B	KVA Code	K
Drive End Bearing Size	6206	Opp Drive End Bearing Size	6205
UL	Recognized	CSA	Y
CE	Y	IP Code	43
Number of Speeds	1		

Technical Specifications

Electrical Type	Squirrel Cage Induction Run	Starting Method	Across The Line
Poles	4	Rotation	Reversible
Resistance Main	3.8 Ohms	Mounting	Rigid Base
Motor Orientation	Horizontal	Drive End Bearing	Ball
Opp Drive End Bearing	Ball	Frame Material	Rolled Steel
Shaft Type	T	Overall Length	13.96 in
Shaft Diameter	1.125 in	Shaft Extension	2.75 in
Assembly/Box Mounting	F1 Only		
Outline Drawing	OL139000	Connection Drawing	NONE

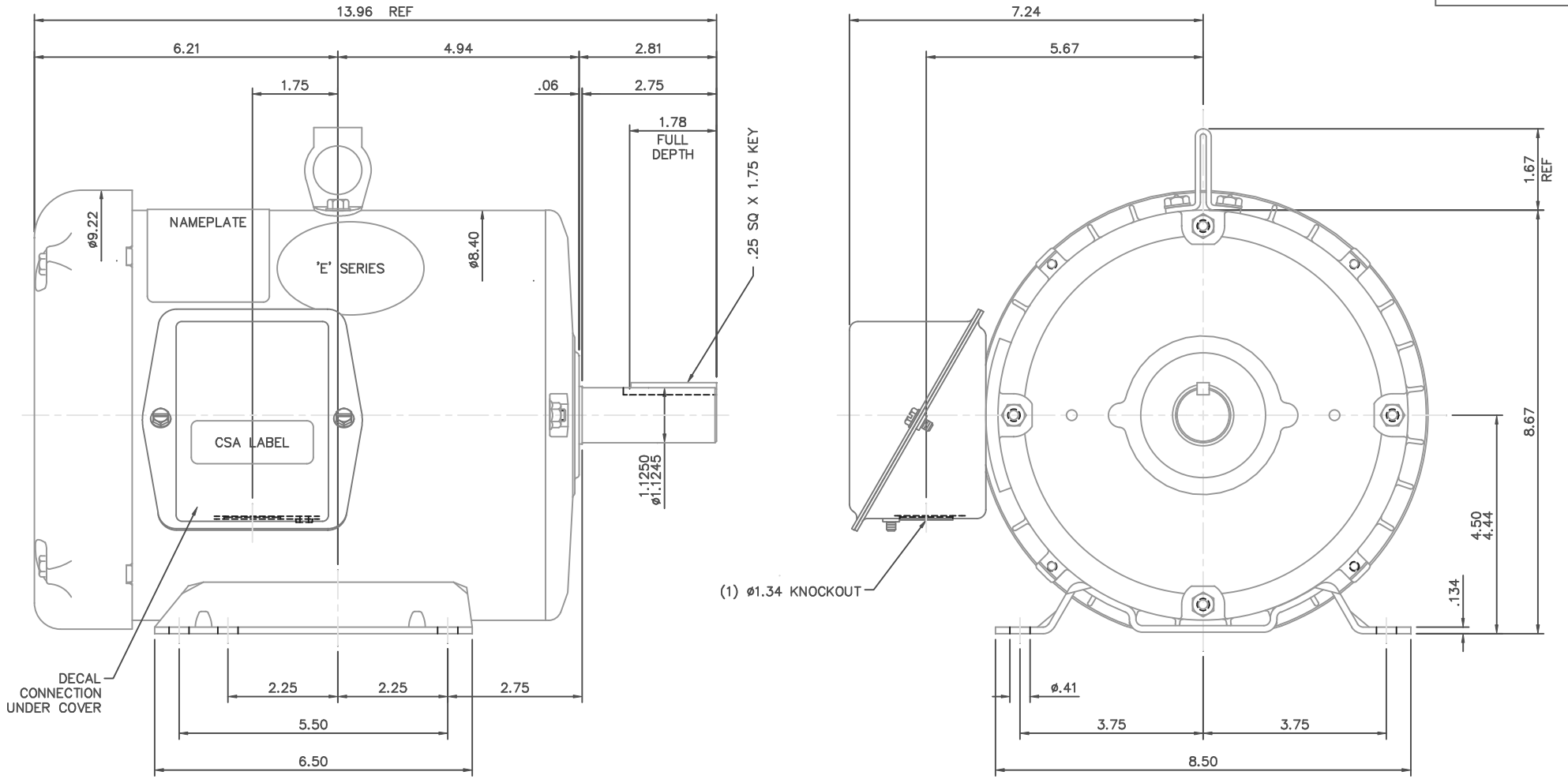

GASKETS THROUGHOUT

				TOLERANCES UNLESS OTHERWISE SPECIFIED				
				DEC.	INCHES	METRIC		
				.X	±.1	±2.5	DRAWN RDW 05/04/01	
				.XX	±.03	±.76	APPR. DWF 05/04/01	
				.XXX	±.005	±.127	R.F.P. 05/04/01	
				.XXXX	±.0005	±.0127	SCALE 1=2	
NO.	REVISION	BY & DATE	CH'K'D.	FRACTIONS	±1/64	REF.	P420	
THIS DRAWING IN DESIGN AND DETAIL IS OUR PROPERTY AND MUST NOT BE USED EXCEPT IN CONNECTION WITH OUR WORK. ALL RIGHTS OF DESIGN AND INVENTION ARE RESERVED. THIS IS AN ELECTRONICALLY GENERATED DOCUMENT - DO NOT SCALE THIS PRINT.				ANGLES	±1/2°	FINISH	MARATHON	
				REV.	DRAWING NO.	NLV		
							TITLE	OUTLINE - 182T FRAME TEFC - RIGID
							MAT'L.	
							REV.	DRAWING NO. OL139000