

PRODUCT INFORMATION PACKET

Model No: 182THTL17041

Catalog No: Y286

Encoder Motors, TENV, 3 HP, 3 Ph, 60 Hz, 230/460 V, 1755 RPM, 182TC Frame



Regal and are trademarks of Regal Rexnord Corporation or one of its affiliated companies.
©2022 Regal Rexnord Corporation, All Rights Reserved. MC017097E

Nameplate Specifications

Output HP	3 Hp	Output KW	2.2 kW
Frequency	60 Hz	Voltage	230/460 V
Current	8.4/4.2 A	Speed	1755 rpm
Service Factor	1	Phase	3
Efficiency	85.5 %	Power Factor	80
Duty	Continuous	Insulation Class	H
Design Code	INV	KVA Code	P
Frame	182TC	Enclosure	Totally Enclosed Non Ventilated
Thermal Protection	No Protection	Ambient Temperature	40 °C
Drive End Bearing Size	6207	Opp Drive End Bearing Size	6206
UL	Recognized	CSA	Y
CE	Y	IP Code	43
Number of Speeds	1		

Technical Specifications

Electrical Type	Squirrel Cage Inverter Duty	Starting Method	Inverter Only
Poles	4	Rotation	Reversible
Resistance Main	3.55 Ohms	Mounting	Rigid Base
Motor Orientation	Horizontal	Drive End Bearing	Ball
Opp Drive End Bearing	Ball	Frame Material	Aluminum
Shaft Type	T	Overall Length	17.19 in
Frame Length	6.75 in	Shaft Diameter	1.125 in
Shaft Extension	2.62 in	Assembly/Box Mounting	F1 ONLY
Connection Drawing	A-EE7308	Outline Drawing	A-SS69914-675

This is an uncontrolled document once printed or downloaded and is subject to change without notice. Date Created:05/18/2022

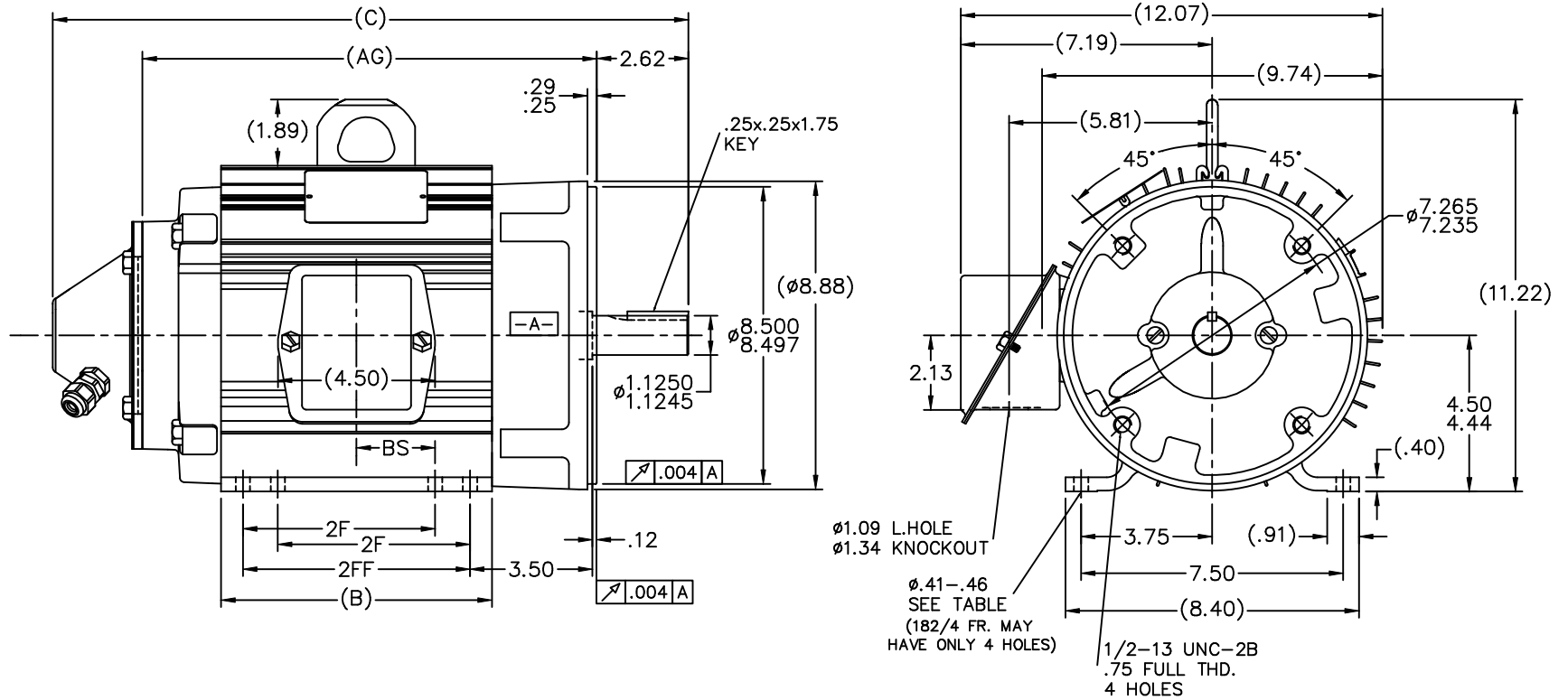

NOTES:

1. CONDUIT BOX CAN BE ROTATED IN 90° STEPS.
2. CONDUIT BOX CAN BE MOUNTED ON OPPOSITE SIDE BY REMOVING BRACKETS AND TURNING FRAME 180°.
3. NAMEPLATE TO BE READ FROM CONDUIT BOX SIDE OF MOTOR.

DASH	FR.	C	B	2F	BS	AG	2FF	FOOT HOLE	MOUNTING
575	182TC	16.19	5.75	4.50	2.25	11.00	----	4	F1 OR F2
675	182TC	17.19	6.75	4.50	2.75	12.00	5.50	8	F1 OR F2
675A	184TC	17.19	6.75	5.50	2.75	12.00	----	4	F1 OR F2
720	182TC	17.64	7.20	4.50	2.98	12.45	5.96	8	F1 OR F2
720	182TC	17.64	7.20	4.50	2.98	12.45	----	4	F1 ONLY
775	184TC	18.19	7.75	5.50	3.25	13.00	----	8	F1 OR F2
875	184TC	19.19	8.75	5.50	3.75	14.00	----	8	F1 OR F2
925	184TC	19.69	9.25	5.50	4.00	14.50	----	8	F1 OR F2

NO.		REVISION	BY & DATE	CHK	ANG	FINISH	TOLERANCES UNLESS SPECIFIED		MARATHON ELECTRIC	DRAWN
							DEC.	INCHES		JJB
							.X	±.1		CHK ML 03-27-2008
							.XX	±.03		APPD GK 03-27-2008
							.XXX	±.005	TITLE	SCALE 5-16
							.XXXX	±.0005	OUTLINE - HS 20 ENCODER	REF SS68967D
									180T FR. - BB - TS - TENV	FMF ME080077, MUB6314
									MATL	PREV ME080077
							RFP	6-20-2008	CAD FILE SS69914	SIZE B DRAWING NO. PAGE 1 OF 1 REV.
							DIST	LB		SS69914

EE7308

THREE PHASE
DUAL VOLTAGE MOTOR



VIEW OF TERMINAL END

REF.
WINDING DIAGRAM

T8Y, T2Y, T2BL, T4BX, T2EC, T2G
T6BZ, T2B, T6BL, T4AV, T6B, T4B

OPTIONAL CORD
CONNECTION

L1 — WHITE
L2 — RED
L3 — BLACK

NO.	REVISION	BY & DATE	CHK	ANG	TOLERANCES UNLESS SPECIFIED		FINISH	DRAWN RM 11/20/1990				
					DEC.	INCHES						
5	CHG TO REGAL LOGO	SL 09/10/2015	AB					CHK ML 11/21/1990				
4	REVISED IEC NOTATIONS	MSG 11/15/2011	CMN	.X	±.1			APPD SAS 04/24/2003				
3	ADDED IEC NOTATIONS... (U1), (V1) ETC. MU95194	MSG 5/10/2010	MJS	.XX	±.02		TITLE CONNECTION DIAGRAM	SCALE 1=1				
2	ADDED THE OPTIONAL CORD CONNECTION MU46318	RDH 04/24/2003	DRS	.XXX	±.005		3Ø - DUAL VOLTAGE MOTOR	REF				
1	REDRAWN	RM 11/20/1990		.XXXX	±.0005		MAT'L.	FMF				
					±7'30"			PREV				
THIS DRAWING IN DESIGN AND DETAIL IS OUR PROPERTY AND MUST NOT BE USED EXCEPT IN CONNECTION WITH OUR WORK ALL RIGHTS OF DESIGN AND INVENTION ARE RESERVED THIS IS AN ELECTRONICALLY GENERATED DOCUMENT - DO NOT SCALE THIS PRINT							RFP	CAD FILE ee7308	SIZE A	DRAWING NO. EE7308	PAGE OF 5	REV. 5
							DIST WP					



Regal Beloit America, Inc.

NONE	P/N	NONE	
NONE	NONE		
NONE FT-LB		NONE V	NONE Hz

DATE: 06/27/2017 01:16:38 AM
FORM 3531 REV.3 02/07/99
** Subject to change without notice.

Data Sheet

Date: 20-06-2017
 Customer: _____
 Attention: _____
 Submitted by: FAREEDA DUDEKULA



182THTL17041

Submittal

Data @ 460 V

Motor Load Data

Load	0%	25%	50%	75%	100%	115%	125%	LR
Current (Amps)	2.20	2.40	2.80	3.5	4.2	4.6	5.0	49.0
Torque (ft-lb)	0.00	2.20	4.4	6.7	9.0	10.2	11.3	33.0
RPM	1800	1790	1780	1765	1755	1,751	1745	0
Efficiency (%)		72.5	82.5	84.0	85.5	84.8	84.0	
P.F. (%)	10.5	42.0	61.0	73.0	80.0	82.0	84.0	60.0

Motor Speed Data

	LR	Pull-Up	BD	Rated	Idle
Speed (RPM)	0	900	1600	1755	1800
Current (Amps)	49.0	46.0	31.0	4.2	2.20
Torque (ft-lb)	33.0	27.0	48.0	9.0	0.00

Information Block				
HP	3.0			
Sync. RPM	1800			
Frame	182			
Enclosure	TENV			
Construction	TTL			
Voltage	230/460 V			
Frequency	60 Hz			
Design	A			
LR Code letter	P			
Service Factor	1.15			
Temp Rise @ FL	80 ° C			
Duty	CONT			
Ambient	40 ° C			
Elevation	1,000 feet			
Rotor/Shaft wk ²	0.42 Lb-Ft ²			
Ref Wdg	K1824104 NONE			
Sound Pressure @ 1M	62 dBA			
VFD Rating	CONSTANT 1000:1			
Outline Dwg	A-SS69914-675			
Conn. Diag	A-EE7308			
Additional Specifications:				
0				
365THFS8036				
EQUIV CKT (OHMS / PHASE)				
R1	R2	X1	X2	Xm
2.3560	1.7310	4.2660	4.3040	123.9260

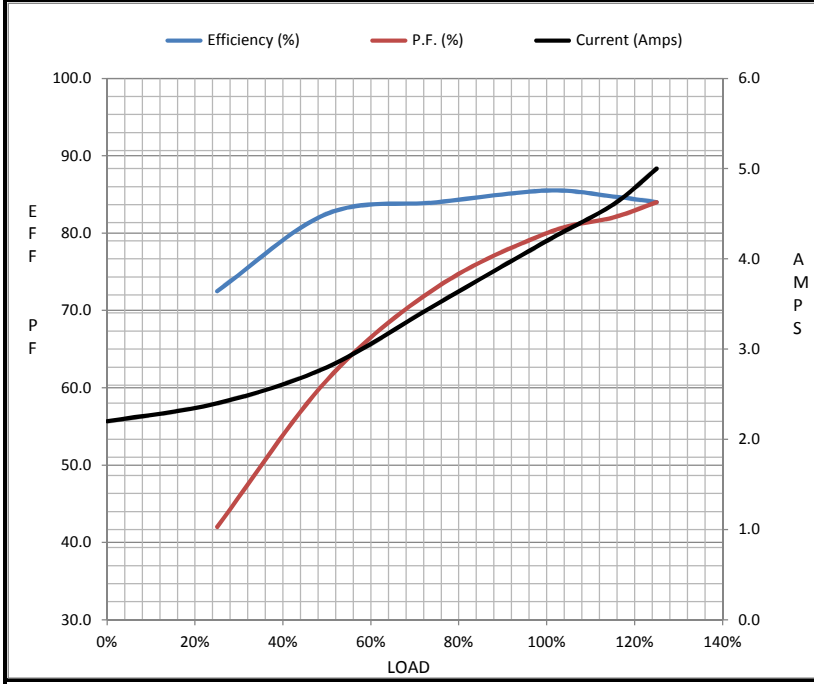

Speed - Torque Curve

