

# PRODUCT INFORMATION PACKET



Model No: 193317.60  
Catalog No: 193317.60

LEESON® PASSPORT 15 HP General Purpose, 3 phase, 1200 RPM, 230/460 V, 160L Frame, TEFC



Regal and Leeson are trademarks of Regal Rexnord Corporation or one of its affiliated companies.  
©2023 Regal Rexnord Corporation, All Rights Reserved. MC017097E





## Nameplate Specifications

Phase	3	Output HP	15 & 10 Hp
Output KW	11.2 & 7.5 kW	Voltage	230/460 & 200/400 V
Speed	1180 & 988 rpm	Service Factor	1.15 & 1.15
Frame	160L	Enclosure	Totally Enclosed Fan Cooled
Thermal Protection	No Protection	Efficiency	91.7 & 91.7 %
Ambient Temperature	40 °C	Frequency	60 & 50 Hz
Current	40/20 & 32/16 A	Power Factor	77
Duty	Continuous	Insulation Class	F
Design Code	B	KVA Code	F
Drive End Bearing Size	6309	Opp Drive End Bearing Size	6209
UL	Recognized	CSA	Y
CE	Y	IP Code	43
Number of Speeds	1		

## Technical Specifications

Electrical Type	Squirrel Cage Inverter Rated	Starting Method	Wye Start Delta Run Or Inverter
Poles	6	Rotation	Reversible
Resistance Main	0 Ohms	Mounting	Rigid Base
Motor Orientation	Horizontal	Drive End Bearing	Ball
Opp Drive End Bearing	Ball	Frame Material	Cast Iron
Shaft Type	IEC	Overall Length	26.57 in
Shaft Diameter	1.625 in	Shaft Extension	4.33 in
Assembly/Box Mounting	F3		
Outline Drawing	B-SS622238	Connection Drawing	004172.01

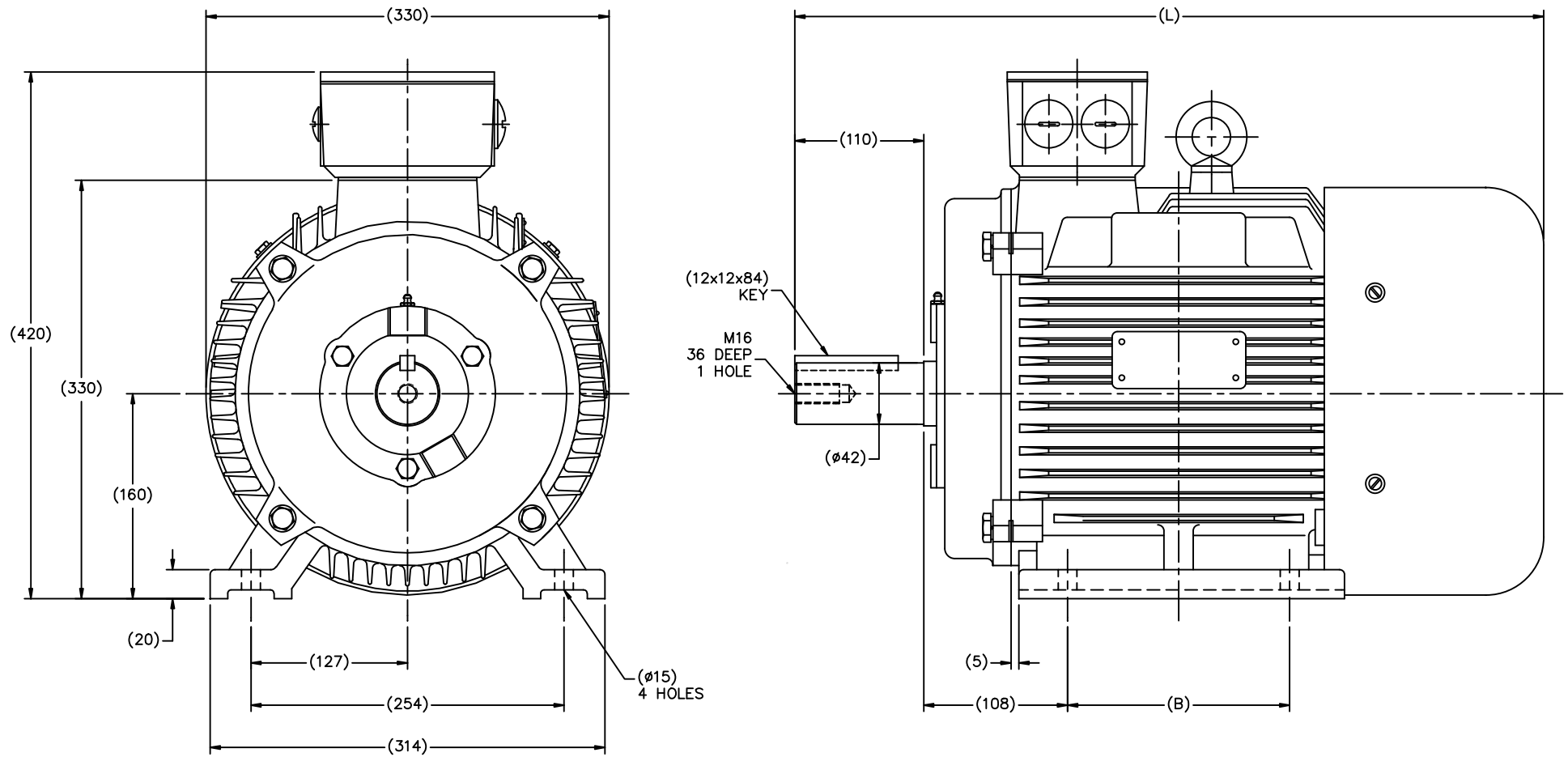

(MAY NOT BE DRAWN TO SCALE)

(DIMENSIONS ARE IN MILLIMETERS)

DF160L-6R	193317.60	675	254
FRAME	PART #	L	B

TOLERANCES UNLESS SPECIFIED				DRAWN MSG 11-17-2010	
DEC.	METRIC			CHK	MJS 11-18-2010
.X	±2.5			APPD	SB 11-18-2010
.XX	±.76			SCALE	5=16
.XXX	±.127			REF	
.XXXX	±.0127			FMF	HEBEI
NO.	REVISION	BY & DATE	CHK	ANG	±7°30"
THIS DRAWING IN DESIGN AND DETAIL IS OUR PROPERTY AND MUST NOT BE USED EXCEPT IN CONNECTION WITH OUR WORK. ALL RIGHTS OF DESIGN AND INVENTION ARE RESERVED. THIS IS AN ELECTRONICALLY GENERATED DOCUMENT - DO NOT SCALE THIS PRINT				RFP	11-18-2010
				DIST	
				FINISH	
				CAD FILE	ss622238
				SIZE	B
				DRAWING NO.	SS622238
				PAGE	OF
				REV.	



REGAL-BELOIT CORPORATION

TITLE OUTLINE - IEC PREMIUM  
DF160L-6R (II)

## WYE - DELTA STARTING USEABLE ON 2,4 AND 6 POLE MOTORS.

## LOW VOLTAGE CONNECTION

## HIGH VOLTAGE CONNECTION

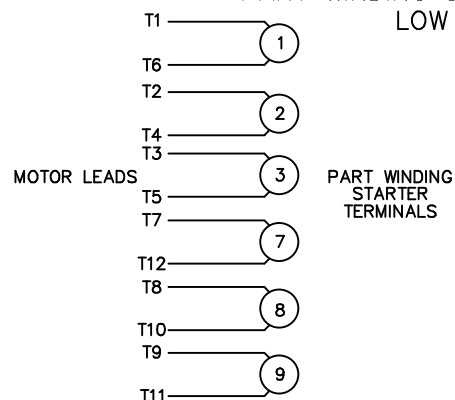

REFER TO THE WYE-DELTA STARTER CONNECTION INSTRUCTIONS FOR PROPER CONNECTION OF POWER LINES TO STARTER.

PART WINDING START USABLE ON 4 & 6 POLE MOTORS  
LOW VOLTAGE CONNECTION ONLY

REFER TO THE PART WINDING STARTER INSTRUCTIONS FOR PROPER CONNECTION OF POWER LINES TO STARTER.

REFER TO THE CUTLER - HAMMER OR EQUIV. FOR PROPER SELECTION OF OVERLOAD HEATER COILS.

## LINE LEADS

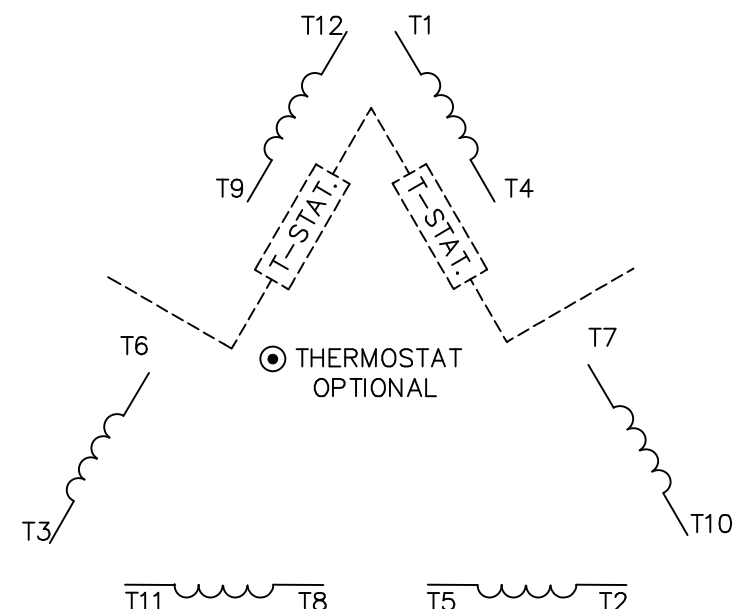

ROTATION CAN BE REVERSED BY INTERCHANGING ANY TWO LINE LEADS  
 ● RED LEADS OR P1, P2, FOR N/C THERMOSTAT

## ACROSS THE LINE START &amp; RUN

	LINE 1	LINE 2	LINE 3	JOIN & INSULATE SEPARATELY
HIGH VOLT	T1,T12	T2,T10	T3,T11	(T4,T7) (T5,T8) (T6,T9)
LOW VOLT	T1,T6 T7,T12	T2,T4 T8,T10	T3,T5 T9,T11	

TOLERANCES  
UNLESS SPECIFIED

DEC. INCHES

.X ±.1

.XX ±.01

.XXX ±.005

.XXXX ±.0005

ANG ±1/2"



ELECTRIC MOTORS  
GEARMOTORS  
AND DRIVES

DRAWN WLW 09/08/77

CHK RPB 09/12/77

APPD JCW 09/12/77

SCALE 1=1

REF

FMF

PREV

03 REV'D LOW VOLTAGE CONN. LEADS PER ELEC.

BJB 06/07/00

02 ADDED T-STAT. NOTES PER ELECTRICAL

KMM 06/02/98

01 REDRAWN TO CAD

DBT 06/02/97

NO. REVISION

BY &amp; DATE

CHK

ANG

RFP

DIST

TITLE DELTA - WYE CONNECTION DIAGRAM

MAT'L.

FINISH

CAD FILE 00417201

SIZE

A

DRAWING NO.

004172-01

REV.

03

THIS DRAWING IN DESIGN AND DETAIL IS OUR PROPERTY AND MUST NOT BE USED EXCEPT  
IN CONNECTION WITH OUR WORK ALL RIGHTS OF DESIGN AND INVENTION ARE RESERVED  
THIS IS AN ELECTRONICALLY GENERATED DOCUMENT - DO NOT SCALE THIS PRINT



# CERTIFICATION DATA SHEET

**1051 CHEYENNE AVE.  
GRAFTON, WI 53024  
PH. 262-377-8810**

CATALOG #: 193317.60

CONN. DIAGRAM: 004172.01

OUTLINE: B-SS622238

MOUNTING: F3

WINDING #: T12906020 3

## TYPICAL MOTOR PERFORMANCE DATA

HP	kW	SYNC. RPM	F.L. RPM	FRAME	ENCLOSURE	KVA CODE	DESIGN
15&10	11.2&7.50	1200	1180&988	160L	TEFC	F	B

PH	Hz	VOLTS	AMPS	START TYPE	DUTY	INSL	S.F.	AMB°C
3	60/50	230/460&200/400	40/20&32/16	Y START D RUN OR INV	CONTINUOUS	F5	1.15/1.15	40

FULL LOAD EFF:	91.7&91.7	3/4 LOAD EFF:	92.4	1/2 LOAD EFF:	91.7	GTD. EFF	ELEC. TYPE
FULL LOAD PF:	77&73	3/4 LOAD PF:	74.5	1/2 LOAD PF:	66	90.2	SQ CAGE INV RATED

F.L. TORQUE	LOCKED ROTOR AMPS	L.R. TORQUE	B.D. TORQUE	F.L. RISE°C
66.8 LB-FT	196 / 98	107 LB-FT 160 %	164 LB-FT 245 %	45

SOUND PRESSURE @ 3 FT.	SOUND POWER	ROTOR WK^2	MAX. WK^2	SAFE STALL TIME	STARTS / HOUR	APPROX. MOTOR WGT
55 dBA	65 dBA	- LB-FT^2	- LB-FT^2	- SEC.	-	332 LBS.

## \*\*\* SUPPLEMENTAL INFORMATION \*\*\*

DE BRACKET TYPE	ODE BRACKET TYPE	MOUNT TYPE	ORIENTATION	SEVERE DUTY	HAZARDOUS LOCATION	DRIP COVER	SCREENS	PAINT
STANDARD	STANDARD	RIGID	HORIZONTAL	FALSE	NONE	FALSE	NONE	BLUE - LEESON (ENAMEL)

BEARINGS		GREASE	SHAFT TYPE	SPECIAL DE	SPECIAL ODE	SHAFT MATERIAL	FRAME MATERIAL
DE	ODE						
BALL	BALL	POLYREX EM	STANDARD IEC	NONE	NONE	AISI 1045 (C-240)	CAST IRON
6309	6209						

THERMO-PROTECTORS				THERMISTORS	CONTROL	SPACE HEATERS
THERMOSTATS	PROTECTORS	WDG RTDs	BRG RTDs			
NONE	NOT	NONE	NONE	NONE	FALSE	NONE VOLTS

\*

N

O

T

E

S

INVERTER TORQUE: CONSTANT 10:1

INV. HP SPEED RANGE: NONE

ENCODER: NONE

NONE NONE

NONE NONE PPR

BRAKE: NONE NONE

NONE P/N NONE

NONE NONE

NONE FT-LB NONE V NONE Hz

## Data Sheet

Date: 1/24/2018

193317.60



Data @ 460 V

## Motor Load Data

Load	0%	25%	50%	75%	100%	115%	125%	LR	
Current (Amps)	7.6	9.2	11.5	15.5	20.0	23.0	25.5	98.0	
Torque (ft-lb)	0.00	15.4	33.2	50.0	66.8	77.5	84.5	107	
RPM	1200	1195	1190	1185	1180	1,175	1170	0	
Efficiency (%)		88.5	91.7	92.4	91.7	91.0	90.2		
P.F. (%)	5.0	43.0	66.0	74.5	77.0	77.0	77.0	37.0	

## Motor Speed Data

	LR	Pull-Up	BD	Rated	Idle
Speed (RPM)	0	600	1000	1180	1200
Current (Amps)	98.0	90.0	63.0	20.0	7.6
Torque (ft-lb)	107	90.0	164	66.8	0.00

## Information Block

HP	15.0			
Sync. RPM	1200			
Frame	160			
Enclosure	TEFC			
Construction	TFC			
Voltage	230/460#200/400	V		
Frequency	60	Hz		
Design	B			
LR Code letter	G			
Service Factor	1.15			
Temp Rise @ FL	45	° C		
Duty	CONT			
Ambient	40	° C		
Elevation	1,000	feet		
Rotor/Shaft wk²	0.00	Lb-Ft²		
Ref Wdg	T12906020 NONE			
Sound Pressure @ 1M	55	dBA		
VFD Rating	CONSTANT 10:1			
Outline Dwg	B-SS622238			
Conn. Diag	004172.01			
Additional Specifications:				
0				
193316.60				
EQUIV CKT (OHMS / PHASE)				
R1	R2	X1	X2	Xm
0.0000	0.0000	0.0000	0.0000	0.0000

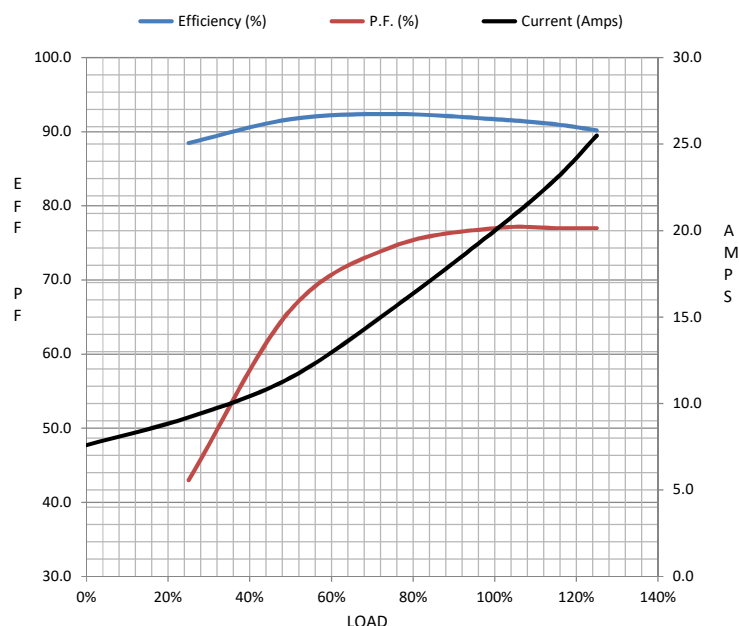

## Speed - Torque Curve

