

# PRODUCT INFORMATION PACKET



Model No: 171574.60

Catalog No: 171574.60

WATTSaver® General Purpose Motor, 3 & 2 HP, 3 Ph, 60 & 50 Hz, 208-230/460 & 190/380 V,  
1200 & 1000 RPM, 213T Frame, DP



Regal and Leeson are trademarks of Regal Rexnord Corporation or one of its affiliated companies.

©2023 Regal Rexnord Corporation, All Rights Reserved. MC017097E





### Nameplate Specifications

Phase	<b>3</b>	Output HP	<b>3 &amp; 2 Hp</b>
Output KW	<b>2.2 &amp; 1.5 kW</b>	Voltage	<b>208-230/460 &amp; 190/380 V</b>
Speed	<b>1185 &amp; 985 rpm</b>	Service Factor	<b>1.15 &amp; 1.15</b>
Frame	<b>213T</b>	Enclosure	<b>Drip Proof</b>
Thermal Protection	<b>No Protection</b>	Efficiency	<b>88.5 %</b>
Ambient Temperature	<b>40 °C</b>	Frequency	<b>60 &amp; 50 Hz</b>
Current	<b>10.2-10/5 &amp; 8.8/4.4 A</b>	Power Factor	<b>63.2</b>
Duty	<b>Continuous</b>	Insulation Class	<b>F</b>
Design Code	<b>B</b>	KVA Code	<b>K</b>
Drive End Bearing Size	<b>6308</b>	Opp Drive End Bearing Size	<b>6208</b>
UL	<b>Recognized</b>	CSA	<b>Y</b>
CE	<b>N</b>	IP Code	<b>22</b>
Number of Speeds	<b>1</b>		

### Technical Specifications

Electrical Type	<b>Squirrel Cage Inverter Rated</b>	Starting Method	<b>Wye Start Delta Run Or Inverter</b>
Poles	<b>6</b>	Rotation	<b>Reversible</b>
Resistance Main	<b>3.091 Ohms</b>	Mounting	<b>Rigid Base</b>
Motor Orientation	<b>Horizontal</b>	Drive End Bearing	<b>Ball</b>
Opp Drive End Bearing	<b>Ball</b>	Frame Material	<b>Cast Iron</b>
Shaft Type	<b>T</b>	Overall Length	<b>16.38 in</b>
Shaft Diameter	<b>1.375 in</b>	Shaft Extension	<b>3.38 in</b>
Assembly/Box Mounting	<b>F1 ONLY</b>		
Outline Drawing	<b>16954960</b>	Connection Drawing	<b>5010.10</b>

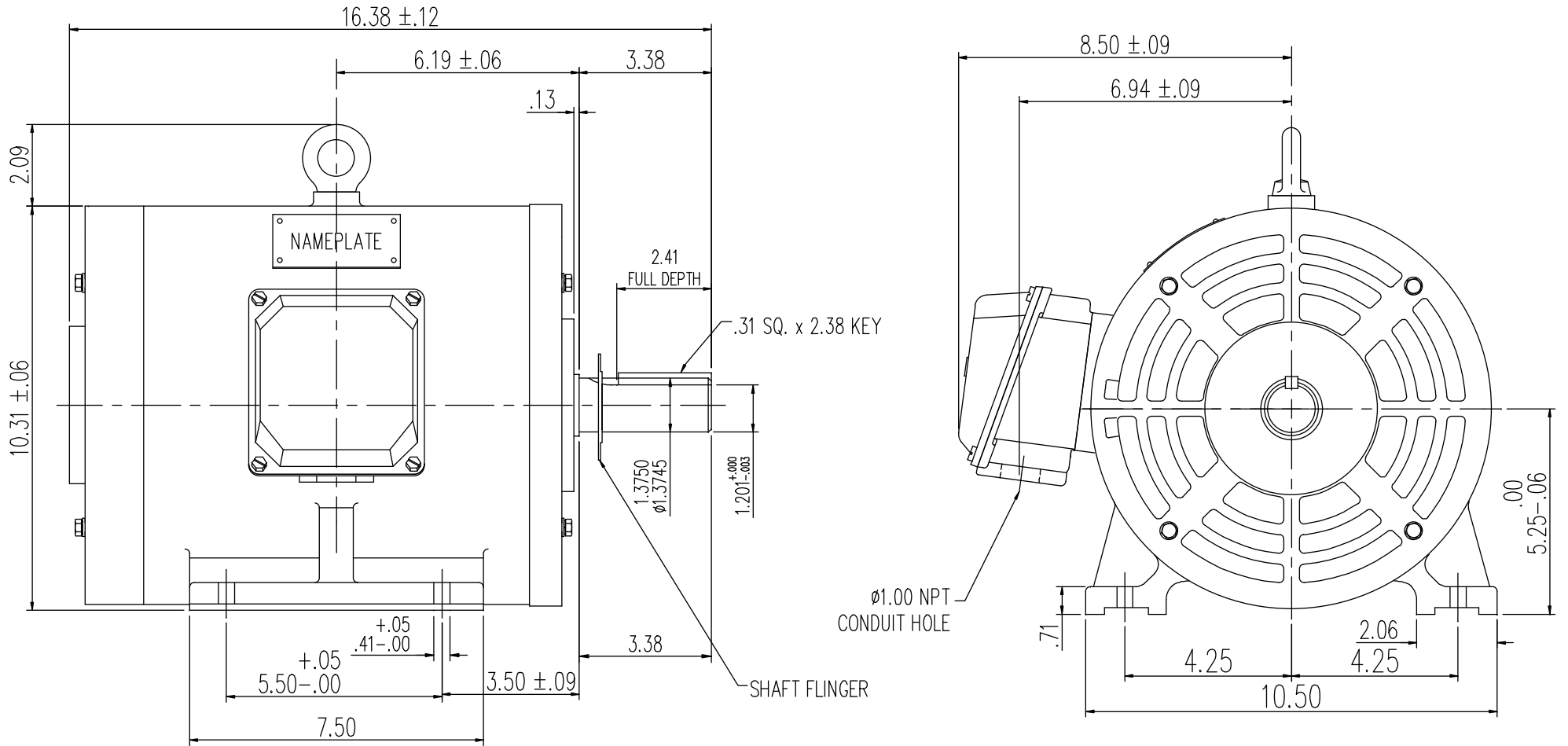

				TOLERANCES UNLESS SPECIFIED		<b>REGAL - BELOIT CORPORATION</b>		DRAWN DRZ 03/21/01			
				DEC.	INCHES			CHK			
				.X	±.1	APPD					
				.XX	±.03	TITLE		SCALE 1=1			
				.XXX	±.005	ODP, RIGID MOUNT, NEW CON-BOX		REF 169515			
				.XXXX	±.0005	MAT'L.		FMF			
A REVISED TO NEW BORDER FORMAT				DWF	12/14/01	FINISH		PREV			
NO.	REVISION	BY & DATE	CHK	ANG	±1/2	CAD FILE		16954960	SIZE DRAWING NO.		
THIS DRAWING IN DESIGN AND DETAIL IS OUR PROPERTY AND MUST NOT BE USED EXCEPT IN CONNECTION WITH OUR WORK ALL RIGHTS OF DESIGN AND INVENTION ARE RESERVED THIS IS AN ELECTRONICALLY GENERATED DOCUMENT - DO NOT SCALE THIS PRINT						RFP	16954960		B	169549-60	REV. A
						DIST					

Data Sheet

Date: 2/1/2018

171574.60



Data @ 460 V

Motor Load Data

Load	0%	25%	50%	75%	100%	115%	125%	LR
Current (Amps)	3.2	3.4	3.8	4.3	5.0	5.4	5.7	31.2
Torque (ft-lb)	0.00	3.3	6.6	10.0	13.3	15.0	16.7	29.6
RPM	1200	1197	1192	1188	1185	1,182	1178	0
Efficiency (%)		77.0	85.5	87.5	88.5	88.5	88.5	
P.F. (%)	6.0	26.0	43.0	55.0	63.0	65.8	68.5	0.0

Motor Speed Data

	LR	Pull-Up	BD	Rated	Idle
Speed (RPM)	0	300	1050	1185	1200
Current (Amps)	31.2	29.6	19.7	5.0	3.2
Torque (ft-lb)	29.6	25.1	49.9	13.3	0.00

Information Block				
HP	3.0			
Sync. RPM	1200			
Frame	213			
Enclosure	DP			
Construction	TDC			
Voltage	208-230/460#190/380 V			
Frequency	60 Hz			
Design	B			
LR Code letter	K			
Service Factor	1.15			
Temp Rise @ FL	23 °C			
Duty	CONT			
Ambient	40 °C			
Elevation	1,000 feet			
Rotor/Shaft wk <sup>2</sup>	0.00 Lb-Ft <sup>2</sup>			
Ref Wdg	T10706007 DR			
Sound Pressure @ 1M	999 dBA			
VFD Rating	CONSTANT 10:1			
Outline Dwg	16954960			
Conn. Diag	5010.10			
Additional Specifications:				
0				
0				
EQUIV CKT (OHMS / PHASE)				
R1	R2	X1	X2	Xm
0.0000	0.0000	0.0000	0.0000	0.0000

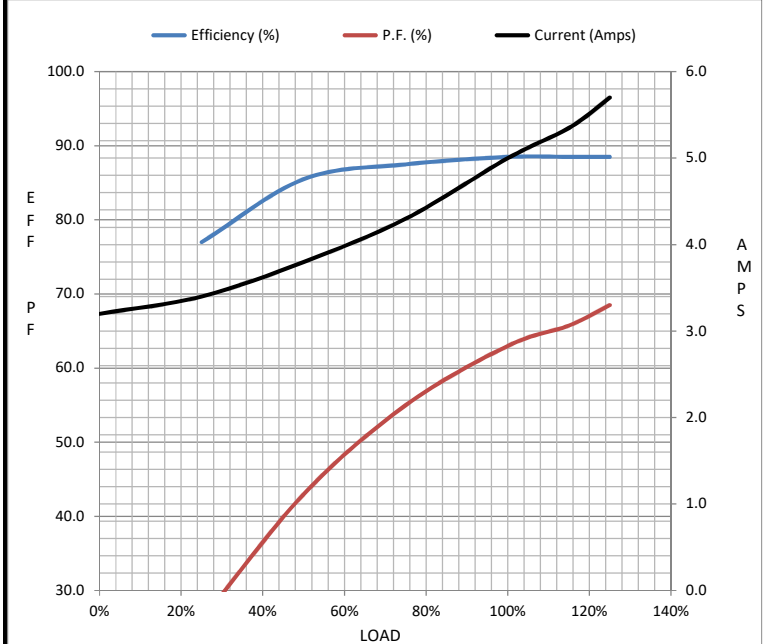

Speed - Torque Curve

