

PRODUCT INFORMATION PACKET



Model No: 140768.00

Catalog No: 140768.00

WATTSaver® General Purpose Motor, 10 & 10 HP, 3 Ph, 60 & 50 Hz, 230/460 & 190/380 V,
1800 & 1500 RPM, 215TC Frame, DP



Regal and Leeson are trademarks of Regal Rexnord Corporation or one of its affiliated companies.

©2023 Regal Rexnord Corporation, All Rights Reserved. MC017097E





Nameplate Specifications

Phase	3	Output HP	10 & 10 Hp
Output KW	7.5 & 7.5 kW	Voltage	230/460 & 190/380 V
Speed	1765 & 1460 rpm	Service Factor	1.25 & 1.25
Frame	215TC	Enclosure	Drip Proof
Thermal Protection	Automatic	Efficiency	91.7 & 91 %
Ambient Temperature	40 °C	Frequency	60 & 50 Hz
Current	26.8/13.4 & 33.6/16.8 A	Power Factor	76
Duty	Continuous	Insulation Class	F
Design Code	B	KVA Code	H
Drive End Bearing Size	6207	Opp Drive End Bearing Size	6206
UL	Recognized	CSA	Y
CE	Y	IP Code	22
Number of Speeds	1		

Technical Specifications

Electrical Type	Squirrel Cage Induction Run	Starting Method	Across The Line
Poles	4	Rotation	Reversible
Resistance Main	.85 Ohms	Mounting	Rigid Base
Motor Orientation	Horizontal	Drive End Bearing	Ball
Opp Drive End Bearing	Ball	Frame Material	Rolled Steel
Shaft Type	T	Overall Length	17.25 in
Frame Length	12.00 in	Shaft Diameter	1.375 in
Shaft Extension	3.38 in	Assembly/Box Mounting	F1/F2 CAPABLE
Outline Drawing	037635-1200	Connection Drawing	005010.20

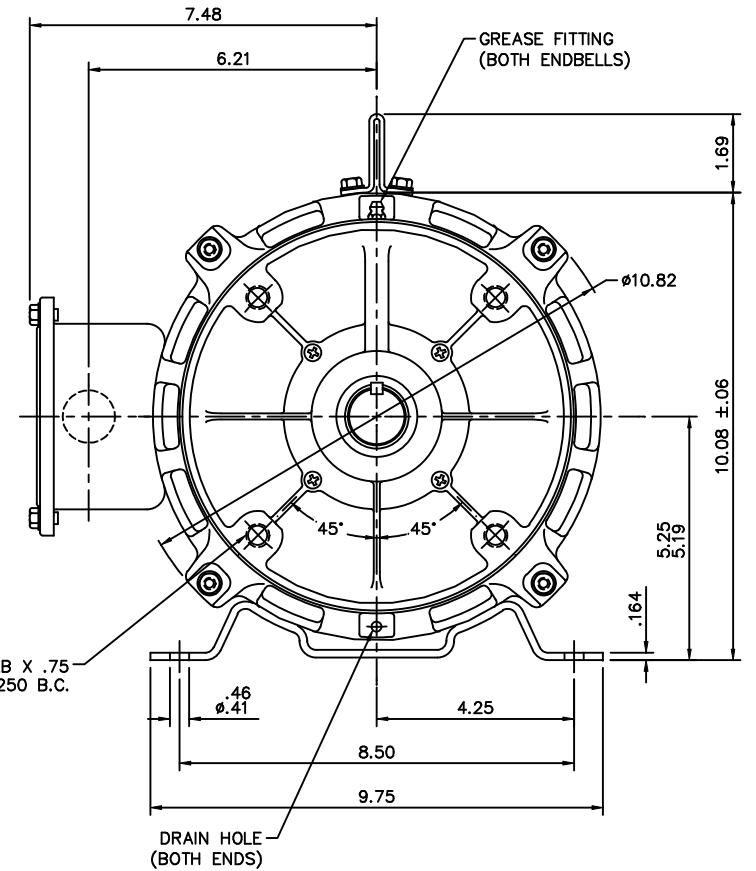

DASH NO.	"C"	"AD"
1100	16.25	4.75
1150	16.75	5.25
1200	17.25	5.75
1250	17.75	6.25
1300	18.25	6.75
1350	18.75	7.25
1400	19.25	7.75

3 of 5

VIEW FROM OUTSIDE OF MOTOR AT SWITCH END.

Uncontrolled Copy

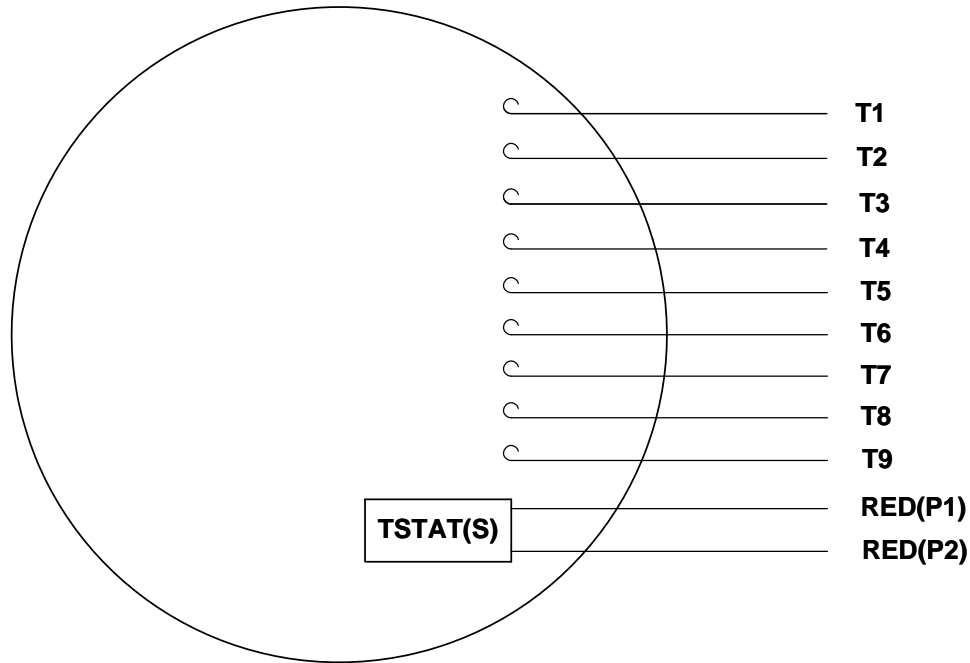

LINE LEADS

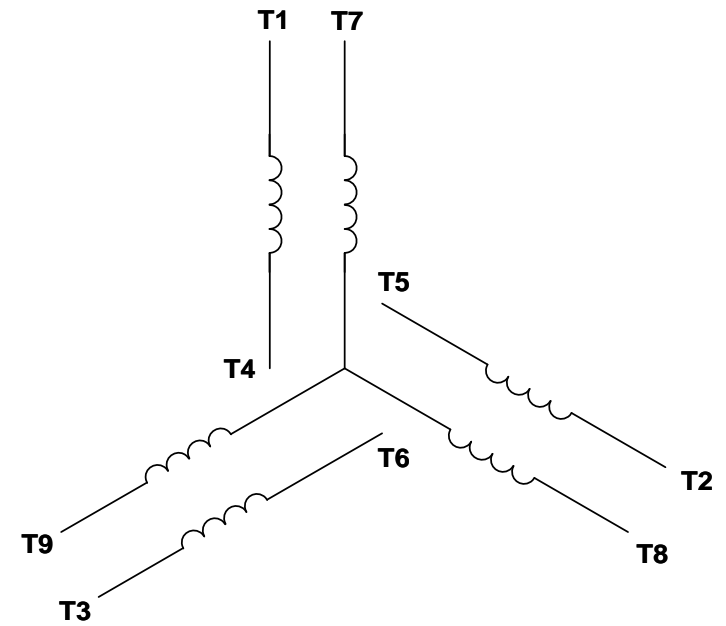

VOLTAGE	L1	L2	L3	JOIN & INSULATE
HIGH	T1	T2	T3	(T4,T7) (T5,T8) (T6,T9)
LOW	T1,T7	T2,T8	T3,T9	T4,T5,T6

DRAWING REVISION G	REVISION BY MVG	DATE 04/05/2017
ECO ECO-0121253	APPROVED BY SM	DATE 04/05/2017

ECO DESCRIPTION
ADDED P1 & P2 FOR TSTAT

TOLERANCES UNLESS OTHERWISE SPECIFIED:

DEC.	INCH	mm	ANGLE
.X	±0.1	[±2.5]	±0.5°
.XX	±0.01	[±0.25]	
.XXX	±0.005	[±0.127]	
.XXXX	±0.0005	[±0.0127]	

REMOVE BURRS & BREAK SHARP EDGES: .003/.015 [.076/.381] X 45°
CORNER FILLETS: R.02 [.51]
MACHINED SURFACES: 125/3.2 INCH/mm

mm SHOWN IN [BRACKETS]

DRAWN BY
DBT 12/16/97

DATE

APPROVED BY
KH 12/17/97

DATE

REFERENCE

THIRD ANGLE
PROJECTION



Regal Beloit America, Inc.

DESCRIPTION
CONN DIAGRAM-EXTERNAL
3 PHASE WITH PROTECTOR

MATERIAL
DECAL - 004014 (TSTAT) - 080582

PROCESS/FINISH
STOCK

SIZE
A

DRAWING NUMBER
00501020

SHEET
1 OF 1

Data Sheet

Date: 1/31/2018

140768.00



Data @ 460 V

Motor Load Data

Load	0%	25%	50%	75%	100%	115%	125%	LR	
Current (Amps)	6.4	7.2	8.8	10.9	13.4	15.0	16.0	79.5	
Torque (ft-lb)	0.00	7.4	14.7	22.2	29.7	34.3	37.3	53.0	
RPM	1800	1793	1785	1777	1766	1762	1758	0	
Efficiency (%)		88.0	92.0	92.6	91.9	92.2	91.6		
P.F. (%)	5.8	37.1	58.2	69.8	76.0	77.9	79.9	0.0	

Motor Speed Data

	LR	Pull-Up	BD	Rated	Idle
Speed (RPM)	0	400	1550	1766	1800
Current (Amps)	79.5	73.1	47.7	13.4	6.4
Torque (ft-lb)	53.0	43.0	91.0	29.7	0.00

Information Block

HP	10.0			
Sync. RPM	1800			
Frame	210			
Enclosure	DP			
Construction	NA			
Voltage	230/460#190/380	V		
Frequency	60	Hz		
Design	B			
LR Code letter	H			
Service Factor	1.15			
Temp Rise @ FL	34	° C		
Duty	CONT			
Ambient	40	° C		
Elevation	1,000	feet		
Rotor/Shaft wk²	0.98	Lb-Ft²		
Ref Wdg	T9496 DR			
Sound Pressure @ 1M	0	dBA		
VFD Rating	NONE			
Outline Dwg	037635-1200			
Conn. Diag	005010.20			
Additional Specifications:				
0				
0				
EQUIV CKT (OHMS / PHASE)				
R1	R2	X1	X2	Xm
0.0000	0.0000	0.0000	0.0000	0.0000

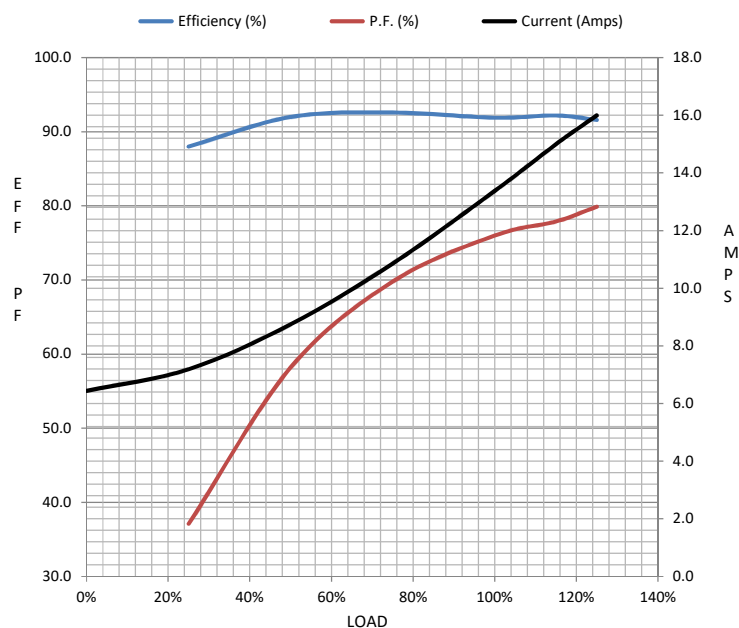

Speed - Torque Curve

