

PRODUCT INFORMATION PACKET

Model No: 131851.00

Catalog No: 131851.00

Pressure Washer Motor, 3 HP, 1 Ph, 60 Hz, 208-230 V, 1800 RPM, 184T Frame, DP



Regal and are trademarks of Regal Rexnord Corporation or one of its affiliated companies.
©2022 Regal Rexnord Corporation, All Rights Reserved. MC017097E

Nameplate Specifications

| | | | |
|------------------------|-----------------------|----------------------------|-------------------|
| Output HP | 3 Hp | Output KW | 2.2 kW |
| Frequency | 60 Hz | Voltage | 208-230 V |
| Current | 13.8-12.8 A | Speed | 1760 rpm |
| Service Factor | 1.15 | Phase | 1 |
| Efficiency | 81.5 % | Power Factor | 92.5 |
| Duty | Continuous | Insulation Class | F |
| Design Code | No Design Code | KVA Code | G |
| Frame | 184T | Enclosure | Drip Proof |
| Thermal Protection | Manual | Ambient Temperature | 40 °C |
| Drive End Bearing Size | 6206 | Opp Drive End Bearing Size | 6205 |
| UL | Recognized | CSA | Y |
| CE | N | IP Code | 22 |
| Number of Speeds | 1 | | |

Technical Specifications

| | | | |
|-----------------------|--------------------------------------|-----------------------|-----------------------------------|
| Electrical Type | Capacitor Start Capacitor Run | Starting Method | Across The Line |
| Poles | 4 | Rotation | Selective Counterclockwise |
| Resistance Main | 0 Ohms | Mounting | Rigid Base |
| Motor Orientation | Horizontal | Drive End Bearing | Ball |
| Opp Drive End Bearing | Ball | Frame Material | Rolled Steel |
| Shaft Type | T | Overall Length | 13.69 in |
| Frame Length | 9.50 in | Shaft Diameter | 1.125 in |
| Shaft Extension | 2.75 in | Assembly/Box Mounting | F1 Only |
| Outline Drawing | 035847-950 | Connection Drawing | 005056.03 |

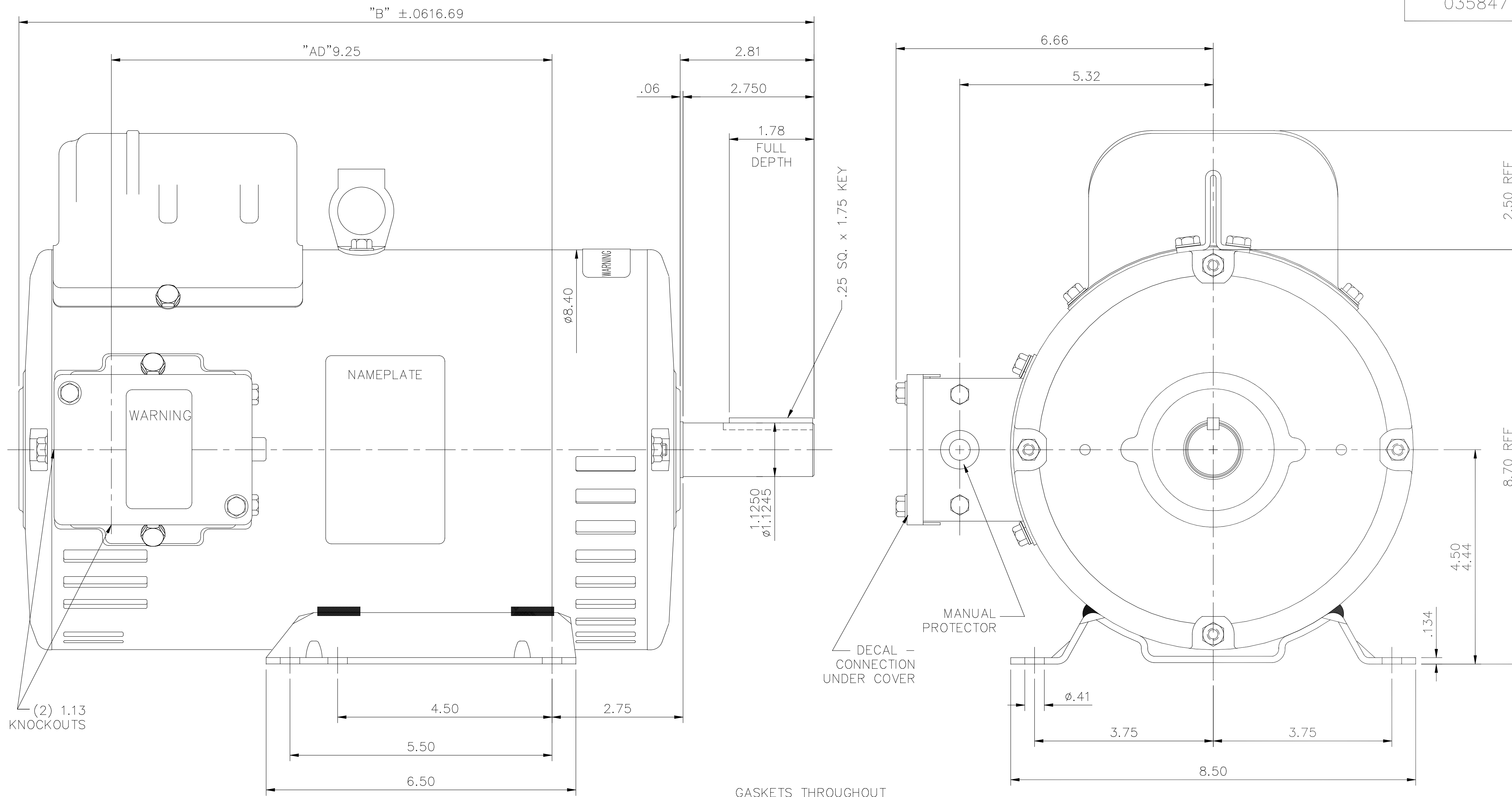

| DASH NO. | "C" | "AD" |
|----------|-------|------|
| 950 | 13.69 | 6.25 |
| 1000 | 14.19 | 6.75 |
| 1050 | 14.69 | 7.25 |
| 1100 | 15.19 | 7.75 |
| 1150 | 15.69 | 8.25 |
| 1200 | 16.19 | 8.75 |
| 1250 | 16.69 | 9.25 |

| | | | | TOLERANCES UNLESS SPECIFIED | | REGAL™ Regal Beloit America, Inc. | DRAWN VS 2/15/2012 | | | |
|--|-------------------------|------------|-----|-----------------------------|--------|--|--------------------|-----------|-------------|------|
| | | | | DEC. | INCHES | | CHK | | | |
| | | | | .X | ±.1 | TITLE OUTLINE DRIP PROOF - RIGID MOUNT | SCALE | 1=2 | | |
| | | | | .XX | ±.03 | | REF | 035696 | | |
| | | | | .XXX | ±.005 | | FMF | 131851.00 | | |
| A | REDRAWN WITH REGAL LOGO | KIR 1/8/16 | SR | .XXXX | ±.0005 | MAT'L. | | | | |
| NO. | REVISION | BY & DATE | CHK | ANG | ±1/2' | FINISH | | PREV | | |
| THIS DRAWING IN DESIGN AND DETAIL IS OUR PROPERTY AND MUST NOT BE USED EXCEPT IN CONNECTION WITH OUR WORK ALL RIGHTS OF DESIGN AND INVENTION ARE RESERVED THIS IS AN ELECTRONICALLY GENERATED DOCUMENT - DO NOT SCALE THIS PRINT | | | | RFP | | CAD FILE | 035847 | SIZE | DRAWING NO. | REV. |
| | | | | DIST | | | | B | 035847 | A |

VIEW FROM OUTSIDE OF MOTOR AT SWITCH END.

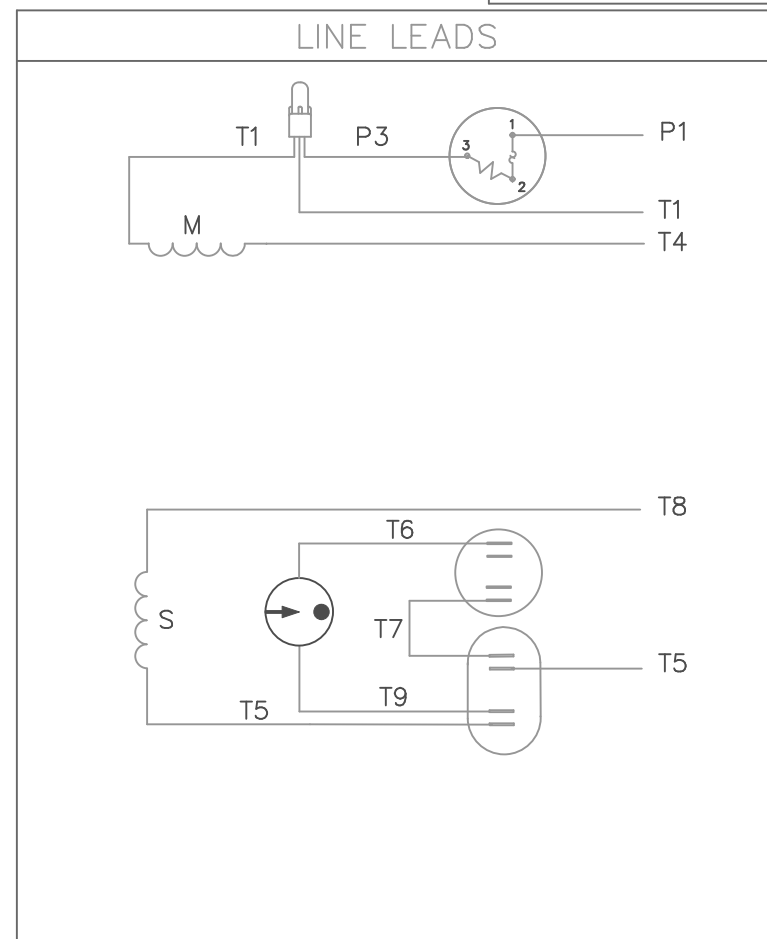
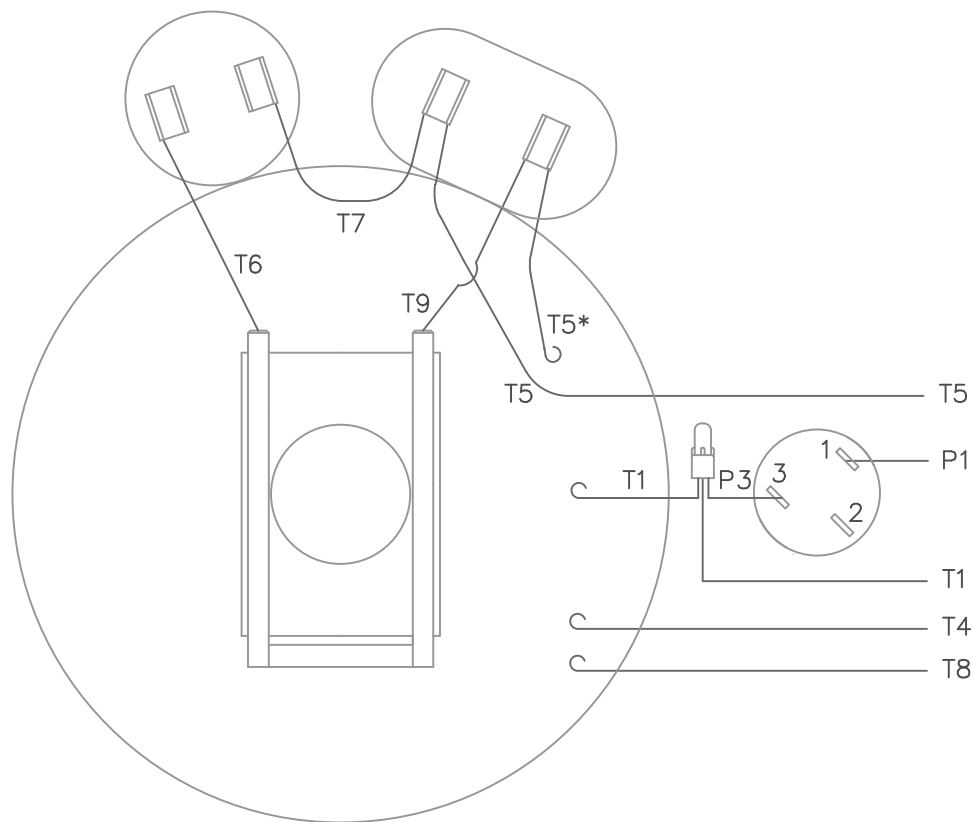

| | | | |
|--------------------------------|----|--------|--------|
| ROTATION FACING LEAD END | L1 | L2 | JOIN |
| C.C.W. | P1 | T4, T5 | T1, T8 |
| C.W. | P1 | T4, T8 | T1, T5 |

* THIS LEAD MAY BE WHITE

| | | TOLERANCES UNLESS SPECIFIED | | LEESON | ELECTRIC MOTORS GEARMOTORS AND DRIVES | DRAWN WLW 08/30/76 | | | |
|--|-----------------------------------|--------------------------------|---------|--------|---|--------------------|------------------|-------------|------|
| | | DEC. | INCHES | | | | CHK WRK 09/24/76 | | |
| | | .X | ±.1 | | | APPD | | | |
| 08 | ALTERNATE T5 LEAD MARKING WAS RED | RLW | 8/6/02 | .XX | ±.01 | SCALE 1=1 | | | |
| 07 | ADDED ALTERNATE T5 LEAD MARKING | RLW | 5/31/02 | KH | .XXX ±.005 | REF | | | |
| 06 | REDRAWN TO CAD | DBT | 5/31/02 | .XXXX | ±.0005 | FMF 6K17FB4 | | | |
| NO. | REVISION | BY & DATE | CHK | ANG | ±1/2' | PREV | | | |
| THIS DRAWING IN DESIGN AND DETAIL IS OUR PROPERTY AND MUST NOT BE USED EXCEPT IN CONNECTION WITH OUR WORK ALL RIGHTS OF DESIGN AND INVENTION ARE RESERVED THIS IS AN ELECTRONICALLY GENERATED DOCUMENT - DO NOT SCALE THIS PRINT | | | | RFP | CAD FILE | 00505603 | SIZE | DRAWING NO. | REV. |
| | | | | DIST | BRF-NLV | | A | 005056-03 | 08 |



1051 CHEYENNE AVE.
GRAFTON, WI 53024
PH. 262-377-8810

CERTIFICATION DATA SHEET

CATALOG #: 131851.00

CONN. DIAGRAM: 005056.03

OUTLINE: 035847-950

MOUNTING: F1 ONLY

WINDING #: K84101 2

TYPICAL MOTOR PERFORMANCE DATA

| HP | kW | SYNC. RPM | F.L. RPM | FRAME | ENCLOSURE | KVA CODE | DESIGN |
|----|------|-----------|----------|-------|-----------|----------|----------------|
| 3 | 2.24 | 1800 | 1760 | 184T | DP | G | NO DESIGN CODE |

| PH | Hz | VOLTS | AMPS | START TYPE | DUTY | INSL | S.F. | AMB°C |
|----|----|---------|-----------|-----------------|------------|------|------|-------|
| 1 | 60 | 208-230 | 13.8-12.8 | ACROSS THE LINE | CONTINUOUS | F4 | 1.15 | 40 |

| FULL LOAD EFF: | 81.5 | 3/4 LOAD EFF: | 82.4 | 1/2 LOAD EFF: | 77.3 | GTD. EFF | | ELEC. TYPE | |
|----------------|------|---------------|------|---------------|------|----------|--|-------------------|--|
| FULL LOAD PF: | 92.5 | 3/4 LOAD PF: | 89.8 | 1/2 LOAD PF: | 84.3 | 78.5 | | CAP START CAP RUN | |

| F.L. TORQUE | LOCKED ROTOR AMPS | L.R. TORQUE | B.D. TORQUE | F.L. RISE°C |
|-------------|-------------------|------------------|------------------|-------------|
| 8.94 LB-FT | 86.3 | 19.5 LB-FT 218 % | 23.7 LB-FT 265 % | 38 |

| SOUND PRESSURE @ 3 FT. | SOUND POWER | ROTOR WK^2 | MAX. WK^2 | SAFE STALL TIME | STARTS / HOUR | APPROX. MOTOR WGT |
|------------------------|-------------|---------------|-----------|-----------------|---------------|-------------------|
| 0 dBA | 10 dBA | 0.147 LB-FT^2 | 0 LB-FT^2 | 10 SEC. | 0 | 75 LBS. |

*** SUPPLEMENTAL INFORMATION ***

| DE BRACKET TYPE | ODE BRACKET TYPE | MOUNT TYPE | ORIENTATION | SEVERE DUTY | HAZARDOUS LOCATION | DRIP COVER | SCREENS | PAINT |
|-----------------|------------------|------------|-------------|-------------|--------------------|------------|---------|------------------------|
| STANDARD | STANDARD | RIGID | HORIZONTAL | FALSE | NONE | FALSE | NONE | BLUE - LEESON (ENAMEL) |

| BEARINGS | | GREASE | SHAFT TYPE | SPECIAL DE | SPECIAL ODE | SHAFT MATERIAL | FRAME MATERIAL |
|----------|------|------------|------------|------------|-------------|-------------------|----------------|
| DE | ODE | | | | | | |
| BALL | BALL | POLYREX EM | T | NONE | NONE | AISI 1045 (C-240) | ROLLED STEEL |
| 6206 | 6205 | | | | | | |

| THERMO-PROTECTORS | | | | THERMISTORS | CONTROL | SPACE HEATERS |
|-------------------|------------|----------|----------|-------------|---------|---------------|
| THERMOSTATS | PROTECTORS | WDG RTDs | BRG RTDs | | | |
| NONE | MANUAL | NONE | NONE | NONE | FALSE | NONE VOLTS |

| | |
|---------------------------------|--|
| * N O T E S * | INVERTER TORQUE: NONE INV. HP SPEED RANGE: NONE |
| | ENCODER: NONE NONE NONE NONE NONE PPR |
| | BRAKE: NONE NONE NONE P/N NONE NONE NONE NONE FT-LB NONE V NONE Hz |



LEESON ELECTRIC CORPORATION
 TYPICAL PERFORMANCE CURVE for AC MOTOR

Curve at 230 Volts HP 3.00 PHASE 1
60 HZ
3 HP VOLTS 208-230

Model No 131851.00

Catalog No 131851.00

HZ 60

RPM 1760

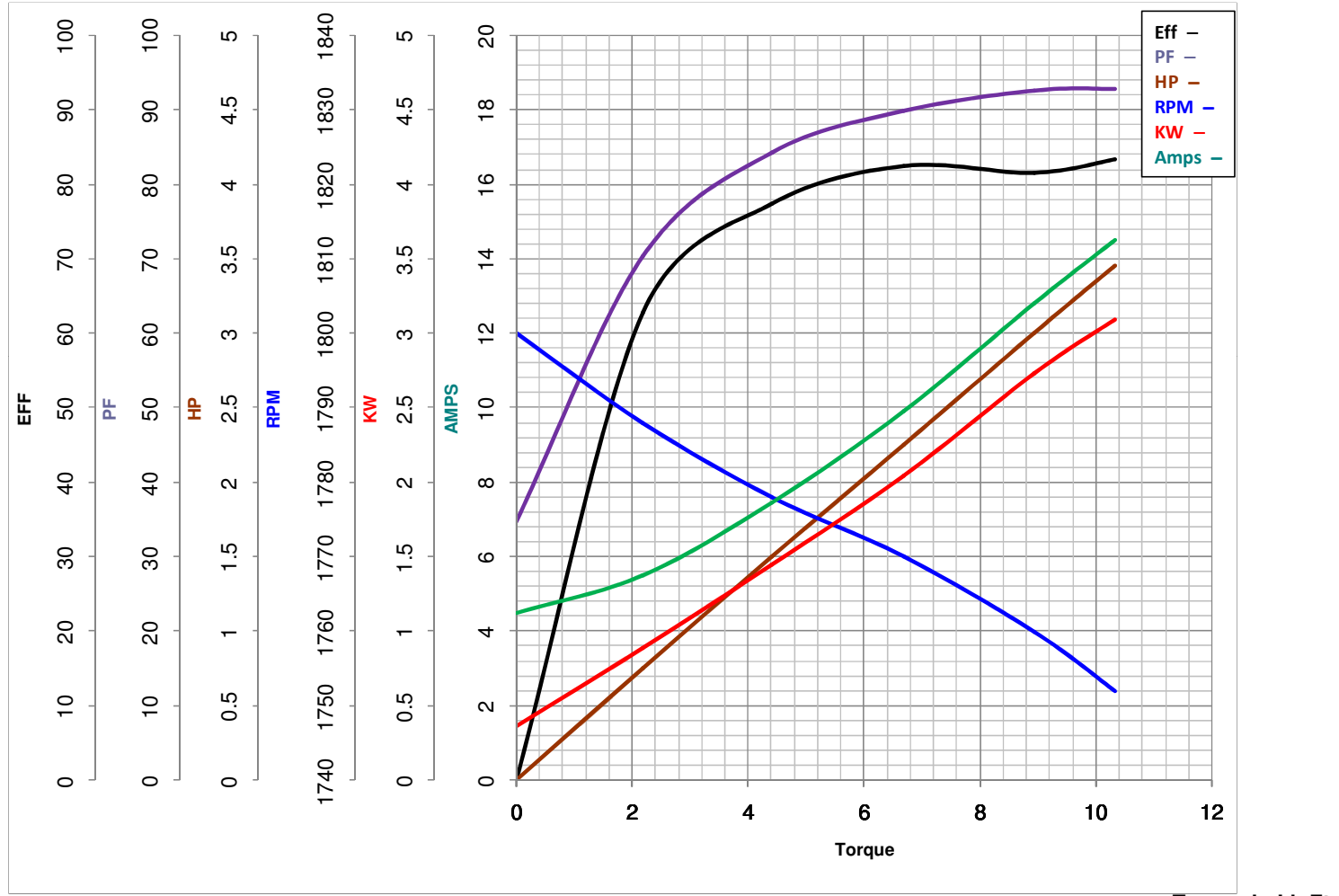

Torque in Lb.Ft

FL TORQUE 8.94 Lb.Ft
 BD TORQUE 23.7 Lb.Ft
 LR TORQUE 19.5 Lb.Ft

FL AMPS 13.8-12.8
 PU TORQUE 17.6 Lb.Ft
 LR AMPS 86.3

WINDING K84101-2

Date 3/19/2018