

PRODUCT INFORMATION PACKET

Model No: 108502.00
Catalog No: 108502.00
SCR Motor, 3 HP, 180 V, 1750 RPM, 182/145TC Frame, TEFC



Regal and are trademarks of Regal Rexnord Corporation or one of its affiliated companies.
©2022 Regal Rexnord Corporation, All Rights Reserved. MC017097E

Nameplate Specifications

Output HP	3 Hp	Output KW	2.2 kW
Voltage	180 V	Current	14.0 A
Speed	1750 rpm	Service Factor	1
Efficiency	88.8 %	Duty	Continuous
Insulation Class	H	Frame	182/145TC
Enclosure	Totally Enclosed Fan Cooled	Thermal Protection	No Protection
Ambient Temperature	40 °C	Drive End Bearing Size	6205
Opp Drive End Bearing Size	6204	UL	Recognized
CSA	Y	CE	N

Technical Specifications

Rotation	Reversible	Mounting	Rigid C base
Overall Length	19.60 in	Shaft Diameter	0.875 in
Shaft Extension	2.15 in	Torque	108 LB-IN
Outline Drawing	033315	Connection Drawing	00531901

This is an uncontrolled document once printed or downloaded and is subject to change without notice. Date Created:09/19/2022

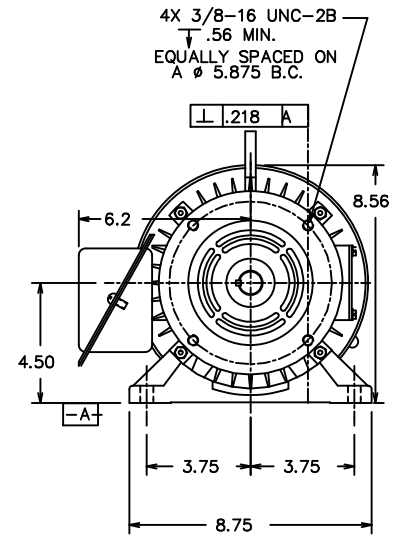
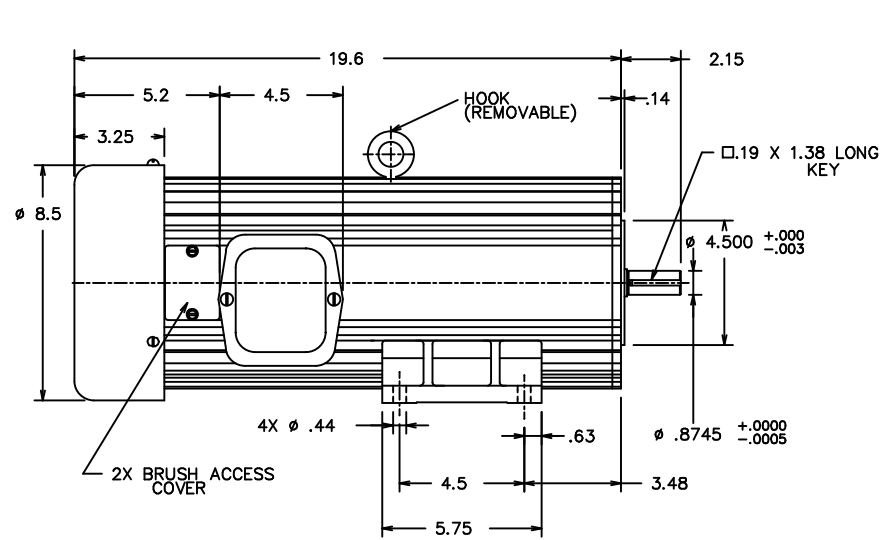
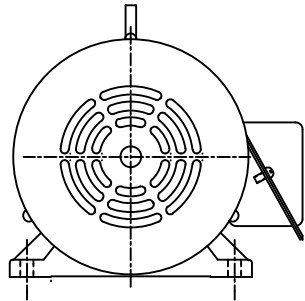

HP	3.0
FL AMPS	14.0
NL AMPS	.56
VOLTS	180
RPM	1750

		TOLERANCES UNLESS SPECIFIED		LEESON	ELECTRIC MOTORS GEARMOTORS AND DRIVES	DRAWN DLL 8/13/86			
		DEC.	INCHES				CHK		
04	REDRAWN ON CAD	WMM	4/7/97	.X	±.1	APPD JCW 8/13/86			
03	REVISED PER SALES CN, EFF IMMED.	MMG	1/12/95	.XX	±.03	SCALE 1=2			
02	ADDED TABLE	MMG	6/13/94	.XXX	±.005	REF			
01	LENGTH WAS 19"	JCW	11/17/86	.XXXX	±.0005	MATL			
NO.	REVISION	BY & DATE	CHK	ANG	±1/2"	FINISH			
THIS DRAWING IN DESIGN AND DETAIL IS OUR PROPERTY AND MUST NOT BE USED EXCEPT IN CONNECTION WITH OUR WORK ALL RIGHTS OF DESIGN AND INVENTION ARE RESERVED THIS IS AN ELECTRONICALLY GENERATED DOCUMENT - DO NOT SCALE THIS PRINT				RFP	CAD FILE	033315	SIZE	DRAWING NO.	REV.
				DIST	B	033315	04		

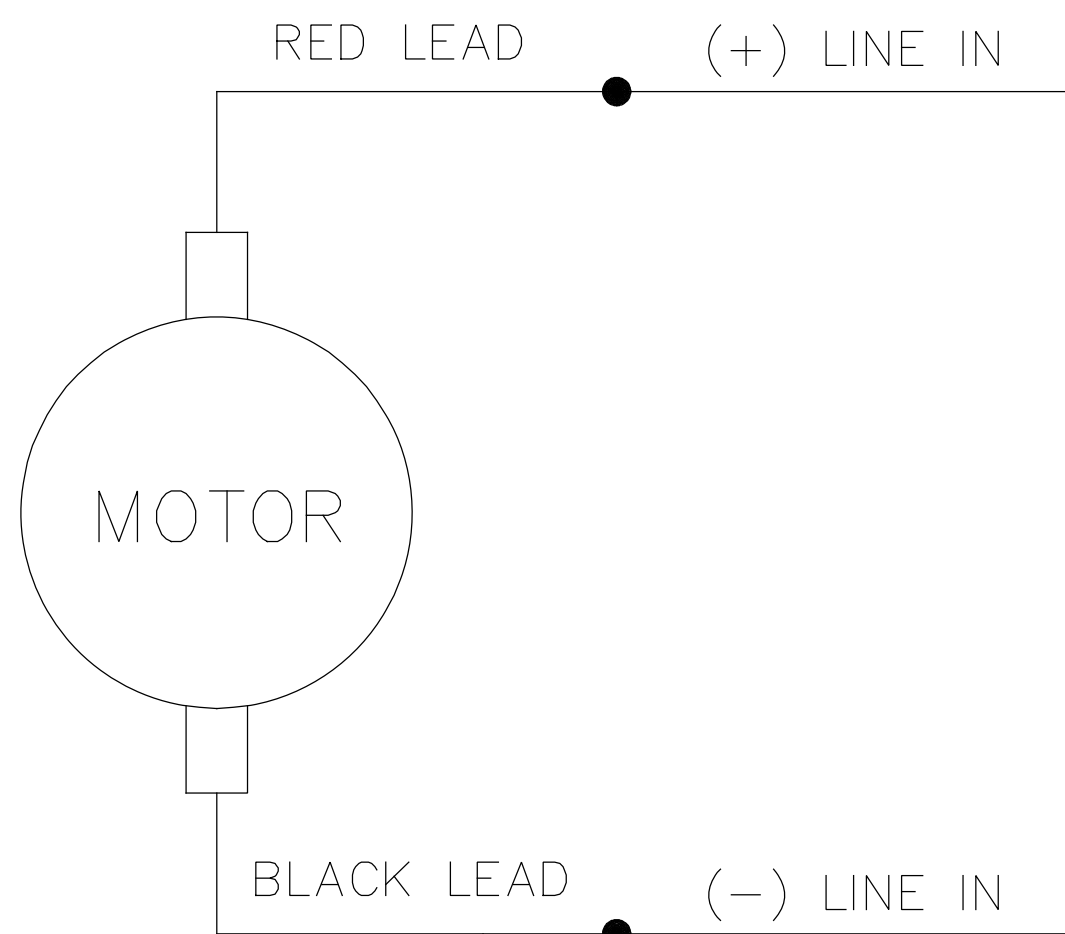

CONNECTIONS SHOWN FOR CCW ROTATION FACING LEAD END OF THE MOTOR
 TO REVERSE ROTATION INTERCHANGE LINE LEADS

NO.	REVISION	BY & DATE	CHK	TOLERANCES UNLESS SPECIFIED		LEESON	ELECTRIC MOTORS GEARMOTORS AND DRIVES	DRAWN TJF 11/15/97	
				DEC.	INCHES				CHK
				.X	±.1			APPD POW 11/15/97	
E	"MOTOR" WAS "ARMATURE", ECO-0163602	IPG 3/14/19		.XX	±.01	TITLE	EXTERNAL WIRING DIAGRAM PMDC MOTOR	SCALE 1=2	
D	UPDATED TO MAKE IT GENERIC, ECO-0163547	IPG 3/13/19		.XXX	±.005			REF	
01	REDRAWN ON CAD. REVISED NOTES.	SJB 9/20/2005		.XXXX	±.0005	MAT'L.		FMF	
				ANG	±1/2°	FINISH		PREV	
THIS DRAWING IN DESIGN AND DETAIL IS OUR PROPERTY AND MUST NOT BE USED EXCEPT IN CONNECTION WITH OUR WORK ALL RIGHTS OF DESIGN AND INVENTION ARE RESERVED THIS IS AN ELECTRONICALLY GENERATED DOCUMENT - DO NOT SCALE THIS PRINT				RFP	CAD FILE 00531901		SIZE A	DRAWING NO. 005319.01	REV. E
				DIST					

LEESON ELECTRIC CORPORATION

TYPICAL PERFORMANCE CURVE FOR DIRECT CURRENT PERMANENT MAGNET MOTOR

Model No. <u>C182D17FK2</u>	Catalog No. <u>108502.00</u>	
HP <u>3.000</u>	RPM <u>1750</u>	DC Volts <u>180.0</u>
F.F. <u>1.40</u>	Encl <u>TEFC</u>	Type <u>DF</u>
Max. Amb. <u>40.0 Deg C</u>	Insul. <u>H</u>	Frame <u>182BC</u>
		N.P. FLA <u>14.00</u>
		S.F. <u>1.00</u>
		Duty <u>Cont</u>

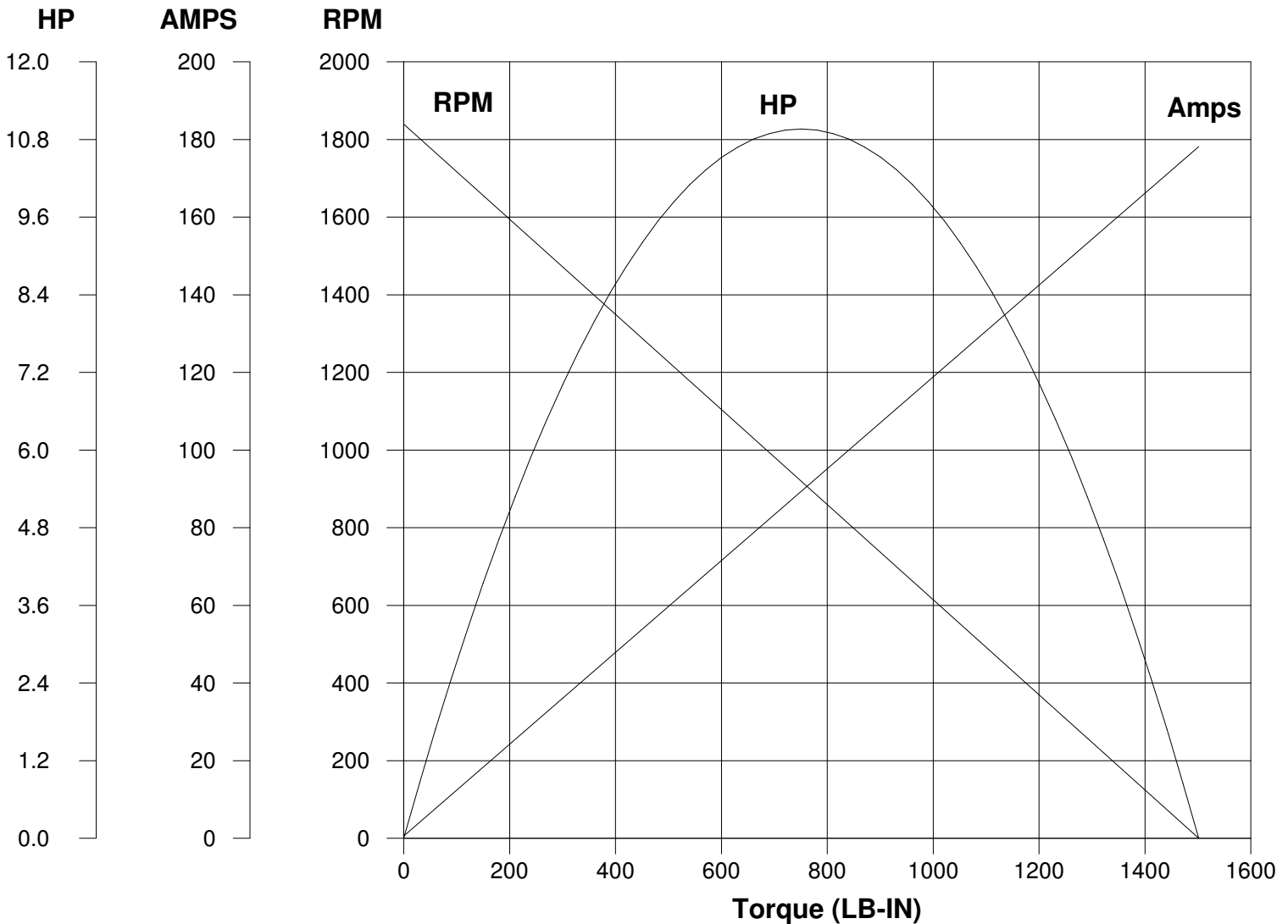

Ra	<u>0.6000</u>	Ohms
La	<u>7.200</u>	mHenrys
Ja	<u>40.00</u>	LB-IN ²
Ke	<u>109.9</u>	V/KRPM

Kt	<u>9.293</u>	LB-IN/AMP
Imax	<u>78.0</u>	AMPS Allowed
FL Torque	<u>108.0</u>	LB-IN
FL EFF	<u>88.80</u>	%

Winding W- PS3-1 **Prepared by** V. Boehlen **Date** 05-02-2005