

# PRODUCT INFORMATION PACKET

**marathon®**  
Motors

Model No: 1009394-BR

Catalog No: 1009394

TerraMAX® Cast Iron Motor, 2 HP, 3 Ph, 60 Hz, 380 V, 3600 RPM, 80M2 Frame, TEFC



Regal and Marathon are trademarks of Regal Rexnord Corporation or one of its affiliated companies.  
©2022 Regal Rexnord Corporation, All Rights Reserved. MC017097E

**RegalRexnord**

### Nameplate Specifications

Output HP	2 Hp	Output KW	1.5 kW
Frequency	60 Hz	Voltage	380 V
Current	3.0 A	Speed	3462 rpm
Service Factor	1.25	Phase	3
Efficiency	85.5 %	Power Factor	0.88
Duty	S1	Insulation Class	F
Frame	80M2	Enclosure	Totally Enclosed Fan Cooled
Thermal Protection	No Protection	Ambient Temperature	40 °C
Drive End Bearing Size	6204	Opp Drive End Bearing Size	6204
UL	No	CSA	No
CE	No	IP Code	55
Number of Speeds	1		

### Technical Specifications

Electrical Type	Squirrel Cage	Starting Method	Direct On Line
Poles	2	Rotation	Clockwise
Mounting	B3	Motor Orientation	Horizontal
Drive End Bearing	Zz C3	Opp Drive End Bearing	Zz C3
Frame Material	Cast	Shaft Type	Keyed
Overall Length	306 mm	Frame Length	165 mm
Shaft Diameter	19 mm	Shaft Extension	40 mm
Assembly/Box Mounting	TOP		
Outline Drawing	0208000334		

This is an uncontrolled document once printed or downloaded and is subject to change without notice. Date Created:12/02/2022

4

3

Uncontrolled Copy

2

1

OUTLINE

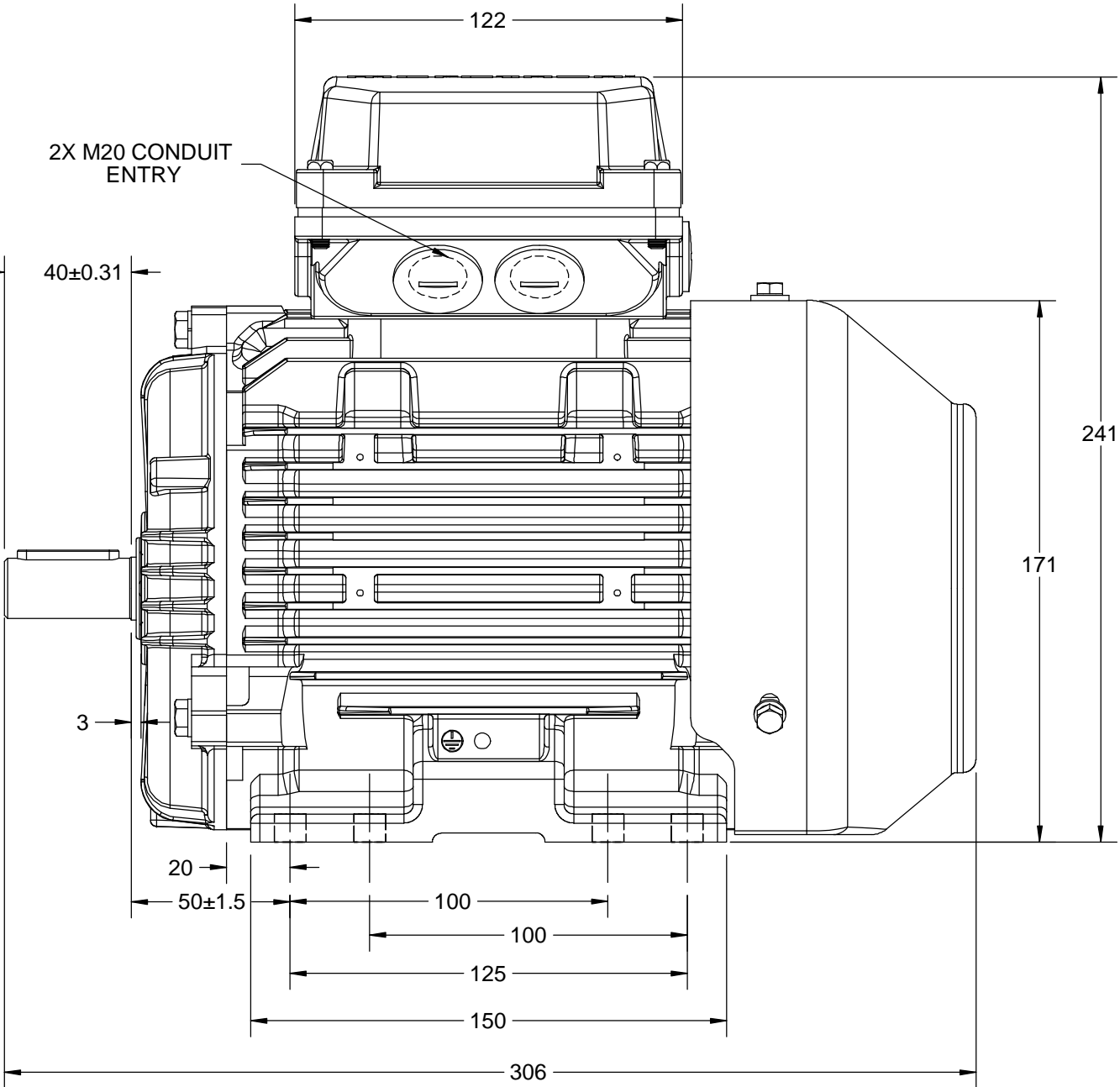
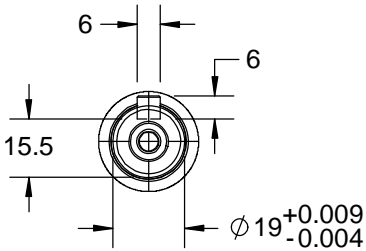
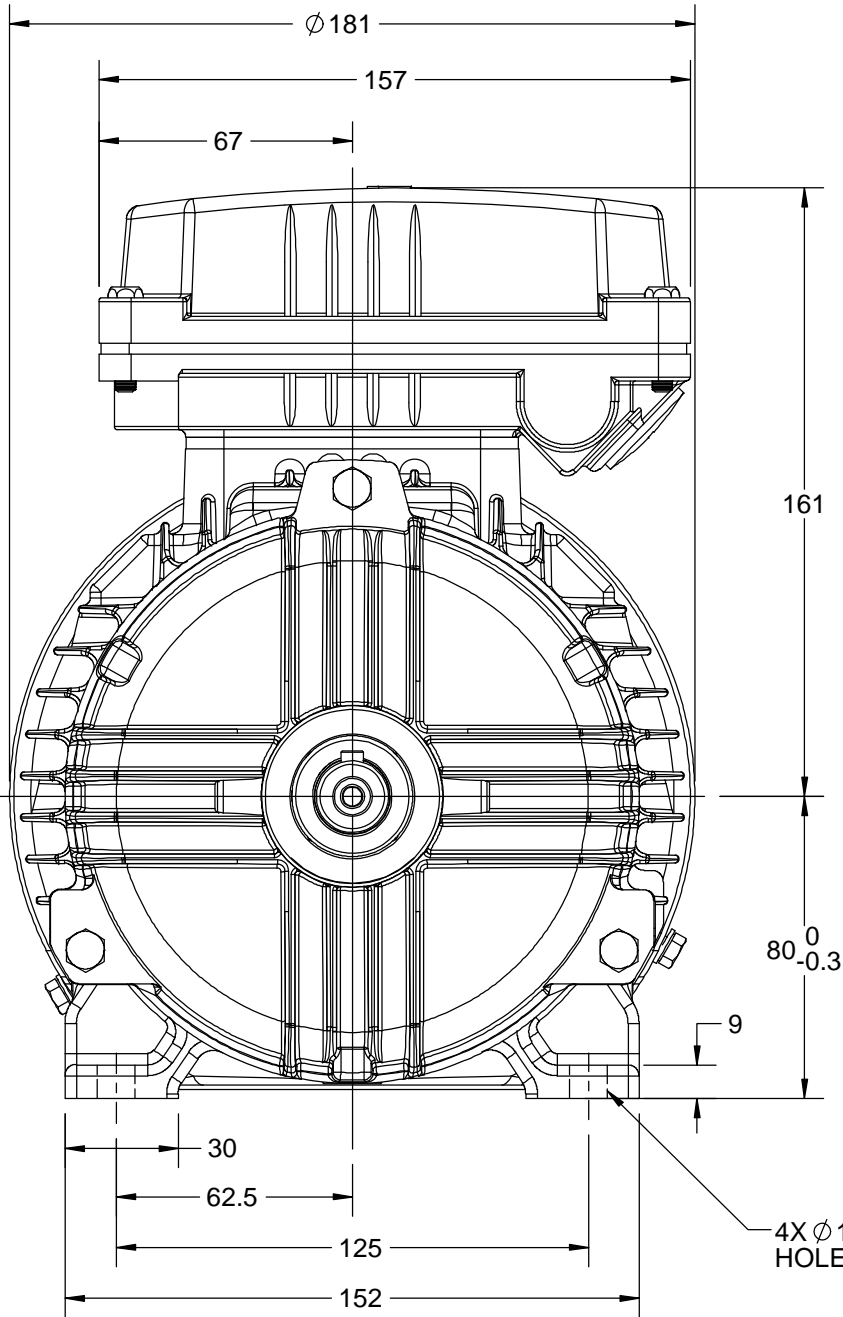

DRAWING REVISION B	REVISION BY NIV	DATE 20/09/2017
ECO ECO-0131516	APPROVED BY JAY	DATE 20/09/2017
ECO DESCRIPTION		
UPDATED DRAWING		
COPYRIGHT REGAL BELOIT AMERICA, INC. ALL RIGHTS RESERVED. PROPRIETARY AND CONFIDENTIAL INFORMATION - THIS DOCUMENT IS THE PROPERTY OF REGAL BELOIT AMERICA, INC. ("OWNER") AND CONTAINS OWNER'S PROPRIETARY INFORMATION. ANY PERSON, CORPORATION OR OTHER FIRM RECEIVING IT IS DEEMED, BY RECEIVING IT, TO AGREE THAT IT, AND/OR ANY PART OF IT, SHALL NOT BE DISCLOSED TO ANY PERSON, CORPORATION OR OTHER ENTITY, DUPLICATED, AND/OR USED, EXCEPT AS EXPRESSLY APPROVED IN WRITING IN ADVANCE BY OWNER. THIS DOCUMENT SHALL BE RETURNED TO OWNER UPON REQUEST. IT MAY BE SUBJECT TO CERTAIN RESTRICTIONS UNDER APPLICABLE EXPORT CONTROL LAWS AND REGULATIONS.		

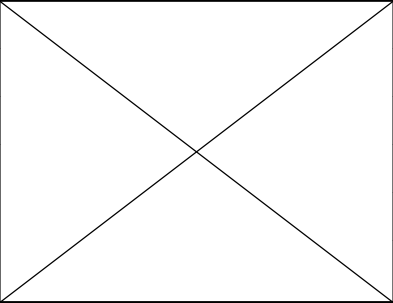

DRAWN BY NIV	<b>marathon™</b> Motors		
DATE 17/07/2017			
APPROVED BY JAY	DESCRIPTION		
DATE 17/07/2017	80 FR- B3 MTG. MOTOR TYPE TCA / QCA		
REFERENCE	MATERIAL	PROCESS/FINISH	
THIRD ANGLE PROJECTION	SIZE B	DRAWING NUMBER 0208000334	SHEET 1 OF 1

Model No. 1009394

Enclosure	U (V)	Δ / Y Conn	f [Hz]	P [kW]	P [hp]	I [A]	n [RPM]	T [kgm]	T [Nm]	IE Class	Amb [°C]	Duty	Elevation [m]	Inertia [kg-m <sup>2</sup> ]	Weight [kg]
TEFC	380	Δ	60	1.5	2	3.0	3462	0.41	4.06	IR3	40	S1	1000	0.008	22

**Motor Load Data**

Load Point		NL	1/4FL	1/2FL	3/4FL	FL	5/4FL
Current	A	1.1	1.4	1.8	2.4	3.0	3.7
Torque	Nm	0.0	1.0	2.0	3.1	4.1	5.2
Speed	r/min	3600	3565	3534	3500	3462	3419
Efficiency	%	0.0	66.8	82.8	84.4	85.5	83.9
Power Factor	%	14.0	50.1	73.5	83.0	88.0	90.1

**Performance vs Load Chart**

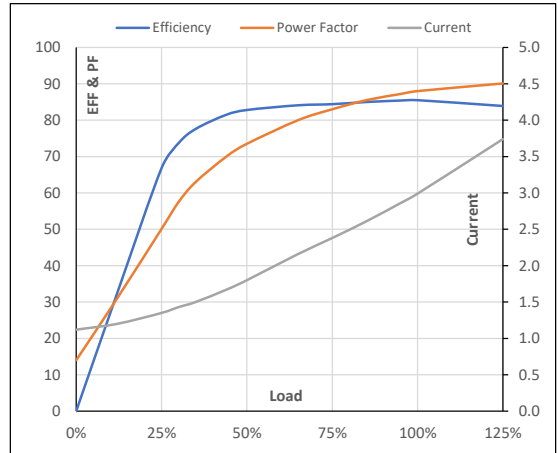

**Motor Speed Torque Data**

Load Point		LR	P-Up	BD	Rated	NL
Speed	r/min	0	720	2571	3462	3600
Current	A	23.0	20.7	13.7	3.0	1.1
Torque	pu	3.5	3.0	3.5	1	0

**Starting Characteristics Chart**

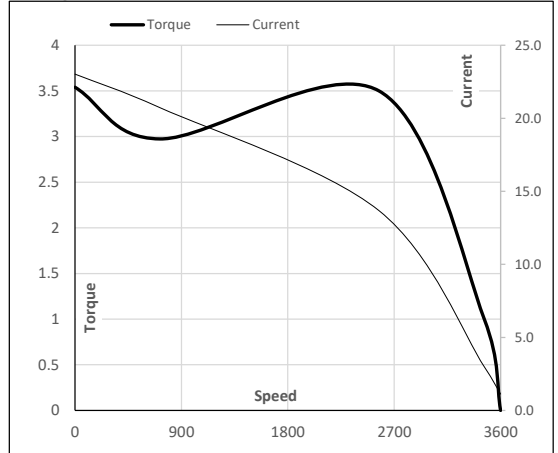

**NOTE** Refer data sheet for applicable standard and tolerances on performance parameters

Issued By  
Issued Date