

PRODUCT INFORMATION PACKET

Model No: 096001.00

Catalog No: 096001.00

Parallel Shaft Gearmotor, 0.08 HP, 1 Ph, 60 Hz, 110 V, 9 RPM, L42Y Frame, TENV



Regal and are trademarks of Regal Rexnord Corporation or one of its affiliated companies.
©2022 Regal Rexnord Corporation, All Rights Reserved. MC017097E

Nameplate Specifications

Output HP	0.08 Hp	Output KW	0.06 kW
Frequency	60 Hz	Voltage	110 V
Current	1.3/0.65 A	Speed	9 rpm
Service Factor	1	Phase	1
Duty	Continuous	Insulation Class	F
KVA Code	G	Frame	L42Y
Enclosure	Totally Enclosed Non Ventilated	Thermal Protection	No Protection
Ambient Temperature	40 °C	Drive End Bearing Size	6203
Opp Drive End Bearing Size	6201	UL	Recognized
CSA	Y	CE	N

Technical Specifications

Rotation	Reversible	Mounting	Special
Shaft Type	Parallel	Overall Length	11.36 in
Frame Length	5.50 in	Shaft Diameter	0.750 in
Shaft Extension	1.625 in	Torque	341 OZ-FT
Outline Drawing	027690-096001	Connection Drawing	005108.05

This is an uncontrolled document once printed or downloaded and is subject to change without notice. Date Created:09/08/2022

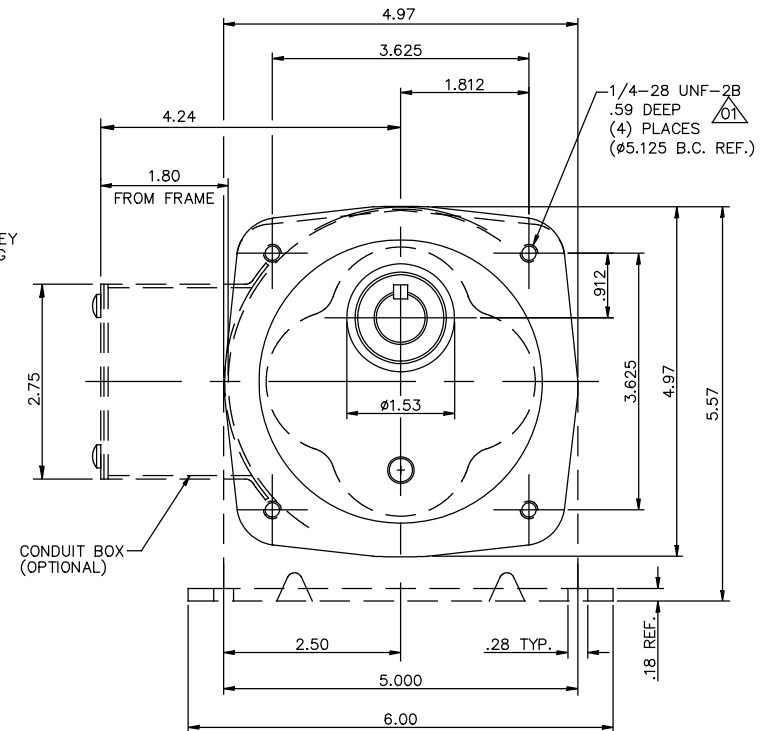

						TOLERANCES UNLESS OTHERWISE SPECIFIED		LEESON ELECTRIC CORPORATION			
						DECIMALS					
						.00	± .01	DRAWN DWG 7/14/97	TITLE		
						.000	± .005	CH'KD.	OUTLINE DRAWING 42 FRAME PE350 STOCK		
01	THREAD DEPTH WAS .63"			JD	06/06/17	.0000	± .0005	APPR.	MAT'L		
NO.	REVISION			BY	DATE	FRACTIONS	± 1/64	SCALE 1=1.5			
THIS DRAWING IN DESIGN AND DETAIL IS OUR PROPERTY AND MUST NOT BE USED EXCEPT IN CONNECTION WITH OUR WORK ALL RIGHTS OF DESIGN AND INVENTION ARE RESERVED.						ANGLES ± 1/2"		REF. 027689	FINISH LEESON	SIZE B DRAWING NO.	
						INCH/MM		FIMF 096000.00	STOCK	027690	

005108-05

VIEW FROM OUTSIDE OF MOTOR AT LEAD END.

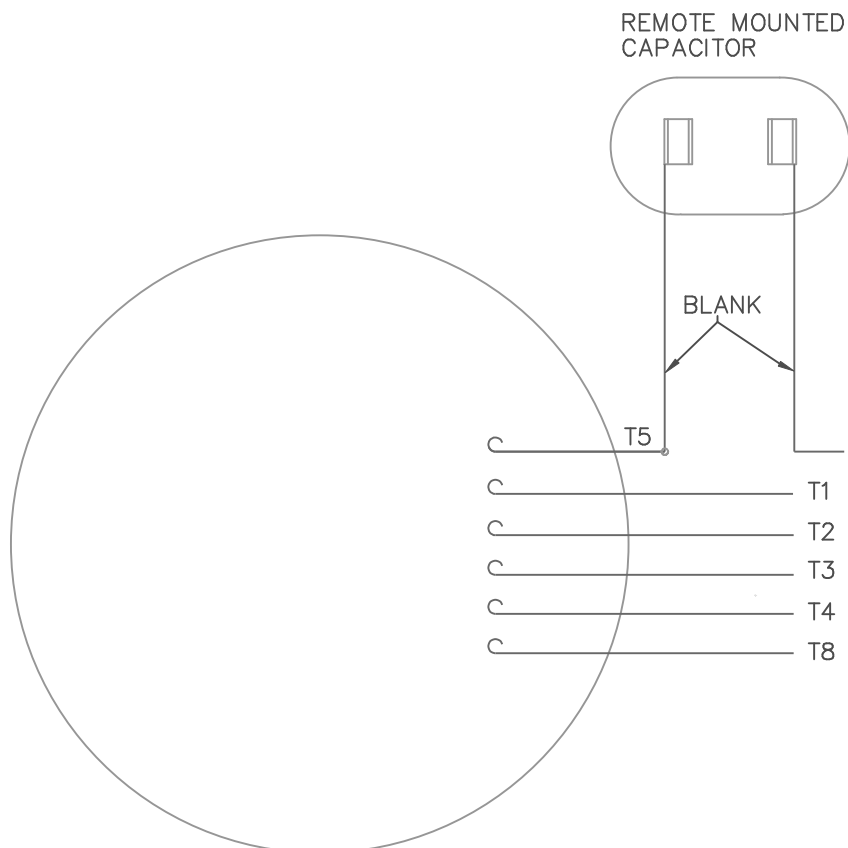

LINE LEADS

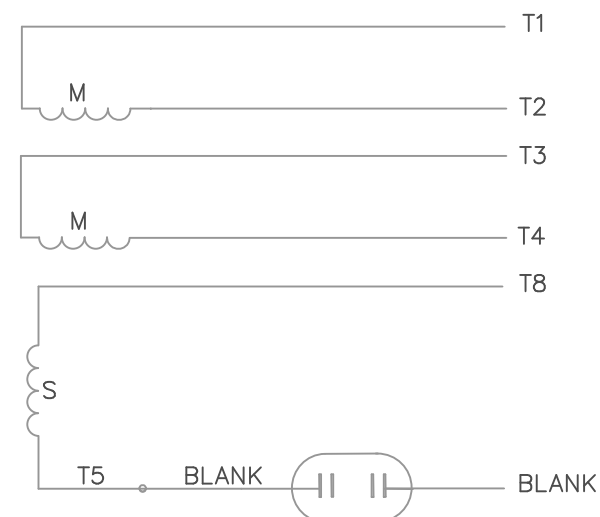

LOW VOLTAGE

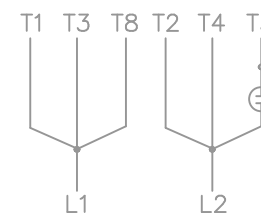

HIGH VOLTAGE

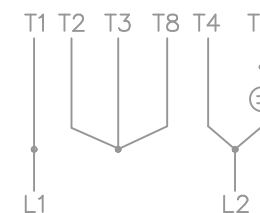

2 STAGE:
C.C.W. ROTATION FACING LEAD END AS SHOWN
INTERCHANGE LEADS T5 & T8 FOR C.W.

3 STAGE:
CW ROTATION FACING LEAD END AS SHOWN
INTERCHANGE LEADS T5 & T8 FOR CCW

				TOLERANCES UNLESS OTHERWISE SPECIFIED		LEESON ELECTRIC CORPORATION					
				DECIMALS							
				.00	± .01	DRAWN DBT 07/21/97	TITLE EXTERNAL WIRING DIAGRAM TYPE "P" W/O PROTECTOR MAT'L TAG - 080689.02 - 2 STAGE TAG - 080689.01 - 3 STAGE				
				.000	± .005	CH'K'D.					
				.0000	± .0005	APPR.					
NO.	REVISION		BY	DATE	FRACTIONS	± 1/64	SCALE 1=1				
THIS DRAWING IN DESIGN AND DETAIL IS OUR PROPERTY AND MUST NOT BE USED EXCEPT IN CONNECTION WITH OUR WORK ALL RIGHTS OF DESIGN AND INVENTION ARE RESERVED					ANGLES	± 1/2'	REF. 005018-01	FINISH LEESON		SIZE A	DRAWING NO. 005108-05
					INCH/MM		FMF	GEARMOTORS			